



Consulting, Ltd.

300 East 210th Street
Euclid, Ohio 44123
(216) 410 3422 (Voice)
(216) 481 8278 (Fax)

March 30, 2016

Joshua Adams
Ohio Environmental Protection Agency
2110 E. Aurora Road
Twinsburg, OH 44087-1969

Dear Mr. Adams:

Please find enclosed a *Request for Authorization to Engage In Excavation Activities at the Former City Of Westlake Sanitary Landfill Pursuant to OAC 3745-27-13*. This request pertains to the installation of a passive gas venting trench in the southwest corner of the former landfill.

We trust that this submittal will meet your needs, and look forward to your approval of our request. Should you have any questions or require and additional information please do not hesitate to contact the undersigned.

Sincerely,

EARTH CONSULTING, LTD.

Fraser K. Hamilton PG
Owner/Geologist

Enclosures

cc: Mr. Paul Quinn, City of Westlake (email only)
Mr. Chris Stuhm, City of Westlake (email and hardcopy)
Mr. Doug Perisutti, Mannik Smith Group (email only)

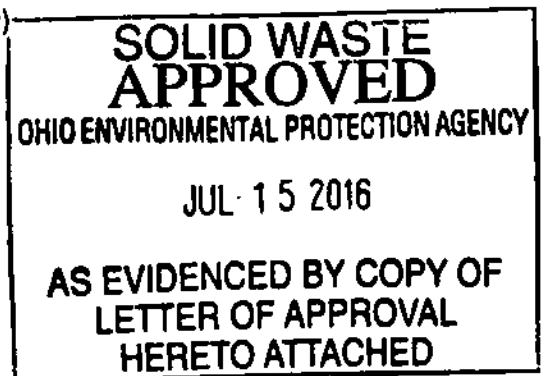

REQUEST FOR AUTHORIZATION

To
ENGAGE IN EXCAVATION ACTIVITIES AT A
PORTION OF THE FORMER CITY OF WESTLAKE
SANITARY LANDFILL
Pursuant to
OAC 3745-27-13

March 30, 2016



Consulting, Ltd.

300 E 210th St.
Cleveland, Ohio 44123
216 410 3422
www.earthconsulting.org

RECEIVED
MAY 11 2016
AS FURNISHED BY COPY OF
THE RECORD OF PROCEEDINGS



CONTENTS

1.0 3745-27-13 (E) (1) THE LOCATION SPECIFIED ON A 7-1/2 MINUTE USGS TOPOGRAPHICAL MAP AND ON A TOPOGRAPHIC MAP WITH A MAXIMUM SCALE OF ONE INCH EQUALS TWO HUNDRED FEET, LEGAL DESCRIPTION, TYPE OF FACILITY, DEMONSTRATION OF CURRENT PROPERTY OWNERSHIP, AND DEMONSTRATION OF CURRENT FACILITY OWNERSHIP. 1

2.0 3745-27-13 (E) (2) THE SPECIFIC ACTIVITIES AND THEIR INTENDED PURPOSES FOR WHICH AUTHORIZATION IS REQUESTED. 1

3.0 3745-27-13 (E) (3) DISCUSSION OF ALL PREVIOUS AND EXISTING PERMITS, LICENSES, APPROVALS, AND ORDERS PERTAINING TO PAST AND ONGOING WASTE TREATMENT, STORAGE, OR DISPOSAL ACTIVITIES ISSUED UNDER LOCAL, STATE, AND FEDERAL ENVIRONMENTAL REGULATIONS FOR LANDS UPON WHICH AUTHORIZATION UNDER THIS RULE IS REQUESTED..... 2

4.0 3745-27-13 (E) (4) LETTERS OF ACKNOWLEDGMENT FROM THE OWNERS OF ALL PARCELS OF LAND TO WHICH THE AUTHORIZATION PERTAINS. 3

5.0 3745-27-13 (E) (5) COPIES OF CERTIFIED MAIL RECEIPTS AND A STATEMENT CERTIFYING THAT LETTERS OF NOTICE STATING THAT AUTHORIZATION UNDER THIS RULE IS BEING REQUESTED FOR THE AFFECTED SITE HAVE BEEN SENT TO THE FOLLOWING ENTITIES: 3

5.1 3745-27-13 (E) (5) (A) THE BOARD OF HEALTH OF THE HEALTH DISTRICT WHEREIN THE SITE IS LOCATED. 3

5.2 3745-27-13 (E) (5) (B) THE GOVERNMENTS OF THE GENERAL PURPOSE POLITICAL SUBDIVISIONS WHERE THE SITE IS LOCATED, I.E., COUNTY COMMISSIONER, LEGISLATIVE AUTHORITY OF A MUNICIPAL CORPORATION, AND/OR THE BOARD OF TOWNSHIP TRUSTEES. 3

5.3 3745-27-13 (E) (5) (C) THE LOCAL ZONING AUTHORITY HAVING JURISDICTION OVER THE GEOGRAPHICAL AREA WHERE THE SITE IS LOCATED, IF ANY..... 3

5.4 3745-27-13 (E) (5) (D) IF THE SITE IS A SOLID WASTE FACILITY, THE SINGLE COUNTY OR JOINT COUNTY SOLID WASTE MANAGEMENT DISTRICT..... 4

5.5 3745-27-13 (E) (5) (E) THE LOCAL FIRE DEPARTMENT FOR THE GEOGRAPHICAL AREA WHERE THE SITE IS LOCATED. 4

6.0 3745-27-13 (E) (6) A DISCUSSION OF THE SITE'S PRESENT OR KNOWN PRIOR USE OF HAZARDOUS WASTE OR SOLID WASTE TREATMENT, STORAGE OR DISPOSAL, INCLUDING A SUMMARY AND DISCUSSION OF ALL AVAILABLE DOCUMENTATION PERTAINING TO THE DATES OF OPERATION, TYPES AND QUANTITIES OF WASTE HANDLED AT THE SITE, AND OWNERSHIP..... 4

7.0 3745-27-13 (E) (7) A DETAILED DISCUSSION OF THE CLOSURE AND/OR POST-CLOSURE ACTIVITIES, IF ANY, PERFORMED AT THE FACILITY AND AN EVALUATION OF THE PRESENT CONDITION OF THE CLOSED FACILITY..... 5

8.0 3745-27-13 (E) (8) A DETAILED DESCRIPTION OF THE MANNER BY WHICH THE PROPOSED FILLING, GRADING, EXCAVATING, BUILDING, DRILLING, OR MINING WILL BE ACCOMPLISHED..... 6

9.0 3745-27-13 (E) (9) A DETAILED DESCRIPTION OF THE MANNER IN WHICH THE INTEGRITY OF THE WASTE PLACEMENT OR THE ANCILLARY STRUCTURES WILL BE PRESERVED WHERE THE FILLING, GRADING, EXCAVATING, BUILDING, DRILLING, OR MINING ACTIVITIES WILL OCCUR IN AREAS WITHIN THREE HUNDRED FEET OF THE LIMITS OF WASTE PLACEMENT. 6

10.0 3745-27-13 (E) (10) A DETAILED PLAN DESCRIBING THE MANNER BY WHICH THE PROPOSED FILLING, GRADING, EXCAVATING, BUILDING, DRILLING, OR MINING WILL BE ACCOMPLISHED IN COMPLIANCE WITH ALL APPLICABLE STATE AND FEDERAL LAWS AND REGULATIONS PERTAINING TO ENVIRONMENTAL PROTECTION, INCLUDING BUT NOT LIMITED TO CONTROL OF AIR EMISSIONS,



CONTROL OF LEACHATE, SURFACE WATER RUN-ON AND RUN-OFF, EXPLOSIVE AND TOXIC GAS MIGRATION, AND PROTECTION OF GROUND WATER.	7
10.1 GROUNDWATER.....	7
10.2 AIR EMISSIONS	7
10.3 SURFACE WATER RUN-ON/RUN-OFF	8
10.4 REGULATORY INVOLVEMENT.....	8
11.0 3745-27-13 (E) (11) IF WASTE WILL STILL REMAIN ON THE PROPERTY, A DETAILED DESCRIPTION OF A NOTATION OR UPDATE TO ANY PRIOR RECORDED NOTATION TO BE PLACED ON THE DEED TO THE PROPERTY TO NOTIFY IN PERPETUITY ANY POTENTIAL PURCHASER OF THE PROPERTY THAT THE LAND HAS BEEN USED AS A HAZARDOUS WASTE FACILITY OR SOLID WASTE FACILITY. THE NOTATION SHALL DESCRIBE THE IMPACTED ACREAGE, INCLUDING THE KNOWN LOCATION, DEPTH, VOLUME, AND NATURE OF WASTE DISTURBED AT THE SITE.....	8
12.0 3745-27-13 (E) (12) OTHER SUCH INFORMATION AS OHIO EPA DEEMS NECESSARY TO DETERMINE THAT THESE ACTIVITIES WILL BE IN COMPLIANCE WITH ALL APPLICABLE LAWS AND REGULATIONS ADMINISTERED BY THE DIRECTOR.	8
13.0 3745-27-13 (E) (13) A SIGNATURE AS DESCRIBED IN PARAGRAPH (I) OF THIS RULE.....	9

1.0 3745-27-13 (E) (1) The location specified on a 7-1/2 minute USGS topographical map and on a topographic map with a maximum scale of one inch equals two hundred feet, legal description, type of facility, demonstration of current property ownership, and demonstration of current facility ownership.

The subject property is located in the City of Westlake, Cuyahoga County, Ohio and owned by the City of Westlake. The site is located near the intersection of Bassett Road and Ranney Parkway (Figure 1), approximately 0.5 to 1.0 miles north of Interstate Route 90. The topography of the site is generally flat (Figure 2), but with adequate slopes to promote positive drainage. The site, formerly part of the Westlake Sanitary Landfill (SLF), an unlined municipal solid waste disposal facility, and now a recreation area, including four baseball/softball diamonds is bounded by a City haul road to the north, by Ranney Parkway to the south and City property, both developed and undeveloped to the west. The City's permitted yard waste composting facility is located to the east.

More details on the property boundaries are included in the legal description included in Appendix A. As demonstrated by the deed for the property and records from the County Recorder (Appendix B) and landowner acknowledgment letter (Appendix C), and Ohio EPA records, the facility and property are entirely owned by the City of Westlake. The project site is entirely within the area represented by Permanent Parcel Number 212-1-5.

2.0 3745-27-13 (E) (2) The specific activities and their intended purposes for which authorization is requested.

This request is specifically for installation of a passive gas venting trench to be located in the southwest corner of the landfill. This trench will extend a depth of approximately 12 feet. The trench will be backfilled with ODOT #57 free-draining gravel. Vertical riser pipes will be installed approximately every 20 to 30 feet. Riser pipes will be constructed of 6-inch diameter perforated PVC pipe to within two feet of the ground surface. The vents will be completed with 4-inch diameter solid PVC pipe to a height of 4 to 6 feet above grade. They will be completed at surface in a manner that will allow venting while keeping rain and/or snow out. Details of the proposed trench and location are included in Figures 2 and 3.

Trench installation will be completed using a hydraulic excavator, likely by City personnel. During excavation, explosive gas levels will be monitored regularly at the surface. In the event that the LEL exceeds 10% work will be stopped and the area allowed to vent.

Excavation spoils will be direct loaded into city dump trucks. Spoils will be visually screened. If the cuttings are soil that contains no garbage they will be stockpiled within the footprint of the landfill and used for landfill cap maintenance. If the spoils appear to contain anything other than soil, they will be placed into a roll-off box pending

characterization (including sampling and analysis), selection of appropriate waste disposal method, waste disposal facility and acceptance and Ohio EPA approval. No waste will leave the site until approval is received from the Ohio EPA.

3.0 3745-27-13 (E) (3) Discussion of all previous and existing permits, licenses, approvals, and orders pertaining to past and ongoing waste treatment, storage, or disposal activities issued under local, state, and federal environmental regulations for lands upon which authorization under this rule is requested.

The site as a whole was operated as an unlined municipal solid waste landfill from approximately 1958 to approximately 1989. Review of OEPA files indicates that no enforcement action was ever taken against the City during operation of the landfill. The facility as a whole was licensed as required by the OEPA during its period of operation.

The portion of the landfill to which this request applies was closed in approximately 1980 in accordance with the 1976 closure rules, following an approved closure plan. Other areas of the landfill were closed later, always in accordance with OEPA approved closure plans and regulations in effect at the time the closure was performed. Currently the facility is performing post-closure monitoring in accordance with approved plans. Post-closure monitoring includes semi-annual groundwater sampling and routine monitoring of methane detection wells. Results of these activities are reported to the OEPA. The City along with the CCBOH performs monthly self-inspections. The City routinely submits reports of these activities to the CCBOH and the OEPA. In the future, these submissions will be made using a means that can be tracked and documented.

The City of Westlake has applied for, and received, authorization under OAC 3745-27-13 for other activities at the greater landfill site. Specifically, in 1990 authorization was granted for use of a 12-acre east of Roman Park for part of the City's yard waste recycling program. In 1993, authorization was given for additional yard waste recycling activities north of Roman Park. Both of these areas (north and east of the Roman Park) have been designated as a single area by the OEPA. As stated elsewhere, the ball diamonds and other aspects of Roman Park were constructed prior to Rule 13 requirements.

In June of 2003 the City received authorization under Rule 13 for the drilling and sampling of soil borings around a water line installed at the landfill to serve the ball diamonds. This drilling was performed in July of 2003 to verify a minimum separation between waste and the water line of 2 feet. The water line, sanitary and storm sewer systems installed at Roman Park were installed at the time of Park construction in the early 1980s. This was prior to the promulgation of Rule 13.

In November of 2004 the City notified the OEPA of its intent to drill and sample soil borings in the proposed location of new foul poles at the ball diamonds. At this time,

drilling and sampling was also performed around an existing picnic pavilion to document the thickness of structural fill and cap material.

In 2007 Pyramid Network Communications received authorization under Rule 13 to drill and sample exploratory soil borings in the proposed location of a monopole wireless communication tower. Two borings were drilled in December 2007.

Composting operations are performed in areas where authorization has been received under OAC 3745-27-13, as discussed above. These operations are acknowledged by the OEPA as a Class IV Composting Facility under registration ID Number 18-4-0076. This registration was received by the OEPA on November 12, 1993. The City also has a permitted transfer station north and west of Roman Park. This facility is used for transferring road sweepings and similar debris only, as the City entered into an agreement with a private trash hauler in the summer of 2002. Under this agreement, household trash is collected curbside and hauled directly to the disposal facility. It should be noted that neither the transfer station nor the yard waste composting areas are located within the work area to which this authorization is being requested.

4.0 3745-27-13 (E) (4) Letters of acknowledgment from the owners of all parcels of land to which the authorization pertains.

The subject site and facility are entirely owned by the City of Westlake (Appendix C). Evaluation of the site does not suggest impact to any abutting, or other, landowners from the activities proposed herein.

5.0 3745-27-13 (E) (5) Copies of certified mail receipts and a statement certifying that letters of notice stating that authorization under this rule is being requested for the affected site have been sent to the following entities:

5.1 3745-27-13 (E) (5) (a) The board of health of the health district wherein the site is located.

Notice to the Board of Health is included in Appendix D.

5.2 3745-27-13 (E) (5) (b) The governments of the general purpose political subdivisions where the site is located, i.e., county commissioner, legislative authority of a municipal corporation, and/or the board of township trustees.

Notice to the Mayor of the City of Westlake is included in Appendix D.

5.3 3745-27-13 (E) (5) (c) The local zoning authority having jurisdiction over the geographical area where the site is located, if any.

Notice to the Westlake Planning Department (the local zoning authority) is included in Appendix D.

5.4 3745-27-13 (E) (5) (d) If the site is a solid waste facility, the single county or joint county solid waste management district.

Notice to the Cuyahoga County Waste Management District is included in Appendix D.

5.5 3745-27-13 (E) (5) (e) The local fire department for the geographical area where the site is located.

Notice to the Westlake Fire Rescue Department is included in Appendix D.

6.0 3745-27-13 (E) (6) A discussion of the site's present or known prior use of hazardous waste or solid waste treatment, storage or disposal, including a summary and discussion of all available documentation pertaining to the dates of operation, types and quantities of waste handled at the site, and ownership.

The subject site was formerly part of the City of Westlake (SLF). The area of the site to which this request pertains was operated as a landfill from approximately 1958 through approximately 1979. During this period of operation only residential waste collected by City personnel was disposed of in the landfill. To the City's knowledge, City personnel did not collect industrial wastes, as industries within the City contracted with private haulers. Westlake could locate no records concerning industrial waste disposal at the Westlake Landfill, and believes that industrial wastes were not disposed of at the landfill.

From inception of operations in 1958 to approximately 1967, the landfill collected trash on a monthly or semi-monthly basis. During this period, the waste collected was largely "non-burnable" as personal incineration of trash was a legal and typical waste disposal method. After 1967, collection frequency was increased to biweekly, and later weekly. The increased collection frequency coincided with the phasing out of personal incineration. Waste was buried in long cells, of varying width, up to 75 or 100 feet that were separated by buffers approximately 15 feet wide.

According to City authorities, metal and steel items were always segregated. This included appliances and similar large items. These materials were not buried with other wastes but were sent for recycling.

The City had a permitted solid waste transfer facility at another area of the landfill. This concrete pad was formerly used to transfer solid waste from City-owned vehicles to dump trailers used to transport the collected solid waste to the final disposal location. These operations were stopped in the fall of 2002 as a result of the City privatizing garbage collection. Currently, solid waste collected curbside is direct-hauled to an off-site landfill. The transfer facility is now permitted, and used, as part of the City's leaf collection program.

The City has a yard waste composting operation at another area of the closed landfill facility. As mentioned above, these operations are conducted in areas where the OEPA



has granted authorization under OAC-3745-27-13 and has acknowledged receipt of registration for these composting operations. As mentioned elsewhere herein, these composting activities are permitted by the OEPA.

7.0 3745-27-13 (E) (7) A detailed discussion of the closure and/or post-closure activities, if any, performed at the facility and an evaluation of the present condition of the closed facility.

All closure activities were performed in accordance with approved plans, and the regulations applicable at the time of closure. The area of the landfill, to which this request applies, was closed prior to 1980 and in accordance with the 1976 closure requirements (other areas of the landfill were closed later and in accordance with approved closure plans consistent with regulations in place at the time of closure). Furthermore, this specific area has been in use as a ball field since the early 1980s.

The area of the landfill that this request pertains to was closed with over 6 feet of cover. This includes at least 2.5 feet of daily cover over the last waste placed in the fill and approximately 3.5 feet of low permeability fill used as final cover, according to City personnel familiar with the closure. Topsoil was then placed over the fill to support vegetation.

Maintenance of the cover includes occasional leveling to maintain ball field conditions. Any time grading is performed the City imports fill material to achieve the desired grades. No landfill cap or overlying material is ever disturbed during the performance of these routine maintenance activities.

The Westlake Fire Department formerly performed methane monitoring on a weekly basis in the past. The CCBOH formerly monitored methane levels on a quarterly basis. Methane is monitored in wells intended specifically for that purpose at the landfill. Currently the City monitors explosive gas migration in a series of well around the facility on a quarterly basis, in accordance with an OEPA approved Explosive Gas Monitoring Plan. This request has been prepared to request permission from the OEPA for the installation of passive gas venting wells to address elevated explosive gas measurements observed in Well GW3R.

Groundwater is monitored on a semi-annual basis by collection and analysis of samples from a set of seven monitoring wells installed around the site. Copies of these monitoring results are on file with the Ohio EPA as required.

The subject site is currently in use as a ballpark. The area is generally flat, with adequate grading to allow runoff. No ponding was observed during a March 2016 site visit. In addition, no offensive odors were noticed.

The ballpark area of the landfill, to which this request pertains, is generally grass covered, with the following exceptions:

- Roadways and parking areas – these areas are mostly gravel paved, although there appears to be some asphalt in limited, random, areas. They are routinely graded to ensure proper drainage
- Baselines and pitcher's mounds on the ball diamonds – these areas are sand or topsoil and are graded to ensure that there is no ponded water

In addition, some landscaped areas include trees and shrubs around the parking area. These are generally areas with only enough slope to ensure surface water flow.

The OEPA has indicated knowledge of overfilling complaints during the time of landfill operation. In addition, the OEPA has suggested that there were previously violations relative to the groundwater monitoring system at the landfill. The OEPA indicated in November 1999 that all deficiencies and/or violations relative to the groundwater monitoring system had been corrected.

9.0 3745-27-13 (E) (8) A detailed description of the manner by which the proposed filling, grading, excavating, building, drilling, or mining will be accomplished.

This request is specifically for installation of a passive gas venting trench to be located in the southwest corner of the landfill. This trench will extend a depth of approximately 12 feet. The trench will be backfilled with ODOT specification #57.5 draining gravel. A perforated horizontal pipe will be installed along the length of the trench above the seasonal high water level. Vertical riser pipes will be installed approximately every 20 feet. These solid riser pipes will be completed above grade as close to the existing fence as possible. They will be completed at surface in a manner that will allow venting while keeping rain and/or snow out. Details of the proposed trench and location are included in Figures 2 and 3.

Trench installation will be completed using a hydraulic excavator, likely by City personnel. During excavation, explosive gas levels will be monitored regularly at the surface. In the event that the LEL exceeds 10% work will be stopped and the area allowed to vent.

Excavation spoils will be direct loaded into city dump trucks. Spoils will be visually screened. If the cuttings are soil that contains no garbage they will be stockpiled within the footprint of the landfill and used for landfill cap maintenance. If the cuttings appear to contain anything other than soil, they will be placed into a yellow box pending characterization (including sampling and analysis), selection of appropriate waste disposal method, waste disposal facility and acceptance and Ohio EPA approval. No waste will leave the site until approval is received from the Ohio EPA.

9.0 3745-27-13 (E) (9) A detailed description of the manner in which the integrity of the waste placement or the ancillary structures will be preserved where the

*Amended
July 7, 2016
See attached
pages
ML*

filling, grading, excavating, building, drilling, or mining activities will occur in areas within three hundred feet of the limits of waste placement.

The nature of the proposed activities will require the breaching of the landfill cap. However, the cap will be restored in a manner that is at least as protective as the current cap (Figure 3). Any damage to the landfill cap caused by equipment movement or other construction related activities will be repaired promptly using onsite material reserved for cap repair and maintenance. No impact to any ancillary structures is anticipated. A description of these activities will be included in the certification report submitted once the work is complete, which will include a statement notarized by an authorized representative of the City that the work has been completed as required.

10.0 3745-27-13 (E) (10) A detailed plan describing the manner by which the proposed filling, grading, excavating, building, drilling, or mining will be accomplished in compliance with all applicable state and federal laws and regulations pertaining to environmental protection, including but not limited to control of air emissions, control of leachate, surface water run-on and run-off, explosive and toxic gas migration, and protection of ground water.

The following steps will be taken for protection of groundwater, limiting air emissions and surface water run-on/run-off during the proposed drilling.

10.1 Groundwater

The following steps will be taken to protect groundwater as a result of the proposed drilling operations:

- Work operations will be suspended in the event of heavy precipitation that might result in the flooding of an open trench. In this event, the trench will be protected with plastic sheeting or similar. Work will be performed in stages to minimize open areas and will not be performed in the event that significant precipitation is forecast.
- Excavated areas will be backfilled and covered daily.
- Excavation is anticipated to proceed through groundwater. When groundwater is encountered the excavator bucket will drain all water in the trench before bringing spoils to the surface.

10.2 Air Emissions

There are no anticipated air emissions associated with this project that would require permitting or other regulatory involvement. In the unlikely event that waste is encountered during drilling and a foul odor or other air emission is noted, the offensive material will be containerized immediately and the excavation sealed as quickly as possible.

10.3 Surface Water Run-On/Run-Off

Surface water run-on/run-off becomes an issue if surface water encounters waste and then becomes contaminated itself. Additionally, surface water run-on could enter an open excavation thereby possibly entering into the waste and causing additional leachate generation. Steps to protect the waste from this run-on are discussed above, in the Groundwater section. The following steps will be taken to reduce the likelihood of intermingling of surface water and waste, or any sample extracted:

- In the event of precipitation, the excavation will be protected as discussed above.
- In summary, all efforts will be made to keep waste or other samples from coming into contact with surface water.

10.4 Regulatory Involvement

In addition, the following agencies have been contacted, and have confirmed that the activities performed to date, and proposed do not require any additional permits:

- The local Air Pollution Control Authority (City of Cleveland, Division of Engineering – Mr. David Hearne) indicated on September 20, 2001 that no air permit was needed for proposed construction activities given the temporary nature of the operations.
- Discussions with Mr. Dan Bogoevsky of the Ohio EPA Northeast District Office on September 20, 2001 confirm that no stormwater permit is required for this construction, as the area of disturbance is less than 5 acres. Since that time the regulatory requirement for stormwater permits at construction sites have changed. The new area of disturbance, above which a permit is required, is 1 acre. The subject site still falls beneath this requirement.

11.0 3745-27-13 (E) (11) If waste will still remain on the property, a detailed description of a notation or update to any prior recorded notation to be placed on the deed to the property to notify in perpetuity any potential purchaser of the property that the land has been used as a hazardous waste facility or solid waste facility. The notation shall describe the impacted acreage, including the known location, depth, volume, and nature of waste disturbed at the site.

The required notice was placed on the property deed as part of another project at the Site. A copy of the deed notice is included in Appendix B

12.0 3745-27-13 (E) (12) Other such information as Ohio EPA deems necessary to determine that these activities will be in compliance with all applicable laws and regulations administered by the director.

No other information is provided at this time.



13.0 3745-27-13 (E) (13) A signature as described in paragraph (I) of this rule.

This document is signed by a principal executive officer of at least the level of vice president, or his duly authorized representative if such representative is responsible for the overall operation of the site, of the City of Westlake.

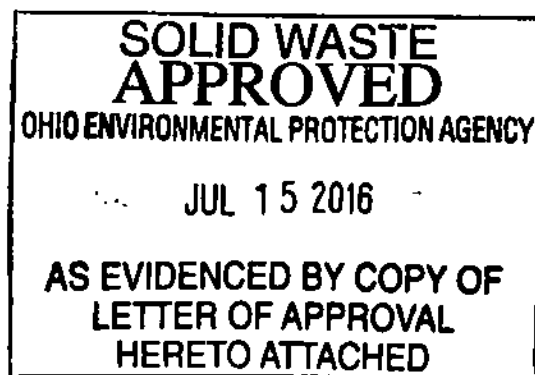



The following signature constitutes a personal affirmation that all statements or assertions of fact made in the foregoing application are true and complete and comply fully with applicable state requirements, and shall subject the signatory to liability under applicable state laws forbidding false or misleading statements.

Paul J. Quinn III

Principal (Print name)

3/30/16

Date

[Handwritten Signature]

Signature

Director of Public Service

Title

Note: The above signature shall be notarized separately with the following statement.

STATE OF OHIO COUNTY OF CUYAHOGA

Sworn to and subscribed before me by PAUL J. QUINN III on this date MARCH 30, 2016. My commission expires 12/5/2016.

Gayle Hill

Notary Public (Print name)

[Handwritten Signature]

Signature

3/30/2016

Date

GAYLE HILL
Notary Public, State of Ohio
My Commission Expires 12/5/2016

Stamp/Seal

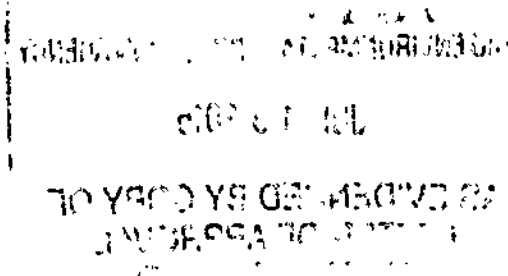

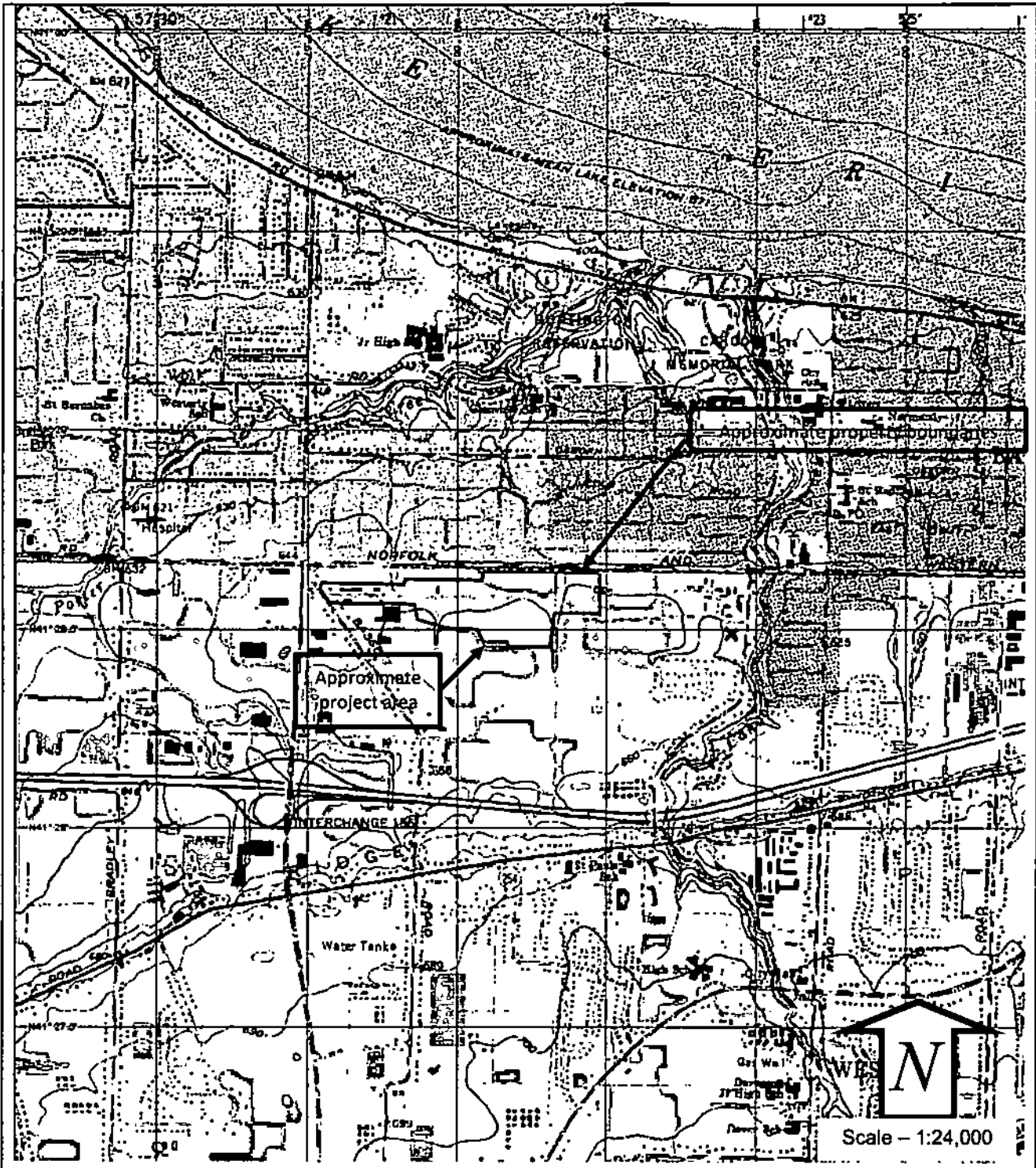

FIGURE 1

SITE LOCATION MAP

REQUEST FOR AUTHORIZATION TO ENGAGE
IN CONSTRUCTION ACTIVITIES AT THE
FORMER CITY OF WESTLAKE SANITARY
LANDFILL PURSUANT TO OAC 3745-27-13

SOURCE:

USGS - North Olmsted Ohio
7.5 minute topographic
quadrangle map

DATE:

July 2010

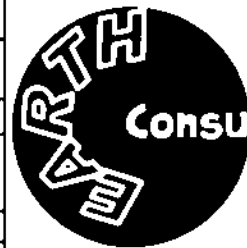

Consulting, Ltd.

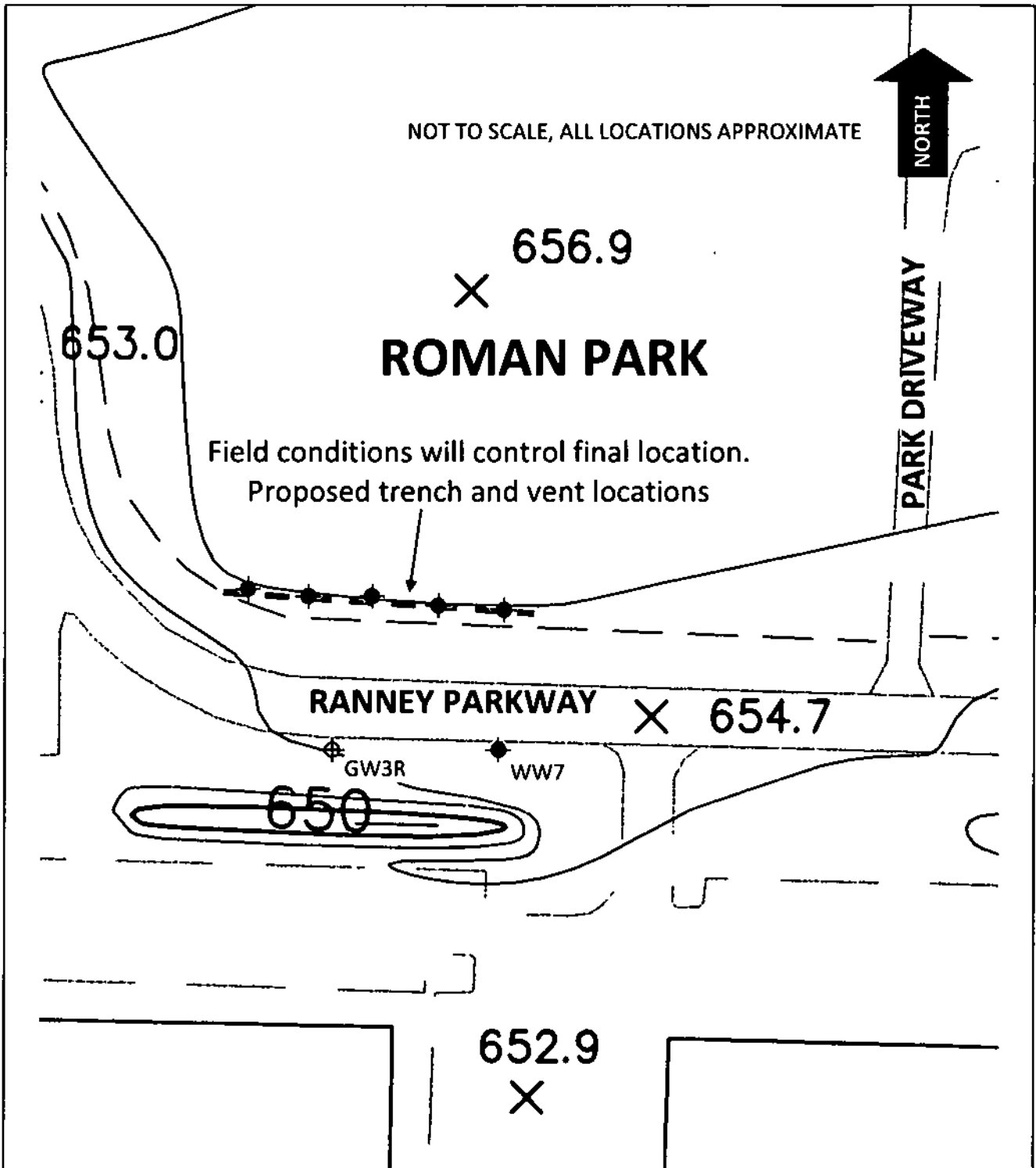

FIGURE 2

PROPOSED PASSIVE GAS VENT LOCATION

CITY OF WESTLAKE
CLOSED LANDFILL
SOUTHWEST CORNER EXPLOSIVE GAS
CONTROL PROJECT

SCALE

Not drawn to scale – do not
scale from this drawing.

DATE:

March 2016



Consulting, Ltd.

Amended July 7, 2016 *mu*
 See attached pages

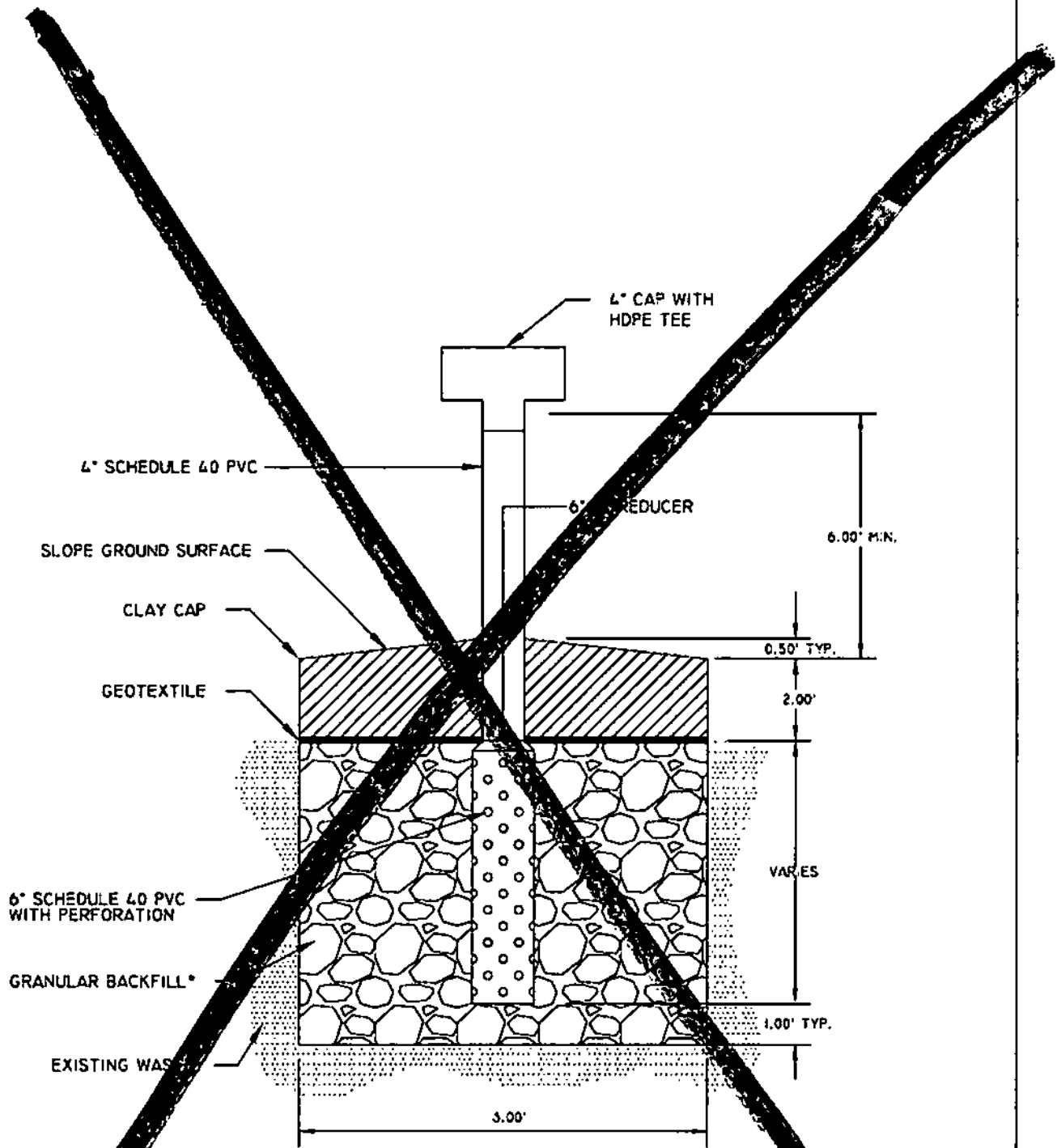

FIGURE 3

PROPOSED PASSIVE GAS WELL DESIGN

REQUEST FOR AUTHORIZATION TO ENGAGE IN
 CONSTRUCTION ACTIVITIES AT THE FORMER
 CITY OF WESTLAKE SANITARY LANDFILL
 PURSUANT TO OAC 3745-27-13

SCALE

Not drawn to scale - do not
 scale from this drawing.

DATE:

March 2016



In Witness Whereof, I have hereunto set my hand, the 18th day of February, in the year of our Lord one thousand nine hundred and fifty-eight

Signed and acknowledged in the presence of

John Farkas
D. E. Lloyd

Molly Farkas

STATE OF OHIO

Cuyahoga

County,

Before me, a Notary Public

in and for said County and State, personally appeared the above named Molly Farkas, (widow)

who acknowledged that she did sign the foregoing instrument and that the same is her free act and deed.

In Testimony Whereof, I have hereunto set my hand and official seal, at Cleveland, Ohio this 18 day of February A. D. 1958

Stanley E. Lloyd
STANLEY E. LLOYD - Notary Public

100
199607
WARRANTY DEED
FROM *Westlake*
Molly Farkas, (widow) 212
1
5

Municipality of Westlake

2 - *Westlake* 29 15

RECEIVED FOR RECORD

at **RECEIVED FOR RECORD** 19

Recorded AT 307P 19

In MAR 4 1958 County Records

Volume RECORDED IN CUYAHOGA COUNTY RECORDS

Vol. 106 P. 558 FRANK'S DAY RECORDER County Recorder

ENTERED FOR TRANSFER MAR 4 1958 19

John G. P.
This instrument prepared by:
Strangward & Llewellyn Auditt
Attorneys at Law
1209 National City Bank Bldg.
Cleveland 14, Ohio
CHERRY 1-1204

The Ohio Legal Blank Co., Cleveland
152302-87293 DC

2-0473 SP 684.20 NE P 14 1/2 x 18 10.71' REAR OF BACCHETT LN

do give, grant, bargain, sell and convey unto the said Grantee, ^{successors} its ~~and~~ assigns, the following described premises, situated in the Municipality of Westlake County of Cuyahoga and State of Ohio:

Parcel No. 1. and known as being part of Original Dover Township Lot No. 74, and bounded and described as follows: Beginning on the Westerly line of said Original Lot No. 74, at its point of intersection with the Northerly line of land conveyed to John Henry Siek and Mary Siek by deed dated April 14, 1914, and recorded in Volume 1578, Page 28 of Cuyahoga County Records; thence Northerly along said Westerly line of original Lot No. 74, about 826-21/100 feet to the Northwesterly corner of land conveyed to Saul Green by deed dated May 20, 1922, and recorded in Volume 2631, Page 487 of Cuyahoga County Records; thence Easterly along the Northerly line of land so conveyed to Saul Green, 825-14/100 feet to the Westerly line of land conveyed to W. W. Dodd, and Clifton I. Aldrich by deed dated October 18, 1919, and recorded in Volume 2476, Page 339, of Cuyahoga County Records; thence Southerly along the Westerly line of land so conveyed to W. W. Dodd and Clifton I. Aldrich to the Northerly line of land conveyed to John Henry Siek and Mary Siek as aforesaid; thence Westerly along said Northerly line 825 feet to the place of beginning, and containing about 15.72 acres of land, and

Parcel No. 2. and known as being part of Original Dover Township Lot No. 73, bounded as follows: Beginning at an iron pin in the Northerly line of premises conveyed to Dittrick Woehrman by deed recorded in Volume 4473, Page 359, Cuyahoga County Records, which iron pin is distant South 88° 30' East, 400-00/100 feet from the center line of Bassett Road; thence North 1° 30' East, 140-59/100 feet to an iron pin; thence South 88° 36' 41" East, 1810-71/100 feet to the Easterly line of said Original Lot No. 73; thence South 2° 04' West along the Easterly line of said Original Lot, 144-12/100 feet to a stone monument; thence North 88° 30' West along the Northerly line of premises conveyed to Dittrick Woehrman, as aforesaid, 1809-28/100 feet to the beginning, and containing 5-9152/10000 Acres of land, according to the survey of Charles W. Root, Registered Professional Engineer and surveyor, together with the Sello's easement in the common driveway, a strip of land, 16 feet in width, extending from the Westerly line of the above described premises, Westerly to the Easterly line of Bassett Road; the Northerly line of said common driveway being the Westerly prolongation of the Northerly line of the above described premises,



be the same more or less, but subject to all legal highways.

CUYAHOGA COUNTY RECORDER
PATRICK J. O'MALLEY
DEAF 03/05/2008 02:37:22 PM
200508050736

AFFIDAVIT OF FACTS RELATING TO TITLE
(ORC 5201.252)

STATE OF OHIO)
COUNTY OF CUYAHOGA)^{SS}

Now comes the undersigned, Honorable Dennis M. Clough and being duly sworn, deposes and states as follows that:

1. He is the duly elected Mayor of, City of Westlake, Cuyahoga County, Ohio;
2. The City of Westlake is the recorded owner of certain real estate in the City of Westlake, Ohio being Permanent Parcel No. 212-01-005;
3. This affidavit is given to create perpetual notice upon the real estate records of Cuyahoga County, Ohio that said land has been used as a part of a municipal solid waste landfill facility; and
4. Information as to said landfill facility is as follows;
 - a. Limit of waste acreage in this parcel is approximately 16 acres, approximately 13 of which contains waste;
 - b. Location of landfill and limit of waste placement in this Parcel is shown on Exhibit "A" attached hereto and incorporated herein;
 - c. Waste is covered by approximately six (6) feet of low permeability soil. Waste thickness varies from approximately two (2) to fifteen (15) feet.
 - d. Waste volume in the landfill on this Parcel is approximately one hundred seventy-seven thousand (177,000) cubic yards; and
 - e. Landfill contents consist of municipal solid waste collected from the residents of Westlake from approximately 1958 to approximately 1989.

FURTHER AFFIANT SAYETH NAUGHT.

Dennis M. Clough, Mayor

The above referenced Dennis M. Clough, Mayor personally appeared before me and signed the foregoing document in my presence upon his oath and/or affirmation on this 14th day of July 2005.

(seal)

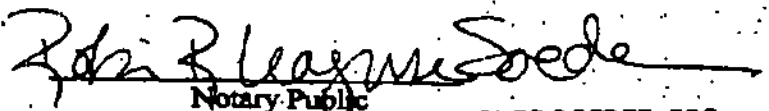
Notary Public

ROBIN R. LEASURE SOEDER, ESQ.
Notary Public, State of Ohio
My Comm. Has No Expir. Date
Section 147.03 R.C.

CUYAHOGA COUNTY RECORDER
200508050736 PAGE 1 of 1

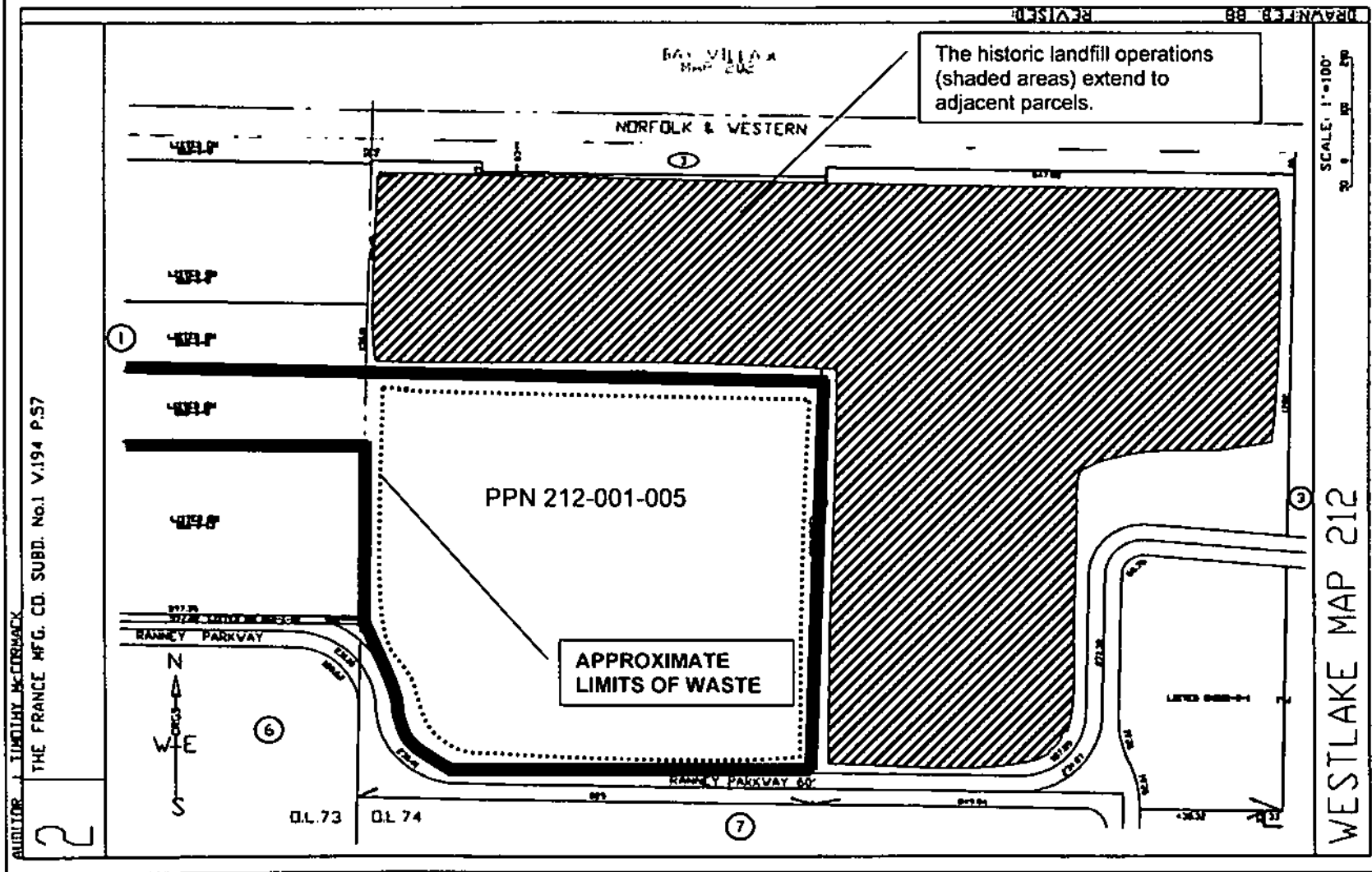

EXHIBIT A

TAX MAP SHOWING DEEDED PARCEL AND AREA OF WASTE PLACEMENT IN THAT PARCEL

REQUEST FOR AUTHORIZATION TO ENGAGE IN CONSTRUCTION ACTIVITIES AT THE FORMER CITY OF WESTLAKE SANITARY LANDFILL PURSUANT TO OAC 3745-27-13

SOURCE:
Cuyahoga County Auditor
DATE:
February 2004



Legal Description

Situated in the City of Westlake, County of Cuyahoga and State of Ohio and known as being part of Original Dover Township Lot No. 74 and being bounded and described as follows:

Beginning at a point being the southwesterly corner of Permanent Parcel Number 212-02-001;

Thence easterly approximately 825.14 feet along the southwesterly line of said parcel to southwesterly corner thereof said point also being in the westerly line of Permanent Parcel Number 212-02-002;

Thence easterly along a line being south of and parallel to the northerly line of said parcel 350 feet to a point;

Thence northerly along a line 350 feet east of and parallel to the westerly line of said parcel to its intersection with the northerly line thereof;

Thence westerly along the northerly line of said parcel 350 feet to the northwesterly corner thereof;

Thence southerly along the westerly line of said parcel 19 feet to a point said also being the northeasterly corner of Permanent Parcel Number 212-02-001;

Thence westerly along the northerly line of said Parcel approximately 634.28 feet to an angle point therein;

Thence northerly along said northerly line 19 feet to an angle point therein;

Thence westerly along said northerly line approximately 190 feet to a point also being the northwesterly corner of Permanent Parcel 212-02-001;

Thence southerly along the westerly line of said Parcel to the southwesterly corner thereof said point being the place of beginning be the same more or less but subject to all legal highways.

*This legal description was provided to
EARTH Consulting, Ltd. by the City of
Westlake, and is included as received.*

The City of *Westlake* Ohio

DENNIS M. CLOUGH, MAYOR



www.cityofwestlake.org

DEPARTMENT OF PUBLIC SERVICE

27700 Hilliard Blvd.
Westlake, OH 44145

Phone 440.871.3300
Fax 440.617.4229

March 29, 2016

Mr. Fraser K. Hamilton, PG
EARTH Consulting, Ltd.
300 E. 210th St.
Euclid, Ohio 44123

Re: Letter of Acknowledgement
Rule 13 Request – Explosive Gas Venting Wells
Landowner and Facility Owner

Dear Mr. Hamilton:

Pursuant to Ohio Administrative Code (OAC) 3745-27-13(C)(1) and (C)(4), the City of Westlake is both the property and facility owner of the Westlake Sanitary Landfill facility, located on Bassett Road at Ranney Parkway in the City of Westlake, Cuyahoga County. This letter is the City of Westlake's notice to you, in accordance with the requirements of OAC 3745-27-13 (E)(4) that we are aware that you are requesting authorization to engage in building on land where a solid waste facility was formerly operated from the Ohio Environmental Protection Agency. We understand that you are making this request on behalf of the City so that a passive gas venting trench can be installed.

Please do not hesitate to contact the undersigned with any questions or comments you might have.

Sincerely,

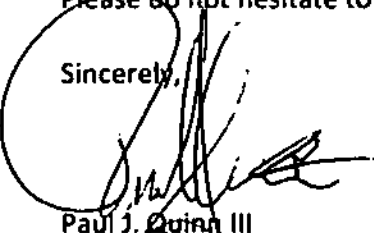
Paul J. Quinn III
Director of Public Service

Cc: File



Consulting, Ltd.

300 E 210th St.
Cleveland, Ohio 44123
216 410 3422
www.earthconsulting.org

March 17, 2016

Mr. John Romano, RS
Supervisor
Cuyahoga County Board of Health
5550 Venture Drive
Parma, Ohio 44130

Dear Mr. Romano:

On behalf of our client, the City of Westlake, EARTH Consulting, Ltd is providing notice to you, in accordance with the requirements of OAC 3745-27-13 (E)(5), that a request for *Authorization To Engage In Filling, Grading, Excavating, Building, Drilling, Or Mining On Land Where A Hazardous Waste Facility Or Solid Waste Facility Was Operated* (OAC 3745-27-13), is being submitted to the Ohio Environmental Protection Agency. This request is so that the City of Westlake might install a passive gas venting trench at the Roman Park recreation facility, the property described on the attached legal description and figure.

Please do not hesitate to contact the undersigned, or Mr. Chris Stuhm of the City of Westlake at (440) 835-6432 with any questions or comments you might have.

Respectfully yours,

EARTH CONSULTING, LTD

Mr. Fraser K. Hamilton, PG
Geologist

Legal Description

Situated in the City of Westlake, County of Cuyahoga and State of Ohio and known as being part of Original Dover Township Lot No. 74 and being bounded and described as follows:

Beginning at a point being the southwesterly corner of Permanent Parcel Number 212-02-001;

Thence easterly approximately 825.14 feet along the southwesterly line of said parcel to southwesterly corner thereof said point also being in the westerly line of Permanent Parcel Number 212-02-002;

Thence easterly along a line being south of and parallel to the northerly line of said parcel 350 feet to a point;

Thence northerly along a line 350 feet east of and parallel to the westerly line of said parcel to its intersection with the northerly line thereof;

Thence westerly along the northerly line of said parcel 350 feet to the northwesterly corner thereof;

Thence southerly along the westerly line of said parcel 19 feet to a point said also being the northeasterly corner of Permanent Parcel Number 212-02-001;

Thence westerly along the northerly line of said Parcel approximately 634.28 feet to an angle point therein;

Thence northerly along said northerly line 19 feet to an angle point therein;

Thence westerly along said northerly line approximately 190 feet to a point also being the northwesterly corner of Permanent Parcel 212-02-001;

Thence southerly along the westerly line of said Parcel to the southwesterly corner thereof said point being the place of beginning be the same more or less but subject to all legal highways.



Consulting, Ltd.

300 E 210th St.
Cleveland, Ohio 44123
216 410 3422
www.earthconsulting.org

March 17, 2016

Mr. Robert M. Parry
Director of Planning
City of Westlake
27700 Hilliard Boulevard
Westlake, OH 44145

Dear Mr. Parry:

On behalf of our client, the City of Westlake, EARTH Consulting, Ltd is providing notice to you, in accordance with the requirements of OAC 3745-27-13 (E)(5), that a request for *Authorization To Engage In Filling, Grading, Excavating, Building, Drilling, Or Mining On Land Where A Hazardous Waste Facility Or Solid Waste Facility Was Operated* (OAC 3745-27-13), is being submitted to the Ohio Environmental Protection Agency. This request is so that the City of Westlake might install a passive gas venting trench at the Roman Park recreation facility, the property described on the attached legal description and figure.

Please do not hesitate to contact the undersigned, or Mr. Chris Stuhm of the City of Westlake at (440) 835-6432 with any questions or comments you might have.

Respectfully yours,

EARTH CONSULTING, LTD

A handwritten signature in black ink, appearing to read "F. Hamilton", written over a horizontal line.

Mr. Fraser K. Hamilton, PG
Geologist

Legal Description

Situated in the City of Westlake, County of Cuyahoga and State of Ohio and known as being part of Original Dover Township Lot No. 74 and being bounded and described as follows:

Beginning at a point being the southwesterly corner of Permanent Parcel Number 212-02-001;

Thence easterly approximately 825.14 feet along the southwesterly line of said parcel to southwesterly corner thereof said point also being in the westerly line of Permanent Parcel Number 212-02-002;

Thence easterly along a line being south of and parallel to the northerly line of said parcel 350 feet to a point;

Thence northerly along a line 350 feet east of and parallel to the westerly line of said parcel to its intersection with the northerly line thereof;

Thence westerly along the northerly line of said parcel 350 feet to the northwesterly corner thereof;

Thence southerly along the westerly line of said parcel 19 feet to a point said also being the northeasterly corner of Permanent Parcel Number 212-02-001;

Thence westerly along the northerly line of said Parcel approximately 634.28 feet to an angle point therein;

Thence northerly along said northerly line 19 feet to an angle point therein;

Thence westerly along said northerly line approximately 190 feet to a point also being the northwesterly corner of Permanent Parcel 212-02-001;

Thence southerly along the westerly line of said Parcel to the southwesterly corner thereof said point being the place of beginning be the same more or less but subject to all legal highways.



300 E 210th St.
Cleveland, Ohio 44123
216 410 3422
www.earthconsulting.org

March 17, 2016

James Hughes
Chief
City of Westlake Fire Department
Administrative Offices
3200 Crocker Rd.
Westlake, Ohio 44145

Dear Chief Hughes:

On behalf of our client, the City of Westlake, EARTH Consulting, Ltd is providing notice to you, in accordance with the requirements of OAC 3745-27-13 (E)(5), that a request for *Authorization To Engage In Filling, Grading, Excavating, Building, Drilling, Or Mining On Land Where A Hazardous Waste Facility Or Solid Waste Facility Was Operated* (OAC 3745-27-13), is being submitted to the Ohio Environmental Protection Agency. This request is so that the City of Westlake might install a passive gas venting trench at the Roman Park recreation facility, the property described on the attached legal description and figure.

Please do not hesitate to contact the undersigned, or Mr. Chris Stuhm of the City of Westlake at (440) 835-6432 with any questions or comments you might have.

Respectfully yours,

EARTH CONSULTING, LTD

A handwritten signature in black ink, appearing to read "Fraser K. Hamilton", written over a horizontal line.

Mr. Fraser K. Hamilton, PG
Geologist

Legal Description

Situated in the City of Westlake, County of Cuyahoga and State of Ohio and known as being part of Original Dover Township Lot No. 74 and being bounded and described as follows:

Beginning at a point being the southwesterly corner of Permanent Parcel Number 212-02-001;

Thence easterly approximately 825.14 feet along the southwesterly line of said parcel to southwesterly corner thereof said point also being in the westerly line of Permanent Parcel Number 212-02-002;

Thence easterly along a line being south of and parallel to the northerly line of said parcel 350 feet to a point;

Thence northerly along a line 350 feet east of and parallel to the westerly line of said parcel to its intersection with the northerly line thereof;

Thence westerly along the northerly line of said parcel 350 feet to the northwesterly corner thereof;

Thence southerly along the westerly line of said parcel 19 feet to a point said also being the northeasterly corner of Permanent Parcel Number 212-02-001;

Thence westerly along the northerly line of said Parcel approximately 634.28 feet to an angle point therein;

Thence northerly along said northerly line 19 feet to an angle point therein;

Thence westerly along said northerly line approximately 190 feet to a point also being the northwesterly corner of Permanent Parcel 212-02-001;

Thence southerly along the westerly line of said Parcel to the southwesterly corner thereof said point being the place of beginning be the same more or less but subject to all legal highways.



Consulting, Ltd.

300 E 210th St.
Cleveland, Ohio 44123
216 410 3422
www.earthconsulting.org

March 30, 2016

The Honorable Dennis M. Clough
Mayor
City of Westlake
27700 Hilliard Blvd.
Westlake, Ohio 44145

On behalf of our client, the City of Westlake, EARTH Consulting, Ltd is providing notice to you, in accordance with the requirements of OAC 3745-27-13 (E)(5), that a request for *Authorization To Engage In Filling, Grading, Excavating, Building, Drilling, Or Mining On Land Where A Hazardous Waste Facility Or Solid Waste Facility Was Operated* (OAC 3745-27-13), is being submitted to the Ohio Environmental Protection Agency. This request is so that the City of Westlake might install a passive gas venting trench at the Roman Park recreation facility, the property described on the attached legal description and figure.

Please do not hesitate to contact the undersigned, or Mr. Chris Stuhm of the City of Westlake at (440) 835-6432 with any questions or comments you might have.

Respectfully yours,

EARTH CONSULTING, LTD

A handwritten signature in black ink, appearing to read "F. Hamilton", written over a horizontal line.

Mr. Fraser K. Hamilton, PG
Geologist

Legal Description

Situated in the City of Westlake, County of Cuyahoga and State of Ohio and known as being part of Original Dover Township Lot No. 74 and being bounded and described as follows:

Beginning at a point being the southwesterly corner of Permanent Parcel Number 212-02-001;

Thence easterly approximately 825.14 feet along the southwesterly line of said parcel to southwesterly corner thereof said point also being in the westerly line of Permanent Parcel Number 212-02-002;

Thence easterly along a line being south of and parallel to the northerly line of said parcel 350 feet to a point;

Thence northerly along a line 350 feet east of and parallel to the westerly line of said parcel to its intersection with the northerly line thereof;

Thence westerly along the northerly line of said parcel 350 feet to the northwesterly corner thereof;

Thence southerly along the westerly line of said parcel 19 feet to a point said also being the northeasterly corner of Permanent Parcel Number 212-02-001;

Thence westerly along the northerly line of said Parcel approximately 634.28 feet to an angle point therein;

Thence northerly along said northerly line 19 feet to an angle point therein;

Thence westerly along said northerly line approximately 190 feet to a point also being the northwesterly corner of Permanent Parcel 212-02-001;

Thence southerly along the westerly line of said Parcel to the southwesterly corner thereof said point being the place of beginning be the same more or less but subject to all legal highways.



Consulting, Ltd.

300 E 210th St.
Cleveland, Ohio 44123
216 410 3422
www.earthconsulting.org

March 17, 2016

Ms Diane Bickett
Executive Director
Cuyahoga County Solid Waste Management District
4750 East 131 Street
Garfield Heights, OH 44105-7130

Dear Ms Bickett:

On behalf of our client, the City of Westlake, EARTH Consulting, Ltd is providing notice to you, in accordance with the requirements of OAC 3745-27-13 (E)(5), that a request for *Authorization To Engage In Filling, Grading, Excavating, Building, Drilling, Or Mining On Land Where A Hazardous Waste Facility Or Solid Waste Facility Was Operated* (OAC 3745-27-13), is being submitted to the Ohio Environmental Protection Agency. This request is so that the City of Westlake might install a passive gas venting trench at the Roman Park recreation facility, the property described on the attached legal description and figure.

Please do not hesitate to contact the undersigned, or Mr. Chris Stuhm of the City of Westlake at (440) 835-6432 with any questions or comments you might have.

Respectfully yours,

EARTH CONSULTING, LTD

A handwritten signature in black ink, appearing to read "F. Hamilton", written over a horizontal line.

Mr. Fraser K. Hamilton, PG
Geologist

Legal Description

Situated in the City of Westlake, County of Cuyahoga and State of Ohio and known as being part of Original Dover Township Lot No. 74 and being bounded and described as follows:

Beginning at a point being the southwesterly corner of Permanent Parcel Number 212-02-001;

Thence easterly approximately 825.14 feet along the southwesterly line of said parcel to southwesterly corner thereof said point also being in the westerly line of Permanent Parcel Number 212-02-002;

Thence easterly along a line being south of and parallel to the northerly line of said parcel 350 feet to a point;

Thence northerly along a line 350 feet east of and parallel to the westerly line of said parcel to its intersection with the northerly line thereof;

Thence westerly along the northerly line of said parcel 350 feet to the northwesterly corner thereof;

Thence southerly along the westerly line of said parcel 19 feet to a point said also being the northeasterly corner of Permanent Parcel Number 212-02-001;

Thence westerly along the northerly line of said Parcel approximately 634.28 feet to an angle point therein;

Thence northerly along said northerly line 19 feet to an angle point therein;

Thence westerly along said northerly line approximately 190 feet to a point also being the northwesterly corner of Permanent Parcel 212-02-001;

Thence southerly along the westerly line of said Parcel to the southwesterly corner thereof said point being the place of beginning be the same more or less but subject to all legal highways.

RECEIVED
JUL 08 2016
OHIO EPA NEDO



300 East 210th Street
Euclid, Ohio 44123
(216) 410 3422 (Voice)
(216) 481 8278 (Fax)

July 7, 2016

Jarnal Singh
Ohio Environmental Protection Agency
2110 E. Aurora Road
Twinsburg, OH 44087-1969

Via email and overnight courier

Dear Mr. Singh:

In response to comments from the Ohio EPA regarding the subject submittal, EARTH Consulting, Ltd, on behalf of our client, the City of Westlake, have made certain modifications to the REQUEST FOR AUTHORIZATION to ENGAGE IN EXCAVATION ACTIVITIES AT A PORTION OF THE FORMER CITY OF WESTLAKE SANITARY LANDFILL pursuant to OAC 3745-27-13. We have addressed the Ohio EPA's comments by revising Figure 3 and section 8.0 of the text of the Request. We have enclosed only those revisions. In summary, we offer the following responses to the Ohio EPA comments:

Comment *Aggregate - Trade standards recommend the use of larger material without any fines, such as ODOT 2, 3, or 4 (ODOT Spec Manual, page 704).*

Response - The text has been revised to specify free-draining granular backfill that meets ODOT specifications for a 2, 3 or 4 gradation material.

Comment *Trench Location - It was not clear from the submitted documentation if the passive trench was to be placed in waste or at the interface of waste and native soils, such as at the limits of waste placement. Placement of the trench within waste may be problematic depending on the amount of waste material that may be between the trench and the outer limits of waste placement.*

Response - The text now includes a discussion of trench location relative to the perimeter fence and buried utilities in the adjacent public right of way. The City appreciates that removing waste and/or installing the trench in waste is not ideal and will make all efforts to minimize disturbance of waste and installation of a trench in same by installing the trench as close to the fence as possible.

Comment *Depth of Trench - The trench is proposed to be 12 feet deep, however the explosive gas management plan states the waste is at a depth of 12-25 feet. The trench should be designed to capture gas that may be migrating from the total waste depth of the landfill i.e. 25 feet deep.*

Received on July 8 2016 M4

Ohio EPA
July 7, 2016
Page 2

Response – The text includes clarification that at the south side of the landfill waste is only ± 12 feet deep, while at the north side it is deeper. Therefore, the depth of 12 feet in the area of the proposed trench is considered most appropriate.

Comment *Horizontal Connectors* - The proposed trench design does not incorporate the use of horizontal connectors between the vertical risers. While this construction is not a requirement, a horizontal connector placed in the trench maximizes its ability to passively vent gas along its entire length and affords the possibility of easily incorporating the trench into an active extraction system should future landfill gas generation conditions change.

Response – Figure 3 and the text have been updated to include this horizontal connector.

We trust that we have adequately addressed the Ohio EPA's comments and look forward to a prompt approval so that construction can begin as soon as possible.

EARTH Consulting, Ltd and the City of Westlake are committed to protection of human health and the environment. Please do not hesitate to contact the undersigned or Mr. Chris Stuhm at the City of Westlake with any questions or comments.

Sincerely,

EARTH CONSULTING, LTD.

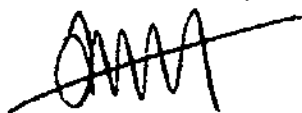

Fraser K. Hamilton PG
Owner/Geologist

Enclosures

cc: Mr. Paul Quinn, City of Westlake (email only)
Mr. Chris Stuhm, City of Westlake (email and hardcopy)
Mr. Doug Perisutti, Mannik Smith Group (email only)

Received on July 8, 2016 ML

8.0 3745-27-13 (E) (8) A detailed description of the manner by which the proposed filling, grading, excavating, building, drilling, or mining will be accomplished.

This request is specifically for installation of a passive gas venting trench to be located in the southwest corner of the landfill. This trench will extend a depth of approximately 12 feet. This depth is consistent with the depth of buried waste on the south side of the landfill. As the landfill was constructed, the trenches for waste burial were deepened to approximately 25 feet to the north. The proposed 12 foot depth for this trench on the south side of the landfill will provide a full exposure to the waste profile on this side of the landfill. The trench will be backfilled free-draining gravel meeting the gradation specification defined by the Ohio Department of Transportation (ODOT) for #2, #3 or #4 aggregate. A perforated horizontal pipe will be installed along the length of the trench above the seasonal high water level. Vertical riser pipes connected to the horizontal pipe will be installed approximately every 20 feet. These perforated riser pipes will be completed above grade as close to the existing fence as possible. They will be completed at surface in a manner that will allow venting while keeping rain and/or snow out. Details of the proposed trench and location are included in Figures 2 and 3.

Trench installation will be completed using a hydraulic excavator, likely by City personnel. During excavation, explosive gas levels will be monitored regularly at the surface. In the event that the LEL exceeds 10% work will be stopped and the area allowed to vent.

Excavation spoils will be direct loaded into city dump trucks. Spoils will be visually screened. If the cuttings are soil that contains no garbage they will be stockpiled within the footprint of the landfill and used for landfill cap maintenance. If the cuttings appear to contain anything other than soil, they will be placed into a roll-off box pending characterization (including sampling and analysis), selection of appropriate waste disposal method, waste disposal facility and acceptance and Ohio EPA approval. No waste will leave the site until approval is received from the Ohio EPA.

The proposed trench location is as far south as practically possible. Several buried utilities are present south of the limits of waste, including a trans-continental fiber optic cable and a high voltage electric service. The limits of waste are within feet of the fence that separates the landfill property from the public right-of-way. The proposed trench location is as far south as possible so as to avoid waste while avoiding the buried utilities without necessitating relocation of the fence, which would likely be impossible given the buried utilities. So, while it is not the intent of this project to encounter or remove waste, it is possible.

RECEIVED
JUL 10 2016
CITY OF CLEVELAND
DEPARTMENT OF PUBLIC WORKS
100 EAST 12TH AVE
CLEVELAND, OH 44115

Received on July 8, 2016 Mel.

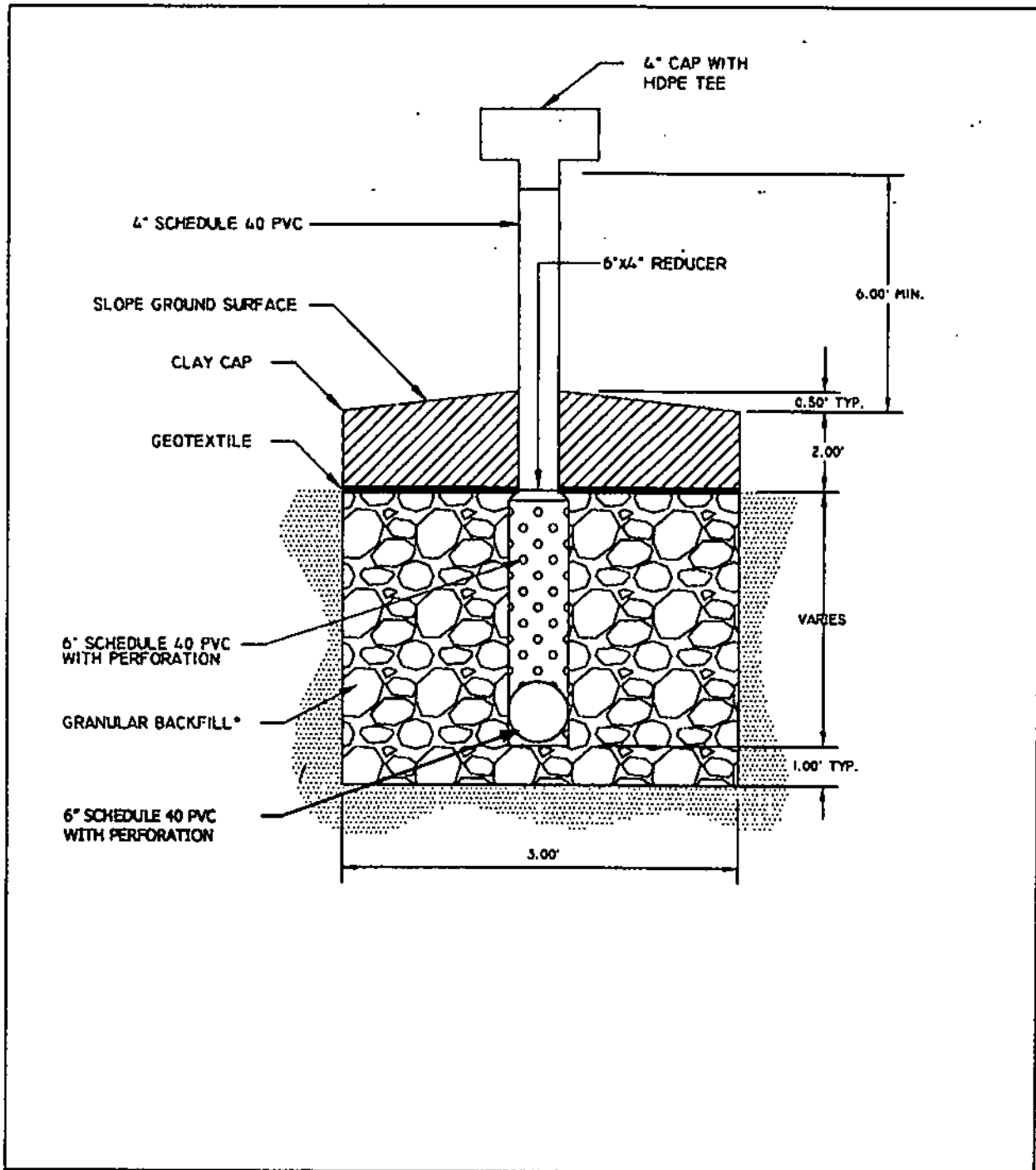

FIGURE 3	
PROPOSED PASSIVE GAS WELL DESIGN	
REQUEST FOR AUTHORIZATION TO ENGAGE IN CONSTRUCTION ACTIVITIES AT THE FORMER CITY OF WESTLAKE SANITARY LANDFILL PURSUANT TO OAC 3745-27-13	SCALE Not drawn to scale - do not scale from this drawing.
	DATE: March 2016 REVISED June 2016



SOLID WASTE APPROVED
 OHIO ENVIRONMENTAL PROTECTION AGENCY

JUL 15 2016
 AS EVIDENCED BY COPY OF
 LETTER OF APPROVAL
 HERETO ATTACHED