

RE: Kalida Village
Report
Drinking Water Program
Putnam County
PWS ID: OH6900512

Village of Kalida

110 S. Broad St.
P. O. Box 495
Kalida, OH 45853

RECEIVED

JAN 23 2017

OHIO E.P.A.
N.W.D.O.

Alan M. Gerdeman, Mayor
Rita Schroeder, Fiscal Officer

Council Members
Richard Schulte, Pres. Robert Buss
Jason Birkemeier Michael Stechschulte
Jon Edelbrock, Sandy Fortman

Phone 419-532-3899
Fax 419-532-3852

Board of Public Affairs
Ronald Knueve, Pres.
Roger Dickman
John Schimmoeller

January 20, 2017

To Whom It May Concern:

RE: Lead and Copper Program

Please find enclosed the information and map fulfilling HB 512 requirements.

The Village of Kalida is a small community with approximately five hundred and sixty service connections. There are old homes in the community and they are kept up nicely including plumbing with cpvc, therefore; it is difficult to find old copper pipes with old solder.

The Village has approximately fifty percent copper service lines and fifty percent plastic service lines. Any known plumbing apparatus would be the corp and curb valves that contain lead in the brass. The village has no lead service lines. Also, please find enclosed a list of sample sites (LC201 through LC213) with a brief description of each.

Please call with any questions 419-796-3899 or email kalidawater@bright.net.

Best regards,



Jeff Schroeder
Water Department Superintendent

Enclosed

List of Sample Sites

RECEIVED

JAN 23 2017

OHIO E.P.A.
N.W.D.O.

THE VILLAGE OF KALIDA HAS NO LEAD SERVICE LINES.

- LC 201 – Older home/ copper service line/ interior plumbing has been changed to CPVC
- LC 202 – built in late 70's / copper service line/ re-plumb to CPVC in the home
- LC 203 – building built in the 60's / copper service line/ plumbing all copper with CUPB L83
- LC 204 – built in early 70's / copper service line with CPVC plumbing
- LC 205 – built in early 80's / copper service line with CPVC plumbing
- LC 206 – built in 70's / copper service line with CPVC plumbing
- LC 207 – building/ copper line/ mixture of copper CUPB L83 and CPVC for interior plumbing
- LC 208 – home built in 90's with plastic service line and CPVC plumbing
- LC 209 – home built in 2000 with plastic service line and CPVC interior plumbing
- LC 210 – home built in 60's / copper service line with interior copper plumbing
- LC 211 – older home with copper/ plastic service line and interior plumbing a mixture of CPVC
And copper CUPB L83
- LC 212 – high school built in 2005/ plastic and iron service line/ interior plumbing all copper
- LC 213 – elementary school built in 2010/ plastic and iron service line/ interior plumbing all copper

VILLAGE OF KALIDA WATER MAP

UPDATED: JANUARY 29, 2016

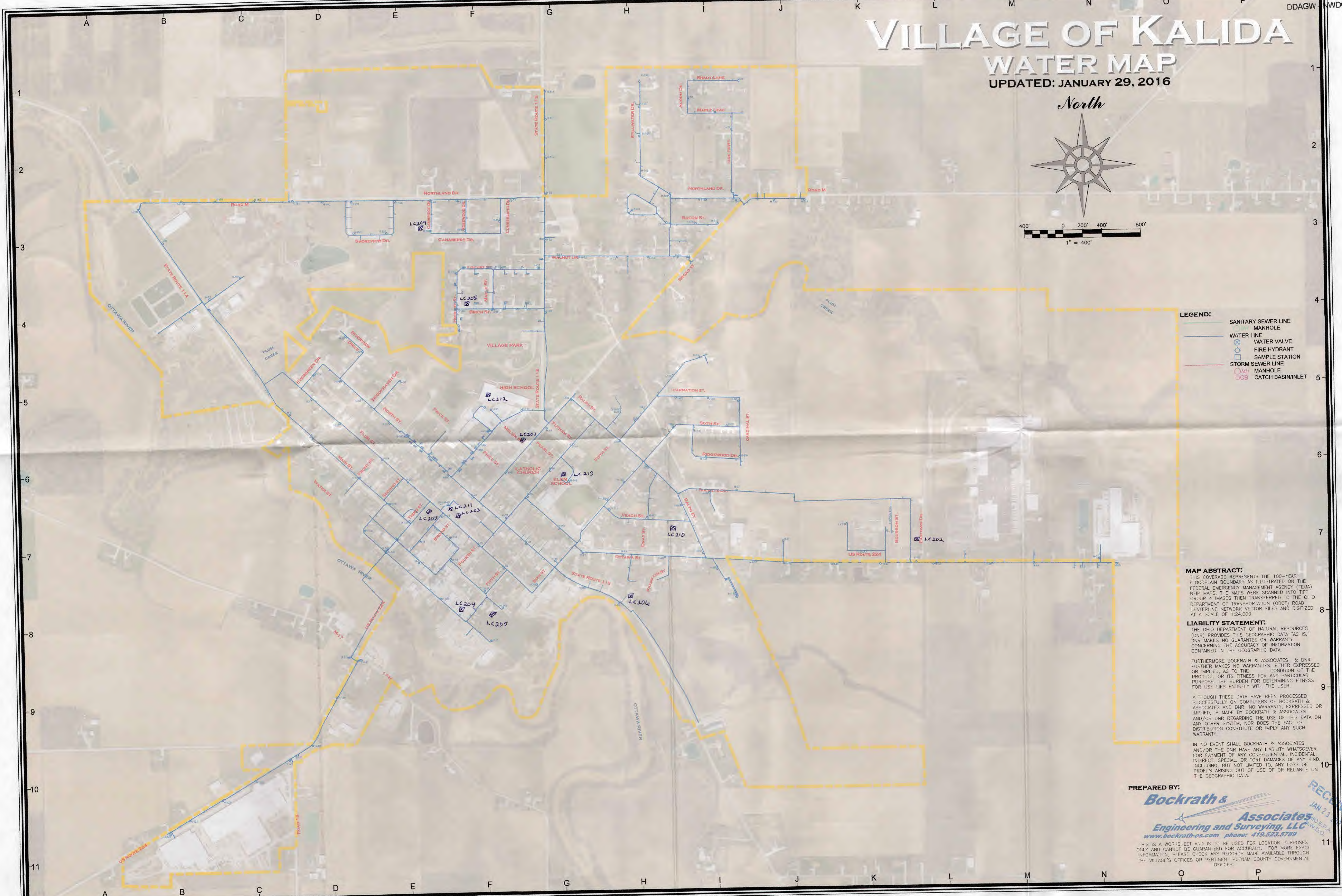

- LEGEND:**
- SANITARY SEWER LINE
 - WATER LINE
 - MANHOLE
 - WATER VALVE
 - FIRE HYDRANT
 - SAMPLE STATION
 - STORM SEWER LINE
 - MANHOLE
 - CATCH BASIN/INLET

MAP ABSTRACT:
THIS COVERAGE REPRESENTS THE 100-YEAR FLOODPLAIN BOUNDARY AS ILLUSTRATED ON THE FEDERAL EMERGENCY MANAGEMENT AGENCY (FEMA) NFIP MAPS. THE MAPS WERE SCANNED INTO TIFF GROUP 4 IMAGES THEN TRANSFERRED TO THE OHIO DEPARTMENT OF TRANSPORTATION (ODOT) ROAD CENTERLINE NETWORK VECTOR FILES AND DIGITIZED AT A SCALE OF 1:24,000.

LIABILITY STATEMENT:
THE OHIO DEPARTMENT OF NATURAL RESOURCES (DNR) PROVIDES THIS GEOGRAPHIC DATA "AS IS." DNR MAKES NO GUARANTEE OR WARRANTY CONCERNING THE ACCURACY OF INFORMATION CONTAINED IN THE GEOGRAPHIC DATA.

FURTHERMORE BOCKRATH & ASSOCIATES & DNR MAKE NO WARRANTIES, EITHER EXPRESSED OR IMPLIED, AS TO THE CONDITION OF THE PRODUCT, OR ITS FITNESS FOR ANY PARTICULAR PURPOSE. THE BURDEN FOR DETERMINING FITNESS FOR USE LIES ENTIRELY WITH THE USER.

ALTHOUGH THESE DATA HAVE BEEN PROCESSED SUCCESSFULLY ON COMPUTERS OF BOCKRATH & ASSOCIATES AND DNR, NO WARRANTY, EXPRESSED OR IMPLIED, IS MADE BY BOCKRATH & ASSOCIATES AND/OR DNR REGARDING THE USE OF THIS DATA ON ANY OTHER SYSTEM, NOR DOES THE FACT OF DISTRIBUTION CONSTITUTE OR IMPLY ANY SUCH WARRANTY.

IN NO EVENT SHALL BOCKRATH & ASSOCIATES AND/OR THE DNR HAVE ANY LIABILITY WHATSOEVER FOR PAYMENT OF ANY CONSEQUENTIAL, INCIDENTAL, INDIRECT, SPECIAL, OR TORT DAMAGES OF ANY KIND, INCLUDING, BUT NOT LIMITED TO, ANY LOSS OF PROFITS ARISING OUT OF USE OF OR RELIANCE ON THE GEOGRAPHIC DATA.

PREPARED BY:
Bockrath & Associates
Engineering and Surveying, LLC
www.bockrath-es.com phone: 419.523.5789

THIS IS A WORKSHEET AND IS TO BE USED FOR LOCATION PURPOSES ONLY AND CANNOT BE GUARANTEED FOR ACCURACY. FOR MORE EXACT INFORMATION, PLEASE CHECK ANY RECORDS MADE AVAILABLE THROUGH THE VILLAGE'S OFFICES OR PERTINENT PUTNAM COUNTY GOVERNMENTAL OFFICES.