

Warren Water Authority PWSID OH4102903 was formed in 1959 to furnish water service to homes located in the Upland Heights area of Southeastern Jefferson and Northeastern Belmont Counties. Currently there are about 180 customers. Water is purchased from the village of Yorkville. The system was initially installed in 1963. Prior to completion most homes relied on cisterns for water and some had private wells. There are no commercial or industrial customers served by the authority.

Initial construction utilized cast iron mains of 2" to 8" mains. All fire hydrants are installed on the 6" or larger mains. Original service lines were copper, based on inspection of many homes and inquiries of persons within the authority it is strongly believed there are no lead service lines within the service area. Bronze body corporation stops, curb boxes and water meters manufactured prior to 1998 were used. Per Janet Barth OEPA: "The use of copper pipe with bronze curb box valves, curb stops and meters will not mean you have to state you have lead service lines. As you have on the map, providing a description of what you have in the narrative will cover this issue. A verification form will need to be submitted by systems that state they have no lead service lines. This verification form is not yet available."

Lead content within homes is based on examination of property tax records of the residences within the district and those built prior to 1998 are assumed to contain lead solder or lead containing fixtures and are designated "lead". Homes where information could not be found on construction date are all presumed to contain lead solder with lead containing fixtures are also designated lead.

In 1983 a combination forced main and gravity sewer system was completed and most homes were tied into the sewer system. This allowed a further increase in customers. PVC laterals on the system were installed to accommodate these customers and service lines to the expanded customers are copper or HDPE.

The higher elevations experienced low water pressures and a new water tank/stand pipe was installed in 2003 another 7 homes were tied (Montenery Estates) into the system. These homes were on an extended aeration treatment for sewage treatment. These homes were tied into the authority's sewage collection system.

C:\Autocad\Projects\War... Water_System_Dwg\WWSD_03.dwg, 11/19/2004 3:37:21 PM, 1:200

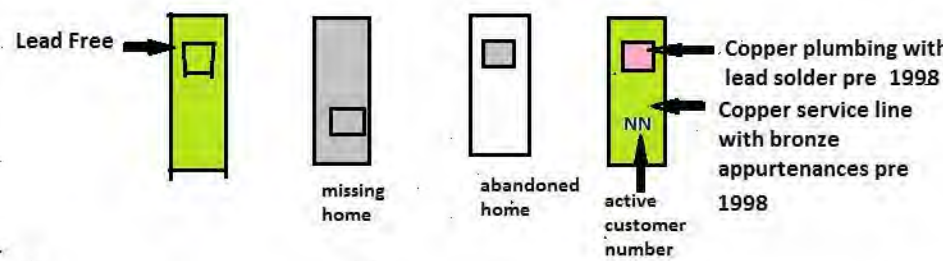

Edited by Richard A Coup 2/27/2017

Buildings in Ohio built prior to 1998 or that use plumbing material or solder manufactured before 1998 may have materials with greater than 8% lead and are at a higher risk of contributing lead to the drinking water than materials manufactured after 1998. In addition, buildings built and plumbing materials manufactured after 2014 were required to have less than 0.25% lead by weight and have the lowest risk for contributing lead to the drinking water. It should be noted however that, although prohibited, some use of leaded solder or leaded components may have occurred after the prohibitions became effective.

- NOTES:
- 1) THIS DRAWING WAS PART OF ORIGINAL RECORD DRAWING SET DATED OCTOBER 1963
 - 2) FOR DETAILS NOT SHOWN ON THIS SHEET, SEE DWG NO.4

WARREN WATER AUTHORITY
Upland Heights Water System
Jefferson County, Ohio

UPLAND HEIGHTS WATER SYSTEM
WATER SYSTEM MAP AND DETAILS
Map 2

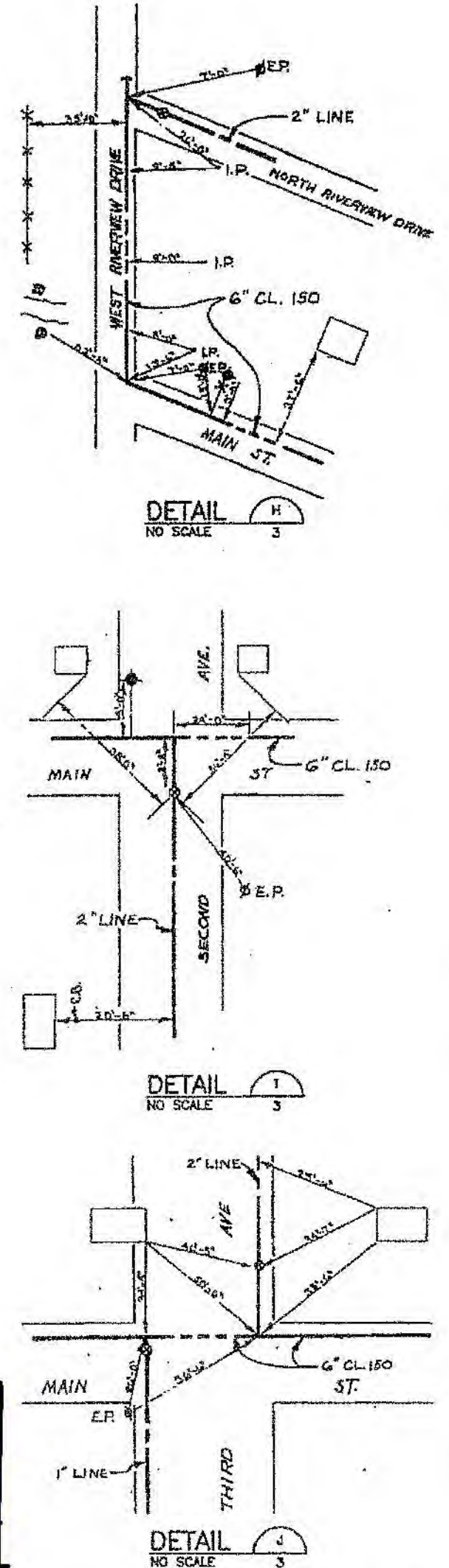

SCALE: 1"=100' (22'x34")
1"=200' (11"x17")
DATE: NOVEMBER 2004
PROJECT NO. 11

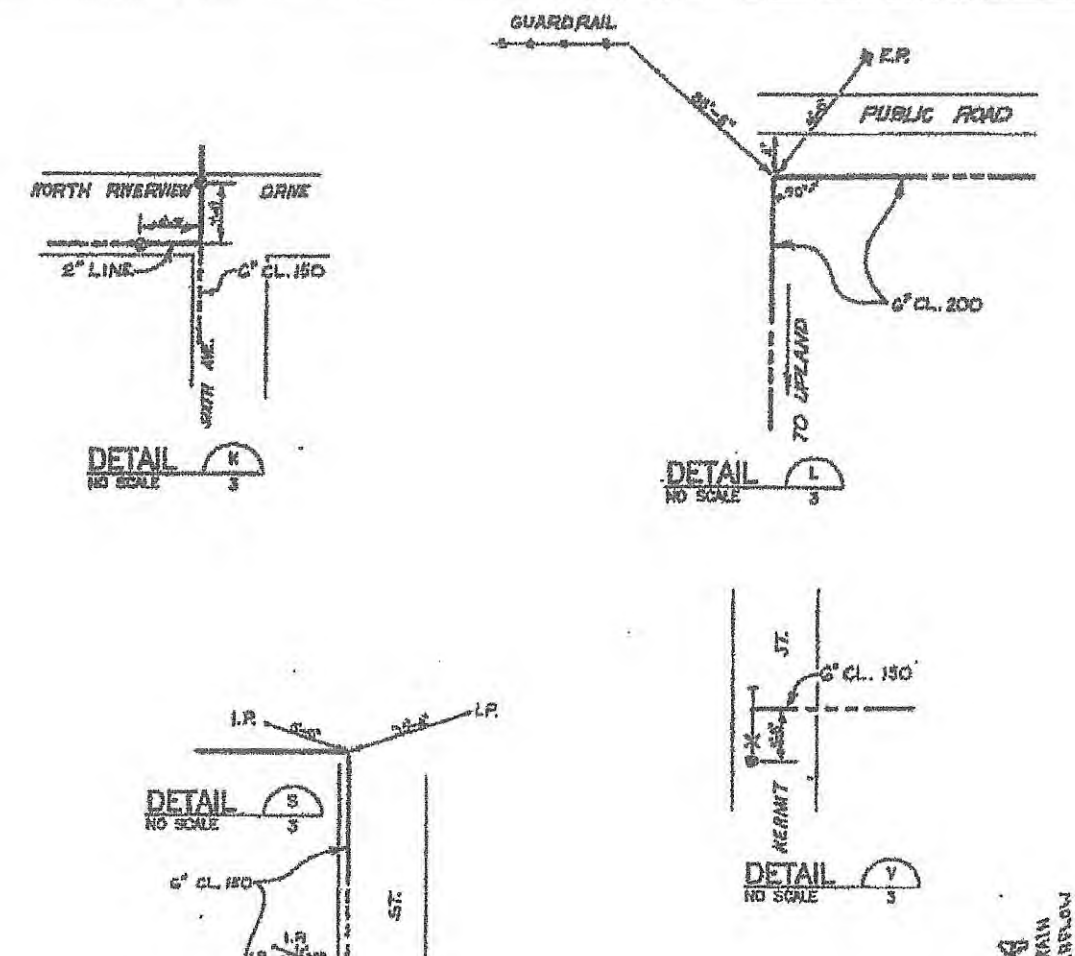

Edited By Richard A Coup
2/10/2017
Warren Water Authority

No Scale

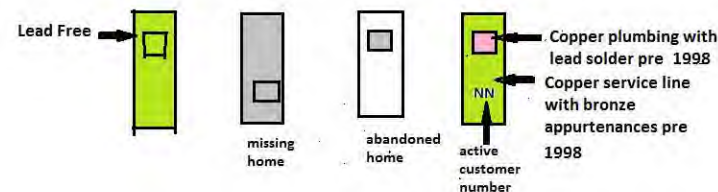

Buildings in Ohio built prior to 1998 or that use plumbing material or solder manufactured before 1998 may have materials with greater than 8% lead and are at a higher risk of contributing lead to the drinking water than materials manufactured after 1998. In addition, buildings built and plumbing materials manufactured after 2014 were required to have less than 0.25% lead by weight and have the lowest risk for contributing lead to the drinking water. It should be noted however that, although prohibited, some use of leaded solder or leaded components may have occurred after the prohibitions became effective.

RAIN
BELOW

C:\Autocad\Projects\Warren_Water_System_Dwg\WWSDD_05.dwg, 11/19/2004 3:38:14 PM, 1:109

Edited by Richard A Coup
2/15/2017

Buildings in Ohio built prior to 1998 or that use plumbing material or solder manufactured before 1998 may have materials with greater than 8% lead and are at a higher risk of contributing lead to the drinking water than materials manufactured after 1998. In addition, buildings built and plumbing materials manufactured after 2014 were required to have less than 0.25% lead by weight and have the lowest risk for contributing lead to the drinking water. It should be noted however that, although prohibited, some use of leaded solder or leaded components may have occurred after the prohibitions became effective.

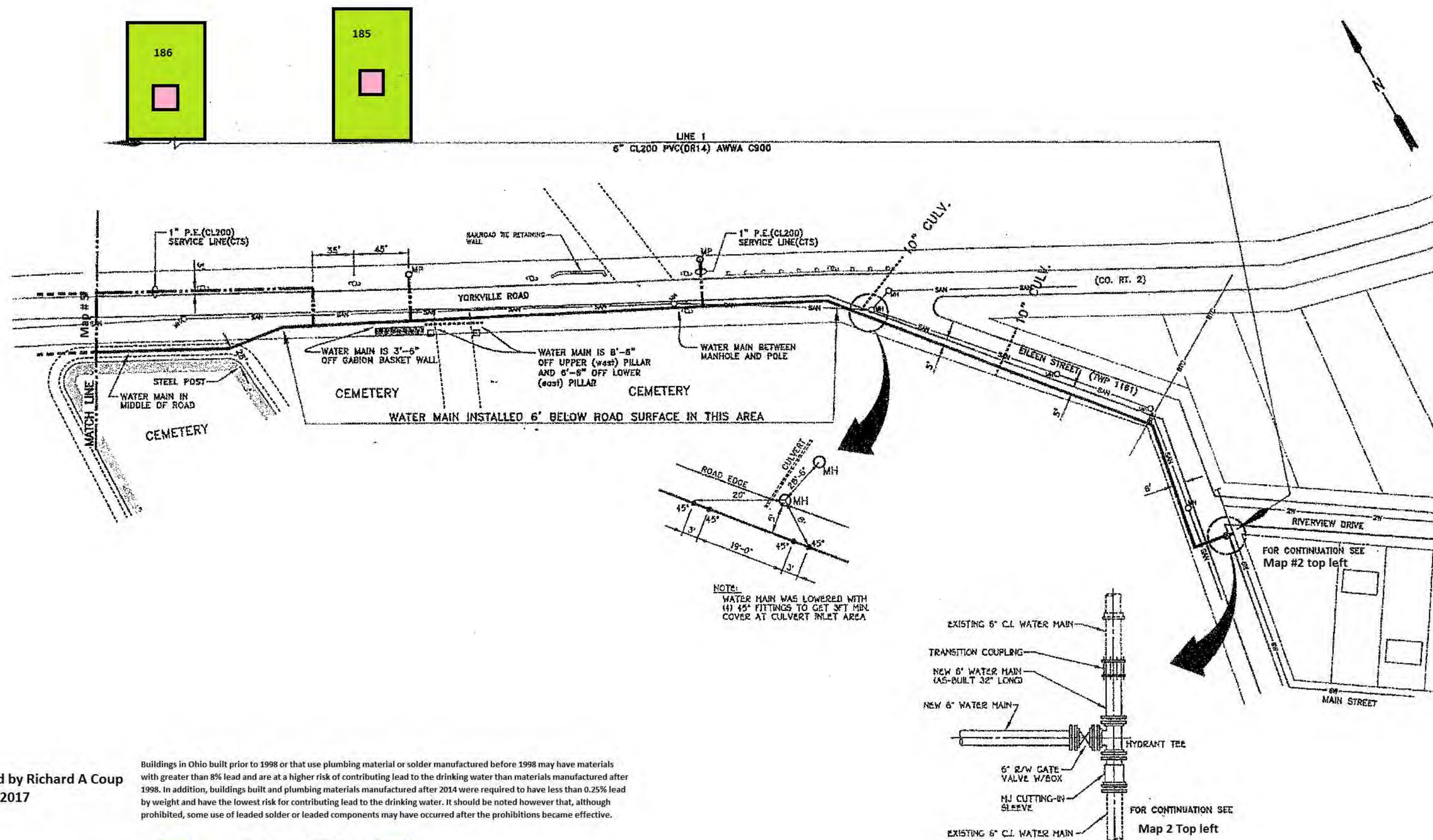
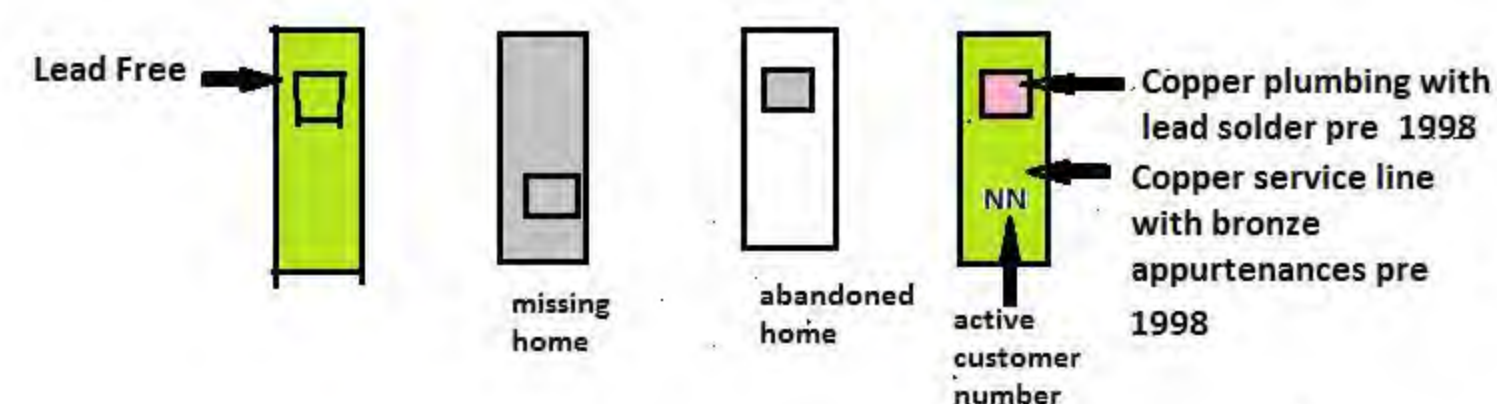

NOTE:

1) THIS DRAWING WAS PART OF ORIGINAL RECORD
DRAWING SET DATED AUGUST 2003

| | | | |
|---|---|-----------------------|-------------------|
| WARREN WATER AUTHORITY Upland Heights Water System Jefferson County, Ohio | UPLAND HEIGHTS WATER SYSTEM WATER SYSTEM MAP AND DETAILS | SCALE | |
| | | DATE NOVEMBER 2004 | PROJECT NO. 11 |

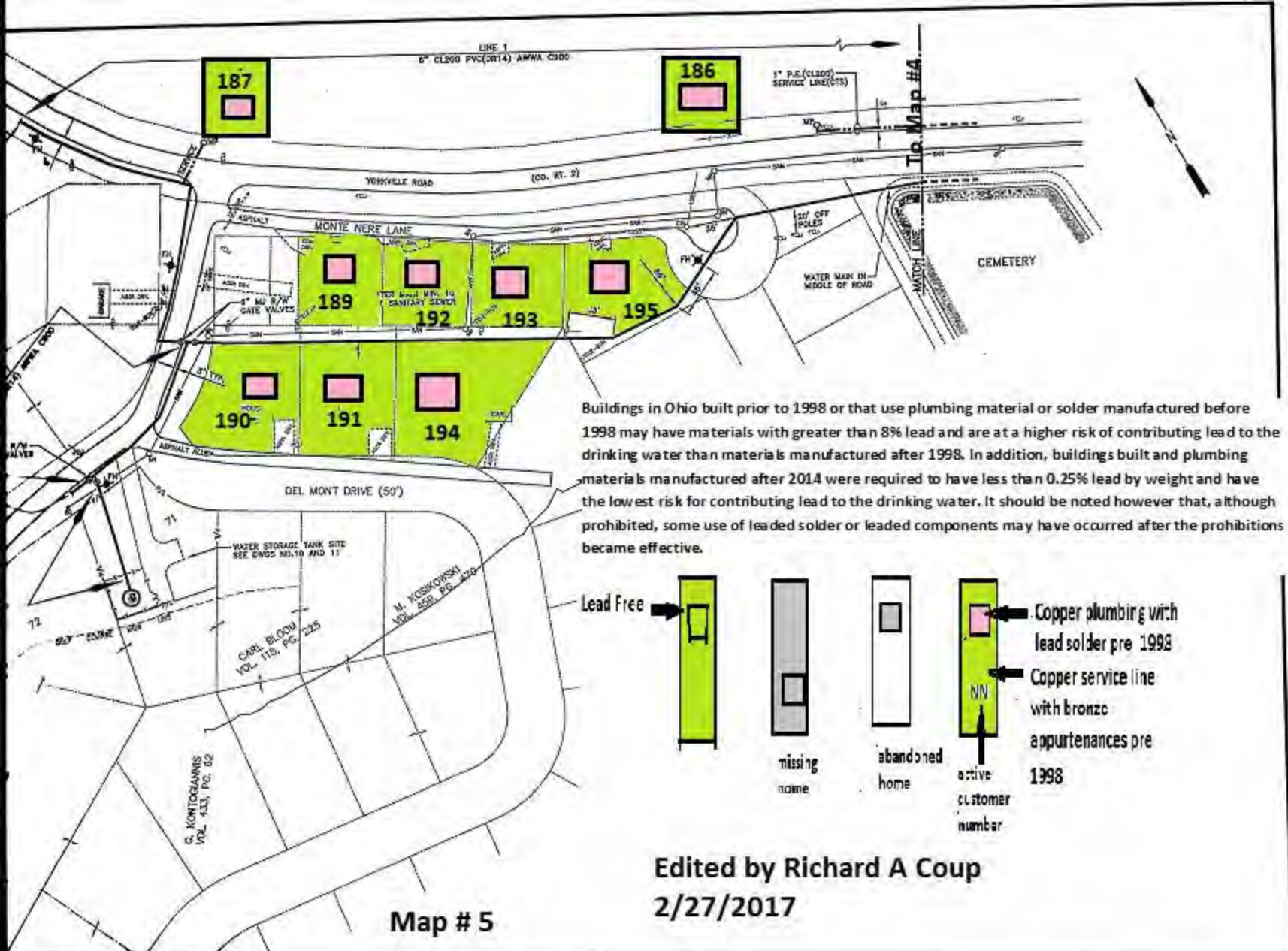

Edited by Richard A Coup
2/27/2017