

RE: Payne Village  
Report  
Drinking Water Program  
Paulding County  
PWS ID: OH6300712

# PAYNE, OHIO

WATER MAP

OH 6300712

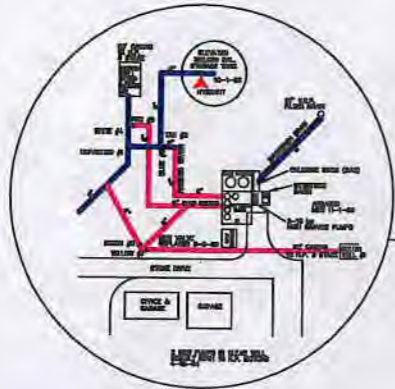

## LEGEND

- 8" WATER MAIN
- 6" WATER MAIN
- 4" WATER MAIN
- 3" WATER MAIN OR LESS
- ▲ FIRE HYDRANT
- + MAIN LINE VALVE

SCALE APPROXIMATELY 1" = 300'

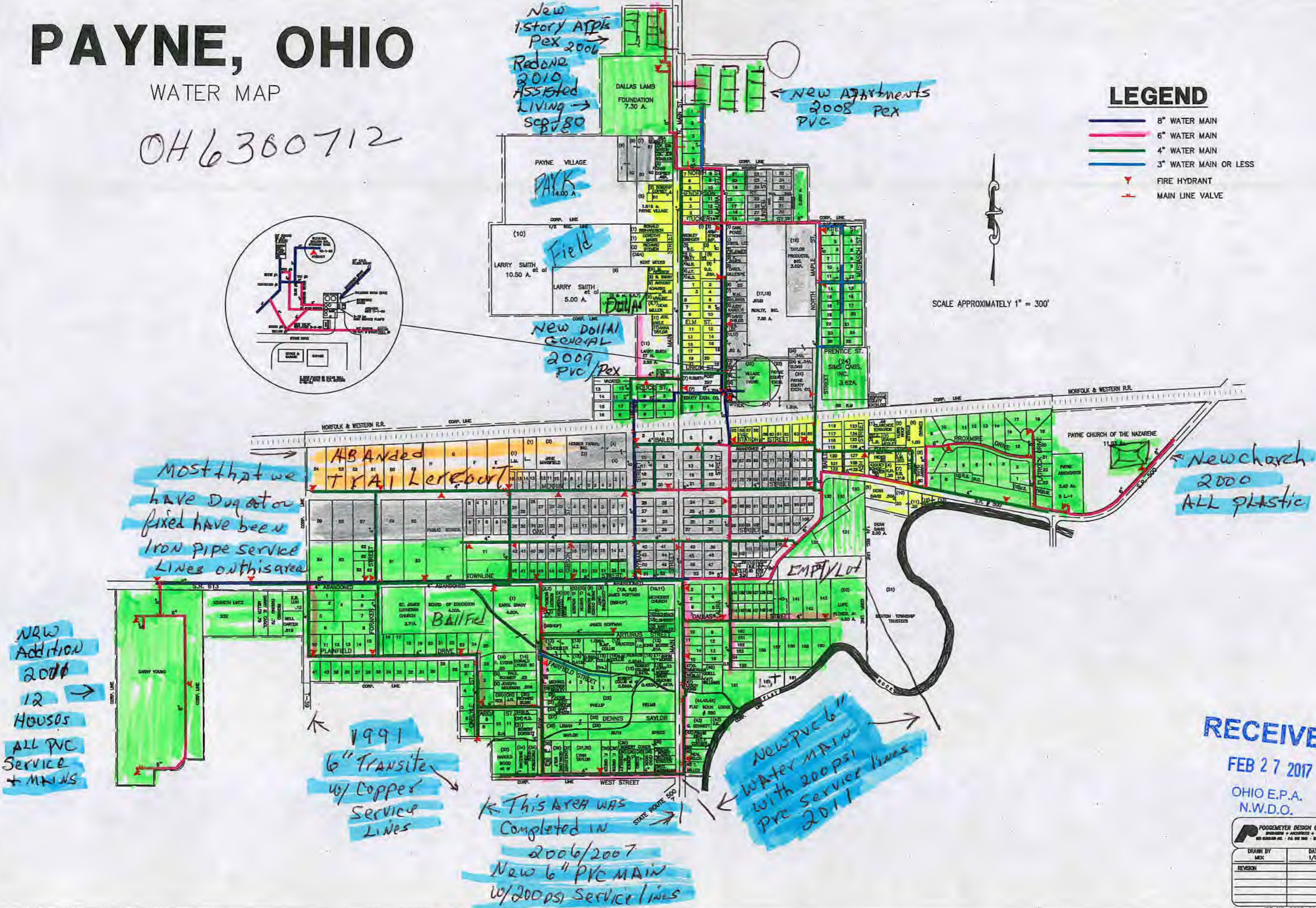

Most that we have dug out or fixed have been Iron pipe service lines on this area

NRW Addition 2000 12 HOUSES ALL PVC SERVICE + MAINS

1991 6" Transite w/ Copper Service Lines

This Area was Completed in 2006/2007 New 6" PVC MAIN w/ 200 PSI Service Lines

New PVC 6" Water Main with 200 PSI Pre Service Lines 2011

New church 2000 ALL PLASTIC

RECEIVED

FEB 27 2017

OHIO E.P.A. N.W.D.O.

FOGEMEYER DESIGN GROUP, INC. ENGINEERS + ARCHITECTS + PLANNERS 200 BROADWAY, SUITE 200, CLEVELAND, OH 44115	
DRAWN BY MEK	DATE 1/02
REVISION	

# PAYNE, OHIO

WATER MAP

046300712

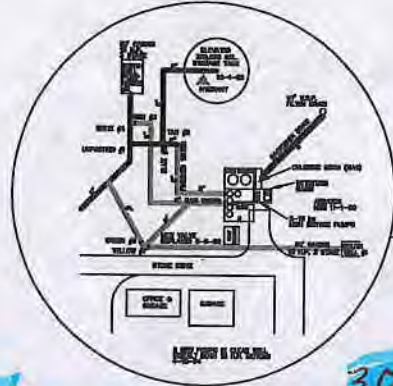

## LEGEND

- 8" WATER MAIN
- 6" WATER MAIN
- 4" WATER MAIN
- 3" WATER MAIN OR LESS
- FIRE HYDRANT
- MAIN LINE VALVE

N

SCALE APPROXIMATELY 1" = 300'

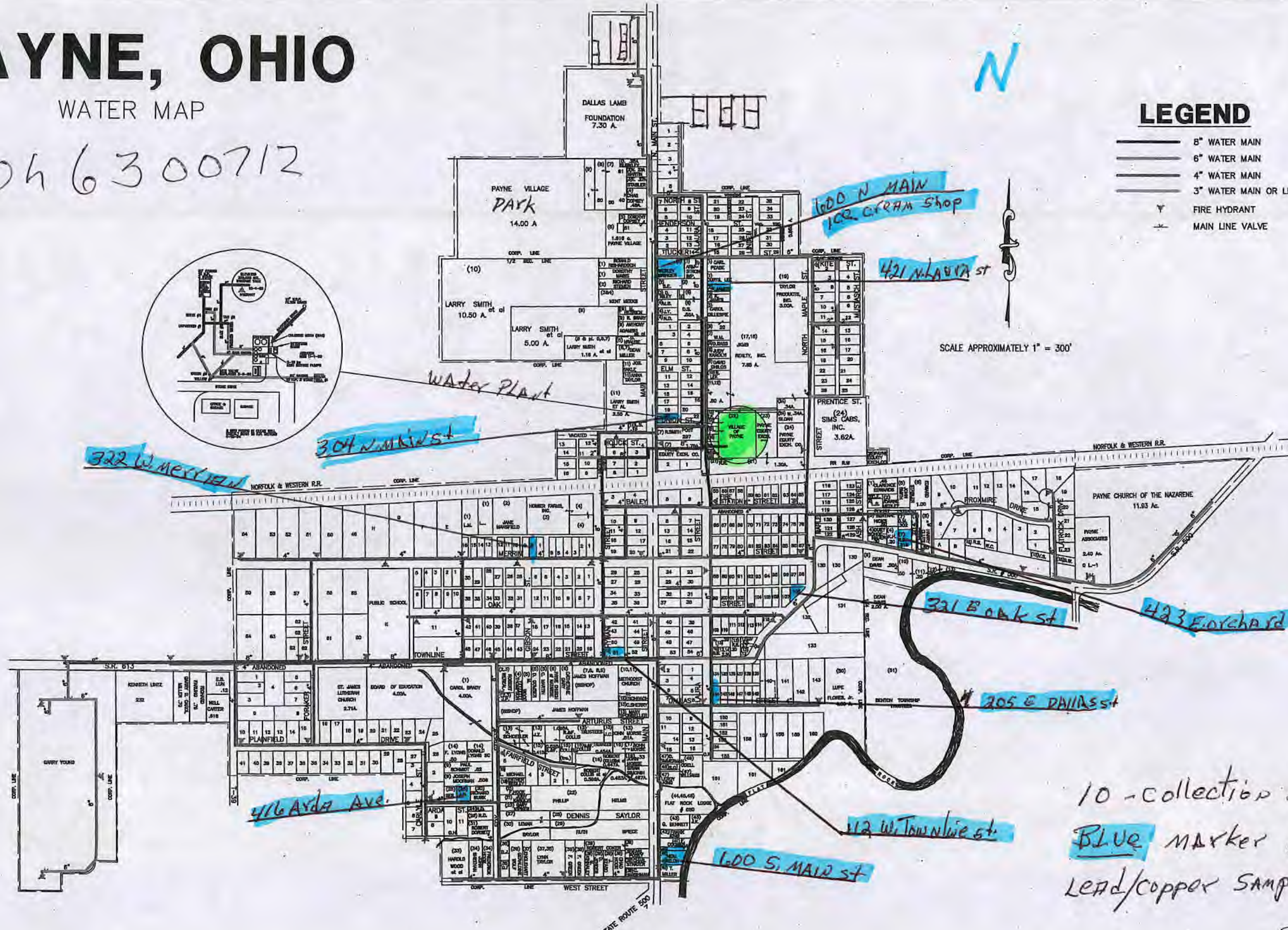

10 - collection sites  
BLUE marker indicates  
 LEAD/COPPER SAMPLING SITES

POGOREL DESIGN GROUP, INC. ENGINEERS • ARCHITECTS • PLANNERS 200 W. MAIN ST. - 1st FLOOR - COLUMBUS, OH 43215	
DRAWN BY	DATE
MEX	1/02
REVISION	