

RE: Madison South Elementary
Report
Drinking Water Program
Richland County
PWS ID: OH7043112

**VERIFICATION FORM FOR COMMUNITY PUBLIC WATER SYSTEMS
CLAIMING NO LEAD SERVICE LINES**

The owner or operator of all community public water systems must identify and map areas of their distribution system that are known or are likely to contain lead service lines. Systems must submit a copy of the applicable map to the Ohio Department of Health and the Ohio Department of Job and Family Services. Systems must also submit a report to the director containing at least both of the following: (1) The applicable map with narrative, and (2) A list of sampling locations used to collect samples as required by Ohio Revised Code (ORC) Section 6109.121 and any rules adopted thereunder, including contact information for the owner and occupant of each sampling site.

Should a water system determine no lead service lines exist in their distribution system, they must provide information stating they reviewed, at the minimum, historical permit records and local ordinances, distribution maintenance records and information pertaining to installation dates or materials for all services lines. This information must be verified below.

I HEREBY CERTIFY THAT THE FOLLOWING METHOD(S) WERE USED TO DETERMINE NO LEAD SERVICE LINES EXIST IN THIS WATER SYSTEM'S DISTRIBUTION SYSTEM, AS REQUIRED BY ORC 6109.121(F):

LEAD SERVICE LINE VERIFICATION
<p>This PWS states they have no lead service lines and has reviewed the following information (select one or more of the following):</p> <ul style="list-style-type: none"> <input type="checkbox"/> Historical permit records and/or local ordinances <input checked="" type="checkbox"/> Distribution maintenance records (i.e. meter replacement, waterline break repairs) <input type="checkbox"/> Information pertaining to installation dates for all service lines (i.e. after 1986 when lead services lines were banned) <input checked="" type="checkbox"/> Service line material of all service lines is known (i.e. all service lines are known to be PVC)

Holly L. McGhee 2-22-17
 Signature of Responsible Person Date
Holly L. McGhee MTWSI
 Printed Name and Title of Responsible Person

PWS NAME: Madison South Elem
 PWS ID: OH 7043112
 COUNTY: Richland

<p>For Ohio EPA use only:</p> <p>Date Verification Rec'd: _____</p>
--

RECEIVED

MAR 01 2017

DDAGW - NWDO



MADISON SOUTH ELEMENTARY SCHOOL
 700 SOUTH ILLINOIS AVE
 MANSFIELD, OHIO 44905
 PHONE # (419) 589-2600
 PWS ID # OH7043112

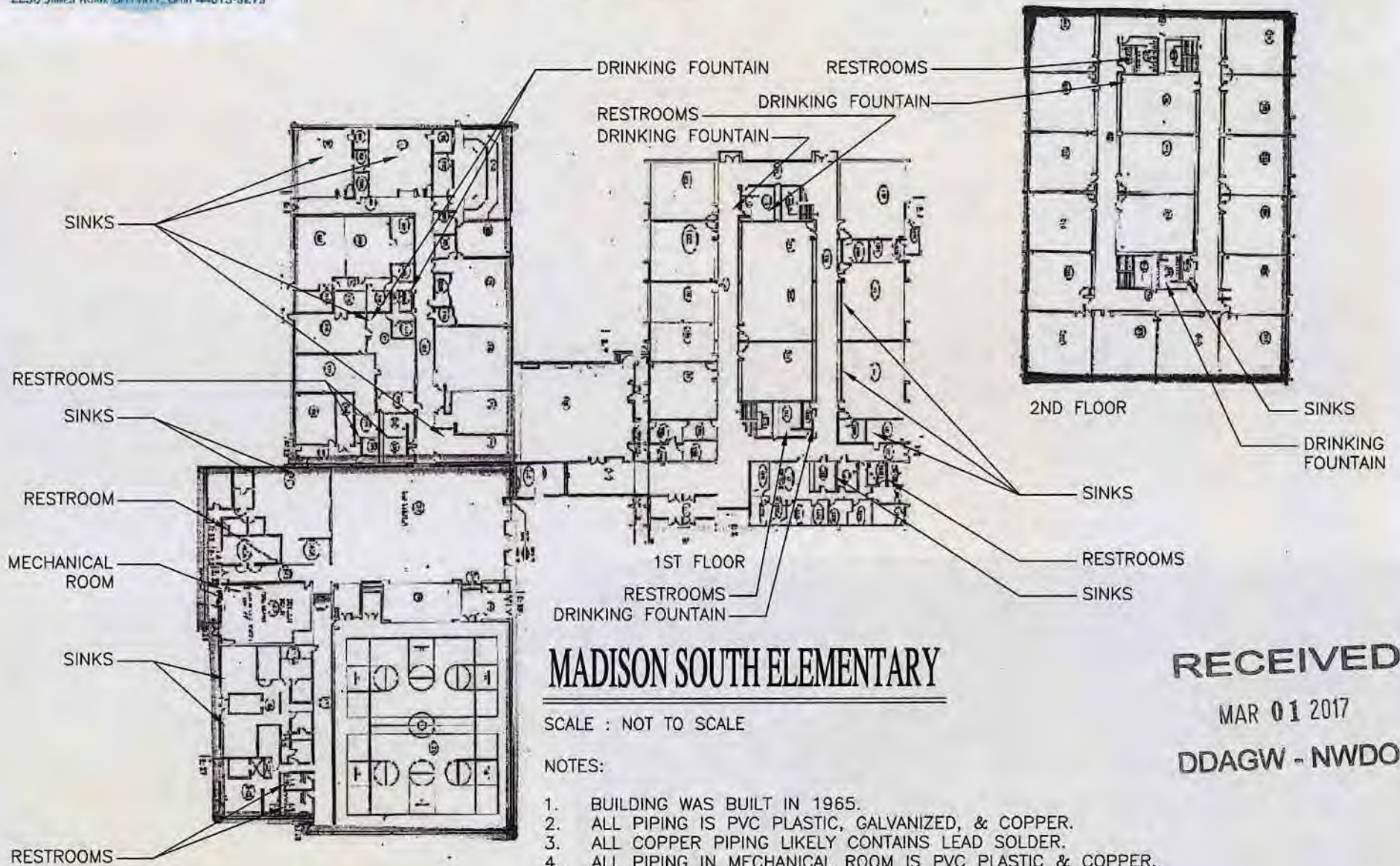

MADISON SOUTH ELEMENTARY

SCALE : NOT TO SCALE

NOTES:

1. BUILDING WAS BUILT IN 1965.
2. ALL PIPING IS PVC PLASTIC, GALVANIZED, & COPPER.
3. ALL COPPER PIPING LIKELY CONTAINS LEAD SOLDER.
4. ALL PIPING IN MECHANICAL ROOM IS PVC PLASTIC & COPPER.
5. ALL PIPING IN BUILDING EXCEPT MECHANICAL ROOM IS GALVANIZED AND COPPER.
6. ALL BATHROOMS, SINKS, & DRINKING FOUNTAINS WERE INSTALLED PRIOR TO 1998.

RECEIVED

MAR 01 2017

DDAGW - NWDO