

RE: Riverdale Local Schools  
Report  
Drinking Water Program  
Hancock County  
PWS ID: OH3239812

**VERIFICATION FORM FOR COMMUNITY PUBLIC WATER SYSTEMS  
CLAIMING NO LEAD SERVICE LINES**

The owner or operator of all community public water systems must identify and map areas of their distribution system that are known or are likely to contain lead service lines. Systems must submit a copy of the applicable map to the Ohio Department of Health and the Ohio Department of Job and Family Services. Systems must also submit a report to the director containing at least both of the following: (1) The applicable map with narrative, and (2) A list of sampling locations used to collect samples as required by Ohio Revised Code (ORC) Section 6109.121 and any rules adopted thereunder, including contact information for the owner and occupant of each sampling site.

Should a water system determine no lead service lines exist in their distribution system, they must provide information stating they reviewed, at the minimum, historical permit records and local ordinances, distribution maintenance records and information pertaining to installation dates or materials for all services lines. This information must be verified below.

I HEREBY CERTIFY THAT THE FOLLOWING METHOD(S) WERE USED TO DETERMINE NO LEAD SERVICE LINES EXIST IN THIS WATER SYSTEM'S DISTRIBUTION SYSTEM, AS REQUIRED BY ORC 6109.121(F):

<b>LEAD SERVICE LINE VERIFICATION</b>
<p><b>This PWS states they have no lead service lines and has reviewed the following information (select one or more of the following):</b></p> <ul style="list-style-type: none"><li><input type="checkbox"/> Historical permit records and/or local ordinances</li><li><input type="checkbox"/> Distribution maintenance records (i.e. meter replacement, waterline break repairs)</li><li><input checked="" type="checkbox"/> Information pertaining to installation dates for all service lines (i.e. after 1986 when lead services lines were banned)</li><li><input type="checkbox"/> Service line material of all service lines is known (i.e. all service lines are known to be PVC)</li></ul>

Signature of Responsible Person	Date
William Newsome-H2OTechnologies/President	
Printed Name and Title of Responsible Person	

**PWS NAME:** Riverdale School  
**PWS ID:** OH3239812  
**COUNTY:** Hancock

<p><b><u>For Ohio EPA use only:</u></b></p> <p>Date Verification Rec'd: _____</p>
---

**RECEIVED**  
MAR 01 2017  
DDAGW - NWDO

Riverdale School  
PWS ID# OH3239812  
For more information, please call  
H2O Technologies  
740.389.4514

There are no known Riverdale School or  
customer lead water service lines in this Public  
Water System\*

\* The maps provided are based on historical data in available records, historical knowledge, and assumptions concerning the date of installation and in some cases, information acquired during physical inspections. H2O Tech does not guarantee the accuracy of these records and maps, which shall be used for the sole purpose of providing H2O Tech available data regarding company and privately owned lead water services, and not for any commercial or other use. These records will be updated as H2O Tech gathers additional information. H2O Tech reserves the right to alter or amend the display of these maps and records. Customers should take independent steps to verify whether their service lines are lead.

---

"Buildings in Ohio built prior to 1998 or that use plumbing material or solder manufactured before 1998 may have materials with greater than 8% lead and are at a higher risk of contributing lead to the drinking water than materials manufactured after 1998. In addition, buildings built and plumbing materials manufactured after 2014 were required to have less than 0.25% lead by weight and have the lowest risk for contributing lead to the drinking water. It should be noted however, that although prohibited, some use of leaded solder or leaded components may have occurred after the prohibitions became effective."

RECEIVED

MAR 01 2017

DDAGW - NWDO

RECEIVED  
 MAR 01 2017  
 DDAGW - NWDO

Service line is copper.  
 Waterlines are cupb > 82  
 There are no lead lines in the system

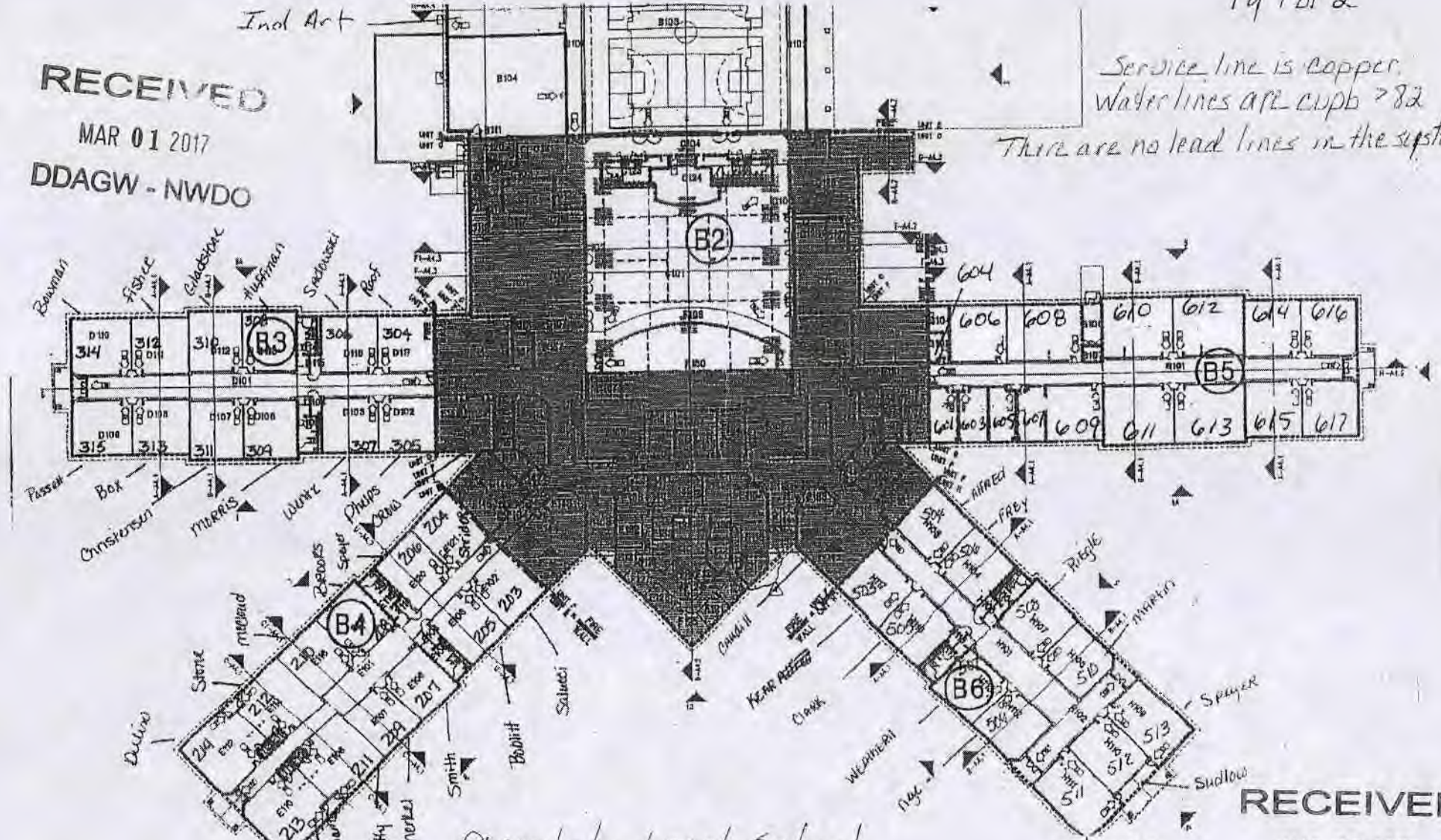

Riverdale Local School  
 20613 St Rt 37  
 Mt Blanchard OH 45867  
 PWS ID OH 3239812  
 Contact Eric Hoffman 419.694.4994 ext 1801

RECEIVED  
 MAR 01 2017  
 DDAGW - NWDO

Buildings in Ohio built prior to 1998 or that use plumbing material or solder manufactured before 1998 may have materials with greater than 8% lead and are at a higher risk of contributing lead to the drinking water than materials manufactured after 1998. In addition, building built and plumbing material manufactured after 2014 were required to have less than 0.25% lead by weight and have the lowest risk for contributing lead to the drinking water. It should be noted however that, although prohibited, some use of leaded solder or leaded components may have occurred after the prohibitions became effective.