

RE: Richland Manor Nursing Home
Report
Drinking Water Program
Allen County
PWS ID: OH0201112

RECEIVED

MAR 02 2017

OHIO E.P.A.
N.W.D.O.

**VERIFICATION FORM FOR COMMUNITY PUBLIC WATER SYSTEMS
CLAIMING NO LEAD SERVICE LINES**

The owner or operator of all community public water systems must identify and map areas of their distribution system that are known or are likely to contain lead service lines. Systems must submit a copy of the applicable map to the Ohio Department of Health and the Ohio Department of Job and Family Services. Systems must also submit a report to the director containing at least both of the following: (1) The applicable map with narrative, and (2) A list of sampling locations used to collect samples as required by Ohio Revised Code (ORC) Section 6109.121 and any rules adopted thereunder, including contact information for the owner and occupant of each sampling site.

Should a water system determine no lead service lines exist in their distribution system, they must provide information stating they reviewed, at the minimum, historical permit records and local ordinances, distribution maintenance records and information pertaining to installation dates or materials for all services lines. This information must be verified below.

I HEREBY CERTIFY THAT THE FOLLOWING METHOD(S) WERE USED TO DETERMINE NO LEAD SERVICE LINES EXIST IN THIS WATER SYSTEM'S DISTRIBUTION SYSTEM, AS REQUIRED BY ORC 6109.121(F):

LEAD SERVICE LINE VERIFICATION	
<p>This PWS states they have no lead service lines and has reviewed the following information (select one or more of the following):</p> <ul style="list-style-type: none"> <input checked="" type="checkbox"/> Historical permit records and/or local ordinances <input checked="" type="checkbox"/> Distribution maintenance records (i.e. meter replacement, waterline break repairs) <input checked="" type="checkbox"/> Information pertaining to installation dates for all service lines (i.e. after 1986 when lead services lines were banned) <input checked="" type="checkbox"/> Service line material of all service lines is known (i.e. all service lines are known to be PVC) 	

Lance Nickler

2-28-17

Signature of Responsible Person

Date

Lance Nickler Executive Director

Printed Name and Title of Responsible Person

PWS NAME: *Richland Manor*
PWS ID: *OHG 201112*
COUNTY: *Allen*

<p>For Ohio EPA use only:</p> <p>Date Verification Rec'd: _____</p>
--

February 15, 2017
Richland Manor
PWS# OHO201112
STU# 252635

As stated on map, a 2" plastic line runs from the well to the treatment facility, where a mixture of 2" PVC 40 & PVC 80 piping was installed, along with treatment equipment, in August of 2012. A plastic 2" line runs from the treatment facility out to an underground tank where re-pressurization takes place and feeds the entire Richland Manor facility, with another 2" plastic line thru FRP bladder tanks and to the facility, where in 2000 all new 2" copper water lines were run thru the ceilings of the hallways with PEX lines going to each room.

Buildings in Ohio built prior to 1998 or that use plumbing material or solder manufactured before 1998 may have materials with greater than 8% lead and are at a higher risk of contributing lead to the drinking water than materials manufactured after 1998. In addition, builds built and plumbing materials manufactured after 2014 were required to have less than 0.25% lead by weight and have the lowest risk for contributing lead to the drinking water. It should be noted, however, that although prohibited, some use of leaded solder or leaded components may have occurred after the prohibitions became effective.

In 2000 New 2" water mains were run thru hallway ceilings & pex piping was run from main line to each room, 2" water mains are copper.

* Richard Manor
 PLS# 01020112
 STU# 252635

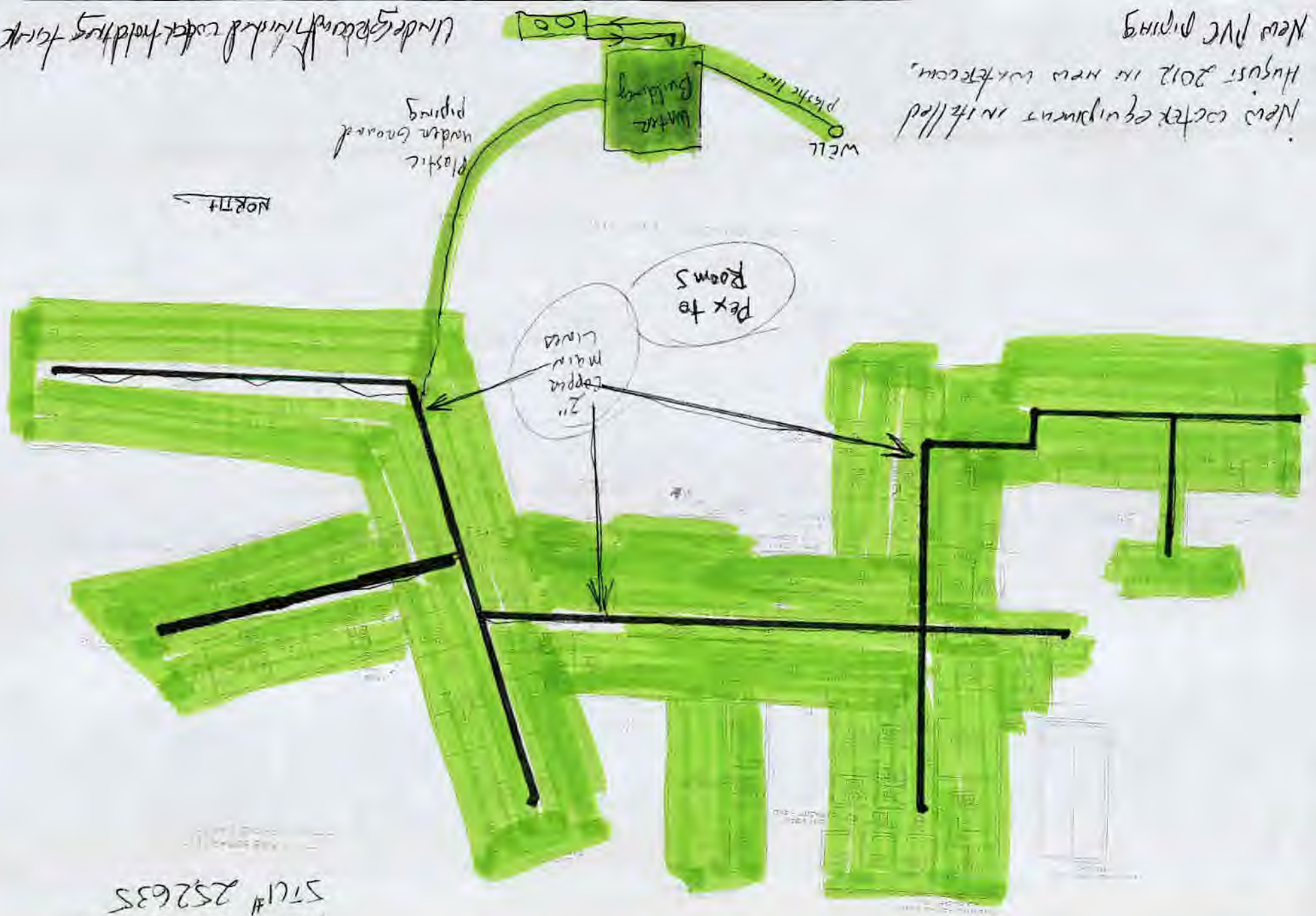

New water equipment installed August 2012 in new water room.

New PVC piping

Underground finished water holding tank

NORTH

Plastic under ground piping

Water Building

Well

Pex line

Pex to Rooms

2" Copper main lines