

RE: Bryan City  
Report  
Drinking Water Program  
Williams County  
PWS ID: OH8600012

# THE CITY OF BRYAN, OHIO

## POTENTIAL RISK LEVELS OF LEAD & COPPER IN BRYAN'S WATER DISTRIBUTION SYSTEM

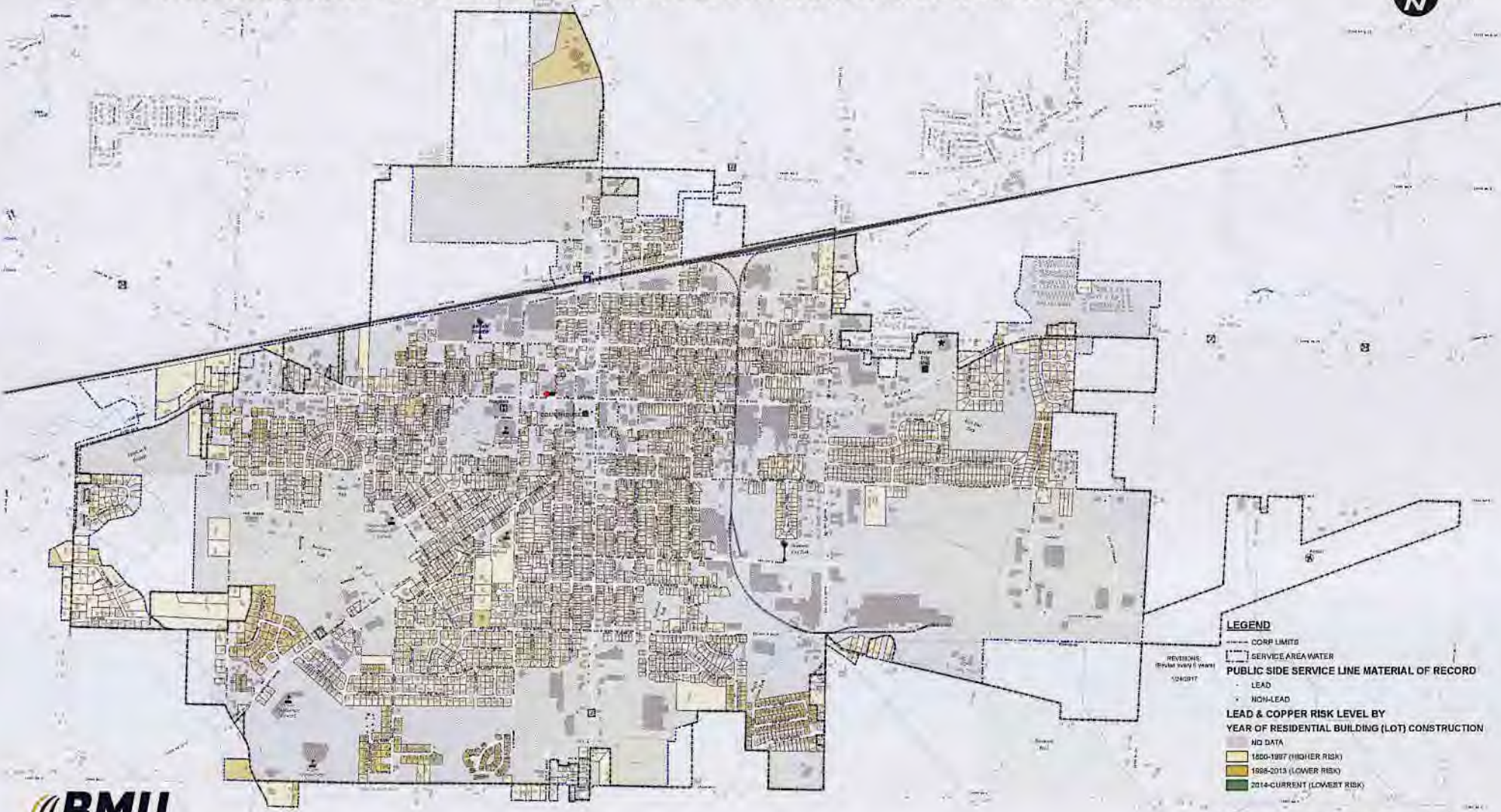

- LEGEND**
- CORP LIMITS
  - SERVICE AREA WATER
  - PUBLIC SIDE SERVICE LINE MATERIAL OF RECORD
  - LEAD
  - NON-LEAD
- LEAD & COPPER RISK LEVEL BY YEAR OF RESIDENTIAL BUILDING (LOT) CONSTRUCTION**
- NO DATA
  - 1800-1987 (HIGHER RISK)
  - 1988-2013 (LOWER RISK)
  - 2014-CURRENT (LOWEST RISK)

Buildings in Ohio built prior to 1988 or that use plumbing material or solder manufactured before 1988 may have materials with greater than 0% lead and are at a higher risk of contributing lead to the drinking water than materials manufactured after 1988. In addition, buildings built and plumbing materials manufactured after 2014 were required to have less than 0.25% lead by weight and have the lowest risk for contributing lead to the drinking water. It should be noted however that, although prohibited, some use of leaded solder or leaded components may have occurred after the prohibitions became effective.



0 250 500 1,000 1,500 2,000 Feet

Bryan Municipal Utilities  
241 S. Stephens St.  
Bryan, OH 43004  
Phone: 419-623-1300

**RECEIVED**

MAR 02 2017

DDAGW - NWDO