

St. Pauls Lutheran Lead and Copper Monitoring Points

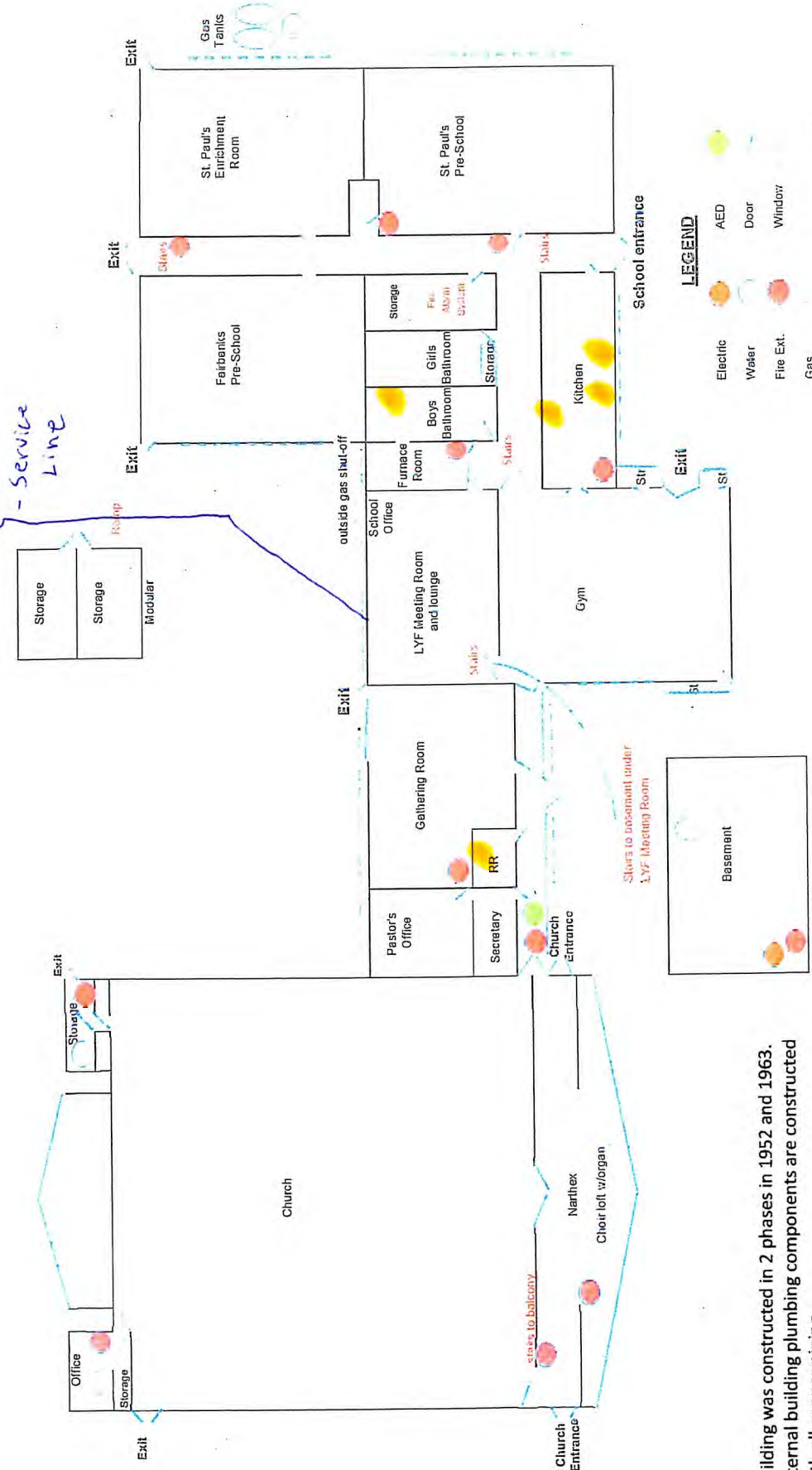

Building was constructed in 2 phases in 1952 and 1963.
 Internal building plumbing components are constructed with all copper piping.
 Service lines and well piping are PVC.

- Yellow = Pb/Cu Sample Locations.
- LC201 = Single Kitchen Sink
- LC202 = Boys Bathroom
- LC203 = Kitchen Front Swivel
- LC204 = Kitchen Back Swivel
- LC205 = Unisex Bathroom

Based on the age of construction, it is highly likely that lead solder and fixtures were used. Our current well was drilled in 2002 and constructed of PVC piping. The service line is also PVC

PWS Name - St Pauls Lutheran School
 PWS ID - 8034412
 Type of System - Non-transient Noncommunity
 Contacts - David Picklesimer 937-243-3976
 or
 - Dennis Headings 614-561-5466
 dwh2500@chuckeryohio.com

LEGEND

- Electric
- Water
- Fire Ext.
- Gas
- AED
- Door
- Window