

**VERIFICATION FORM FOR COMMUNITY PUBLIC WATER SYSTEMS  
CLAIMING NO LEAD SERVICE LINES**

The owner or operator of all community public water systems must identify and map areas of their distribution system that are known or are likely to contain lead service lines. Systems must submit a copy of the applicable map to the Ohio Department of Health and the Ohio Department of Job and Family Services. Systems must also submit a report to the director containing at least both of the following: (1) The applicable map with narrative, and (2) A list of sampling locations used to collect samples as required by Ohio Revised Code (ORC) Section 6109.121 and any rules adopted thereunder, including contact information for the owner and occupant of each sampling site.

Should a water system determine no lead service lines exist in their distribution system, they must provide information stating they reviewed, at the minimum, historical permit records and local ordinances, distribution maintenance records and information pertaining to installation dates or materials for all services lines. This information must be verified below.

I HEREBY CERTIFY THAT THE FOLLOWING METHOD(S) WERE USED TO DETERMINE NO LEAD SERVICE LINES EXIST IN THIS WATER SYSTEM'S DISTRIBUTION SYSTEM, AS REQUIRED BY ORC 6109.121(F):

<b>LEAD SERVICE LINE VERIFICATION</b>	
<b>This PWS states they have no lead service lines and has reviewed the following information (select one or more of the following):</b>	
<input type="checkbox"/>	Historical permit records and/or local ordinances
<input type="checkbox"/>	Distribution maintenance records (i.e. meter replacement, waterline break repairs)
<input checked="" type="checkbox"/>	Information pertaining to installation dates for all service lines (i.e. after 1986 when lead services lines were banned)
<input checked="" type="checkbox"/>	Service line material of all service lines is known (i.e. all service lines are known to be PVC)

*Chris Hucker*

3/5/2017

Signature of Responsible Person

Date

*Chris Hucker Operator*

Printed Name and Title of Responsible Person

PWS NAME:

*East Central Ohio Business Park*

PWS ID:

*OH 6042012*

COUNTY:

*Muskingum*

**For Ohio EPA use only:**

Date Verification Rec'd: \_\_\_\_\_

## **East Central Ohio Business Park**

### **NonTransient Non Community Public Water System**

**PWSID # OH6042812**

**Prepared March 5, 2017**

To comply with Section 6109.21 of the Ohio Revised Code, enacted in September 2016, the East Central Ohio Business Park in Muskingum County, Ohio has created the following report and attached a map to identify known and potential components of water service lines that contain lead (Pb).

The following information and attached map do not verify the presence of lead in any of the plumbing components or structures shown. The information and map only show the probable or possible locations based on the year that structures were built, or by the year that the plumbing components was installed.

The East Central Ohio Business Park staff reviewed a map of the service area. No applicable historical maintenance and operation records, tap cards, or as builts drawings were available to identify lead components locations. Locations where lead components have been replaced, and locations where lead components are likely still being used , were identified and noted on a drawing.

#### **Public and Private Ownership of Service Lines**

The East Central Ohio Business Park water system distributes water to 15 buildings. The East Central Ohio Business Park owns and maintains service lines from the water distribution mains up to the curb stops for each water customer. The remainder of each service line from the curb stop to the building is the responsibility of the property owner.

#### **Distribution System**

Within the distribution system, none of the pipes themselves are known to contain any lead. The water main lines are mostly PVC piping and some ductile iron piping materials, however, some valves, and fittings within the system may contain lead.

Water meters at each customer location may contain more than 8% lead. Meters installed after 1998 may contain up to 8% lead. Meters installed after 2014 will have less than 0.25% lead.

The East Central Ohio Business Park has approximately 8,800 feet of water main lines. All 8,800 feet of water main lines contain no lead solder, valves, or fittings according to pre or post regulation.

## **Indoor Plumbing**

Buildings in Ohio built prior to 1998 or that use plumbing material or solder manufactured before 1998 may have materials with greater than 8% lead and are at higher risk of contributing lead to the drinking water than materials manufactured after 1998.

Buildings built and plumbing materials manufactured after 2014 were required to have less than 0.25% lead by weight and have the lowest risk for contributing lead to drinking water. It should be noted however that, although prohibited, some use of leaded solder or leaded components may have occurred after the prohibitions became effective.

In the East Central Ohio Business Park, all buildings were built after 1991 and there are no known buildings that have been built after 2014, therefore all the buildings may contain some lead in the solder or fixtures.

## **Customer Self-Reporting**

The information on this map regarding privately owned service lines is based on the limited information from the water system staff and Muskingum County building and parcel data. Building owners are encouraged to inspect their own service lines entering the building if these are in anyway exposed, and notify the East Central Ohio Business Park staff if they have determined whether or not a lead service line exists. Please contact Joseph Dinan by calling (740) 819-1043 or by sending an e-mail to [joseph.dinan@longaberger.com](mailto:joseph.dinan@longaberger.com)

## **EPA Test Sites**

The Table below lists the OEPA locations used for lead and copper sampling. The Map ID column is used to identify testing sites in the OEPA Test Site Map that follows this report.

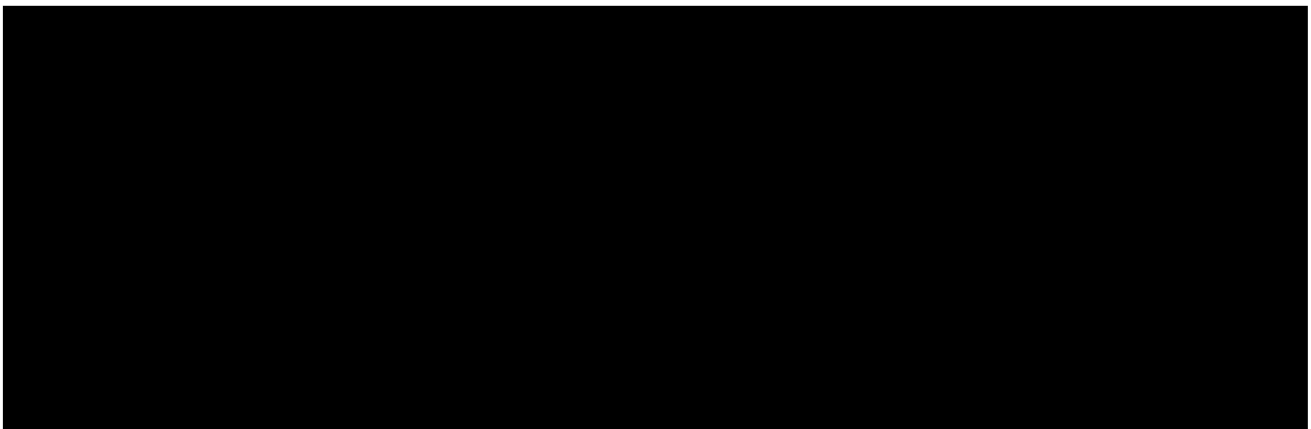

## **Contacts and Resources**

If you have questions about known and potential lead components within the East Central Ohio Business Park public water system, please contact:

Chris Huebner

Phone (740) 255-6385

For more information about lead service lines and their removal, we recommend the following resources:

- The Leas Service Line Replacement Collaborative  
<http://www.lslr-collaborative.org/resources-for-concerned-consumers.html>
- Ohio EPA "Learn About Lead" page <http://epa.ohio.gov/pic/lead.aspx>
- US EPA Lead in Drinking Water Information Page  
<https://www.epa.gov/ground-water-and-drinking-water/basic-information-about-lead-drinking-water>

# East Central Ohio Business Park Water Mains

All water mains PVC pipe

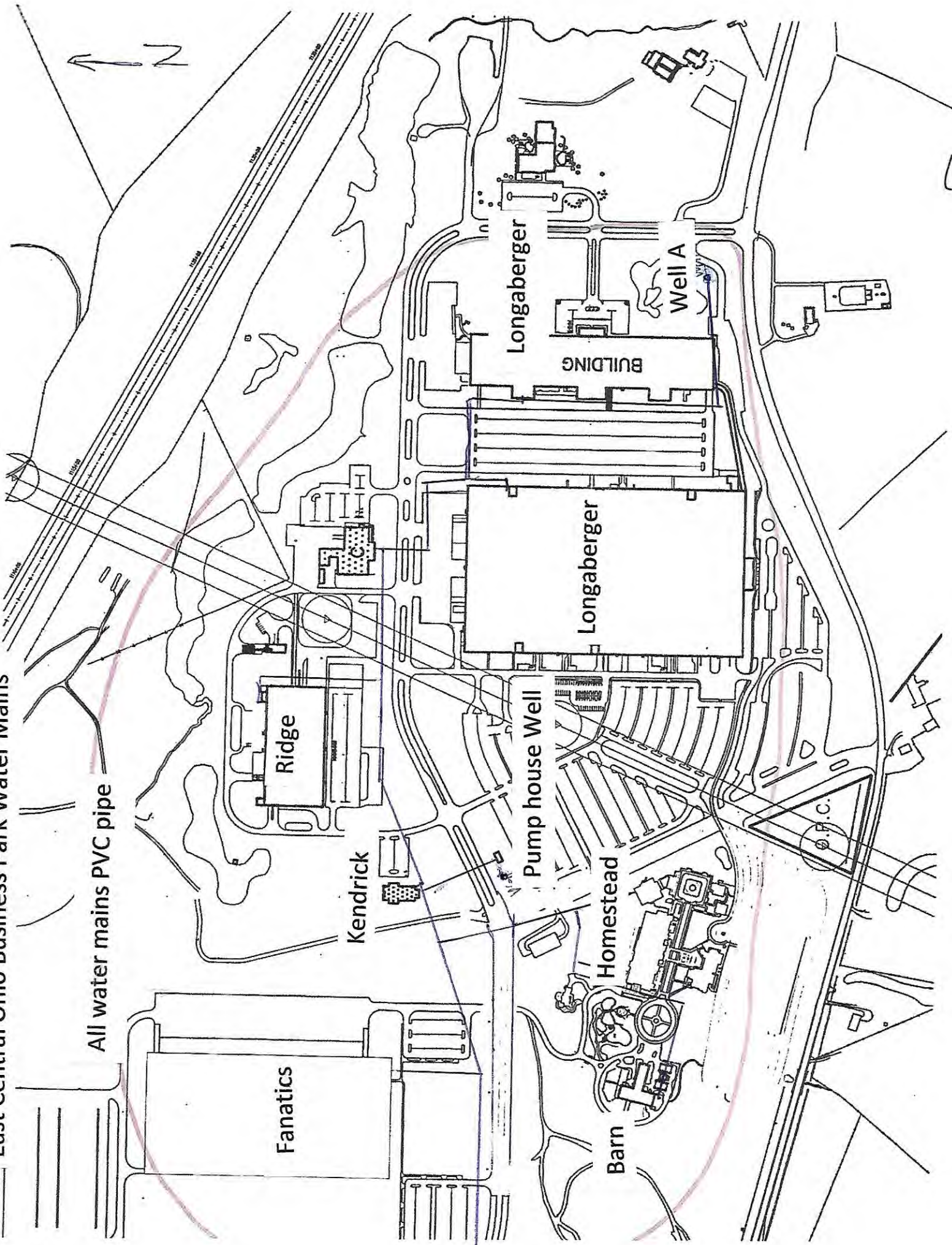

# East Central Ohio Business Park Water Mains

## OEPA Test Site

Tier 1

1-10 test site information included in report

Water Mains

Plastic

