

RE: City of Oregon
Report
Drinking Water Program
Lucas County
PWS ID: OH4800911

RECEIVED

MAR 03 2017

DDAGW - NWDO

City of Oregon, Ohio
Lead Mapping In Water Distribution System
Lead Service Line Locations



Legend

- LEAD SERVICE LINE LOCATION - 515 SERVICE LINES AS OF FEBRUARY 15, 2017
- PARCEL WITH HOME BUILT 1982 OR BEFORE (COPPER PIPES WITH LEAD SOLDER (TIER 3)) - 4,804 METERED ACCOUNTS
- PARCEL WITH HOME BUILT 1983 - 1988 (COPPER PIPES WITH LEAD SOLDER (TIER 1)) - 256 METERED ACCOUNTS
- PARCEL WITH HOME BUILT 1989 - 2014 (AFTER LEAD SOLDER BAN IN 1987, FIXTURES COULD CONTAIN 5% OR GREATER LEAD CONTENT) - 1,429 METERED ACCOUNTS
- Streets

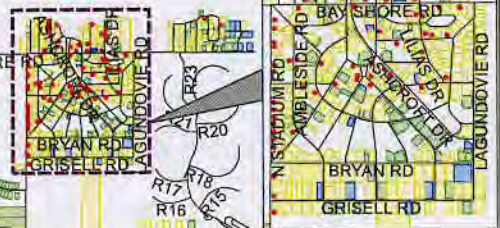
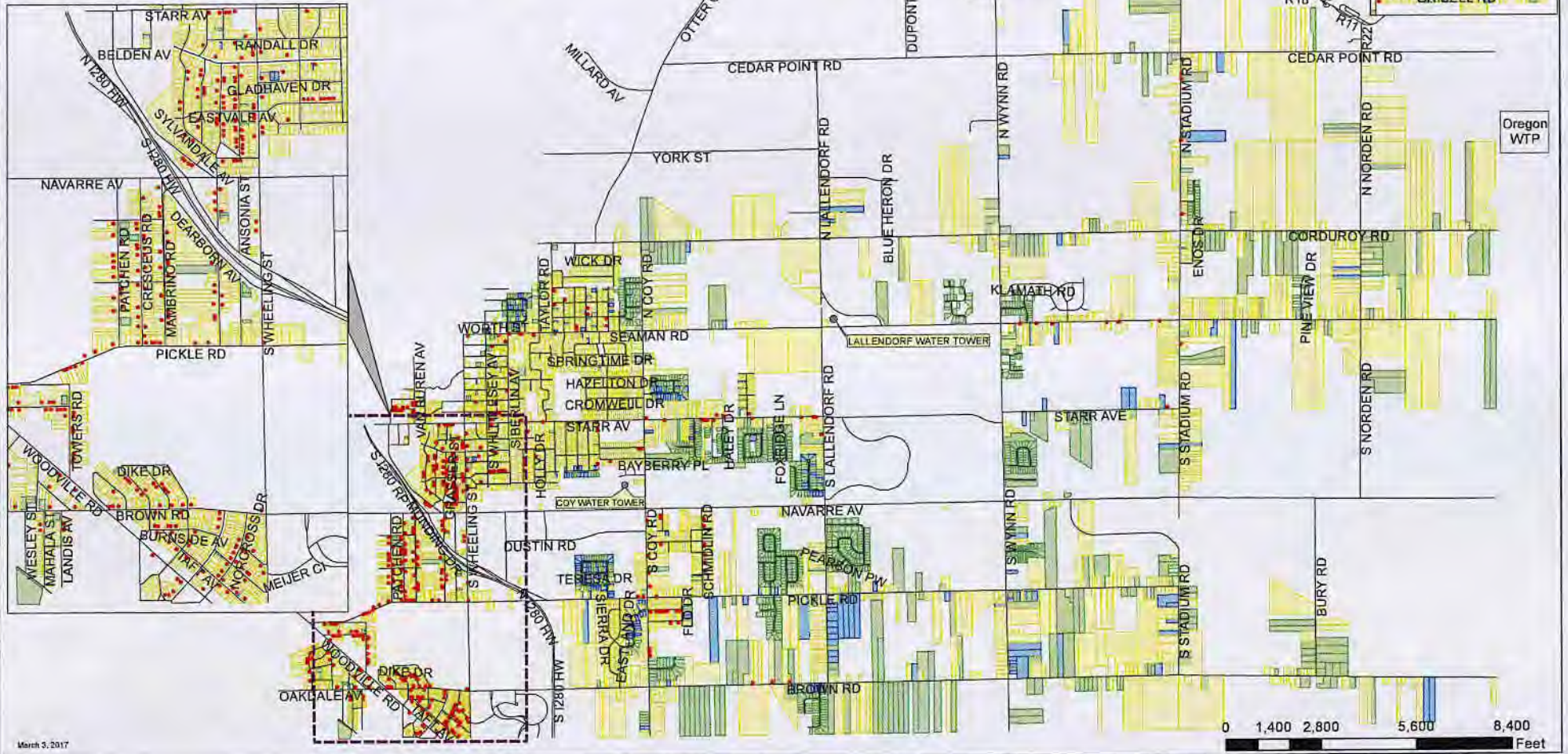

RECEIVED

MAR 03 2017

City of Oregon, Ohio Lead Mapping In Water Distribution System Sample Monitoring Point Locations



Legend

- ★ LEAD AND COPPER SAMPLE MONITORING POINT IDS LOCATION - 50 LOCATIONS
- PARCEL WITH HOME BUILT 1982 OR BEFORE (COPPER PIPES WITH LEAD SOLDER (TIER 3)) - 4,804 METERED ACCOUNTS
- PARCEL WITH HOME BUILT 1983 - 1988 (COPPER PIPES WITH LEAD SOLDER (TIER 1)) - 256 METERED ACCOUNTS
- PARCEL WITH HOME BUILT 1989 - 2014 (AFTER LEAD SOLDER BAN IN 1987, FIXTURES COULD CONTAIN 8% OR GREATER LEAD CONTENT) - 1,429 METERED ACCOUNTS
- Streets

DDAGW - NW

