

Lead & Copper Mapping Project

PWS Name: Saint Gobain crystals

PWS #: OH 2875412

Year Built: 2008

Service Line Material: Non-Lead

If you have any questions, please contact:

Clearwater Operations & Maintenance

10180 Queens Way #3

Chagrin Falls, OH 44023

440-708-0266

clearwater@clearwaterops.com

HIRAM MEZZANINE LEVEL
(1:2 SCALE)



HIRAM GROUND LEVEL

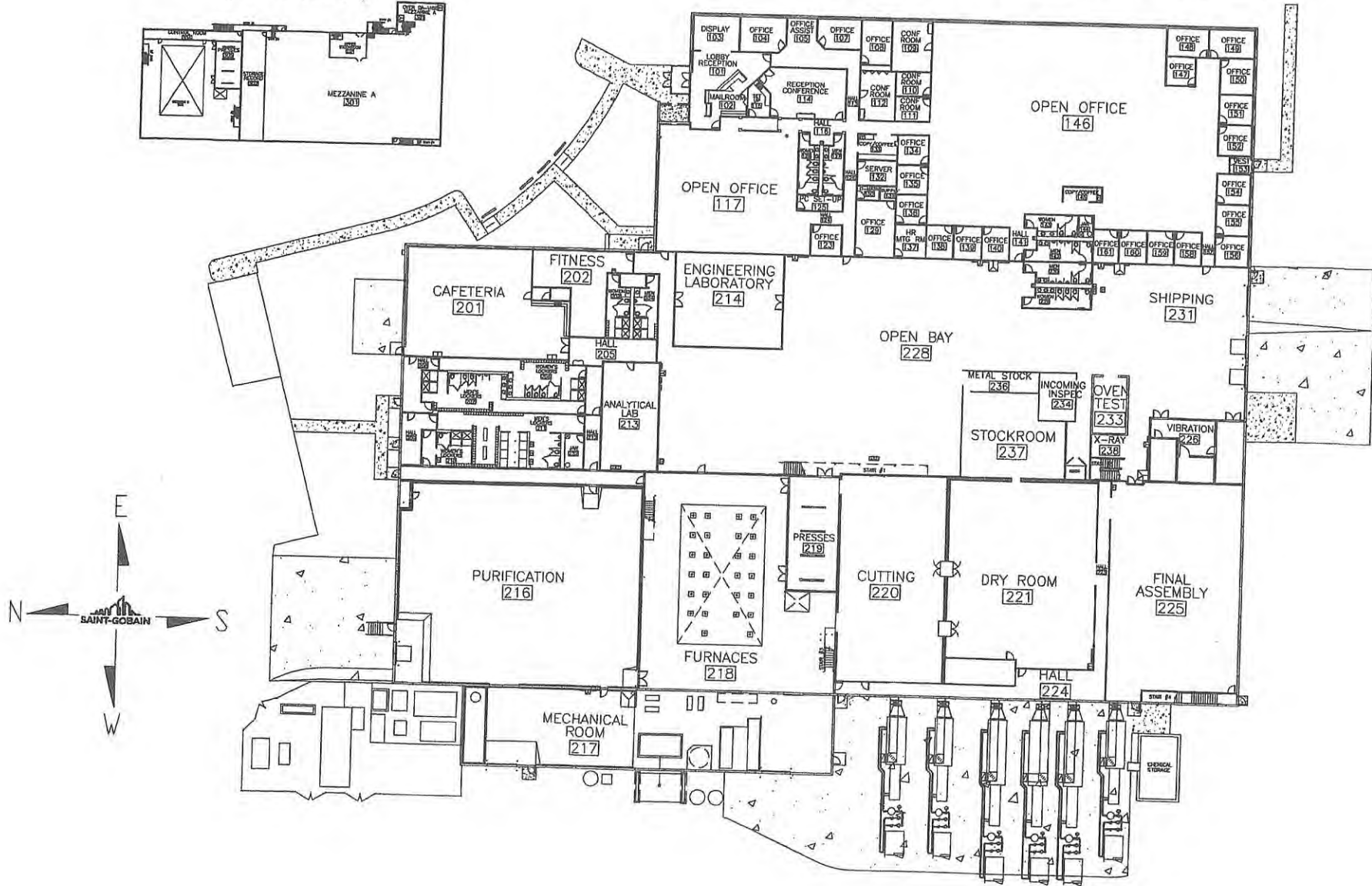



Geauga **REALink**



Frank J. Gliha, Geauga County Auditor
Joe Cattell, Geauga County Engineer PE, PS

Geauga County GIS



1 Inch = 75.75 Feet | Scale: 909

This tax map was prepared by Geauga County GIS in accordance with Section 5713.09 of the O.R.C. Geauga County digital data is a representation of recorder plats, surveys, deeds, and other collected information for use within the Geographic Information System for purposes of public access and analysis. These and other digital data do not replace or modify land surveys, deeds, and/or other legal instruments defining land ownership or use. Geauga County assumes no legal responsibility for this information.

www.auditor.co.geauga.oh.us

February 22, 2017