

RECEIVED

MAR 01 2017

OHIO EPA NEDO



**Manchester Local Schools**

6075 Manchester Rd.

Akron, Ohio 44319

(330) 882-4157 (O) / (330) 882-0013 (Fax)

**Manchester Middle School**

760 W Nimisila Rd

Akron, Ohio 44319

(O) 330-882-3812

**Contact:** Director of Services

Michael E Stafford (330) 882-4157

mike.stafford@manchester-panthers.org

**Building:**

Built New 1974

\*Modular 1995 (no water)

47,637 SqFt. (Building Only)

**PWS ID:** OH7795712, OH7762512

**Water Treatment Details:**

Well

Chlorine Injection Pump

Iron Filters (5)

Storage Tank (2500 Gallons approx)

**Water Mains:** (Cold/Hot/Return) Original Copper + Solder

**Well/Softener/Iron Filters (Tie-In):** - Plumbed in Schedule 40 PVC, L-Copper and Schedule 40 Pressure Fittings + Pro-Press Fittings, Copper Fittings and Lead Free Solder

**Comments:** Since 1988 all water line repairs have been made with L-Copper, Lead Free Solder, Pro-Press Fittings, Aqua-Pex Tubing + Brass Pex Fittings, Schedule 40 PVC + PVC Schedule 40 Pressure Fittings

All Fixtures in the building have been updated and/or replaced at least once since 1988.

Entity: Manchester Middle School  
Doc Type: Report  
Doc Subtype: \_\_\_\_\_  
Program: DDAgw  
County: Summit  
Secondary ID: OH 7762512  
eDOC in color

# Manchester Middle School

760 W. Nimisila Rd.  
Akron OH 44319  
330-882-3812



D-1-D-2

CHARLIE

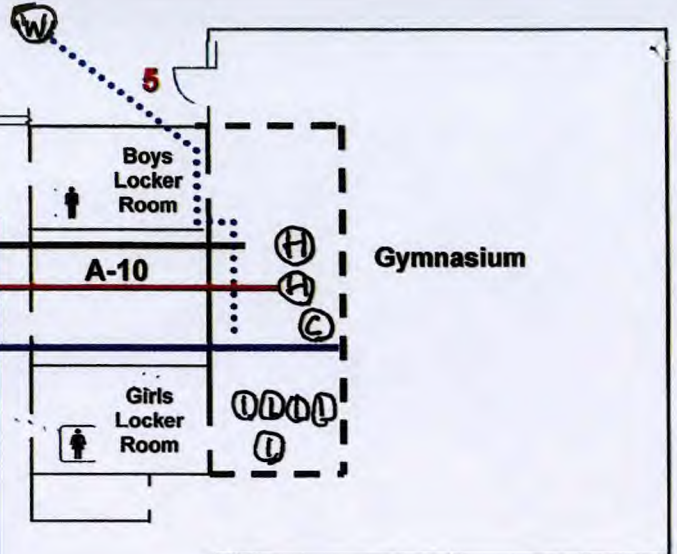
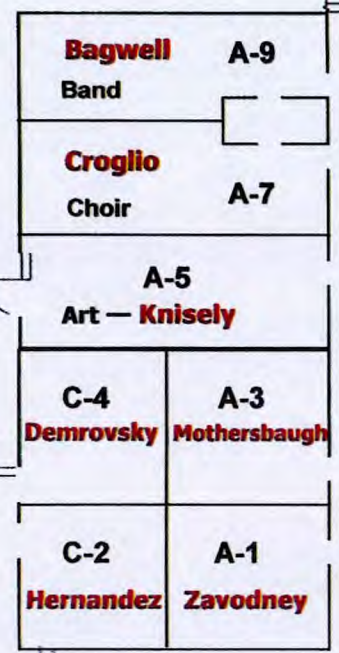

Gymnasium

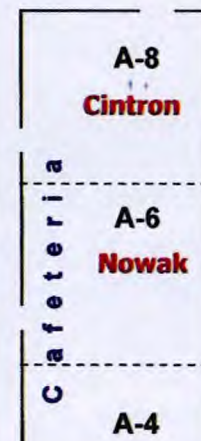
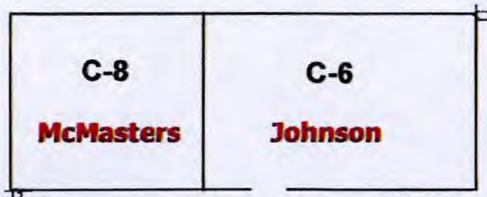

BRAVO

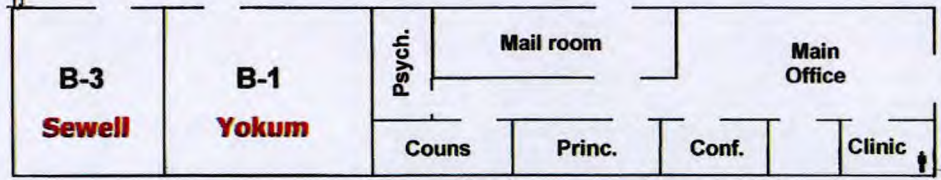

ALPHA

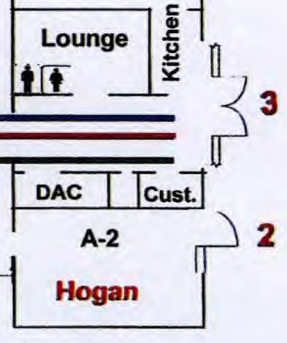
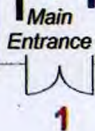

- Key:
- (W) Well
  - (I) Iron Filter
  - (S) Softener
  - (C) Chlorine Feed
  - (CCT) Chlorine Contact Tank
  - (H) Hot Water Heater
  - Cold Water Main
  - Hot Water Main
  - Hot Water Return
  - - - Water Feed From Well

6

5

7

8

9

10

4

3

2

1

# Manchester Middle School

760 W. Nimisila Rd.  
Akron OH 44319  
330-882-3812



CHARLIE

DANCE

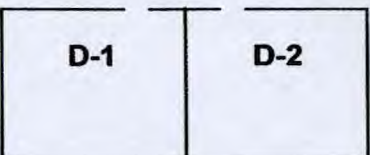
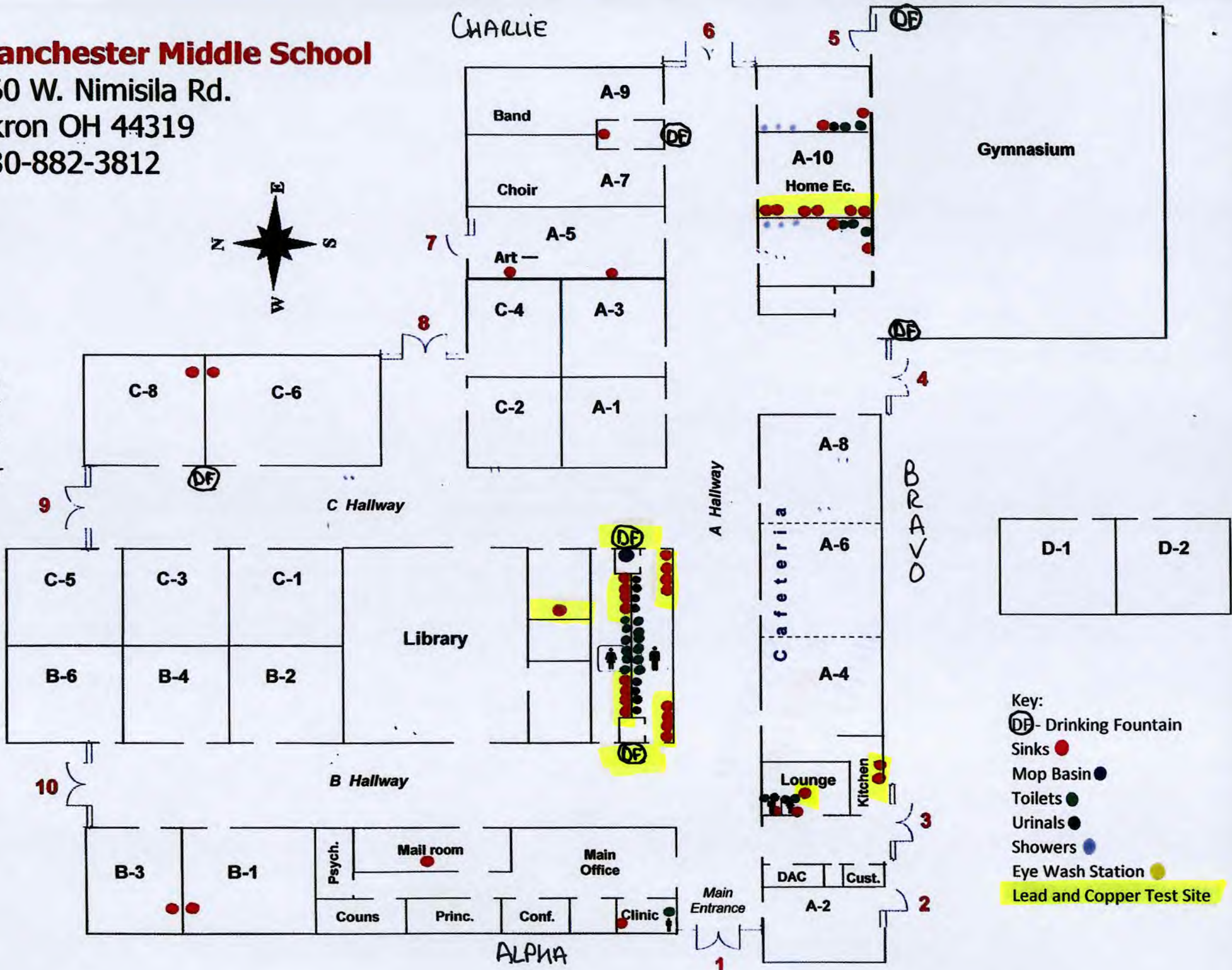

- Key:
- DF - Drinking Fountain
  - Sinks ●
  - Mop Basin ●
  - Toilets ●
  - Urinals ●
  - Showers ●
  - Eye Wash Station ●
  - Lead and Copper Test Site