

RE: Aqua Ohio - Norlick  
Report  
Drinking Water Program  
Williams County  
PWS ID: OH8601012

RECEIVED

MAR 06 2017

DDAGW - NWDO

**VERIFICATION FORM FOR COMMUNITY PUBLIC WATER SYSTEMS  
CLAIMING NO LEAD SERVICE LINES**

The owner or operator of all community public water systems must identify and map areas of their distribution system that are known or are likely to contain lead service lines. Systems must submit a copy of the applicable map to the Ohio Department of Health and the Ohio Department of Job and Family Services. Systems must also submit a report to the director containing at least both of the following: (1) The applicable map with narrative, and (2) A list of sampling locations used to collect samples as required by Ohio Revised Code (ORC) Section 6109.121 and any rules adopted thereunder, including contact information for the owner and occupant of each sampling site.

Should a water system determine no lead service lines exist in their distribution system, they must provide information stating they reviewed, at the minimum, historical permit records and local ordinances, distribution maintenance records and information pertaining to installation dates or materials for all services lines. This information must be verified below.

I HEREBY CERTIFY THAT THE FOLLOWING METHOD(S) WERE USED TO DETERMINE NO LEAD SERVICE LINES EXIST IN THIS WATER SYSTEM'S DISTRIBUTION SYSTEM, AS REQUIRED BY ORC 6109.121(F):

| LEAD SERVICE LINE VERIFICATION  |   |
|---|---|
| This PWS states they have no lead service lines and has reviewed the following information (select one or more of the following): |   |
| <input checked="" type="checkbox"/>   | Historical permit records and/or local ordinances   |
| <input checked="" type="checkbox"/>   | Distribution maintenance records (i.e. meter replacement, waterline break repairs)  |
| <input type="checkbox"/>  | Information pertaining to installation dates for all service lines (i.e. after 1986 when lead services lines were banned) |
| <input type="checkbox"/>  | Service line material of all service lines is known (i.e. all service lines are known to be PVC)                          |

  
Signature of Responsible Person

March 6, 2017

Thomas Schwing

Printed Name and Title of Responsible Person

PWS NAME: Aqua Ohio  
Norlick

PWS ID: OH8601012

COUNTY: Williams

**For Ohio EPA use only:**

Date Verification Rec'd: \_\_\_\_\_



**AQUA**

Aqua Ohio - Norlick  
PWS ID# OH8601012

**Legend**

 Aqua PWS Service Boundary

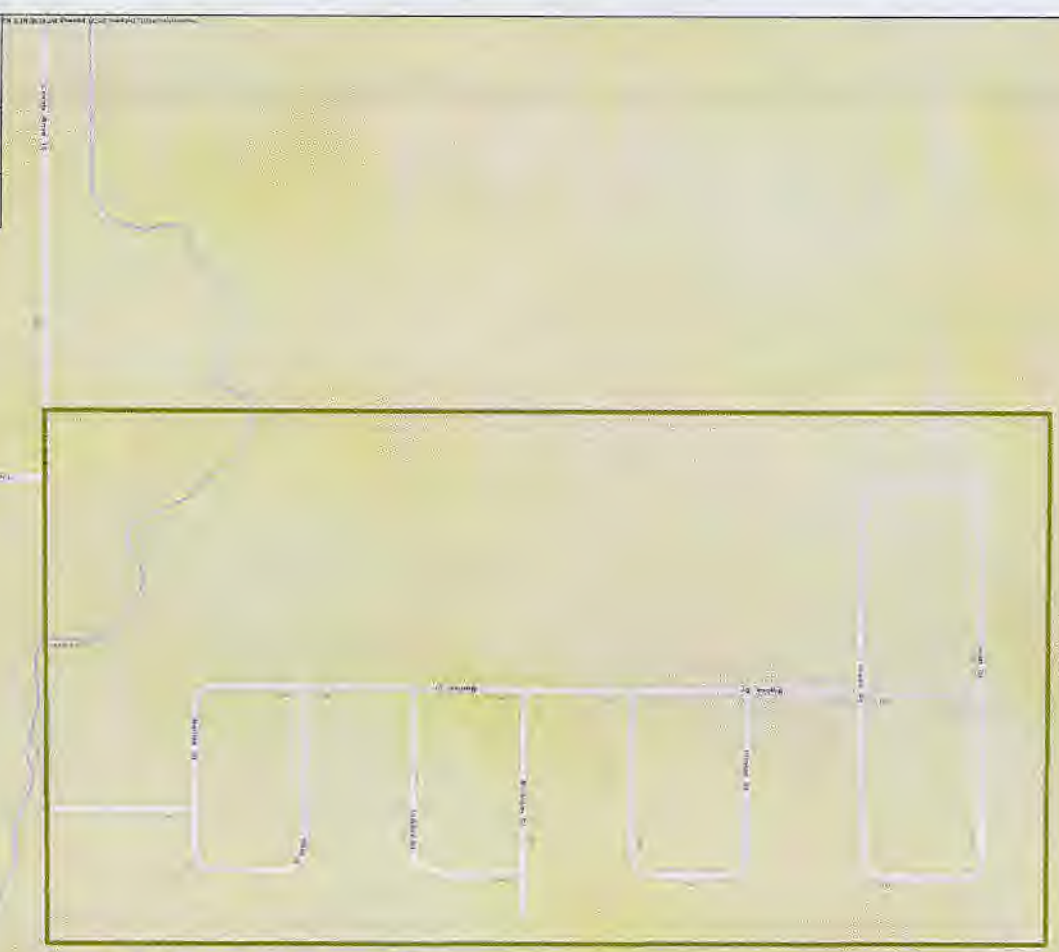

**Aqua Ohio - Norlick**  
PWS ID# OH8601012  
For more information, please call  
Aqua Customer Service  
877.987.2782  
There are no known Aqua or customer lead  
water service lines in this Public Water System.

\*This map was compiled solely for the purpose of complying with ODC Am. 6100.12(1) which  
states that the map is based upon data collected from available utility records, information  
to verify characteristics of buildings served by the system that may contain lead piping, valves  
known or likely to contain lead service lines owned by the water utility or its customers and  
lead requirements for publicly owned and non-owned of the water system and  
in lines. This map is based upon data collected from available utility records, information  
acquired during physical inspections of residential lots and includes easements owned  
upon the date in which service lines were installed or the age of the buildings receiving water  
service. Aqua cannot guarantee the accuracy of all information and assumptions related to  
this map. This map, which was developed solely for the purpose stated above, may include  
not be utilized for any other purpose, commercial or otherwise. This map will be provided  
as-is and without warranty of any kind, including fitness for purpose. Aqua reserves the right to  
update when water main and additional records or information become available. Aqua reserves the  
right to alter or amend the content of this map at any time. Each customer is responsible for  
independently verify whether the customer portion of the service line contains lead.

Buildings in Ohio that prior to 1998 or that use flammable material or rubber manufactured before  
1998 may have materials with greater than 1% lead and are at a higher risk of containing lead  
to the water main materials manufactured after 1998. In addition, buildings that are  
partially or completely manufactured after 2014 were required to have less than 0.2% lead by  
weight and have the lowest risk for containing lead to the existing water. It should be noted  
however that although prohibited, some use of leaded solder in leaded components may  
have occurred after the prohibition became effective.

**RECEIVED**  
MAR 06 2017  
DDAGW - NWDO

