

RE: Aqua Ohio - Seneca  
Report  
Drinking Water Program  
Williams County  
PWS ID: OH8601512

RECEIVED

MAR 06 2017

DDAGW - NWDO

**VERIFICATION FORM FOR COMMUNITY PUBLIC WATER SYSTEMS  
CLAIMING NO LEAD SERVICE LINES**

The owner or operator of all community public water systems must identify and map areas of their distribution system that are known or are likely to contain lead service lines. Systems must submit a copy of the applicable map to the Ohio Department of Health and the Ohio Department of Job and Family Services. Systems must also submit a report to the director containing at least both of the following: (1) The applicable map with narrative, and (2) A list of sampling locations used to collect samples as required by Ohio Revised Code (ORC) Section 6109.121 and any rules adopted thereunder, including contact information for the owner and occupant of each sampling site.

Should a water system determine no lead service lines exist in their distribution system, they must provide information stating they reviewed, at the minimum, historical permit records and local ordinances, distribution maintenance records and information pertaining to installation dates or materials for all services lines. This information must be verified below.

I HEREBY CERTIFY THAT THE FOLLOWING METHOD(S) WERE USED TO DETERMINE NO LEAD SERVICE LINES EXIST IN THIS WATER SYSTEM'S DISTRIBUTION SYSTEM, AS REQUIRED BY ORC 6109.121(F):

LEAD SERVICE LINE VERIFICATION	
This PWS states they have no lead service lines and has reviewed the following information (select one or more of the following):	
<input checked="" type="checkbox"/>	Historical permit records and/or local ordinances
<input checked="" type="checkbox"/>	Distribution maintenance records (i.e. meter replacement, waterline break repairs)
<input type="checkbox"/>	Information pertaining to installation dates for all service lines (i.e. after 1986 when lead services lines were banned)
<input type="checkbox"/>	Service line material of all service lines is known (i.e. all service lines are known to be PVC)

Thomas Schwing March 6, 2017  
 Signature of Responsible Person  
 Thomas Schwing  
 Printed Name and Title of Responsible Person

**PWS NAME:** Aqua Ohio  
 Seneca Lake  
**PWS ID:** OH8601512  
**COUNTY:** Williams

<b>For Ohio EPA use only:</b>
Date Verification Rec'd: _____

**Aqua Ohio - Seneca**  
**PWS ID# OH8601512**  
**For more information, please call**  
**Aqua Customer Service**  
**877.987.2782**

**There are no known Aqua or customer lead water service lines in this Public Water System\***

\*This map was compiled solely for the purpose of complying with DRC Act, §100.12(F) which in part requires water utility companies to identify and map areas of the water system that are known or likely to contain lead service lines owned by the water utility or its customers and to identify characteristics of buildings served by the system that may contain lead piping, solder or fittings. This map is based upon data compiled from available utility records, information acquired during physical inspections of main service lines and includes assumptions based upon the dates in which service lines were installed or the age of the buildings receiving water service. Aqua cannot guarantee the accuracy of all information and assumptions related to compile this map, which was developed solely for the purpose noted above. This map should not be utilized for any other purpose, commercial or otherwise. This map will be periodically updated when sufficient additional records or information become available. Aqua reserves the right to alter or amend the content of this map at any time. Each customer remains responsible to independently verify whether the customer portion of the service line contains lead.

Buildings in Ohio built prior to 1996 or that use plumbing material or solder manufactured before 1996 may have materials with greater than 8% lead and are at a higher risk of contributing lead to the drinking water than materials manufactured after 1996. In addition, buildings built and plumbing materials manufactured after 2014 were required to have less than 0.25% lead by weight and have the lowest risk for contributing lead to the drinking water. It should be noted however that, although prohibited, some use of leaded solder or leaded components may have occurred after the prohibitions became effective.

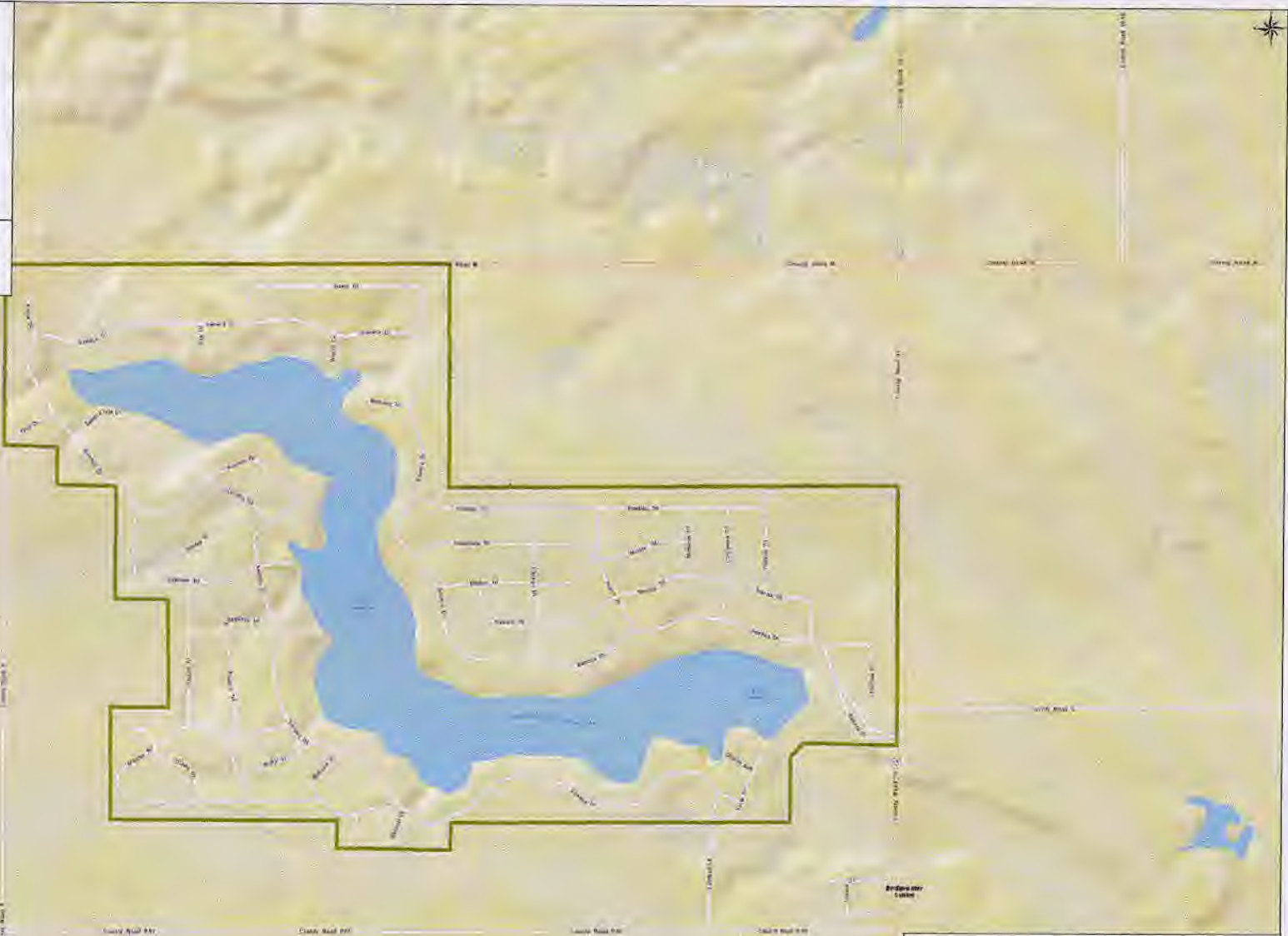

**DDAGW - NWDO**  
**MAR 06 2017**

<b>AQUA</b>	
Aqua Ohio - Seneca PWS ID# OH8601512	
<b>Legend</b>	
	Aqua PWS Service Boundary

**RECEIVED**