

RE: Attica Village
Report
Drinking Water Program
Seneca County
PWS ID: OH7400011

RECEIVED

FEB 27 2017

DDAGW - NWDO

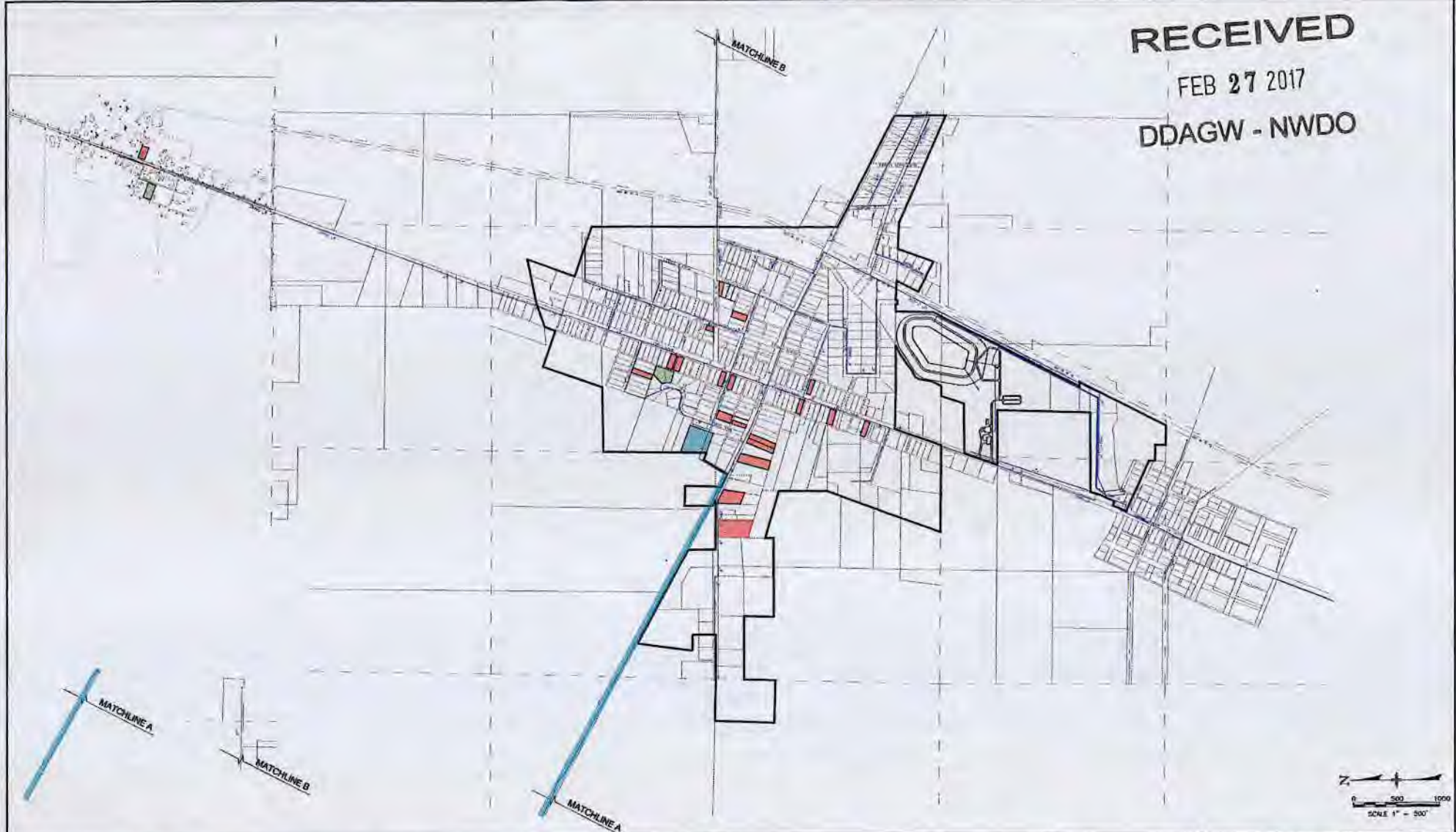

Buildings in Ohio built prior to 1998 or that use plumbing material or solder manufactured before 1998 may have materials with greater than 8% lead and are at higher risk of contributing lead to the drinking water than materials manufactured after 1998. In addition buildings built and plumbing materials manufactured after 2014 were required to have less than 0.25% lead by weight and have the lowest risk for contributing lead to the drinking water. It should be noted however that, although prohibited, some use of leaded solder or leaded components may have occurred after the prohibitions become effective.

VILLAGE OF ATTICA LEAD WATER MAP

LEGEND:

-  Lead service line
-  Built before 1998
-  Built after 1998
-  Built after 2014