

RECEIVED

MAR 03 2017

OHIO EPA NEDO

Resco Products Inc
6878 Osunburg Rd. S.E.
P.O. Box 3076
East Canton 44730
Stark County Ohio

OH 7671012

- 1) The water line from the well to the building is Black Pipe (galvanized)
 - 2) The piping of the building consists of galvanized pipe with copper lines to the plumbing fixtures. (sinks, toilet, urinals)
 - 3) The old part of the plant was constructed in the early 1800s with addition built on in 1980, 2014 and 2017. If the additions have water for production the water pipe used consists of Black pipe (galvanized)
- ④ Compiled by Tim Hetzick and correct Plant form.

Entity: Resco Products
Doc Type: Report
Doc Subtype: _____
Program: PDAGW
County: Stark
Secondary ID: OH7671012

EDOC in color

LOADING LOT

MACHINERY SHOP

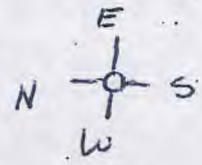

PLANT AREAS:

- A. DRAWING AND SHIPPING AREA
- B. KILN AND PRESS (HFG) AREA
- C. STORAGE AREA
- D. MORTARS AREA
- E. ANG BATCHING AREA
- F. PLANT OFFICE
- G. DRY PAN AREA
- H. CRUSHER / BUNKER AREA
- J. GARAGE
- K. STORAGE SHED
- L. STAGING AREA
- M. STARTER AREA
- N. HEATED STORAGE ROOM
- O. ELECTRIC SHOP
- P. LABORATORY / RESEARCH
- Q. MAINTENANCE SHOP
- R. BIN AREA

EVACUATION PLAN:

IF DURING AN EMERGENCY YOU ARE LOCATED IN AREA'S A,E,J,K,L,M, OR N, YOU ARE TO MEET IN THE LOADING LOT.

IF YOU ARE LOCATED IN AREA'S B,C,D,F,G,H,O,P,Q, OR R, YOU ARE TO MEET IN THE WEST PARKING LOT.

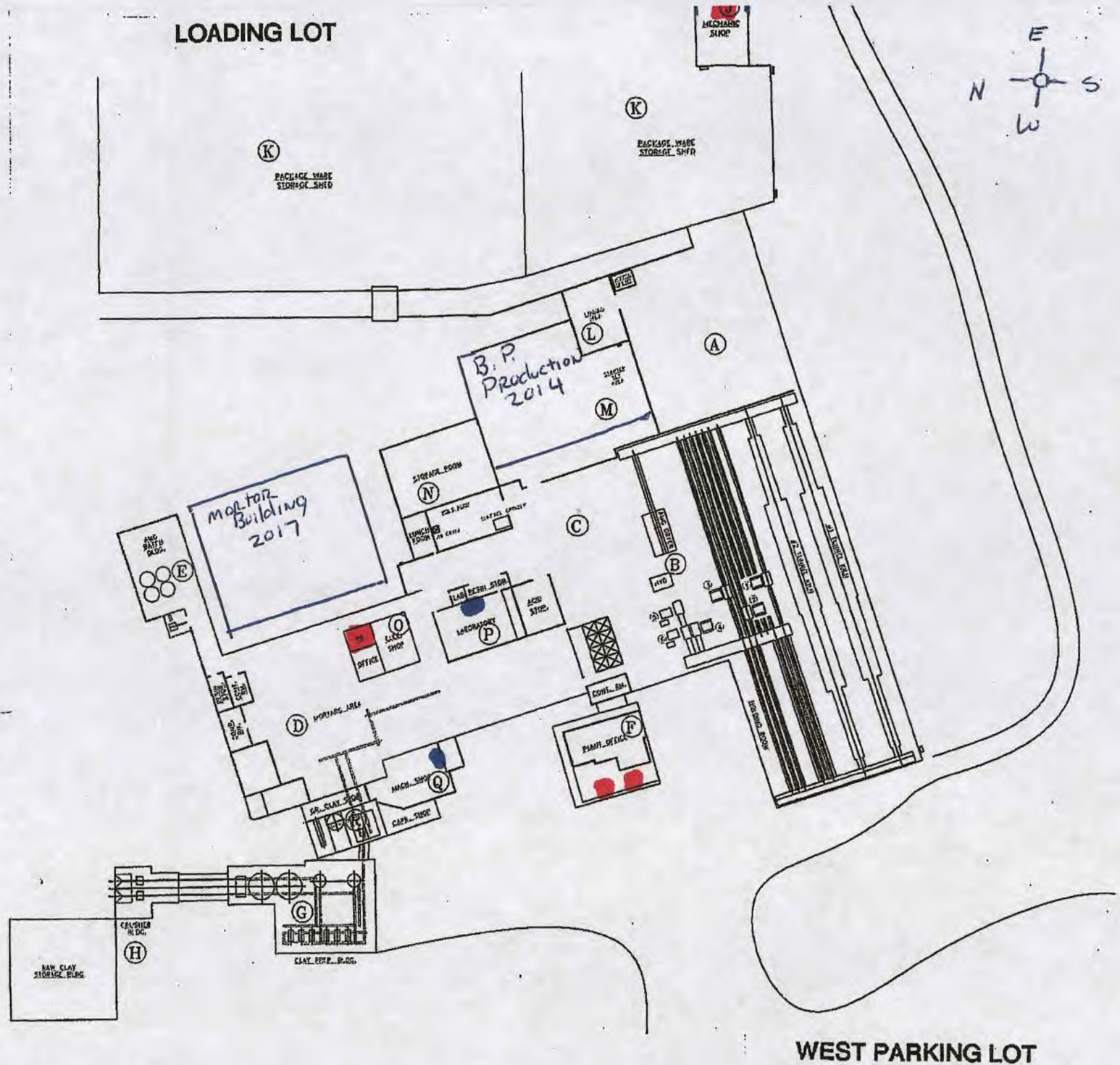

1 Handsinks
Restrooms

WEST PARKING LOT

Resoo Industries