

RECEIVED  
 MAR 06 2017  
 OHIO EPA NEDO

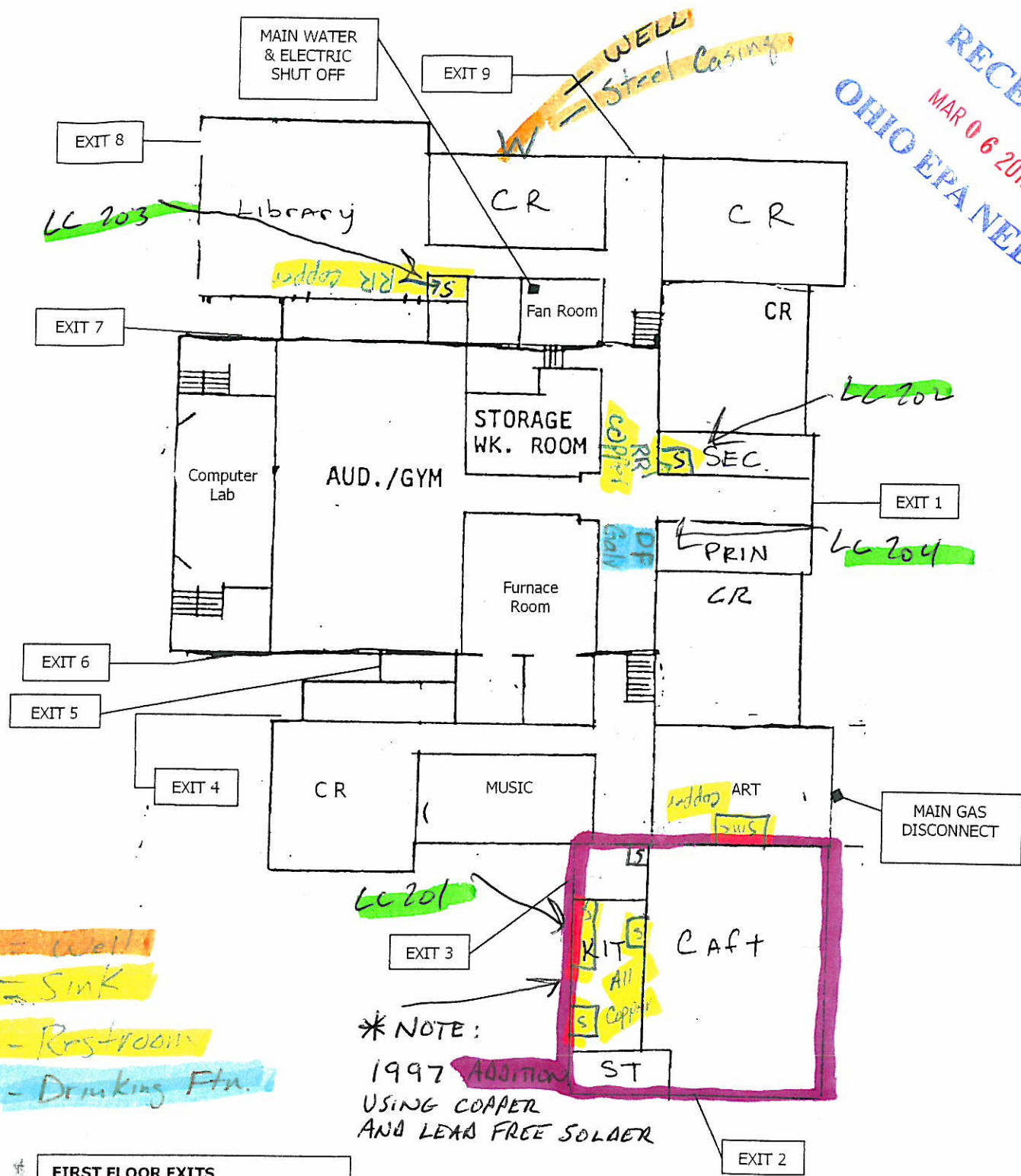

W = Well  
 S = Sink  
 RR = Restroom  
 DF = Drinking Ftn.

\* NOTE:  
 1997 ADDITION  
 USING COPPER  
 AND LEAD FREE SOLDER

\* ORIGINAL BLDG 1930 - GALVANIZE PIPING

- FIRST FLOOR EXITS**
- 1 WEST (MAIN) EXIT
  - 2 CAFETERIA EXIT
  - 3 NORTH (KITCHEN) EXIT
  - 4 NORTHEAST CLASSROOM EXIT
  - 5 FURNACE ROOM EXIT
  - 6 NORTH GYM EXIT
  - 7 SOUTH GYM EXIT
  - 8 LIBRARY EXIT
  - 9 SOUTH EXIT



Clark Elementary School  
 1390 State Route 83  
 Clark, Ohio 44654  
 IRN 068445

OH3831112

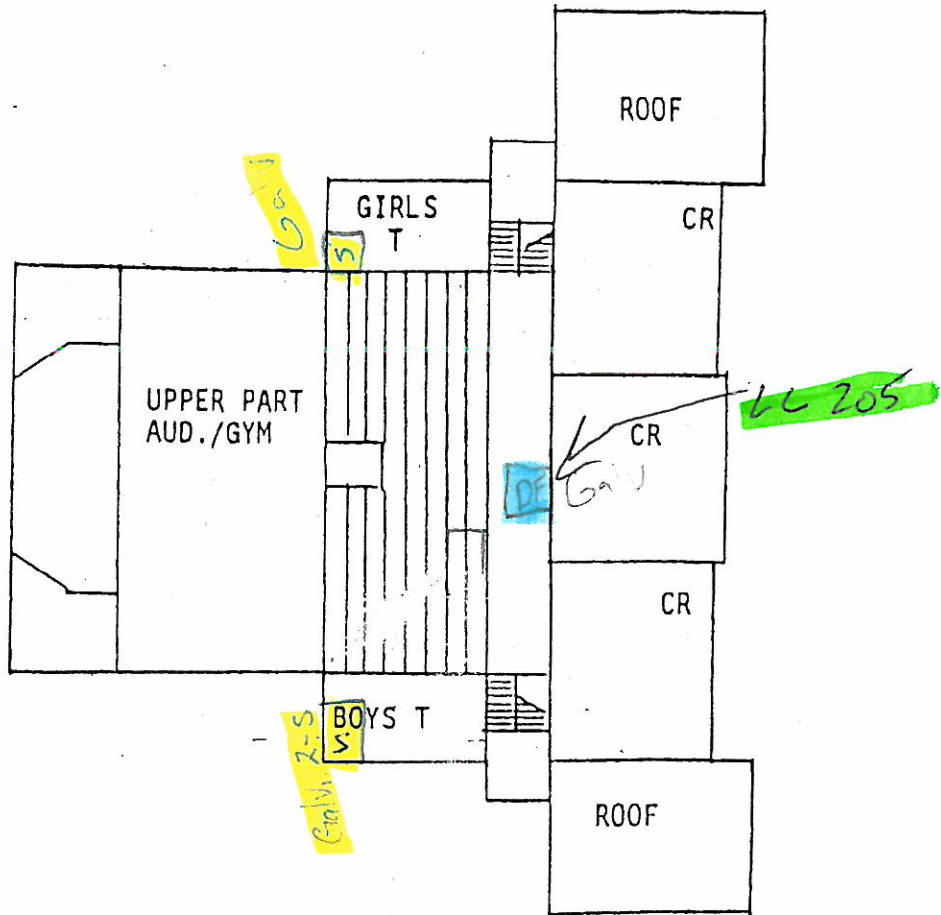

**SECOND FLOOR EXITS**  
NONE

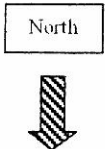

**Clark Elementary School**  
1390 State Route 83  
Clark, Ohio 44654  
IRN 068445