

Mineral Ridge PWS OH7803503

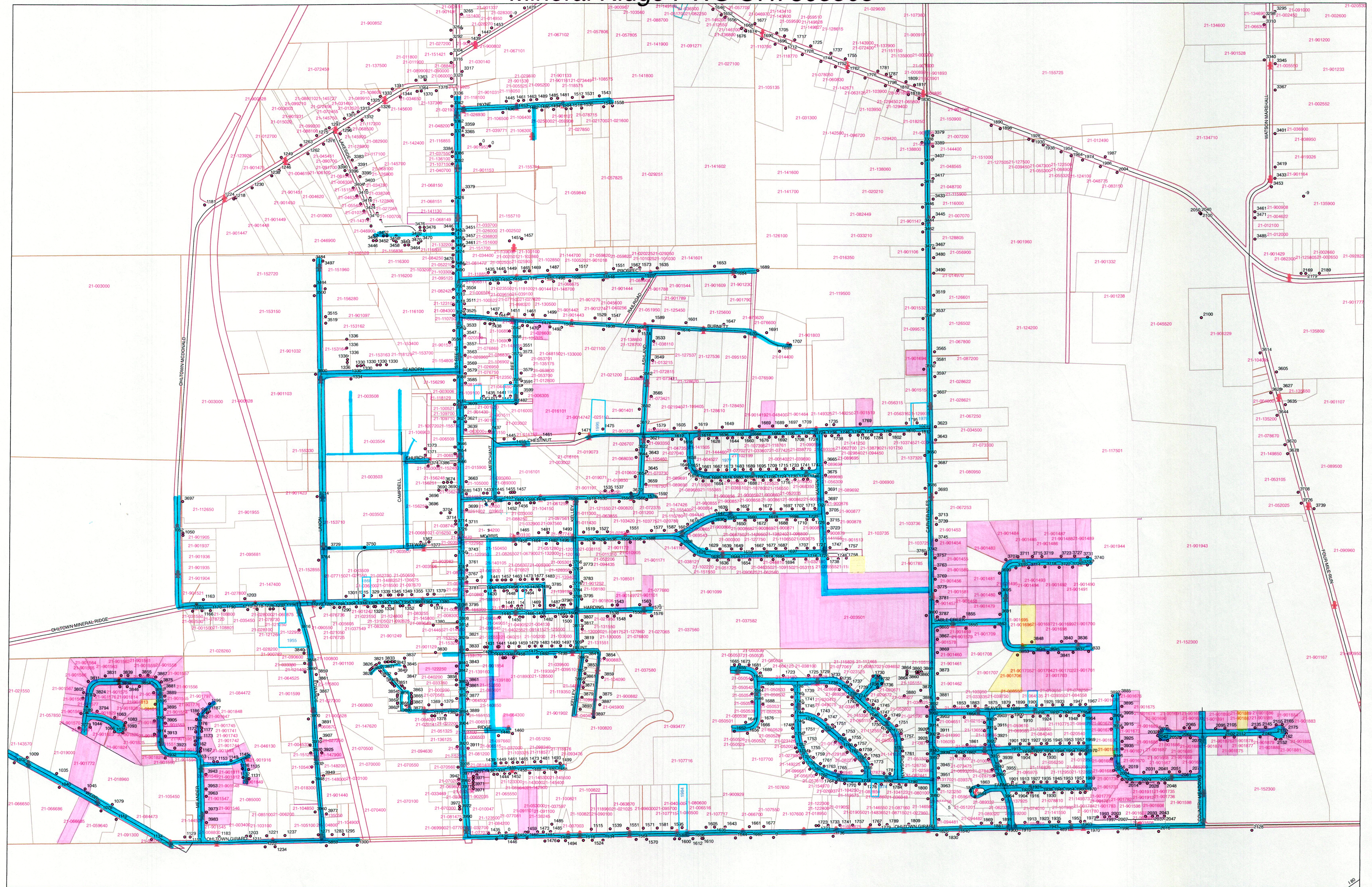

1998-2014 2014-PRESENT



WATER LINE

510 255 0 510 Feet



Mineral Ridge PWS OH7803503

According to field personnel, no known lead service lines are in this system.

Age of homes were determined by the Trumbull County Auditors Web Site.

Mineral Ridge Water District consists of 1086 service connections as of February 2017.

Customers in this district, not colored with pink or yellow highlighter, are pre 1998

Water lines for this district have been marked with blue highlighter.

Sample sites are outlined in blue ink.