



*water treatment, inc.*

East Ohio Machine was originally built in 1960 with a large addition in the 1990's, however due to consolidation the newer part of the building is no longer in use and are not suitable sites for lead and copper sampling. All plumbing in the currently used part of the building is copper and is original to construction.

EAST OHIO MACHINE PWS# 1545412

FRONT OF BUILDING  
FACING RT 62

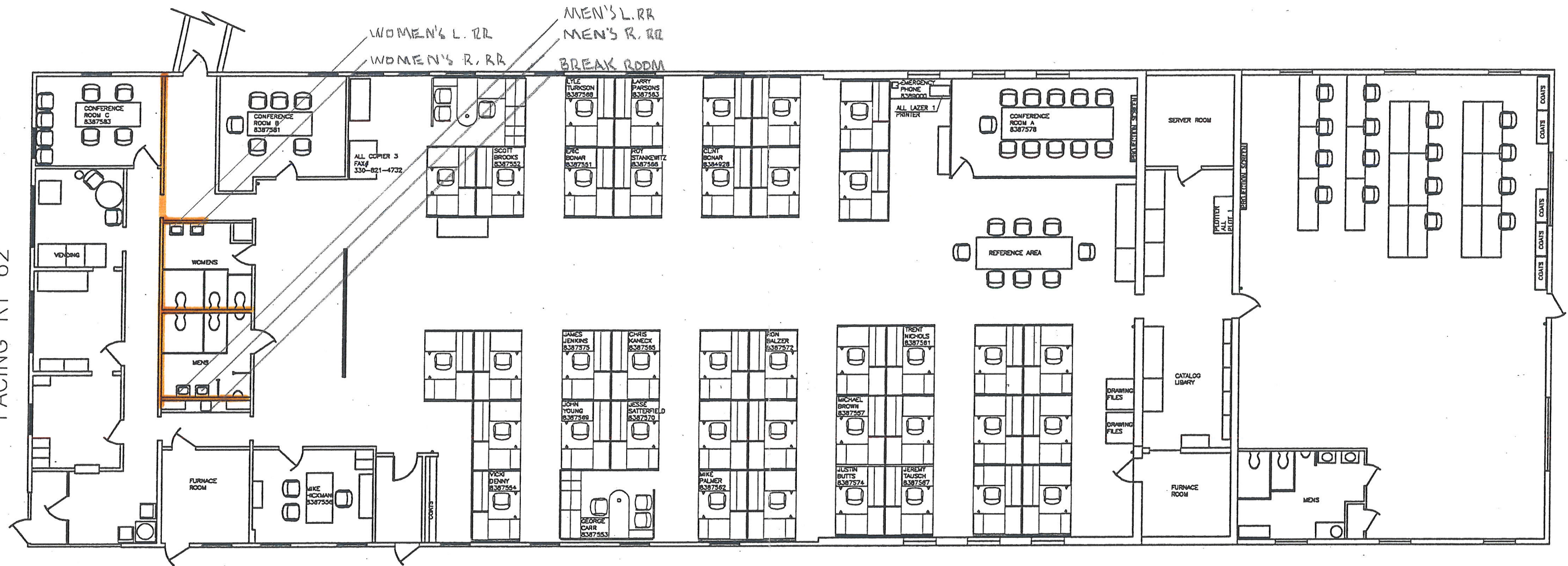

— DENOTES C. PLUMBING CIRCA 1960