

1998-2014 2014-PRESENT WATER LINE

# Howland Twp OH7806303

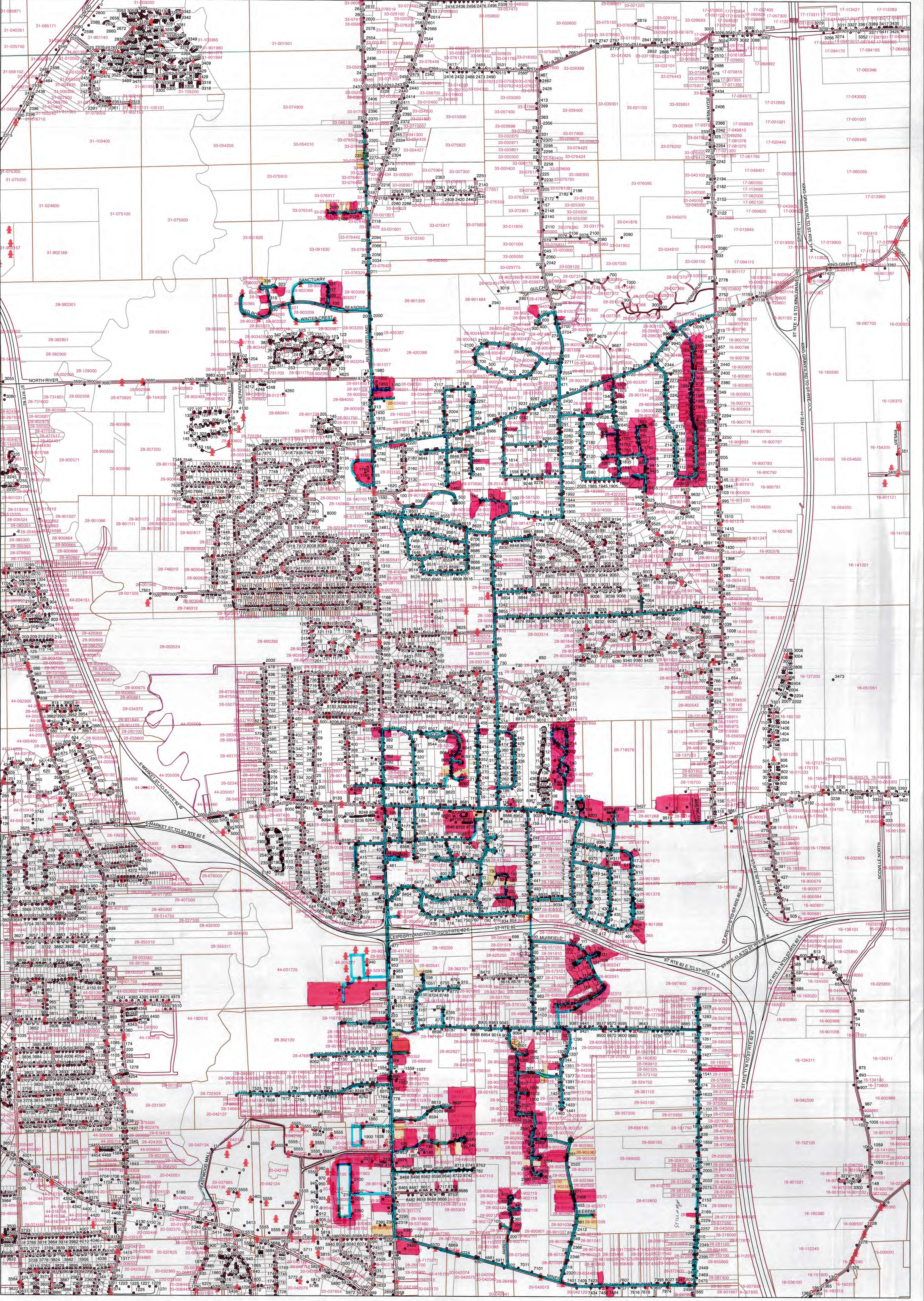

800 400 0 800 Feet





## Howland PWS OH7806303

According to field personnel, no known lead service lines are in this system.

Age of homes were determined by the Trumbull County Auditors Web Site.

Howland Water District consists of 2325 service connections as of February 2017.

Customers in this district, not colored with pink or yellow highlighter, are pre 1998

Water lines for this district have been marked with blue highlighter.

Sample sites are outlined in blue ink.

**VERIFICATION FORM FOR COMMUNITY PUBLIC WATER SYSTEMS  
CLAIMING NO LEAD SERVICE LINES**

The owner or operator of all community public water systems must identify and map areas of their distribution system that are known or are likely to contain lead service lines. Systems must submit a copy of the applicable map to the Ohio Department of Health and the Ohio Department of Job and Family Services. Systems must also submit a report to the director containing at least both of the following: (1) The applicable map with narrative, and (2) A list of sampling locations used to collect samples as required by Ohio Revised Code (ORC) Section 6109.121 and any rules adopted thereunder, including contact information for the owner and occupant of each sampling site.

Should a water system determine no lead service lines exist in their distribution system, they must provide information stating they reviewed, at the minimum, historical permit records and local ordinances, distribution maintenance records and information pertaining to installation dates or materials for all services lines. This information must be verified below.

I HEREBY CERTIFY THAT THE FOLLOWING METHOD(S) WERE USED TO DETERMINE NO LEAD SERVICE LINES EXIST IN THIS WATER SYSTEM'S DISTRIBUTION SYSTEM, AS REQUIRED BY ORC 6109.121(F):

<b>LEAD SERVICE LINE VERIFICATION</b>
<p><b>This PWS states they have no lead service lines and has reviewed the following information (select one or more of the following):</b></p> <ul style="list-style-type: none"><li><input type="checkbox"/> Historical permit records and/or local ordinances</li><li><input checked="" type="checkbox"/> Distribution maintenance records (i.e. meter replacement, waterline break repairs)</li><li><input type="checkbox"/> Information pertaining to installation dates for all service lines (i.e. after 1986 when lead services lines were banned)</li><li><input type="checkbox"/> Service line material of all service lines is known (i.e. all service lines are known to be PVC)</li></ul>

<p>* <u><i>Terry Myers</i></u>      <u>3-8-17</u> Signature of Responsible Person      Date</p> <p><u>TERRY MYERS CHIEF WATER OPERATOR</u> Printed Name and Title of Responsible Person</p>	<p style="text-align: right; margin-right: 50px;"><i>TRUMBULL</i> <i>COUNTY</i></p> <p>PWS NAME: <u>HOWLAND TWP.</u> PWS ID: <u>OH 7806303</u> COUNTY: <u>TRUMBULL</u></p>
---	--

\*I cannot verify the type or condition of any service lines from our water system into the home/building. This signature is conditioned solely upon my personal knowledge of reasonably known facts on the above date.

**For Ohio EPA use only:**

Date Verification Rec'd: \_\_\_\_\_