









Building was constructed in 1972 and plumbed before 1983; new well installed in 2016

Building is lead pipe free; Building contains soldering which may contain lead traces;

Well Casing – Steel; Service Line to building – 2” PVC pipe

Distribution Lines in the building – mix of copper pipes and PVC pipes

Main Legend and Pipe Descriptions

A	3 bowl sink located on the upper level – used as a lead & copper sample site (LC01)
B	kitchen utility sink on the upper level – used as a lead & copper sample site (LC02)
C	toddler handwashing sink on the upper level – used as a lead & copper sample site (LC03)
	hot water tank
	hot water line
	cold water line
	pressure tank
	water softener
D	staff restroom handwashing sink on the lower level – used as a lead & copper sample site (LC04)
E	infant handwashing sink on the lower level – used as a lead & copper sample site (LC05)
	line comes from lower level to upper level
	line goes to upper level of the building
	location of a sink NOT used for lead & copper sampling

Description of upper level piping:

From the softener on the lower level to the upper level (directional down arrow) into the hot water tank (pink hexagon on the map) - copper; from the hot water tank to sinks on the upper level (green circles and A, B, C) - copper

Description of lower level piping:

From well into the building to the pressure tank (yellow triangle on the map) – pvc; from the pressure tank into the water softener (purple star on the map) – copper; from the softener to the hot water tank (pink hexagon on the map) and upper level (directional up arrow) is copper; from the hot water tank to sinks on the lower level (green circles and D, E) - copper

Map of upper level

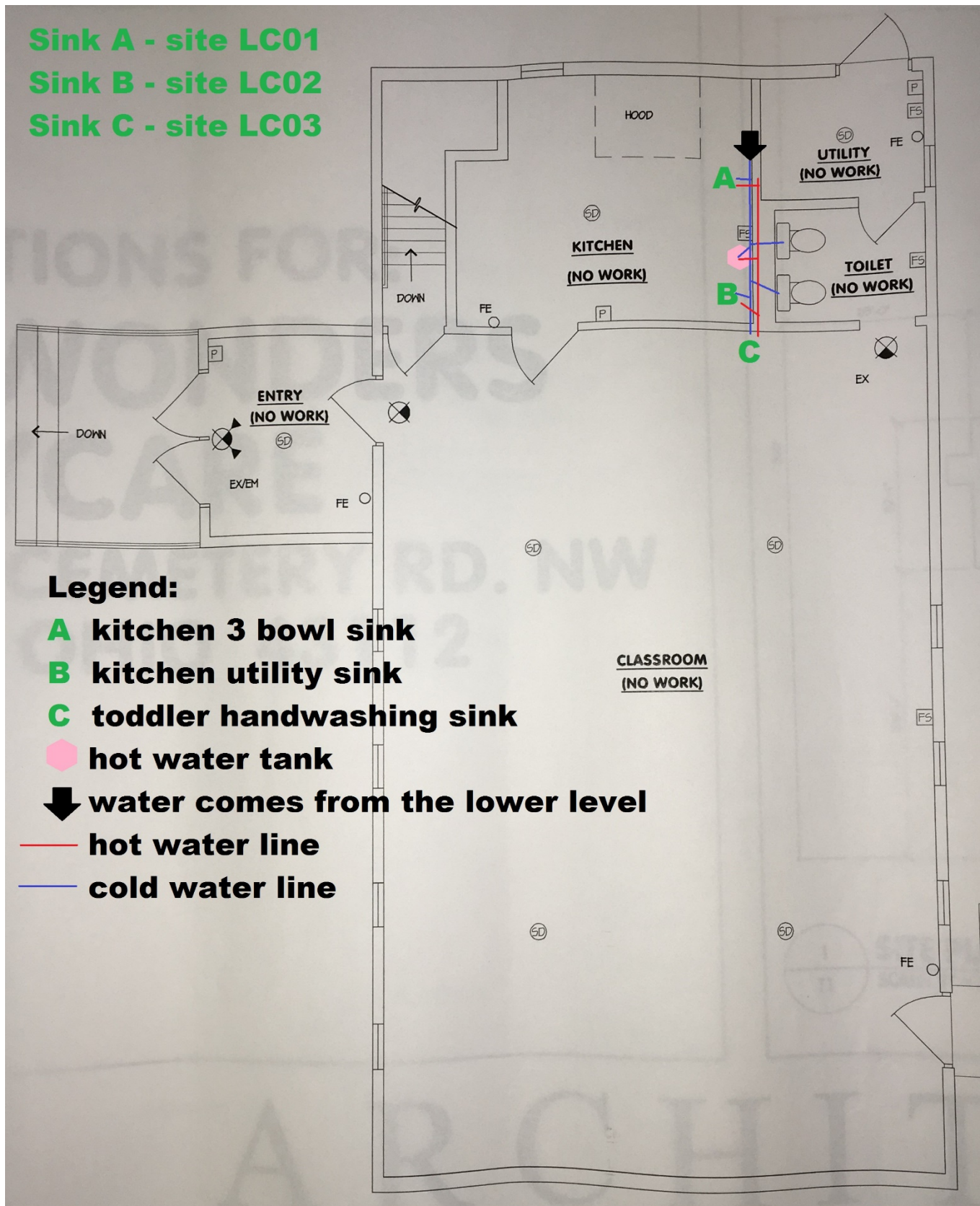

Description of upper level piping:

From the softener on the lower level to the upper level (directional down arrow) into the hot water tank (pink hexagon on the map) - copper; from the hot water tank to sinks on the upper level (green A, B, C) - copper

Map of lower level

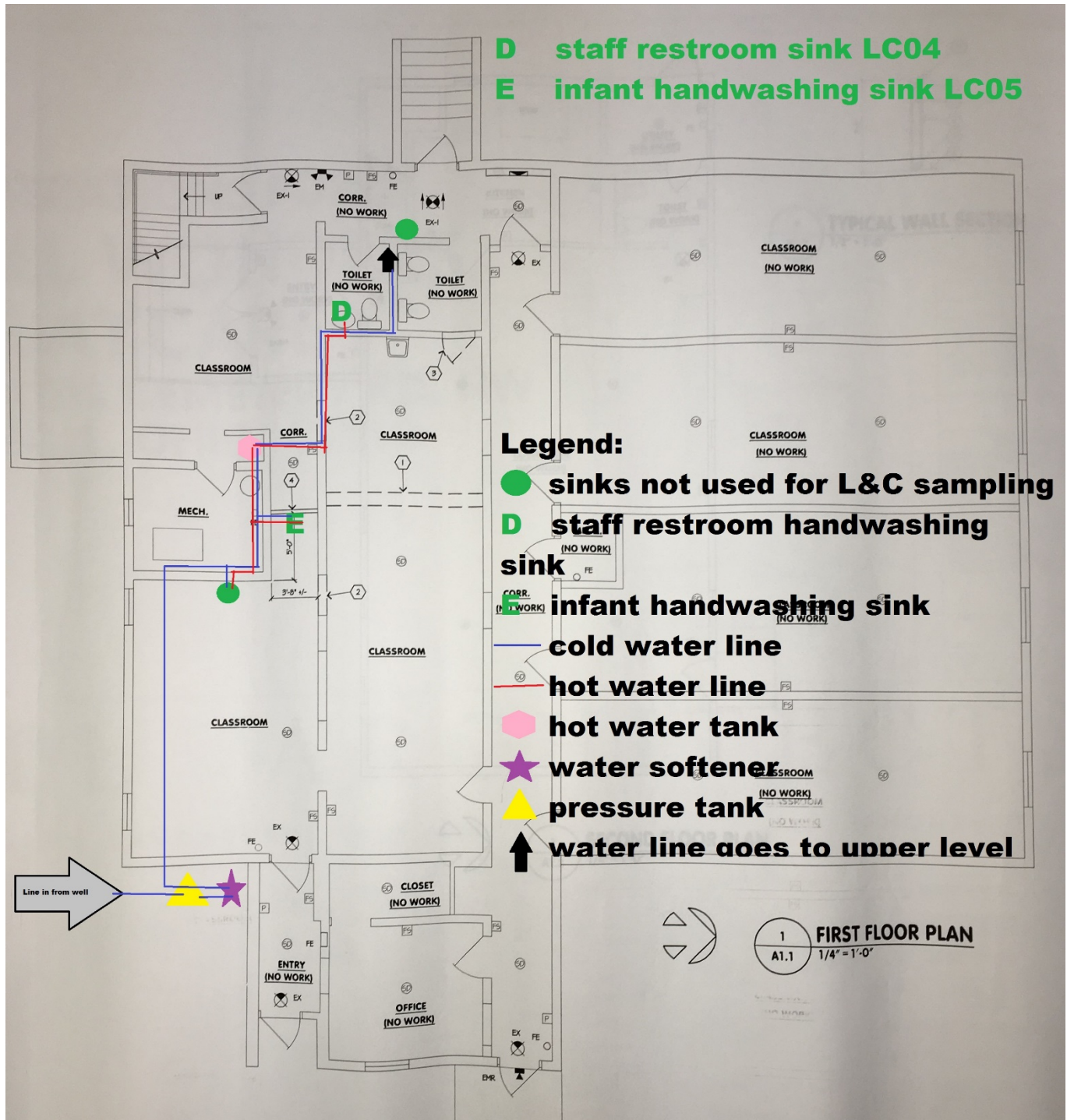

Description of lower level piping:

From well into the building to the pressure tank (yellow triangle on the map) – pvc; from the pressure tank into the water softener (purple star on the map) – copper; from the softener to the hot water tank (pink hexagon on the map) and upper level (directional up arrow) is copper; from the hot water tank to sinks on the lower level (green circles and D, E) - copper