

LEAD AND COPPER SAMPLE MONTITORING SAMPLE POINTS

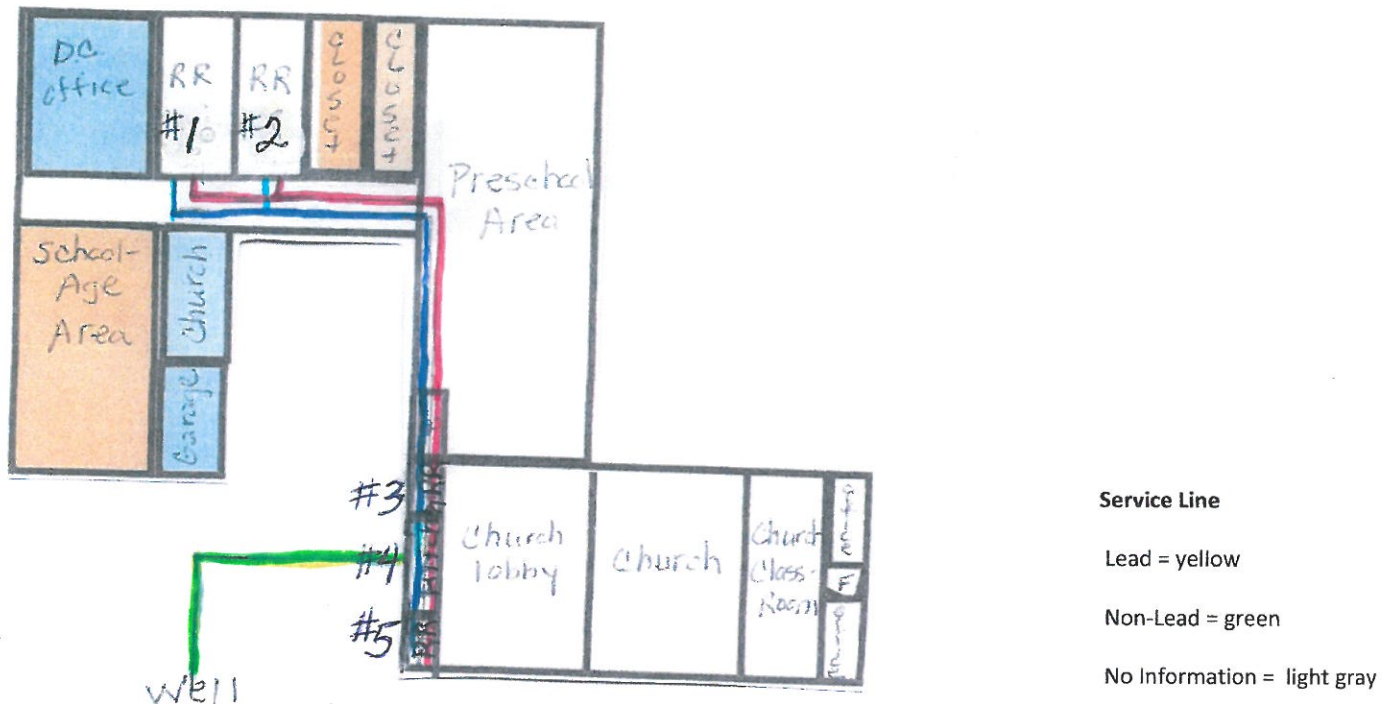

Building was constructed in 1987 per the well log and drilling report #658392.

Building is lead pipe and solder free. Prior water sampling shows no results with any lead.

Water distribution lines consist of PVC pipe and possible copper pipe as water sampling shows evidence of copper.

The service line from the well is constructed of high density polyethylene (HDPE) pipe.

Fixtures :

#1 Girls Restroom (Daycare)	approximately 2012	Lead free
#2 Boys Restroom (Daycare)	approximately 2012	Lead free
# 3 Women's Restroom (Church)	approximately 1987	Lead free
#4 Kitchen	2005	Lead free
# 5 Men's Restroom (Church)	approximately 1987	Lead free

before 1998 there was no limit on lead, may have materials with greater than 8% lead and are at a higher risk of contributing lead to the drinking water than materials manufactured after 1998,

1998 – 2014 lead solder was banned and there was lower content of lead in brass,

After 2014 plumbing materials were required to have less than 0.25% lead by weight and have the lowest risk for contributing lead to the drinking water.

PSW Name: Mom and Me Academy / Gateway Church of the Nazarene

Contact: Vicki Johnson

PWS number: 2350812

Address: 2150 Joye Lane

Type of System: Non-transit / Non community

Lancaster Ohio 43130

Phone: 740-654-6262

E-mail: momandmeacademy@sbcglobal.net