

LANCASTER COUNTRY CLUB

BUILT: 1975 ADDITION: 1995

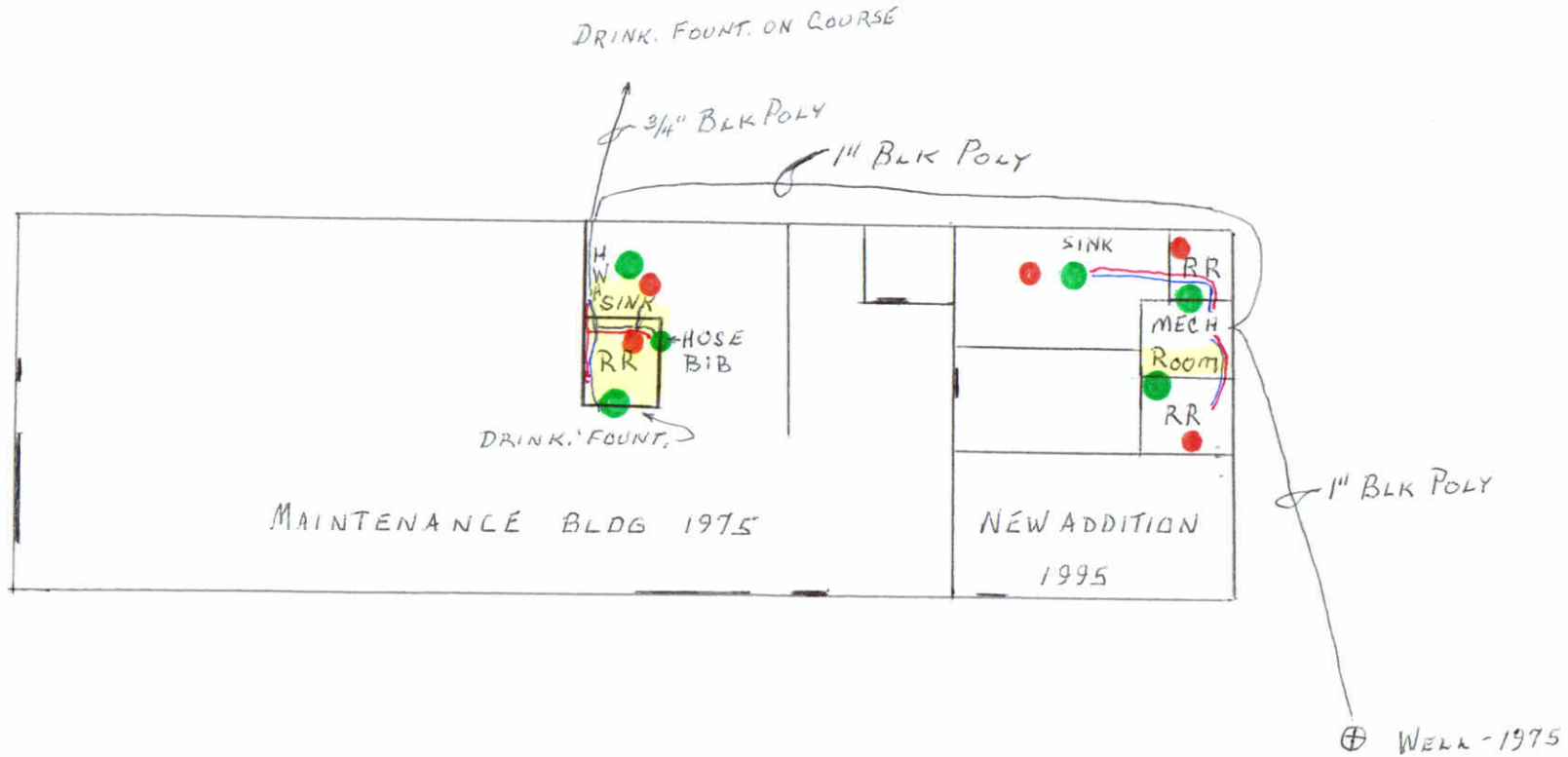

● POTENTIAL SOLDER BEFORE 1998

● PIPING END POINT

● SAMPLE SITE

- Before 1998 there was no limit on lead, may have materials with greater than 8% lead and are at a higher risk of contributing lead to the drinking water than materials manufactured after 1998.
- 1998-2014 lead solder was banned and there was lower content in brass
- After 1998 plumbing materials were required to have less than 0.25% lead by weight and have the lowest risk for contributing lead to the drinking water

2841 B.I.S. RD.

SCALE 1" = 20'

Lancaster Country Club Maintenance Building

The Golf Course Maintenance Building was built in 1975 and the well was drilled that same year. A one inch black poly pipe was installed from the well to the back of the building up through the floor. All piping installed in this building was copper with solder connections. The plumbing services a restroom, a shop clean up sink, a hose bib and a drinking fountain.

An addition to the building was finished in 1995. The footprint of the building was over the path of the one-inch poly line. A new line was installed into the new addition into a mechanical room where a new pressure tank was placed. A line was taken from the mechanical room and attached to the line running to the original building. The plumbing inside the new addition is black poly pipe into the pressure tank. From the pressure tank copper pipe (w/ soldered joints) runs through a cartridge filter, then splits off one line running to the HWH then both pipes into a manifold hot & cold. From the manifold separate lines run to the member's restroom, the employee's restroom and the break room sink. All lines from the manifold are polybutylene. A quarter inch tap at the pressure tank allows for testing raw water.