

ATTACHMENT 2

ALL POTABLE WATER

10 FEET

— COPPER
— PLASTIC

K & B MOLDED PRODUCTS
PLANT 1 **LEVEL 2**
1970
23 FEB 2017

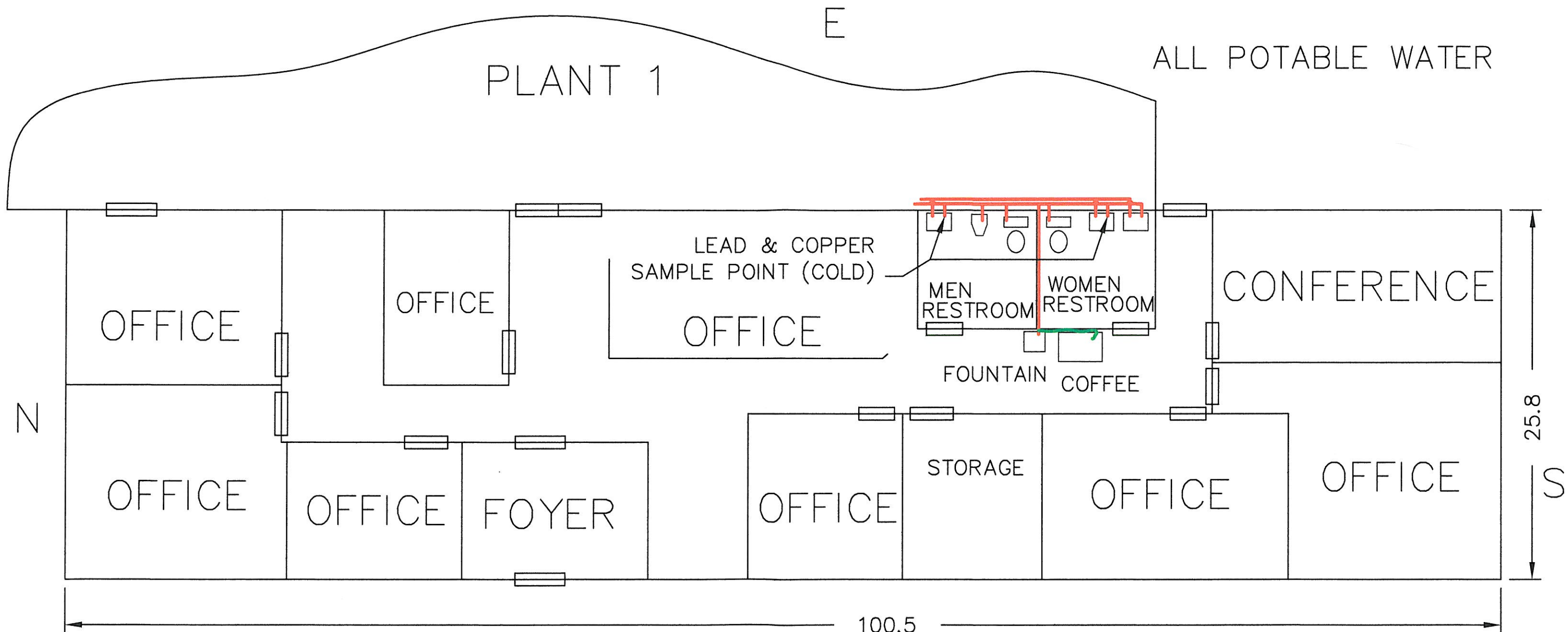

W

— COPPER
— PLASTIC

10 FEET

K & B MOLDED PRODUCTS
OFFICES 1970
23 FEB 2017

ATTACHMENT 4

ALL POTABLE WATER



10 FEET

- COPPER
- PLASTIC
- PVC
- RUBBER

KUHNS MOLD & TOOL
TOOL SHOP 1981
23 FEB 2017

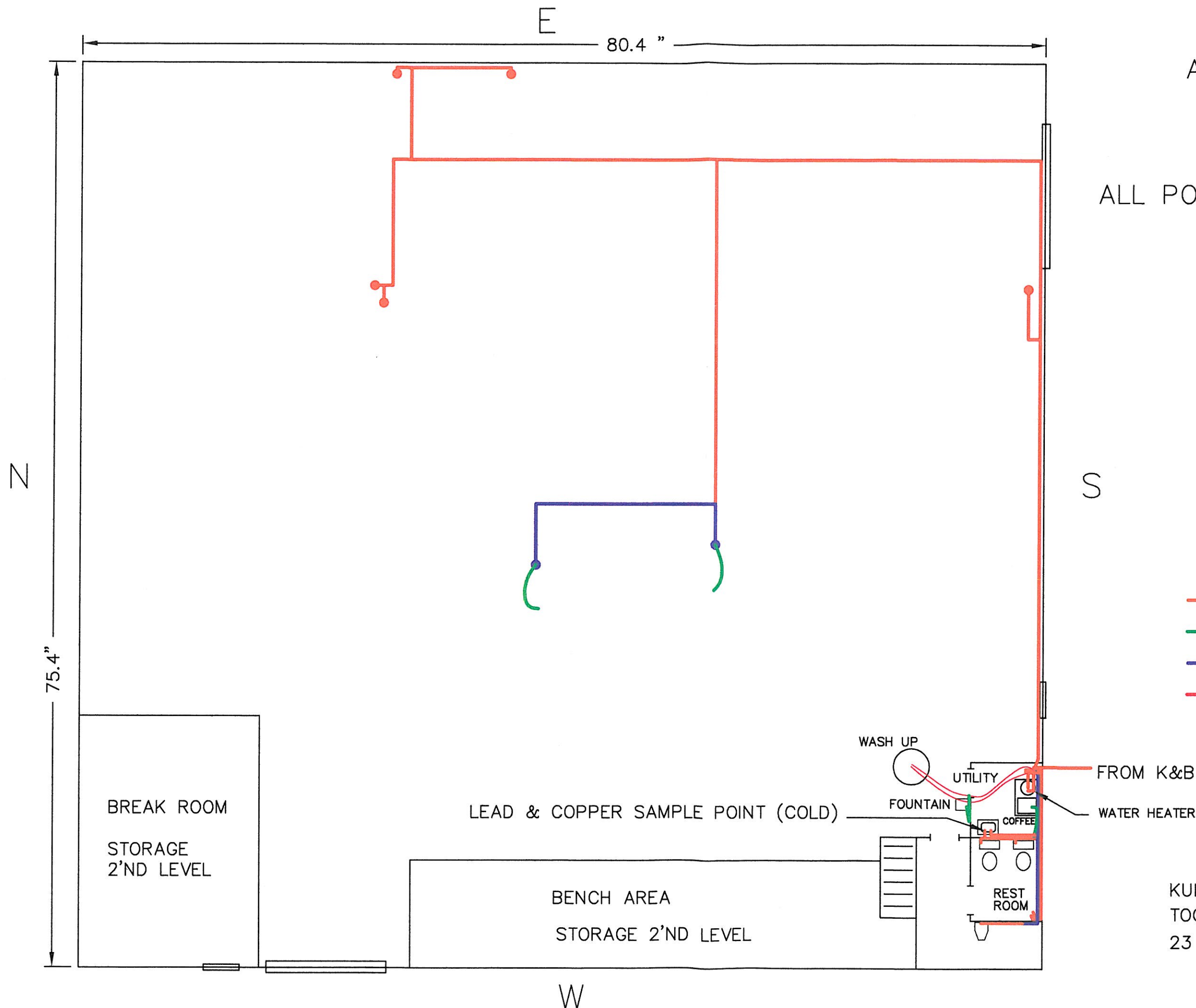

K & B Molded Products water system for potable water

The system consists of a well, one pressure tank, and two water heaters and associated piping.

The pressure tank is on level 2 in plant number 1 and is supplied by copper piping.

All piping was installed around 1970

All fixtures were installed about 10-12 years ago. [We updated everything about that time frame].

In 1970 When the original buildings were built they used all copper or PVC. All the portable water is in the original buildings.

Location legend:

LC201 Shop women's bathroom

LC202 Shop men's restroom

LC203 Office women's restroom

LC204 Office men's restroom

LC205 Tool shop restroom

Because it is practically impossible to determine the lead content of an installed fixture, fitting or pipe, it should be assumed that the manufacture or installation date is the primary indicator of the lead content. Therefore, the characteristics of the buildings and piping solder or fixtures would be buildings built prior to 1998 or that use plumbing material or solder manufactured before 1998 may have materials with greater than 8% lead are at a higher risk of contributing lead to the drinking water than materials manufactured after 1998.

In addition, buildings built and plumbing materials manufactured after 2014 were required to have less than 0.25% lead by weight and have lowest risk for contributing lead to the drinking water. It should be noted however that, although prohibited, some use of leaded solder or leaded components may have occurred after the prohibitions became effective.