



Service Department  
Water Treatment Plant Manager  
513/523-5014 fax 513/273-2002

OEPA-SWDO-DDAGW  
Dan Cloyd  
401 East Fifth Street  
Dayton, Ohio 45402-2911

March 2, 2017

Mr. Cloyd,

This correspondence regards our City's Lead Service Line Mapping Project and includes a narrative related our service area's household plumbing materials characteristics, associated maps and detailed descriptions of pipe materials, either lead or non-lead, and defines the ownership of such service lines by the City of Oxford or the property owners served by the City of Oxford.

**Narrative**

The City of Oxford (Oxford), located in Butler County, Ohio, was incorporated as a City in 1971 and operates a Public Water System under Ohio Environmental Protection Agency unconditional license number 0902312-1115500-2017. The community was founded on February 6, 1810 by directive of the Ohio General Assembly and incorporated as the Village of Oxford on February 23, 1830.

Oxford's original centralized public water system was installed in 1895 and included a stand pipe, cast iron water mains, and lead service lines. This original service area is encompassed within the Service Line Detail Map (Map) which compliments this narrative as page 2 of the Map. As demonstrated within the Map, over 200 structures are designated as being served through a lead service line on either the City owned or privately owned segment of the water service, and meet the definition of Tier 1 Lead and Copper sample sites. The majority of structures within this area are known to include plumbing which incorporates lead solder and fixtures produced prior to the promulgation of Federal and State lead content reduction regulations. These regulations originated at the federal level in 1986, through amendment of the Safe Drinking Water Act establishing a definition of "lead-free" as having no more than 8% weighted average of lead content, and resulted in changes in the Ohio Plumbing Code on March 30, 1998. No lead service lines exist in the remainder of Oxford's water service area.

Additional single family structures meeting the Tier 1 sample site definition by virtue of including lead solder, and having been constructed between 1983 and 1986, are also

illustrated on page 1 of the Map. These structures are also known to contain plumbing fixtures which predate lead content reduction regulations at either the Federal or State level.

The majority of structures served by Oxford's water system are Tier 2 or Tier 3 lead and copper monitoring sample sites, as shown on page 1 of the Map. These sites are likely to include a variety of lead solder types and plumbing fixtures which exceed the current definition of "lead free", but do not fall into the acceptable range of construction dates (1983 – 1986), providing designation as Tier 1 monitoring sites.

The balance of Oxford's water service area contains structures built since January 2014 when the latest iteration of lead reduction regulations resulted in the reduction of acceptable lead content in plumbing fixtures as less than 0.25 percent wetted surface material, and are also indicated on page 1 of the Map.

Please do not hesitate to contact me with any questions or observations regarding this submittal.

Thank you,

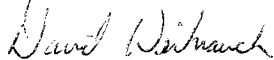

David Weihrauch  
WS3-1009131-90

Water Treatment Plant Manager  
City of Oxford  
101 East High Street  
Oxford, Ohio 45056

Attachments;

City of Oxford PWS OH0902312 Water Service Line Material Map

City of Oxford PWS OH0902312 Water Service Line Material Detail Map



# City of Oxford PWS OH0902312

## Water Service Line Material

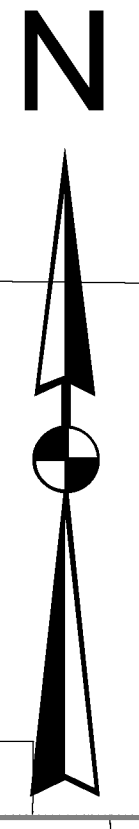

SEE SERVICE LINE DETAIL  
PAGE 2 OF 2

**City of Oxford Water Service Legend**

- Tier 1, 1850 - 1945 With Some Lead Service Lines
- Tier 1, 1983 - 1986 With No Lead Service Lines
- Tier 2 or 3 Constructed Prior to <0.25% of Lead Content Per. Regulation (Oxford's Water Service Boundary)
- Tier 3 2015 - Present <0.25% Lead Content Per. Regulation

AS OF 2/28/16

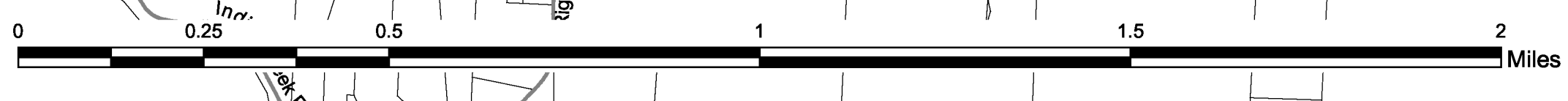



# City of Oxford PWS OH0902312 Water Service Line Material Detail

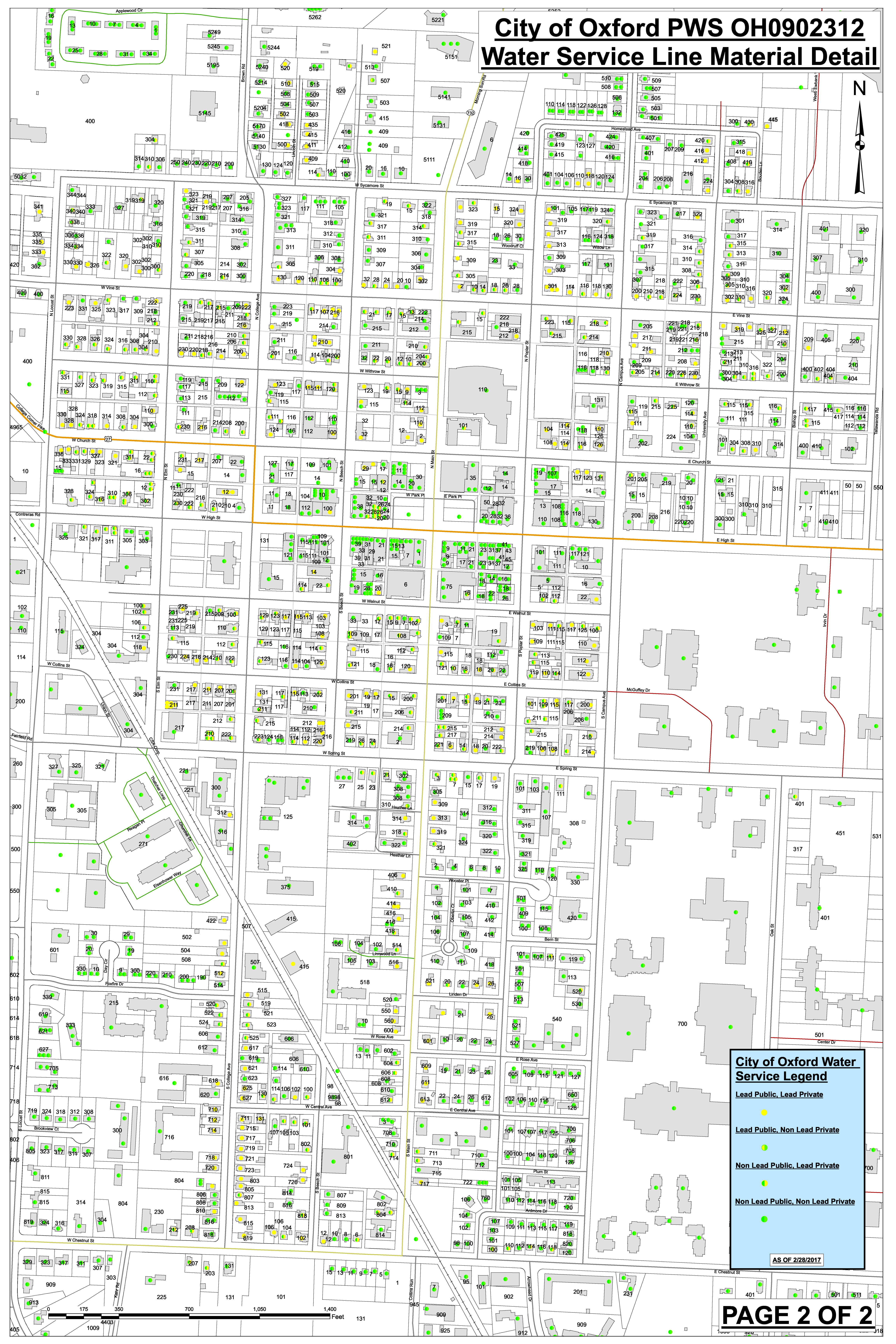

**City of Oxford Water Service Legend**

- Lead Public, Lead Private
- Lead Public, Non Lead Private
- Non Lead Public, Lead Private
- Non Lead Public, Non Lead Private

AS OF 2/28/2017