

GRANDVIEW HEIGHTS
 JOHNSON TOWNSHIP
 CHAMPAIGN COUNTY, OHIO
WATER DISTRIBUTION SYSTEM

LEGEND:

- 3/4" WATER SERVICE —
- WATER 2" —
- WATER 4" —
- FLUSHING HYDRANT 
- WATER VALVE 
- WATER VALVE 

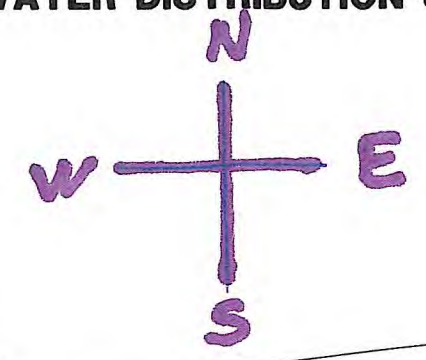
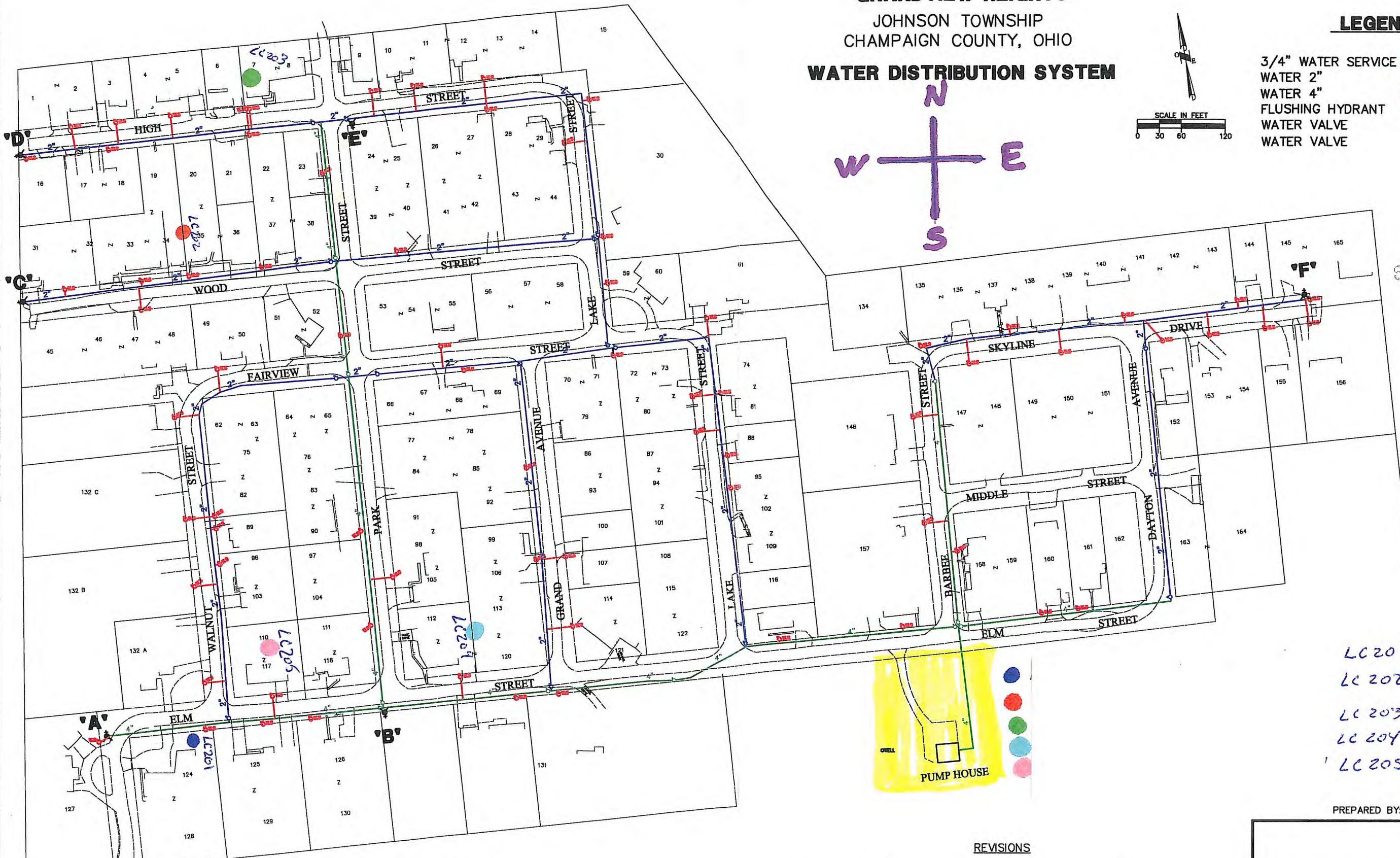
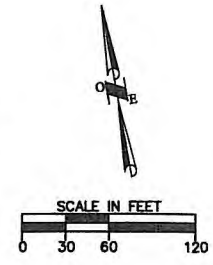

RECEIVED
 OHIO EPA
 MAR 01 2017
 Southwest District

- LC201
- LC202
- LC203
- LC204
- LC205

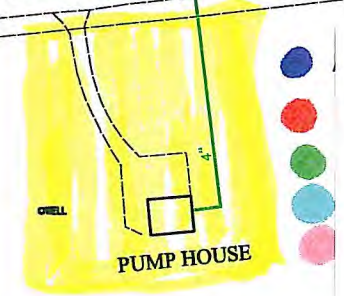

● Residential Housing
 lead, solder, plumbing fixtures unknown

● Main Water Lines made from HDPD material

PREPARED BY:

DATE	REVISIONS DESCRIPTION	INITIAL
7/27/05	RECORD DRAWINGS	ATS

ChoiceOne Engineering

SIDNEY, OHIO 937.497.0200
 LOVELAND, OHIO 513.239.8554
 PORTLAND, INDIANA 260.766.2500
 www.CHOICEONEENGINEERING.com

Grandview Heights
Johnson Township
Champaign County, Ohio
March 6, 2017

Because it is practically impossible to determine the lead content of an installed fixture, fitting or pipe, it should be assumed that the manufacture or installation date is the primary indicator of the lead content. Therefore, the characteristics of buildings and piping solder or fixtures would be buildings in Ohio built prior to 1998 or that use plumbing material or solder manufactured before 1998 may have materials with greater than 8% lead and are at a higher risk of contributing lead to the drinking water than materials manufactured after 1998. In addition, buildings built and plumbing materials manufactured after 2014 were required to have less than 0.25% lead by weight and have the lowest risk for contributing lead to the drinking water. It should be noted however that, although prohibited, some use of leaded solder or leaded components may have occurred after the prohibitions became effective.