

Village of Russells Point
Water Department
433 St. Rt. 708
Russells Point, Ohio 43348
937-843-2245

RECEIVED
OHIO EPA
MAR 08 2017
Southwest District

3-5-2017

PWS# OH4602212

LEAD SERVICE LINE;
Mapping Statement

The Village of Russells Point, Ohio has NO LEAD SERVICE LINES!

This information is based on the following parameters:

1. I am the current Water Superintendent have been involved in the majority of excavations for the Village's water department since 11-1-1992.
2. Supervised a water main upgrade and replacement project in 1997 in which appx 50% of the water distribution system was replaced, and all the services involved were installed in copper.
3. Interviews with past employees and there is absolutely no evidence of a lead service line ever being seen or installed.

Contained within the shaded area of green and yellow striping are components that are likely to have lead content.

Buildings in Ohio built prior to 1998 or that use plumbing material or solder manufactured before 1998 may have materials with greater than 8% lead and are at a higher risk of contributing lead to the drinking water than materials manufactured after 1998. In addition, buildings built and plumbing materials manufactured after 2014 were required to have less than 0.25% lead by weight and have the lowest risk for contributing lead to the drinking water. It should be noted however that, although prohibited, some use of leaded solder or leaded components may have occurred after the prohibitions became effective.

Dale Albert
Village of Russells Point
Water Superintendent

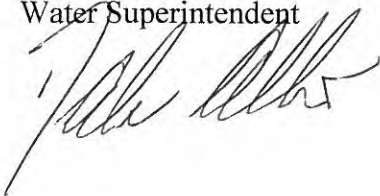

RECEIVED
OHIO EPA
MAR 08 2017

VERIFICATION FORM FOR COMMUNITY PUBLIC WATER SYSTEMS CLAIMING NO LEAD SERVICE LINES

The owner or operator of all community public water systems must identify and map areas of their distribution system that are known or are likely to contain lead service lines. Systems must submit a copy of the applicable map to the Ohio Department of Health and the Ohio Department of Job and Family Services. Systems must also submit a report to the director containing at least both of the following: (1) The applicable map with narrative, and (2) A list of sampling locations used to collect samples as required by Ohio Revised Code (ORC) Section 6109.121 and any rules adopted thereunder, including contact information for the owner and occupant of each sampling site.

Should a water system determine no lead service lines exist in their distribution system, they must provide information stating they reviewed, at the minimum, historical permit records and local ordinances, distribution maintenance records and information pertaining to installation dates or materials for all services lines. This information must be verified below.

I HEREBY CERTIFY THAT THE FOLLOWING METHOD(S) WERE USED TO DETERMINE NO LEAD SERVICE LINES EXIST IN THIS WATER SYSTEM'S DISTRIBUTION SYSTEM, AS REQUIRED BY ORC 6109.121(F):

LEAD SERVICE LINE VERIFICATION	
<p>This PWS states they have no lead service lines and has reviewed the following information (select one or more of the following):</p> <ul style="list-style-type: none"> <input checked="" type="checkbox"/> Historical permit records and/or local ordinances <input checked="" type="checkbox"/> Distribution maintenance records (i.e. meter replacement, waterline break repairs) <input checked="" type="checkbox"/> Information pertaining to installation dates for all service lines (i.e. after 1986 when lead services lines were banned) <input checked="" type="checkbox"/> Service line material of all service lines is known (i.e. all service lines are known to be PVC) 	

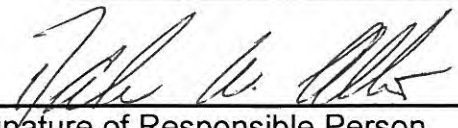
 Signature of Responsible Person 3-6-2017
 Date
Dale Albert - Water Superintendent
 Printed Name and Title of Responsible Person

PWS NAME: 1/0 Russell Point
 PWS ID: OH 4602212
 COUNTY: Logan

<p>For Ohio EPA use only:</p> <p>Date Verification Rec'd: _____</p>
--

VILLAGE OF RUSSELLS POINT WATER DISTRIBUTION MAP

PWS# OH460212

0 200 400
SCALE 1" = 200'

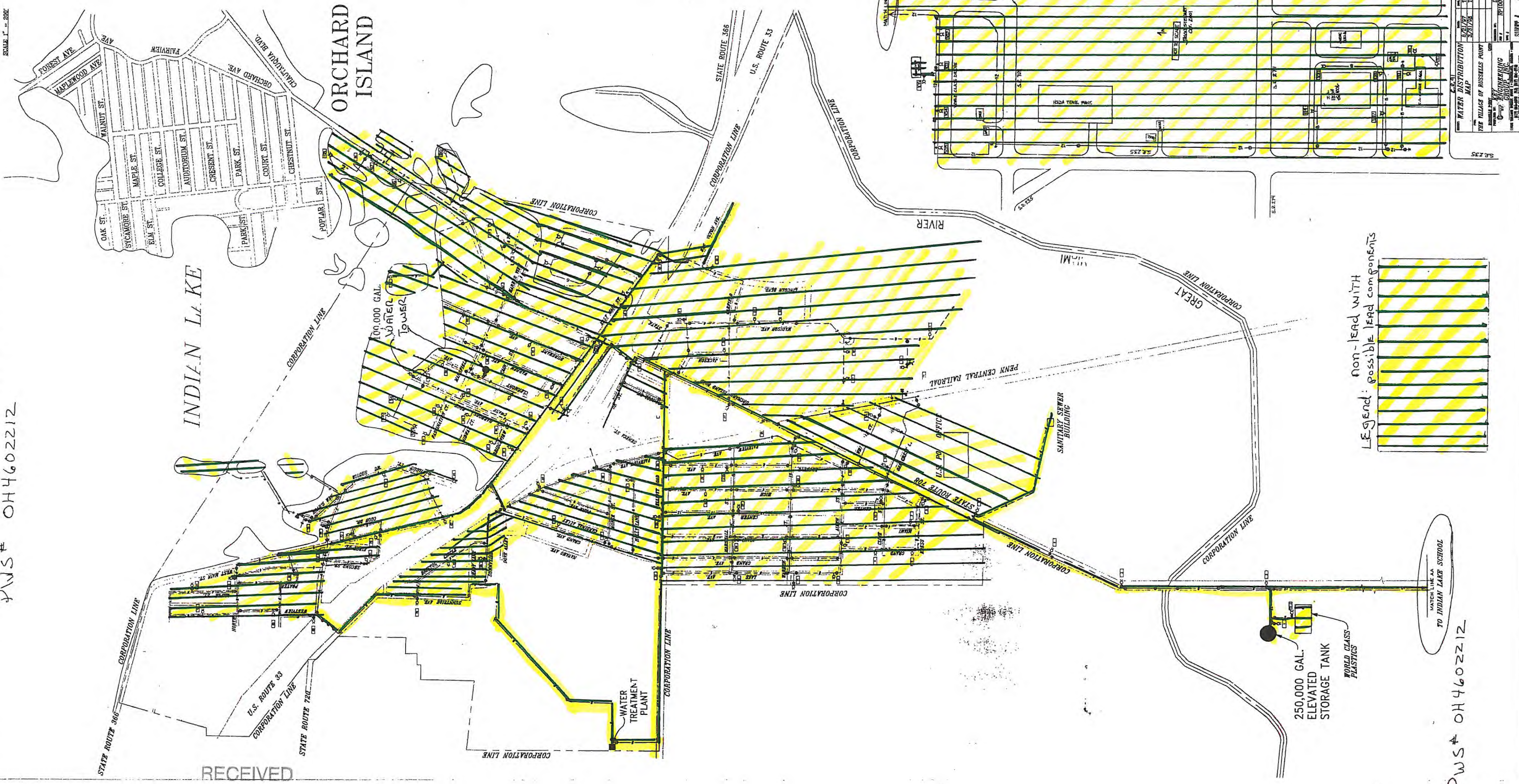
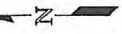

RECEIVED
OHIO EPA
MAR 08 2017

Southwest District

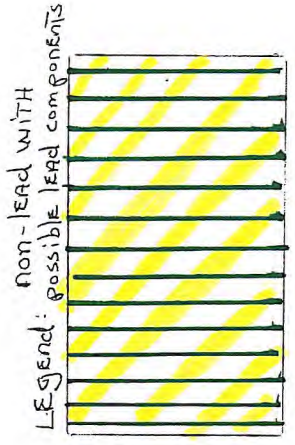

PWS# OH460212

WATER DISTRIBUTION SYSTEM MAP		
DATE	BY	REVISION
12/1/09	J.L.	1.0
10/1/10	J.L.	1.1
10/1/10	J.L.	1.2
10/1/10	J.L.	1.3
10/1/10	J.L.	1.4
10/1/10	J.L.	1.5
10/1/10	J.L.	1.6
10/1/10	J.L.	1.7
10/1/10	J.L.	1.8
10/1/10	J.L.	1.9
10/1/10	J.L.	2.0