

RE: EASTWOOD MIDDLE SCHOOL
Report
Drinking Water Program
Wood County
PWS ID: OH8749812

Narrative description of Building Characteristics for Eastwood Local School District

These maps were comprised of data based on the construction dates of the buildings. And those buildings built prior to 1998 or that use plumbing material or solder manufactured before 1998 may have materials with greater than 8% lead and are at a higher risk of contributing lead to the drinking water than materials manufactured after 1998. In addition, buildings built and plumbing materials manufactured after 2014 were required to have less than 0.25% lead by weight and have the lowest risk for contributing lead to the drinking water. It should be noted however that, although prohibited, some use of leaded solder or leaded components may have occurred after the prohibitions became effective.

RECEIVED

MAR 08 2017

OHIO E.P.A.
N.W.D.O.

OH 8749812

Eastwood MS

August 3, 2015

Sheet 2

Eastwood Middle School

Floor Plan

2015-2016

Id # 8749812

4800 Sugar Ridge Rd
Pemberville, OH

419-833-6011

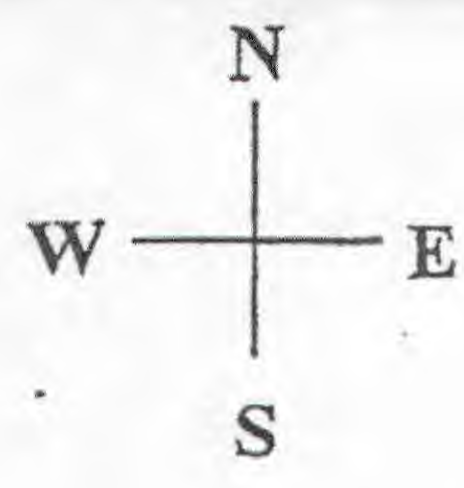
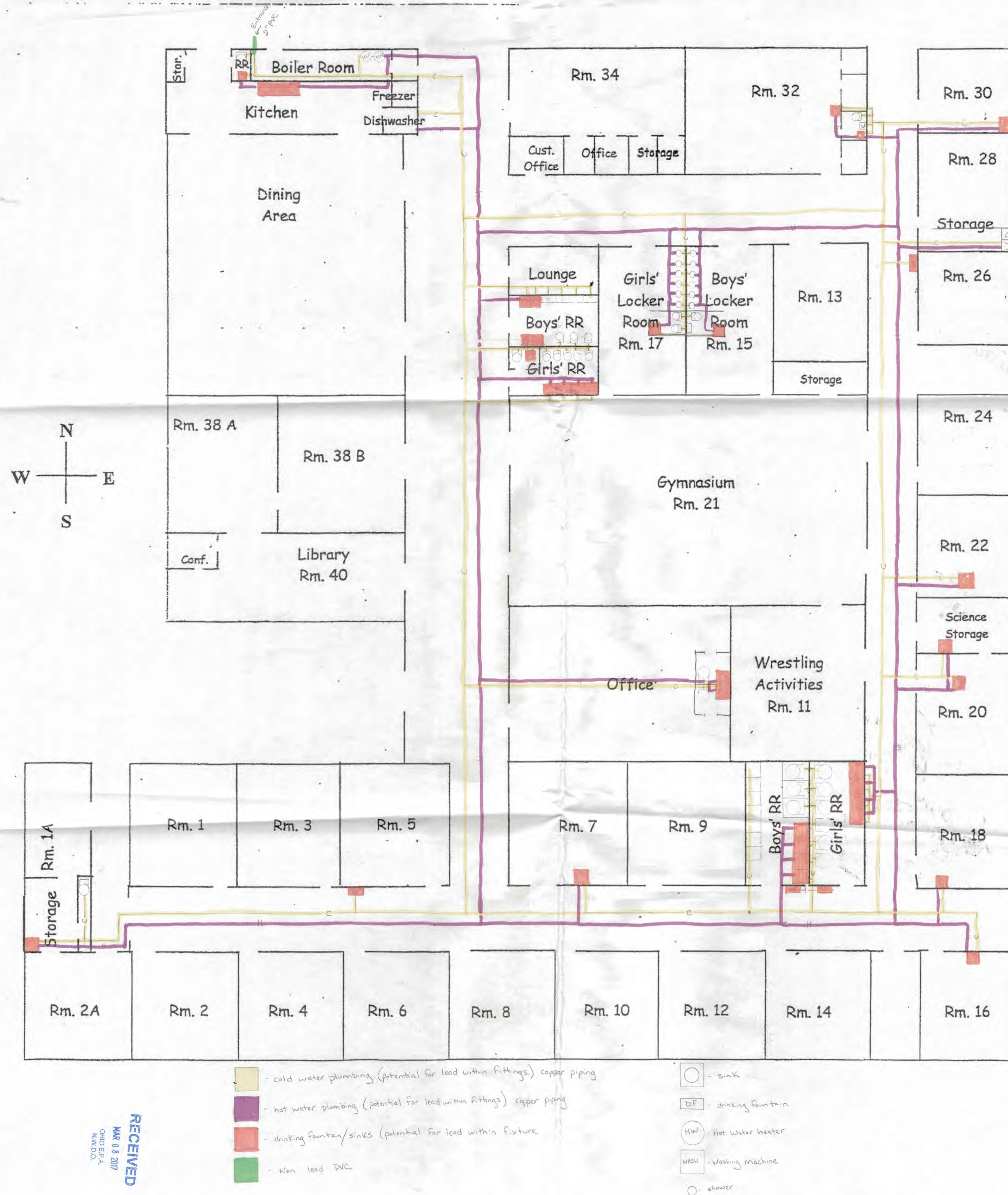

RECEIVED
MAR 08 2017
OHIO EPA
NWD/OA