

PVC Main: PINK  
Pex Feeds: GREEN  
(LEGEND)

NO  
LEAD Service  
LINES

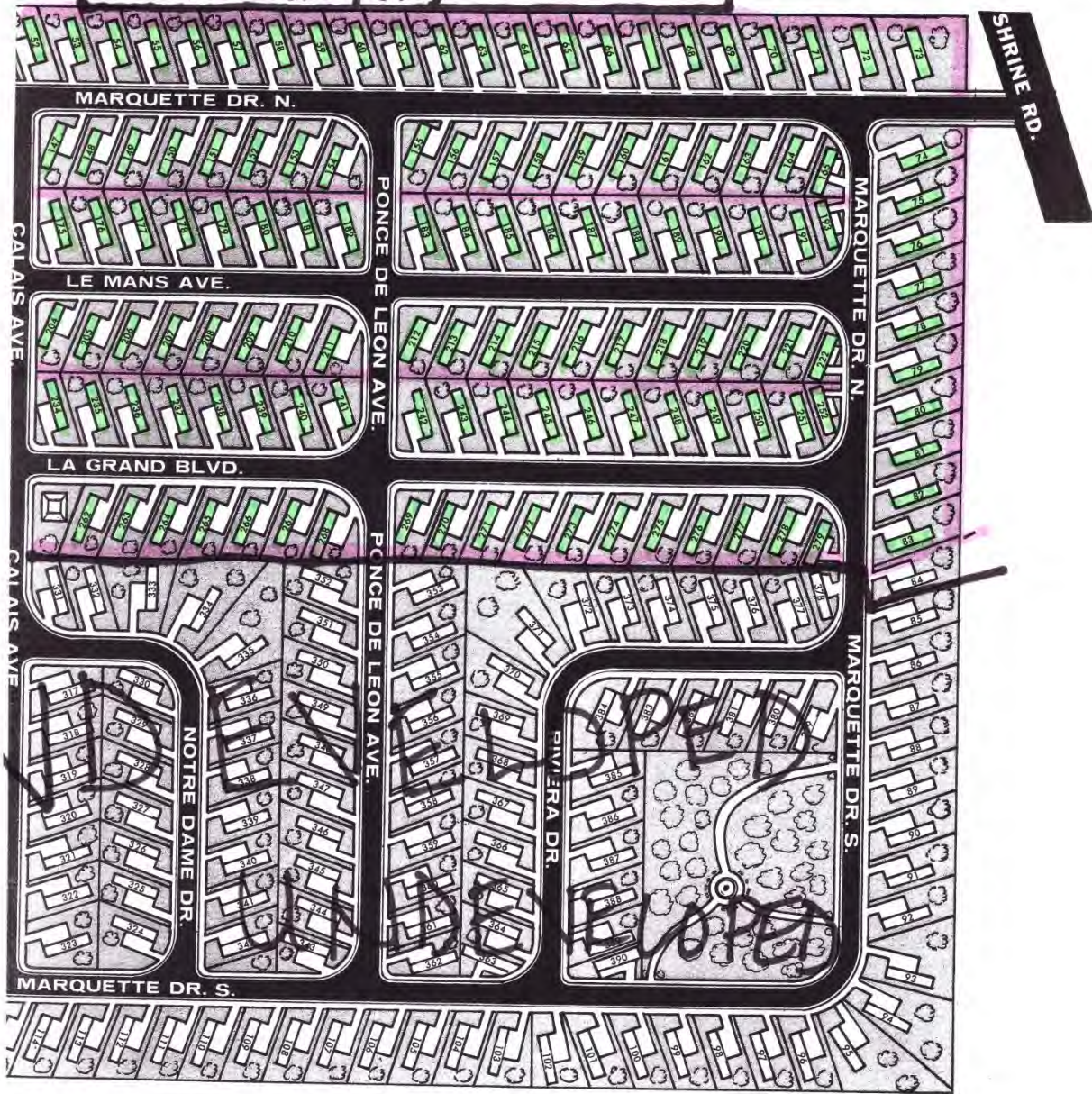

buildings built and plumbing materials manufactured after 2014 were required to have less than 0.25% lead by weight and have the lowest risk for contributing lead to the drinking water. It should be noted however that, although prohibited, some use of leaded solder or leaded components may have occurred after the prohibitions became effective.

Steel Main: Blue  
Copper Feeds: Orange

Pex Feeds: Green

(LEGEND)

PWSID: OH1200412

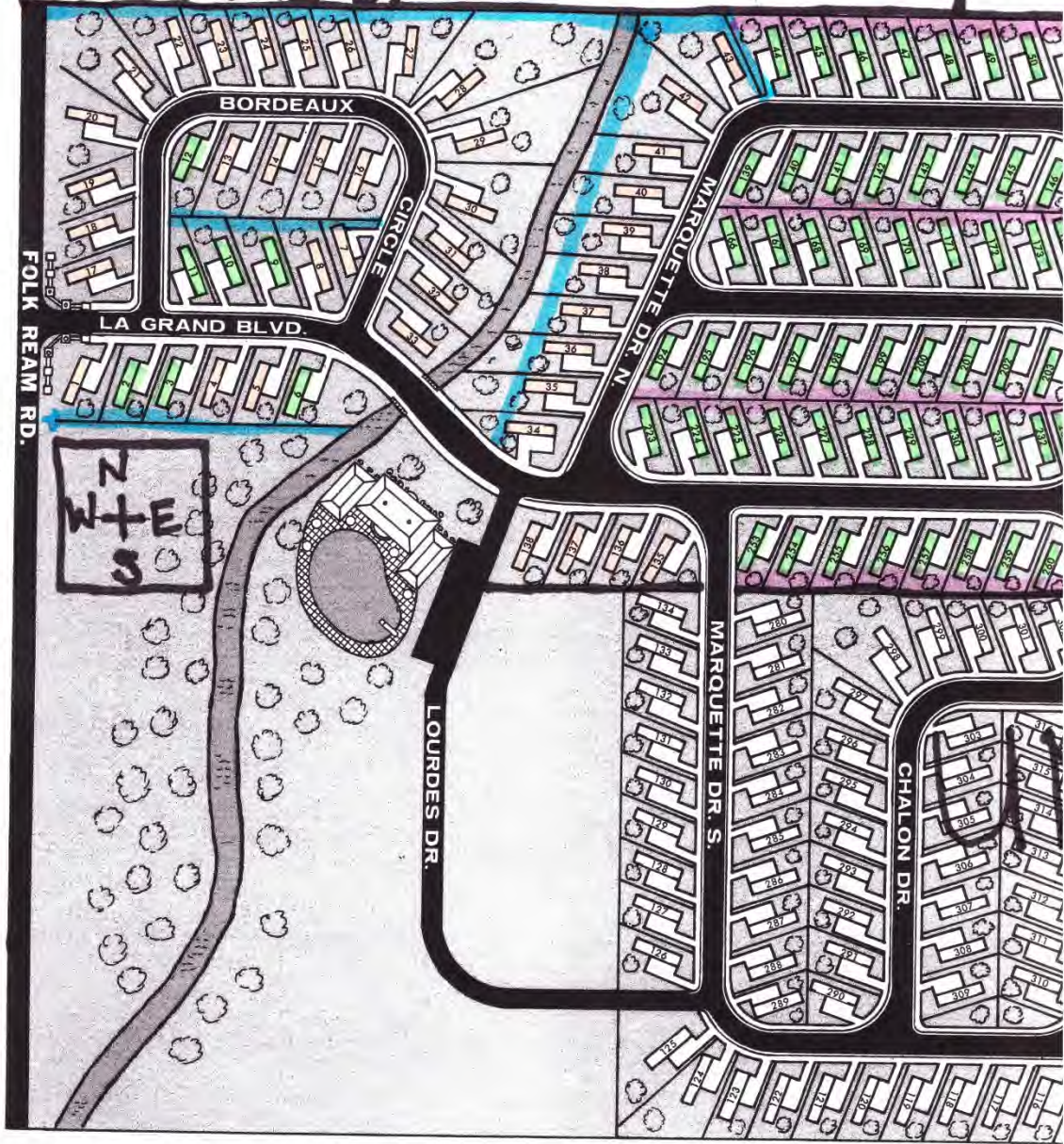

Because it is practically impossible to determine the lead content of an installed fixture, fitting or pipe, it should be assumed that the manufacture or installation date is the primary indicator of the lead content. Therefore, the characteristics of buildings and piping solder or fixtures would be buildings in Ohio built prior to 1998 or that use plumbing material or solder manufactured before 1998 may have materials with greater than 8% lead and are at a higher risk of contributing lead to the drinking water than materials manufactured after 1998. In addition,

2/28/2017

**Chateau Estates MHP, LLC**  
3454 Folk Ream Rd.  
Springfield, Ohio 45502

The wells for Chateau Estates MHP were installed on 02/07/2001. We purchased Chateau Estates MHP on 08/26/2016. Attached you will find the well log and drilling report from install and the maintenance records from our purchase.

The pump house and wells for Chateau Estates MHP is located off of La Grande Blvd. between lot numbers 260 and 262. This structure houses the community's water system. PVC Mains feed the system. From the East side of Marquette Dr. N., all Mains are made of Steel. Water Laterals to the East side of Marquette Dr. N. are made of Pex and Laterals to the West and South of Marquette Dr. N. are either Copper or Pex. To our knowledge, there are NO Lead Service Lines.

However, because it is practically impossible to determine the lead content of an installed fixture, fitting or pipe, it should be assumed that the manufacture or installation date is the primary indicator of the lead content. Therefore, the characteristics of buildings and piping solder or fixtures would be buildings in Ohio built prior to 1998 may have materials with greater than 8% lead and are at a higher risk of contributing lead to the drinking water than materials manufactured after 1998. In addition, buildings built and plumbing materials manufactured after 2014 were required to have less than 0.25% lead by weight and have the lowest risk for contributing lead to the drinking water. It should be noted however that, although prohibited, some use of leaded solder or leaded components may have occurred after the prohibitions became effective.

At this time approximately 130 Water Laterals in this community are not active.

Chateau Estates MHP, LLC.  
CE PWS DISTRIBUTION SUMMARY

**VERIFICATION FORM FOR COMMUNITY PUBLIC WATER SYSTEMS  
CLAIMING NO LEAD SERVICE LINES**

The owner or operator of all community public water systems must identify and map areas of their distribution system that are known or are likely to contain lead service lines. Systems must submit a copy of the applicable map to the Ohio Department of Health and the Ohio Department of Job and Family Services. Systems must also submit a report to the director containing at least both of the following: (1) The applicable map with narrative, and (2) A list of sampling locations used to collect samples as required by Ohio Revised Code (ORC) Section 6109.121 and any rules adopted thereunder, including contact information for the owner and occupant of each sampling site.

Should a water system determine no lead service lines exist in their distribution system, they must provide information stating they reviewed, at the minimum, historical permit records and local ordinances, distribution maintenance records and information pertaining to installation dates or materials for all services lines. This information must be verified below.

I HEREBY CERTIFY THAT THE FOLLOWING METHOD(S) WERE USED TO DETERMINE NO LEAD SERVICE LINES EXIST IN THIS WATER SYSTEM'S DISTRIBUTION SYSTEM, AS REQUIRED BY ORC 6109.121(F):

LEAD SERVICE LINE VERIFICATION	
<b>This PWS states they have no lead service lines and has reviewed the following information (select one or more of the following):</b>	
<input checked="checked" type="checkbox"/>	Historical permit records and/or local ordinances
<input checked="checked" type="checkbox"/>	Distribution maintenance records (i.e. meter replacement, waterline break repairs)
<input type="checkbox"/>	Information pertaining to installation dates for all service lines (i.e. after 1986 when lead services lines were banned)
<input type="checkbox"/>	Service line material of all service lines is known (i.e. all service lines are known to be PVC)

*Virginia Boling*      3-2-17  
Signature of Responsible Person      Date  
Virginia Boling District Manager  
Printed Name and Title of Responsible Person

PWS NAME: Chateau Estates  
PWS ID: OH 1200412  
COUNTY: Clark

<b>For Ohio EPA use only:</b> Date Verification Rec'd: _____
---



TYPE OR USE PEN  
SELF TRANSCRIBING  
PRESS HARD

# WELL LOG AND DRILLING REPORT

Ohio Department of Natural Resources  
Division of Water, 1939 Fountain Square Drive  
Columbus, Ohio 43224-9971 Voice (614) 265-6739 Fax (614) 447-9503

## WELL LOCATION      CONSTRUCTION DETAILS

County **CLARK** Township **GERMAN**

Owner **CHATEAU ESTATES**  
(Circle One or Both) First Last

Address of Well Location **3454 FOLK BEAN RD**  
Number Street Name

City \_\_\_\_\_ Zip Code **+4**

Permit No. **EDA** Section/Lot No. **32**  
(Circle One or Both)

Location of Well in State Plane coordinates, if available:  
 N  X **0.00** +/- ft. or m  
 S  Y **0.00** +/- ft. or m

Elevation of Well **0.00** +/- ft. or m

Datum Plan:  NAD27  NAD83 Elevation Source \_\_\_\_\_

Source of Coordinates:  GPS  Survey  Other

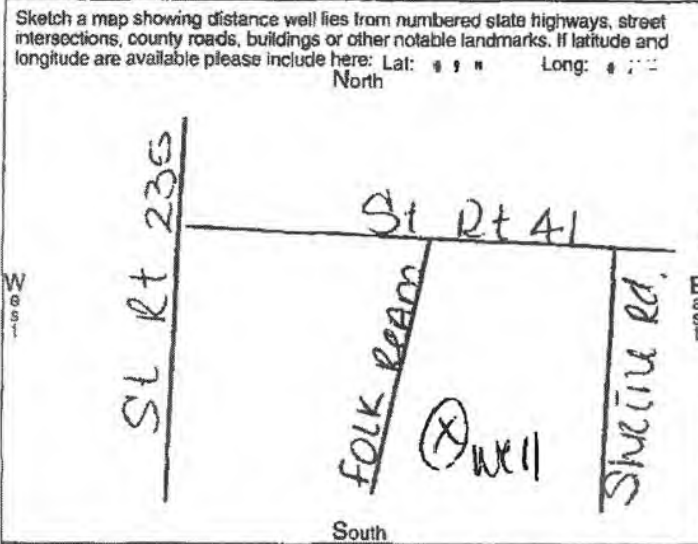

Rotary  Cable  Augered  Driven  Other

**BOREHOLE/CASING** (measured from ground surface)

1  Borehole Diameter **7 7/8** inches Depth \_\_\_\_\_ ft.  
 Casing Diameter **5 1/2** in. Length \_\_\_\_\_ ft. Thickness **SDR17** in.

2  Borehole Diameter **7 1/2** inches Depth **220** ft.  
 Casing Diameter \_\_\_\_\_ in. Length \_\_\_\_\_ ft. Thickness \_\_\_\_\_ in.

Casing Height Above Ground \_\_\_\_\_ ft.

Type 1  Steel 1  Galv. 1  PVC 1  Other \_\_\_\_\_  
 2 \_\_\_\_\_ 2 \_\_\_\_\_ 2 \_\_\_\_\_ 2 \_\_\_\_\_

Joints 1  Threaded 1  Welded 1  Solvent 1  Other \_\_\_\_\_  
 2 \_\_\_\_\_ 2 \_\_\_\_\_ 2 \_\_\_\_\_ 2 \_\_\_\_\_

**SCREEN**

Diameter \_\_\_\_\_ Slot Size \_\_\_\_\_ Screen Length \_\_\_\_\_

Type \_\_\_\_\_ Material \_\_\_\_\_

Set Between \_\_\_\_\_ ft. and \_\_\_\_\_ ft.

**GRAVEL PACK (Filter Pack)**

Material/Size \_\_\_\_\_ Volume/Weight Used \_\_\_\_\_

Method of Installation \_\_\_\_\_

Depth: Placed FROM \_\_\_\_\_ ft. TO \_\_\_\_\_ ft.

**GROUT**

Material \_\_\_\_\_ Volume/Weight Used \_\_\_\_\_

Method of Installation \_\_\_\_\_

Depth: Placed FROM \_\_\_\_\_ ft. TO \_\_\_\_\_ ft.

**WELL TEST\***

Pre-Pumping Static Level \_\_\_\_\_ ft. Date **2/7/01**

Measured from:  Top of Casing  Ground Level  Other \_\_\_\_\_

Air  Bailing  Pumping  Other

Test Rate **100** gpm Duration of Test \_\_\_\_\_ hrs.

Feet of Drawdown **0** ft. Sustainable Yield **100** gpm

\*(Attach a copy of the pumping test record, per section 1521.05, ORC)

Is Copy Attached?  Yes  No Flowing Well?  Yes  No

Quality **CLEAR**

**PUMP/PITLESS**

Type of pump **SUBMERSTIBLE** Capacity **100** gpm

Pump set at **100** ft. Pitless Type **ADAPTER**

Pump installed by **BLESSING PUMP**

I hereby certify the information given is accurate and correct to the best of my knowledge.

Drilling Firm **EATON WELL DRILLING**

Address **10343 Co. Rd. 41**

City, State, Zip **West Liberty, OH 43357**

Signed *Eaton* Date **02/12/10**

ODH Registration Number **02582**

**DRILLING LOG\***

INDICATE DEPTH(S) AT WHICH WATER IS ENCOUNTERED.  
 Show color, texture, hardness, and formation: sandstone, shale, limestone, gravel, clay, sand, etc.

	From	To
EXISTING WELL	0	100
LIMESTONE	100	220

\*(If more space is needed to complete drilling log, use next consecutively numbered form.)

Date of Well Completion \_\_\_\_\_ Total Depth of Well **220** ft.