

NORTHEASTERN HIGH SCHOOL

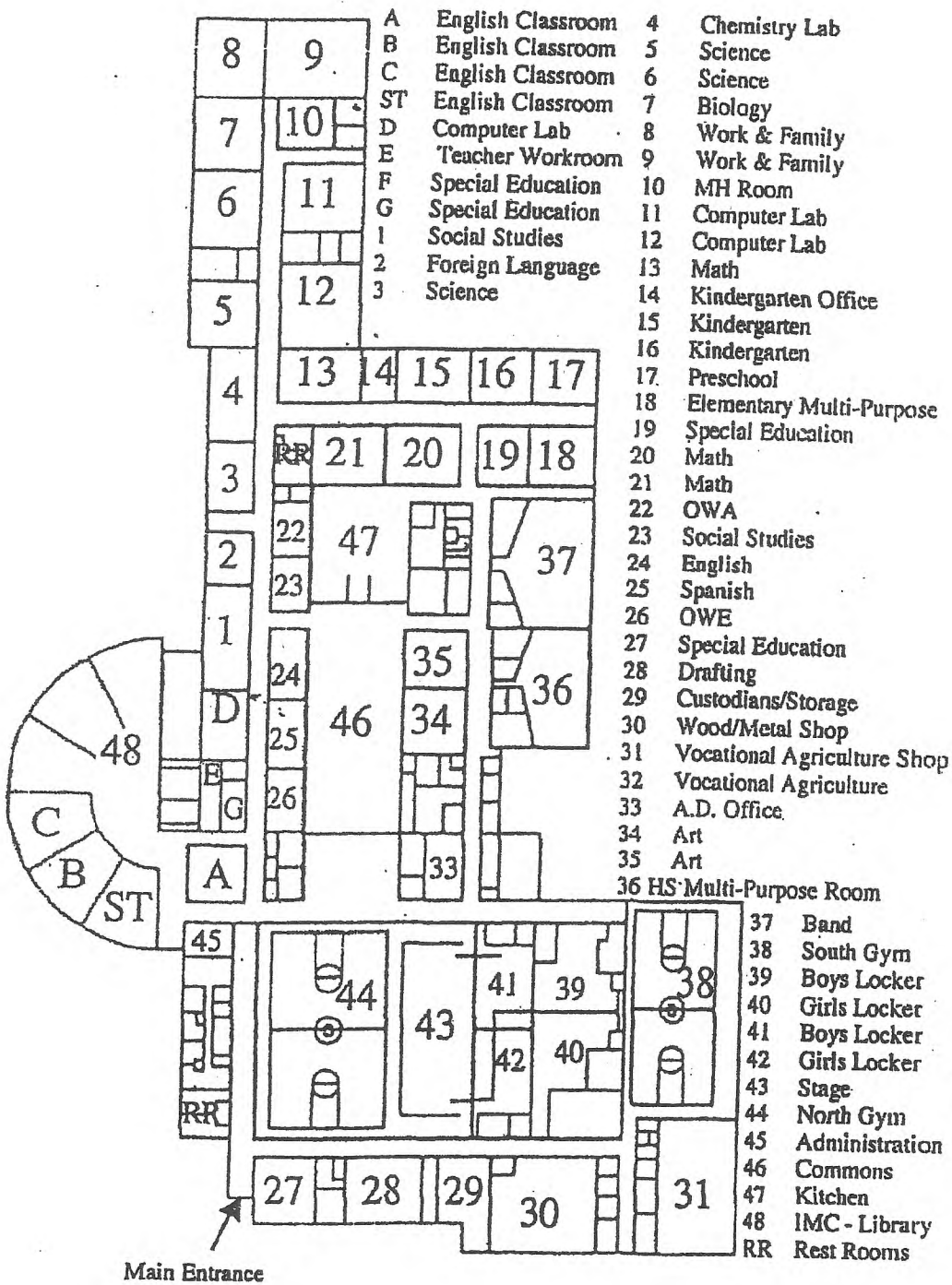

NORTHEASTERN HIGH SCHOOL – PWS O123412

1480 Bowman Rd, Springfield, OH 45502

The Northeastern High School Groundwater System, PSWID OH1233412, is comprised of the following:

Two (2) 50 gpm wells- #1 East Well - 38 foot deep with 7 stage submersible pump

#2 West Well - 42 foot deep with 7 stage submersible pump

A Cl2 injection disinfection system.

Eight (8) forty (40) gal pressure storage tanks.

Four (4) 550 gal chlorine contact tanks.

The water distribution system serves Northeastern High School, The Athletic Building, Football Concession, Central Office, Transportation Garage and Maintenance Building in that sequence.

Primary backflow valves are located at Central Office, Athletic Building, Football Concession, and Transportation Garage.

Most restroom fixture faucets and flush valves have been replaced with brass (1990's). Remaining old faucets are brass.

NORTHEASTERN HIGH SCHOOL – PWS O123412
1480 Bowman Rd, Springfield, OH 45502

All buildings in this complex were built prior to 2014 and plumbing materials used in construction were manufactured prior 2014. Plumbing materials and solder with higher lead content may have been used in their construction.

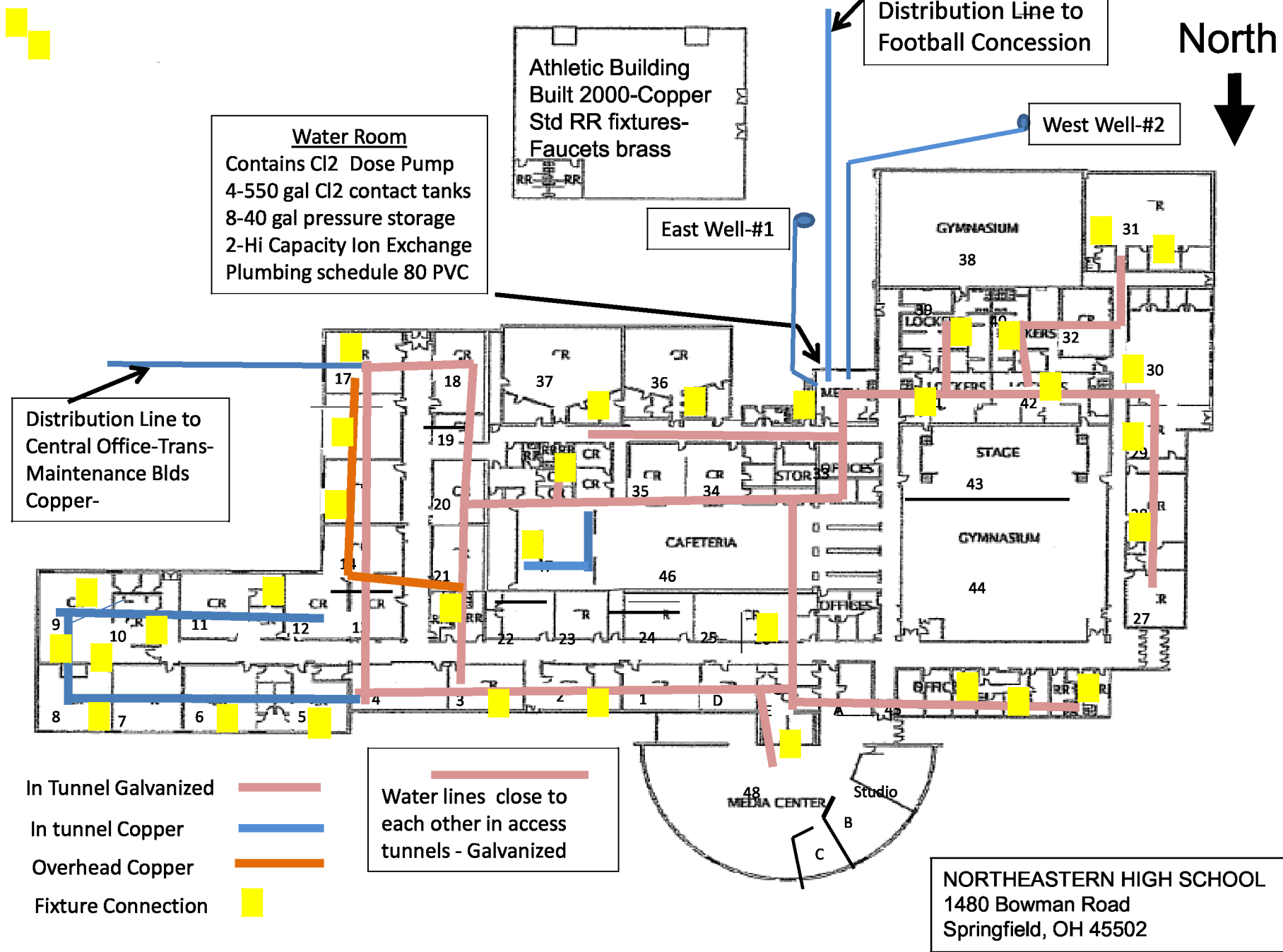

NORTHEASTERN LOCAL BOARD OFFICE-Built 1970
1414 Bowman Rd, Springfield, OH 45502 (937(325-7615
DISTRICT IRN #46250

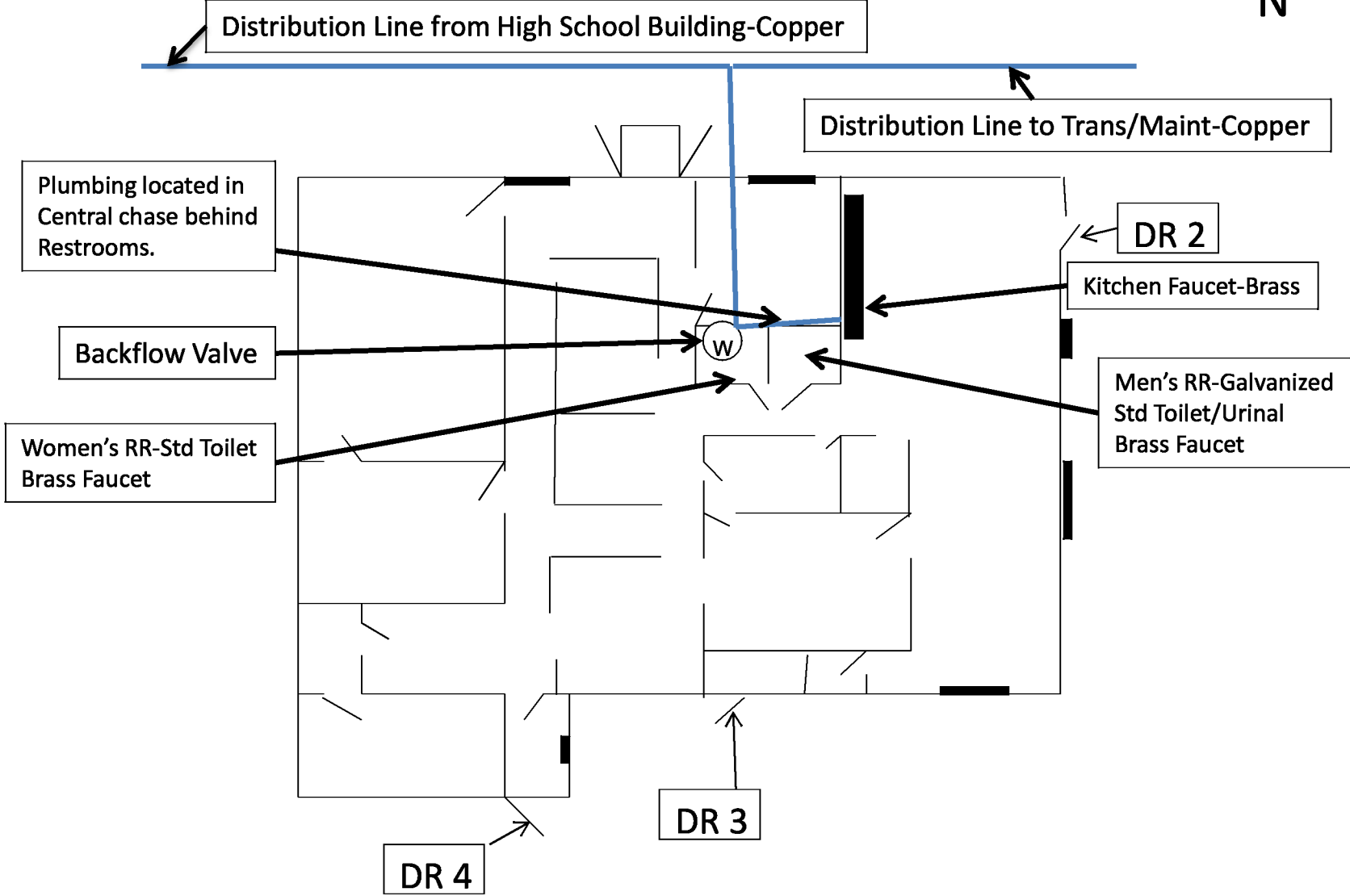

Transportation and Maintenance Buildings - 1414 Bowman Rd, Spfld, OH 45502

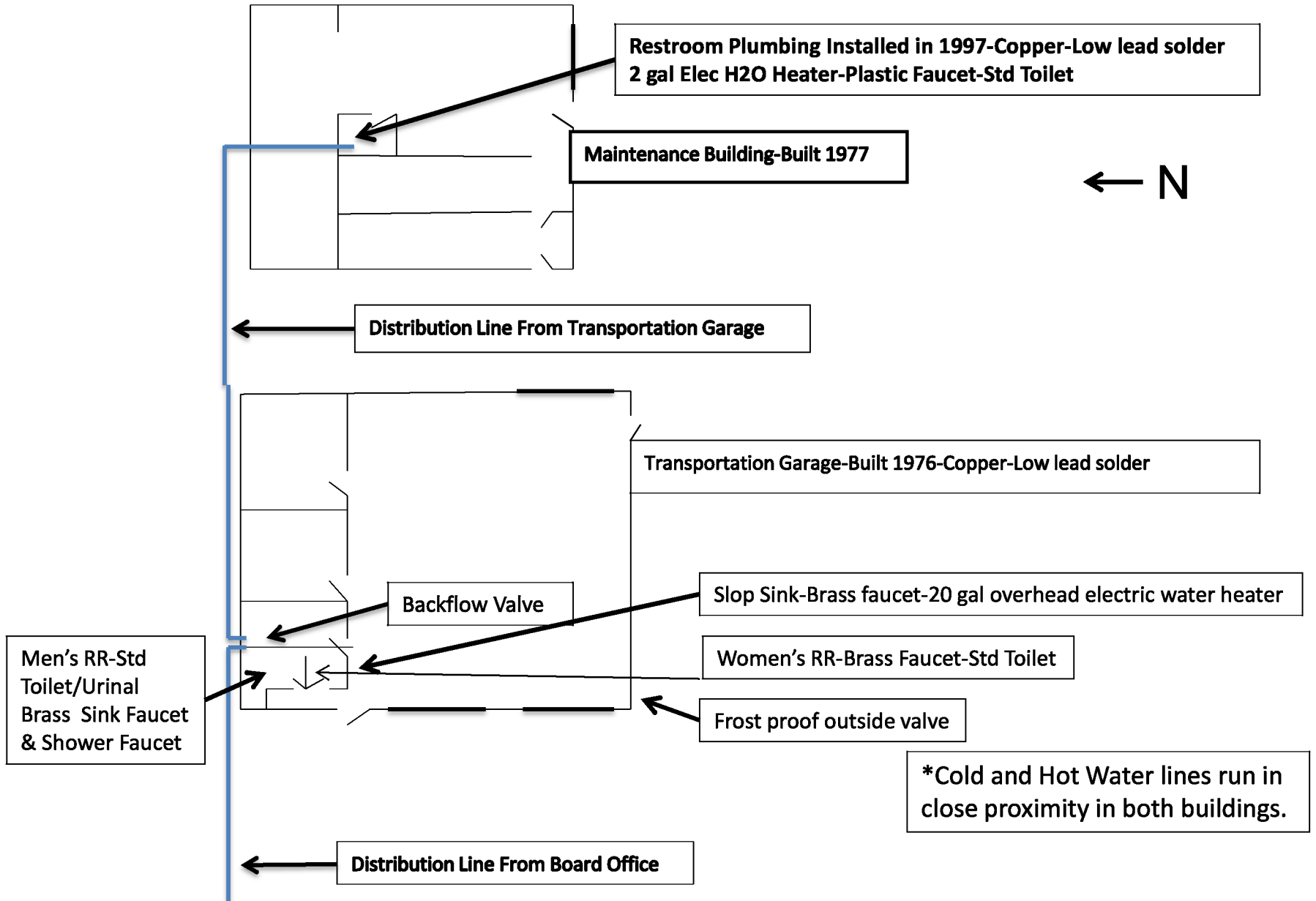

FOOTBALL CONCESSION - Built 1997

Concession Built Before 2014 and May Contain Some Lead Solder

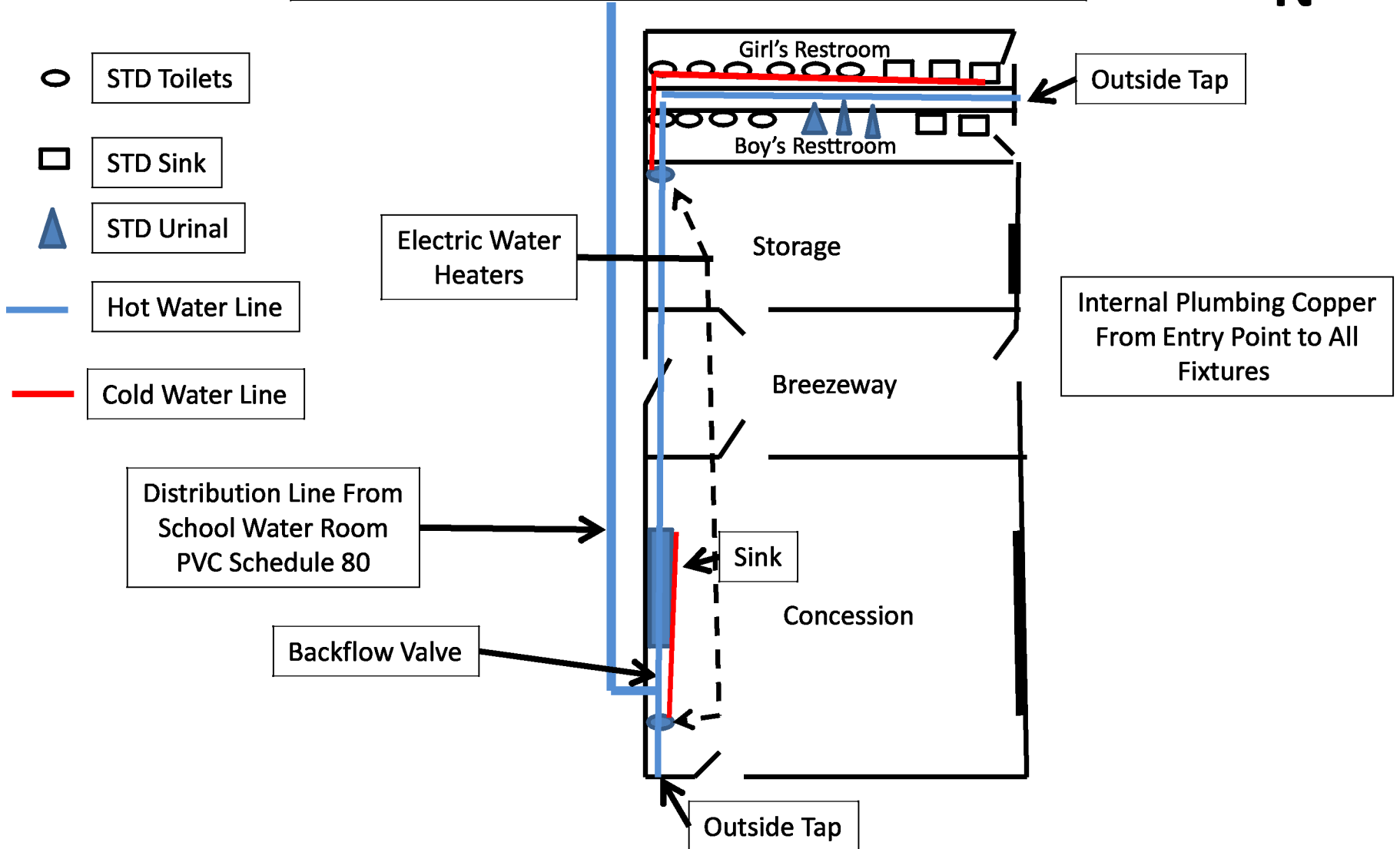

Northeastern High School

Transportation Garage

Maintenance Bldg

Athletic Building

Central Office

Football Concession

© 2016 Google

Google Earth

1994

39°56'25.72" N 83°40'46.70" W elev 1107 ft eye alt 1995 ft



Football
Concession

1997

GYMNASIUM

2000

1976

GYMNASIUM

1997

1969

1952

1976

1976

1969

