

Buildings in Ohio built prior to 1998 or that use plumbing material or solder manufactured before 1998 may have materials with greater than 8" lead and are at a higher risk of contributing lead to the drinking water than materials manufactured after 1998. In addition, buildings built and plumbing materials manufactured after 2014 were required to have less than 0.25% lead by weight and have the lowest risk for contributing lead to the drinking water. It should be noted however that , although prohibited, some use of leaded solder or leaded components may have occurred after the prohibitions became effective.

Clark County Department of Utilities has no records of lead service lines being installed or discovered in any of our service areas. Clark County Department of Utilities has never found a lead service in any of our districts during any meter replacement project, curb valve replacement, water main repair or any other maintenance or replacement activity, however it is possible lead services exist. If a lead service were to be located by Clark County Utilities on the public side of the curb stop, the public side of the service would be removed and replaced by Clark County Utilities. If a lead service were to be located by Clark County Utilities on the private side of the curb stop, the homeowner would be notified that a lead service was located on the private side.

H.B. 512 Service & Fixture Mapping Northridge 1 PWS

Legend

H.B. 512 Service & Fixture Mapping

No Service

Prior to Jan 1, 1988

Jan 1, 1988 to Jan 1, 2014

After Jan 1, 2014

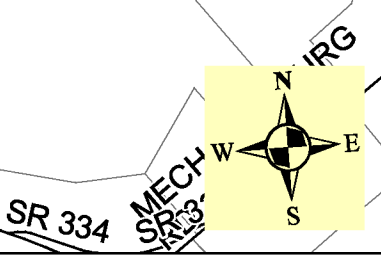

Northridge Water System – OH1201003

The Northridge water system serves approximately 3,600 accounts. Clark County Utilities purchases water from the City of Springfield, treats the water with Fluoride as required by the State of Ohio and pumps the water to the Northridge system. The water system began construction in 1960 and continues to expand with ongoing developments.

The service materials in the Northridge system have been found to be copper, HDPE, PEX, cross linked polyethylene, and galvanized steel. No lead services have ever been located by the Clark County Staff during normal maintenance activities or repairs however it is possible lead services exist. If a lead service were to be located by Clark County Utilities on the public side of the curb stop, the public side of the service would be removed and replaced by Clark County Utilities. If a lead service were to be located by Clark County Utilities on the private side of the curb stop, the homeowner would be notified that a lead service was located on the private side.