

# The Summit Church

---

VICTOR LAWWILL

Pastor

2404 Troy Road

Springfield Oh 45504

P 937-390-1717

C 937-546-8661

## To Whom It May Concern:

I have enclosed the drawing/mapping that was requested per the Ohio EPA. I however am not an artist, or an engineer. The accuracy of this map is as accurate as my knowledge and skill set will allow me to make it. This building was built in the 1970's and there have been no upgrades to any of the water systems to my knowledge. The pipe materials that I can see that connect to our faucets are PVC.

Because it is practically impossible to determine the lead content of an installed fixture, fitting or pipe, it should be assumed that the manufacture or installation date is the primary indicator of the lead content. Therefore, the characteristics of the building and piping solder or fixture would be buildings in Ohio built prior to 1998 or that use of plumbing materials or solder manufacture before 1198 may have materials with greater than 8% lead and are at a higher risk of contributing lead to drinking water than materials manufactured after 1198. In addition, buildings built and plumbing materials manufactured after 2014 were required to have less than 0.25% lead by weight and have the lowest risk for contributing lead to the drinking water. It should be noted however that, although prohibited, some use of leaded solder or leaded components may have occurred after the prohibition became effective.

VICTOR LAWWILL



**THE SUMMIT CHURCH**  
SERVING GOD, LOVING PEOPLE!

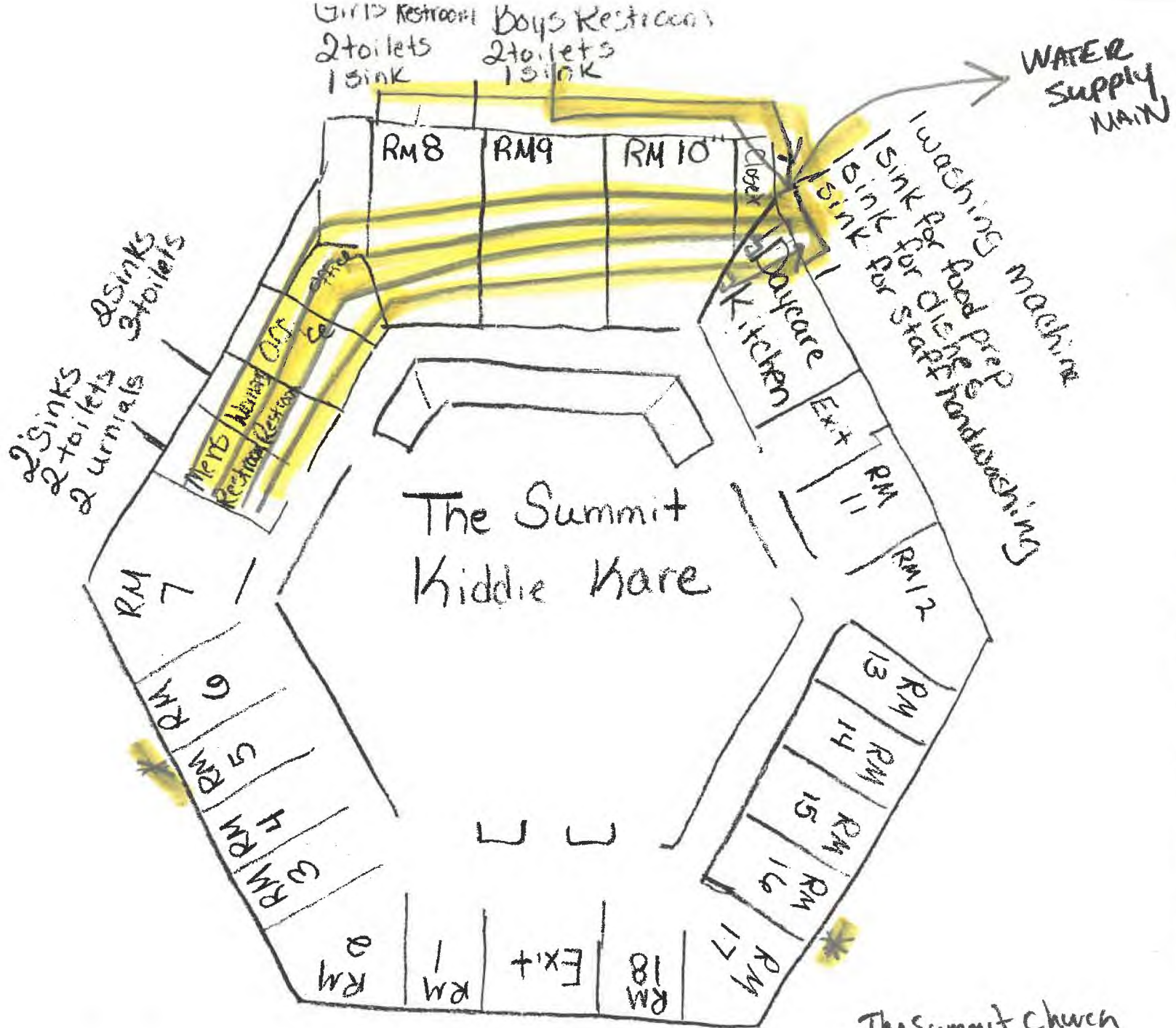
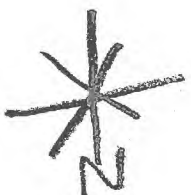

Street 41 - Troy Rd

The Summit Church  
KIDIC CARE  
2401 TROY Rd.  
Springfield, OH 45504