

PWS OH3130612

CINCINNATI INCORPORATED

Cincinnati Incorporated is a machine tool factory located at 7420 Kilby Rd. Harrison, Ohio 45030 in Hamilton County Ohio. This facility was built in 1952. The company was then added onto in 1956, then again in 1964 and then finally in 1970. There has been some small remodeling jobs done in 1986 and 1996 but for the most part the major construction happened before 1983. Since this facility was built prior to 1983 our water piping is copper and lead solder was used throughout. Cincinnati Incorporated uses 3 wells for potable water, wells 1 and 4 from the South side of the factory and well 2 on the North side. Wells 1 and 4 use iron pipe to feed the indoor storage tank in the South and well 2 uses iron pipe to feed a separate indoor storage tank on in the North. Copper piping and Lead solder is then used throughout the building. Wells 1 and 4 feed the majority of the manufacturing side of the company while well 2 feeds the office side of the company. All wells are connected by piping and the entire factory and offices can be run off of one well.

The maps that are included in this packet are as if you are looking down from above. The majority of the company is on one level with Locker Rooms on a second level in the factory and with mechanical rooms and storage rooms, rest rooms and a kitchen in the basement of the office area of the company. The legend will show all rest rooms, locker rooms, sinks, hose bibs and drinking fountains and their locations. The legend will show these areas marked with a dot to indicate hose bibs both inside and out, an X to indicate Drinking fountains, a box that will be colored in a pink highlighted color for rest rooms, locker rooms and sinks. Pink highlighted boxes will have an 'M', 'W', or 'LR' in the box to indicate Men, Women or Locker Room.

Eckel plumbing has done repair work on the plumbing in this facility along with our maintenance personnel and all supply lines from the wells to the storage tanks are iron pipes. After the storage tanks the lines are all copper and because of the age we have to assume lead solder. Due to the distance that the water travels, small water heaters are placed above the restrooms and locker rooms.

Please let me know if there are any questions, you can reach me at:

Office: 513-367-7354

Cell: 513-907-9885

Email: keith.roth@e-ci.com

Lead and Copper Mapping Legend



Hose Bibs



Men, Women Restrooms

Containing Toilets, Urinals and Sinks

Men, Women Locker Rooms

Containing Toilets, Urinals, Sinks and Showers



Sinks



Drinking Fountains



Iron Pipes



Copper Pipes and Lead Solder

NORTH



CINCINNATI INCORPORATED
7420 KILBY RD.
HARRISON, OH 45030
513-367-7100

TECHNICAL CENTER
50,000
SQ. FT.

OFFICE PARKING
LOTS

NORTH PARKING
LOTS

ADMINISTRATION &
ENGINEERING
87,000 SQ. FT.

CUSTOMER
PRODUCTIVITY
CENTER

PERSONNEL

WELL

FAB
SHOP
46,200
SQ. FT.

MANUFACTURING
&
ASSEMBLY
250,000
SQ. FT.

6,000
SQ. FT.

SOUTH
PARKING
LOTS

GUARD
HOUSE

WELL

Iron
Pipe

KILBY RD

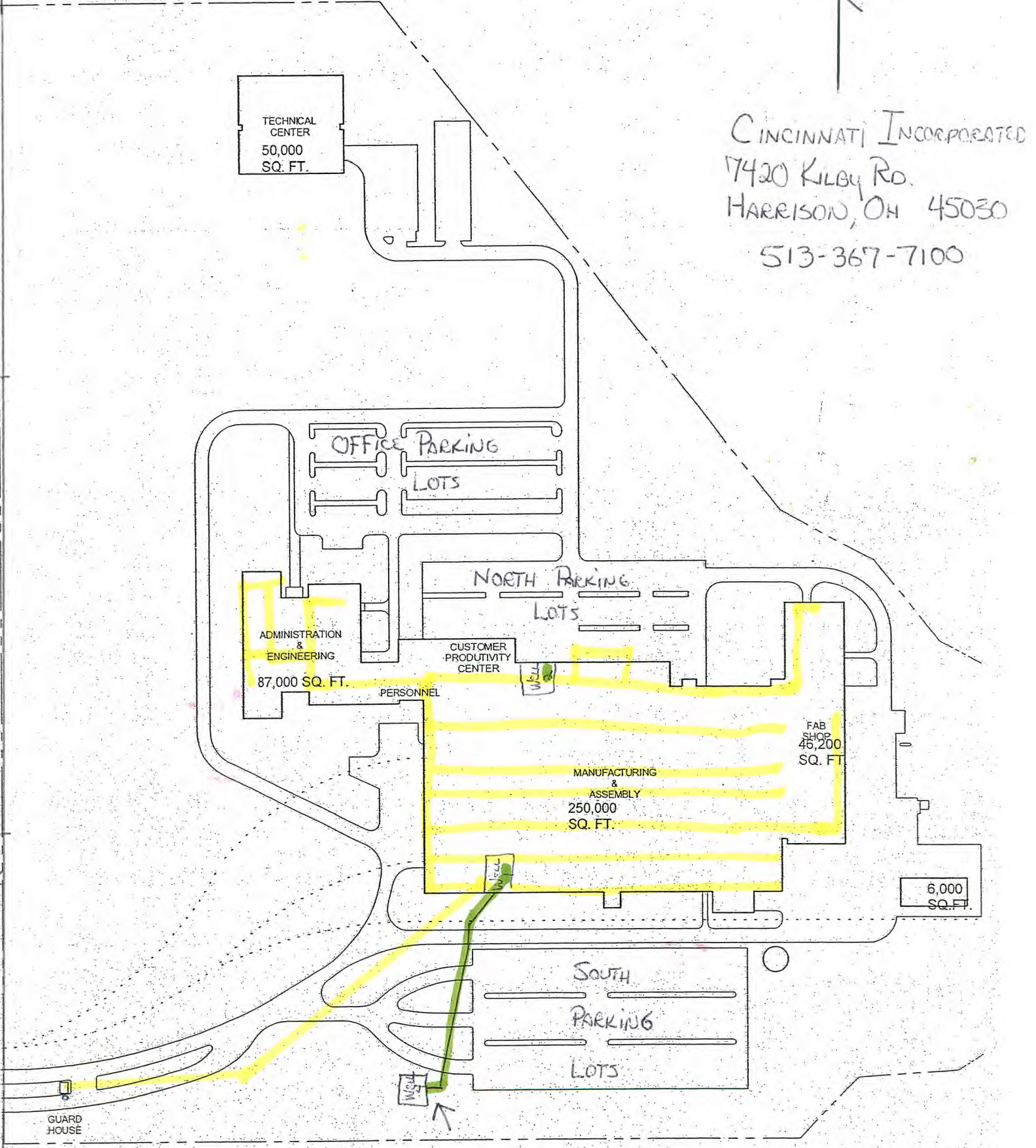

FACTORY MAIN LEVEL



CINCINNATI INCORPORATED
PLANT
SECOND FLOOR

2ND FLOOR

PERSONNEL



LOCKER ROOM HAS
DIRECT EXIT
BY ENTRANCE
TO SECURITY
OFFICE

O = OFFICE
LR = LOCKER ROOM
ST = STORAGE

→ LR1 HAS 5 SINKS
2 TOILETS
2 URINALS
4 SHOWER HEADS

S = JANITOR SINKS

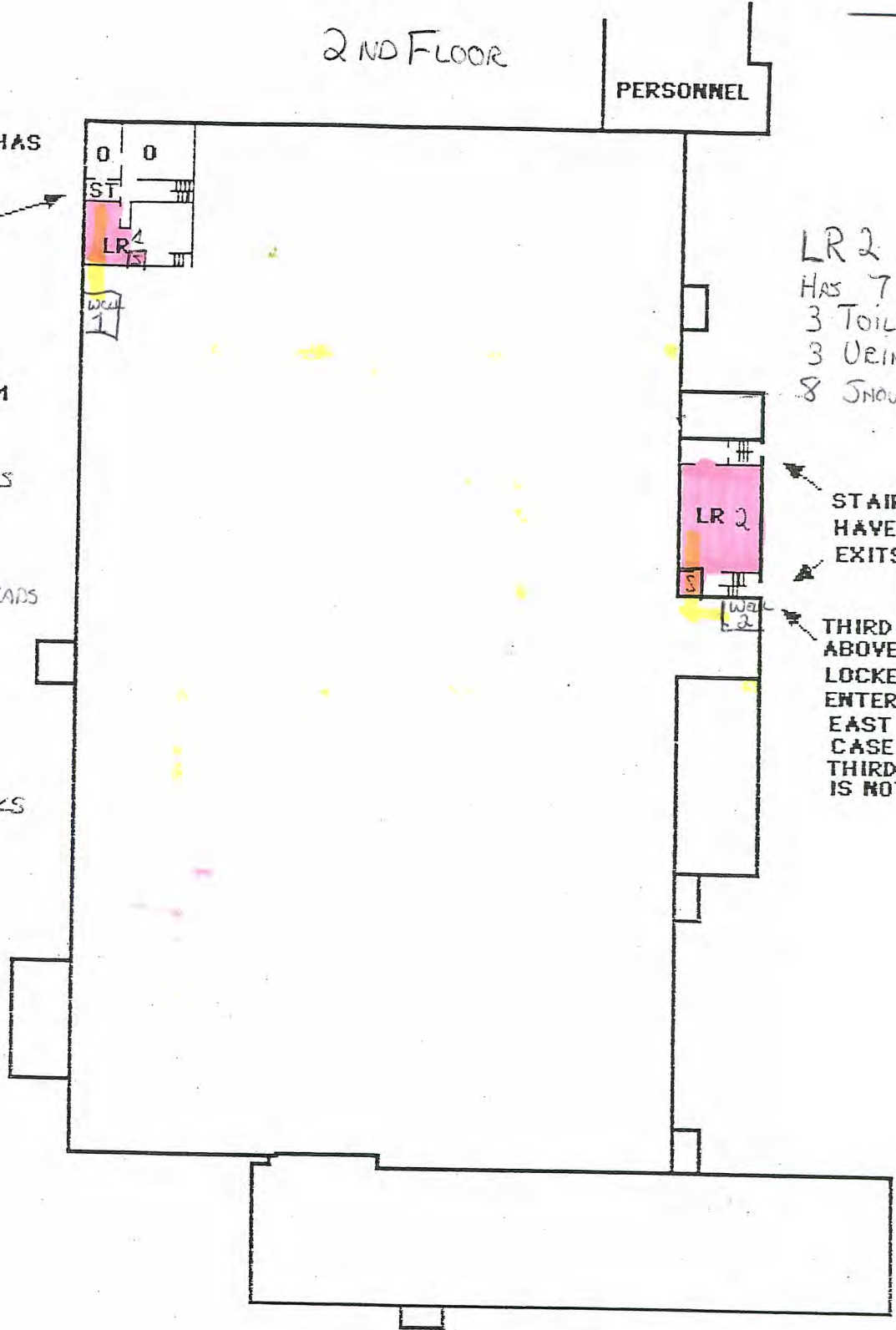

LR 2
HAS 7 SINKS
3 TOILETS
3 URINALS
8 SHOWER HEADS

STAIRWELLS
HAVE DIRECT
EXITS

THIRD FLOOR
ABOVE THIS
LOCKER ROOM
ENTER FROM
EAST STAIR
CASE.
THIRD FLOOR
IS NOT USED.

ADMINISTRATION AND ENGINEERING BUILDING
 FIRST FLOOR PLAN
 FIRE ALARM LOCATIONS
 MAIN LEVEL

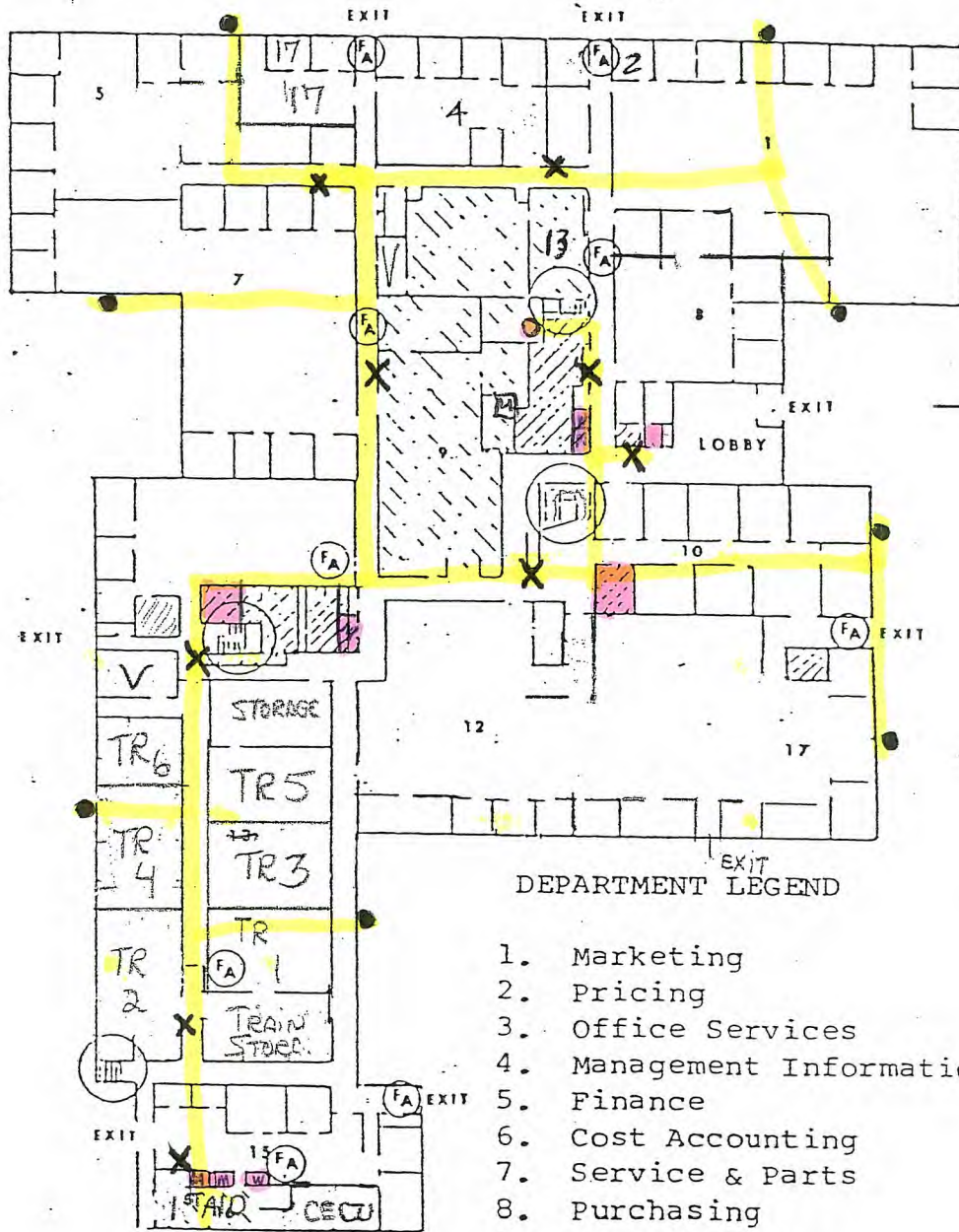

DEPARTMENT LEGEND

- 1. Marketing
- 2. Pricing
- 3. Office Services
- 4. Management Information Service
- 5. Finance
- 6. Cost Accounting
- 7. Service & Parts
- 8. Purchasing
- 9. Reproduction
- 10. Executive
- ? 11. Advertising
- 12. Engineering
- 13. Computer Center
- ? 14. Sales
- ? 15. Personnel
- 16. First Aid
- ? 17. Product Safety + TRAINING
- Service Areas

- Stairway
- ⊙ FA Fire Alarm

**ADMINISTRATION AND ENGINEERING BUILDING
FIRST FLOOR
(BASEMENT)**

→ Z

