

Vacant Sites
 Yr. Prior to 1998
 Yr. 1998 to 2014
 Yr. AFTER 2014

Spring Valley Estates
 Mobile Home Park
 PWS ID # 042962512

Southwest District

MAR 03 2017

RECEIVED
OHIO EPA

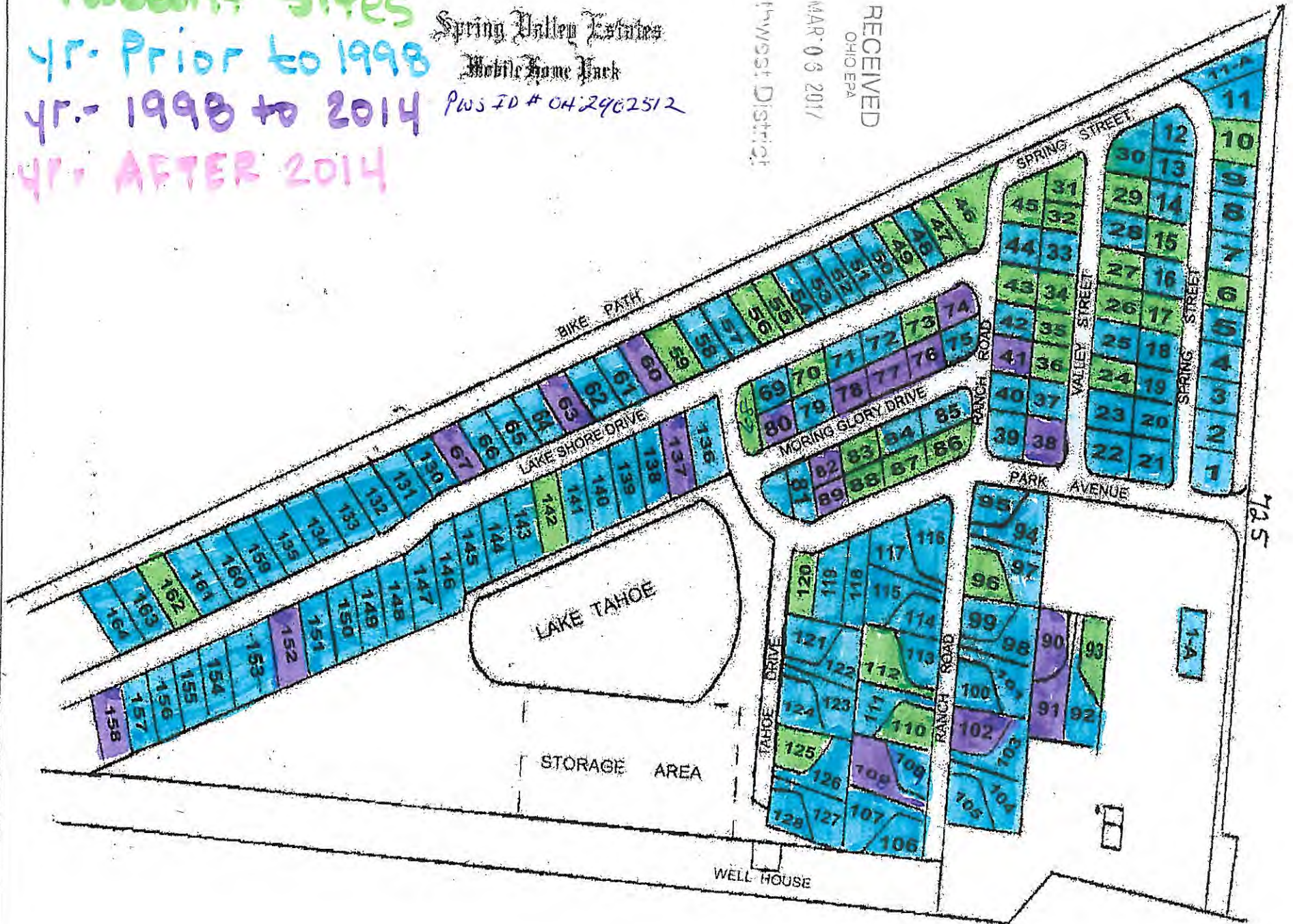

725

LEAD SERVICE LINE AND FIXTURE MAPPING PROJECT – NARRATIVE

Spring Valley Estates MHP

March 2017

1830 State Route 725

Spring Valley, OH 45370

PWSID OH2902512

HB512 enacting section 6109.121 of the Ohio Revised Code (ORC) requires Spring Valley Estates MHP to complete a Lead Mapping Project in the distribution system. To complete this task Spring Valley Estates MHP has followed the OEPA document titled, "Guidelines for the Lead Mapping in Distribution Systems" dated January 6, 2017, hereafter referred to as, "The Guideline".

The Spring Valley Estates MHP was constructed between 1967 and the early 1970s. The blueprints of the park indicate that all water mains were constructed with NSF Approved Plastic Pipes. Older mobile homes (from before the mid 1980s) were built with galvanized steel or copper and used compression fittings to connect the parts, no lead solder was used in their construction. After the mid 1980s the mobile homes were constructed using plastic pipes.

To complete the map Spring Valley Estates MHP used the construction date of the mobile homes. Green indicates vacant lots, Blue indicates homes constructed before 1998, and Purple indicates homes constructed between 1998 and 2014. There are no homes in the park constructed after 2014.

The Guideline states, "Because it is practically impossible to determine the lead content of an installed fixture, fitting or pipe, it should be assumed that the manufacture or installation date is the primary indicator of the lead content. Therefore, the characteristics of buildings and piping solder or fixtures would be buildings in Ohio built prior to 1998 or that use plumbing material or solder manufactured before 1998 may have materials with greater than 8% lead and are at a higher risk of contributing lead to the drinking water than materials manufactured after 1998. In addition, buildings built and plumbing materials manufactured after 2014 were required to have less than 0.25% lead by weight and have the lowest risk for contributing lead to the drinking water. It should be noted however that, although prohibited, some use of leaded solder or leaded components may have occurred after the prohibitions became effective".

Spring Valley Estates MHP does not know of any lead service lines in the park so far as can be determined by the personnel.

RECEIVED
OHIO EPA

MAR 06 2017

Southwest District

VERIFICATION FORM FOR COMMUNITY PUBLIC WATER SYSTEMS CLAIMING NO LEAD SERVICE LINES

The owner or operator of all community public water systems must identify and map areas of their distribution system that are known or are likely to contain lead service lines. Systems must submit a copy of the applicable map to the Ohio Department of Health and the Ohio Department of Job and Family Services. Systems must also submit a report to the director containing at least both of the following: (1) The applicable map with narrative, and (2) A list of sampling locations used to collect samples as required by Ohio Revised Code (ORC) Section 6109.121 and any rules adopted thereunder, including contact information for the owner and occupant of each sampling site.

Should a water system determine no lead service lines exist in their distribution system, they must provide information stating they reviewed, at the minimum, historical permit records and local ordinances, distribution maintenance records and information pertaining to installation dates or materials for all services lines. This information must be verified below.

I HEREBY CERTIFY THAT THE FOLLOWING METHOD(S) WERE USED TO DETERMINE NO LEAD SERVICE LINES EXIST IN THIS WATER SYSTEM'S DISTRIBUTION SYSTEM, AS REQUIRED BY ORC 6109.121(F):

LEAD SERVICE LINE VERIFICATION
<p>This PWS states they have no lead service lines and has reviewed the following information (select one or more of the following):</p> <ul style="list-style-type: none"> <input type="checkbox"/> Historical permit records and/or local ordinances <input checked="" type="checkbox"/> Distribution maintenance records (i.e. meter replacement, waterline break repairs) <input type="checkbox"/> Information pertaining to installation dates for all service lines (i.e. after 1986 when lead services lines were banned) <input type="checkbox"/> Service line material of all service lines is known (i.e. all service lines are known to be PVC)

<i>Jonathan M. Tichenor</i>	2-22-17
Signature of Responsible Person	Date
<i>Timothy M. Tichenor Operator of Record</i>	
Printed Name and Title of Responsible Person	

PWS NAME: Spring Valley Estates M/H
PWS ID: OH 2902512
COUNTY: GREEN

<p>For Ohio EPA use only:</p> <p>Date Verification Rec'd. _____</p>
--

RECEIVED
 OHIO EPA
 MAR 03 2017

Southwest