

2974

APPROXIMATE LOCATION OF WATER LINES (NOT TO SCALE)

APPROXIMATE VALVE LOCATION (NOT TO SCALE)

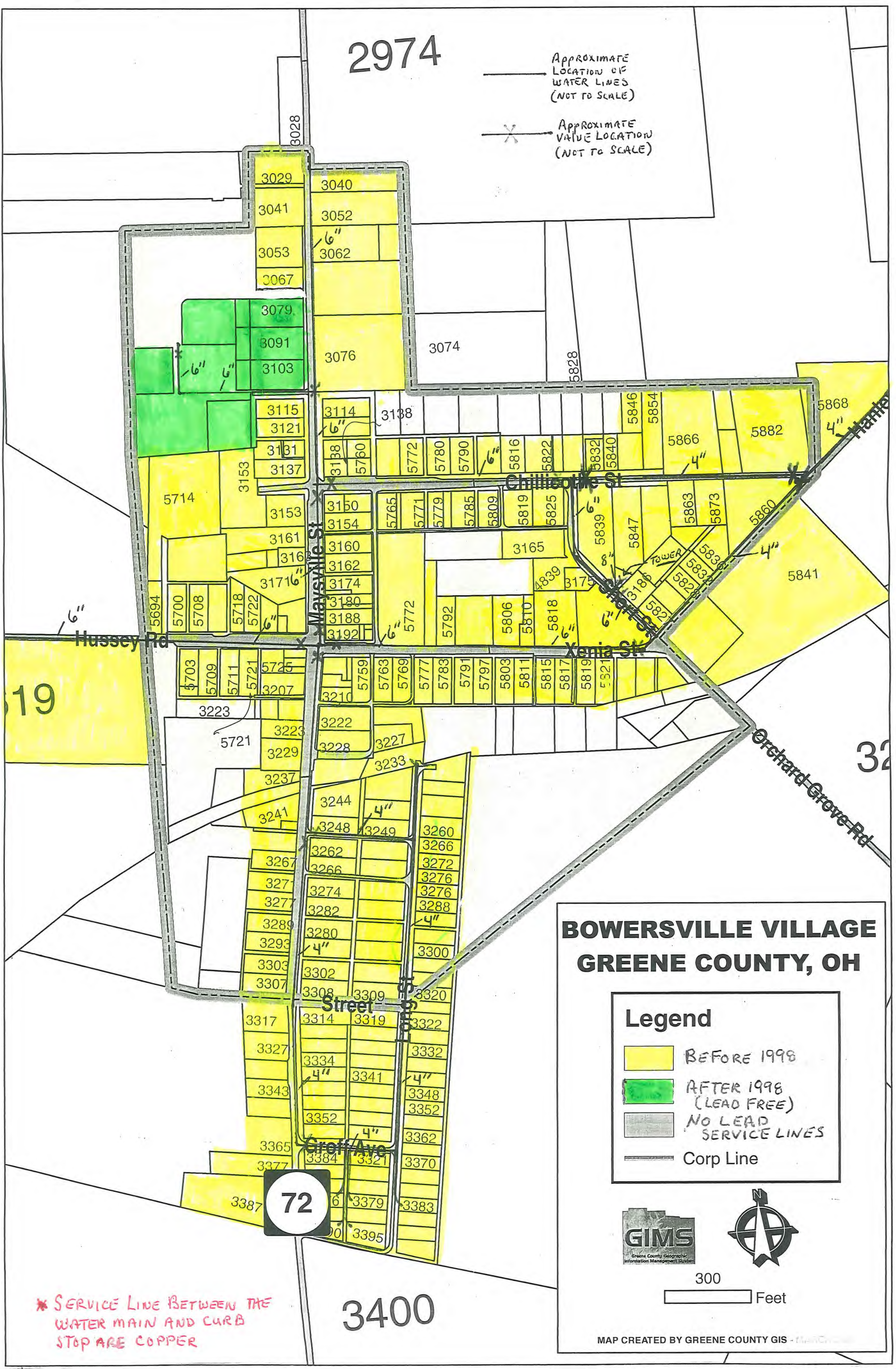

BOWERSVILLE VILLAGE GREENE COUNTY, OH

Legend

- BEFORE 1998
- AFTER 1998 (LEAD FREE)
- NO LEAD SERVICE LINES
- Corp Line



300 Feet

MAP CREATED BY GREENE COUNTY GIS - MARCH 2008

* SERVICE LINE BETWEEN THE WATER MAIN AND CURB STOP ARE COPPER

72

3400

LEAD MAPPING PROJECT

The map provided delineates the areas of town which were constructed before 1998 and after 1998. Areas constructed before 1998 are represented in yellow and areas after 1998 in green. It has also been noted on the map that the service lines from the water mains to the curb stops are all copper pipe.

The gray box in the map legend is to indicate the absence of any lead service lines in Bowersville.

- No historical permits are available to verify the presence or absence of lead service lines in Bowersville.
- No local ordinances are extant which prohibit the installation of lead service lines.
- No distribution maintenance records exist for the Village of Bowersville that would indicate the composition of the water service lines. However, in my thirteen years of experience, during which time I have repaired water main breaks, installed street valves and hydrants, and replaced curb stops, I have observed that all service laterals from water main to curb stop are copper. The service lines connecting the curb stop to the house that I have observed have been largely galvanized pipe. I have observed some copper and plastic service lines.
- Bowersville does not have water meters.

NARRATIVE DESCRIPTION OF BUILDINGS SERVED BY THE WATER SYSTEM LIKELY TO CONTAIN LEAD SOLDER, PLUMBING OR FIXTURES.

As indicated on the map provided, most of Bowersville was constructed previous to 1998. Therefore, it can be assumed that the water fixtures, fittings and pipe work contain lead at a content greater than 8%. Bowersville consist largely of residential housing with a small commercial presence. The residential housing is made up of single family homes. The commercial spaces include a gas station,

post office, grain elevator and a used car dealership. There are also two public spaces, the fire station and the senior citizens center.

TIER 1 SITES

To the best of my knowledge there are no Tier 1 Sites in the Village of Bowersville. The lead sampling has been done at either Tier 2 or Tier 3 sites.

Steve Haines
Village of Bowersville
Water Superintendent

Phone: 1-937-902-8828 (cell)
1-937-675-2437 (home)

Email: shaines76@yahoo.com

RECEIVED
OHIO EPA

FEB 27 2017

Southwest District

VERIFICATION FORM FOR COMMUNITY PUBLIC WATER SYSTEMS CLAIMING NO LEAD SERVICE LINES

The owner or operator of all community public water systems must identify and map areas of their distribution system that are known or are likely to contain lead service lines. Systems must submit a copy of the applicable map to the Ohio Department of Health and the Ohio Department of Job and Family Services. Systems must also submit a report to the director containing at least both of the following: (1) The applicable map with narrative, and (2) A list of sampling locations used to collect samples as required by Ohio Revised Code (ORC) Section 6109.121 and any rules adopted thereunder, including contact information for the owner and occupant of each sampling site.

Should a water system determine no lead service lines exist in their distribution system, they must provide information stating they reviewed, at the minimum, historical permit records and local ordinances, distribution maintenance records and information pertaining to installation dates or materials for all service lines. This information must be verified below.

I HEREBY CERTIFY THAT THE FOLLOWING METHOD(S) WERE USED TO DETERMINE NO LEAD SERVICE LINES EXIST IN THIS WATER SYSTEM'S DISTRIBUTION SYSTEM, AS REQUIRED BY ORC 6109.121(F):

| LEAD SERVICE LINE VERIFICATION |
|--|
| <p>This PWS states they have no lead service lines and has reviewed the following information (select one or more of the following):</p> <ul style="list-style-type: none"><input type="checkbox"/> Historical permit records and/or local ordinances<input type="checkbox"/> Distribution maintenance records (i.e. meter replacement, waterline break repairs)<input type="checkbox"/> Information pertaining to installation dates for all service lines (i.e. after 1986 when lead services lines were banned)<input checked="" type="checkbox"/> Service line material of all service lines is known (i.e. all service lines are known to be PVC) |

Steve N. Harris 2-24-17
Signature of Responsible Person Date

PWS NAME: VILLAGE OF BOWERSVILLE
2900212