

SABINA RICHLAND TOWNSHIP 2016

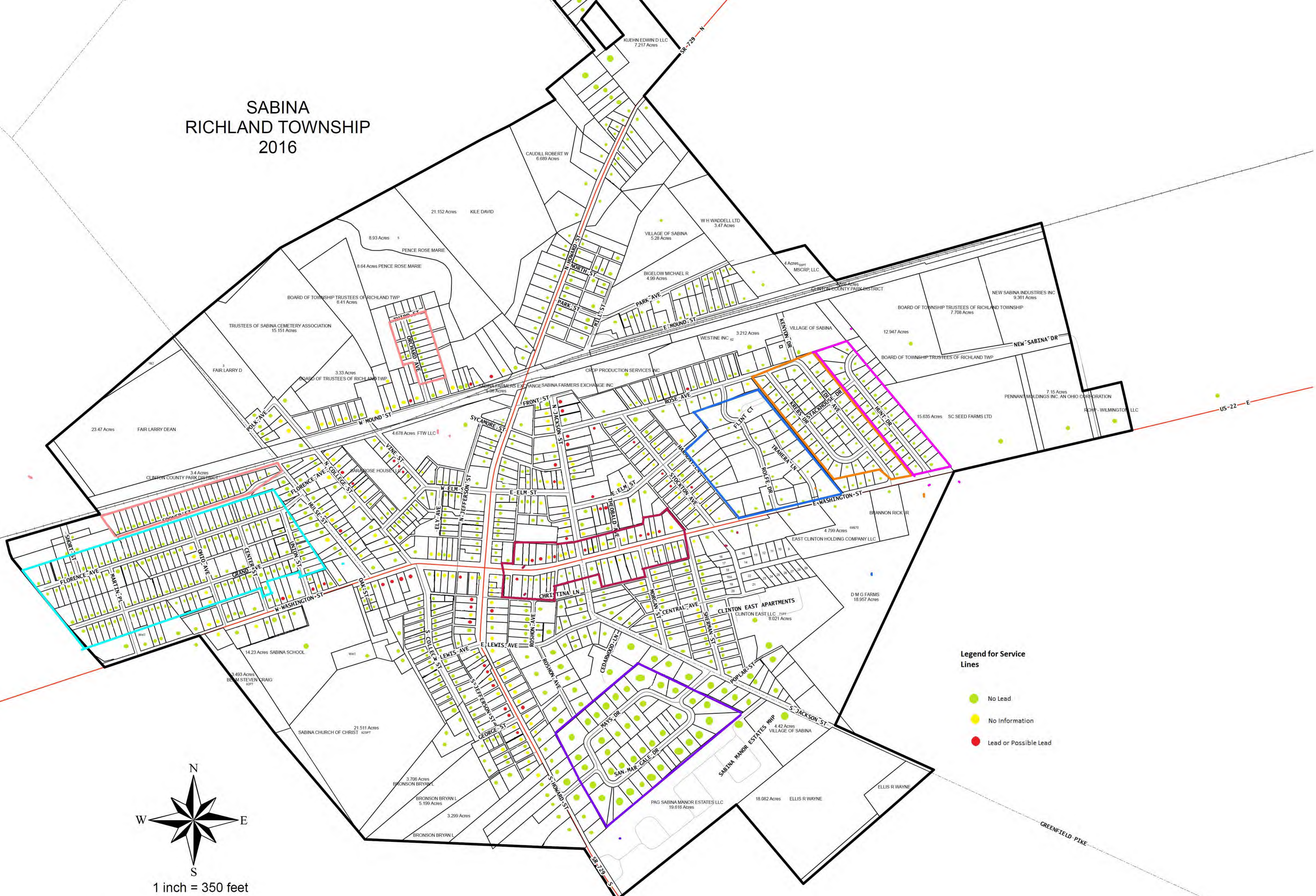

Legend for Service Lines

- No Lead
- No Information
- Lead or Possible Lead

N
W E
S
1 inch = 350 feet

- 1945-1955
- 1960-1979
- 1991-1995
- 1973-1993
- 1993-2007
- 1927-1945
- Trailers

Village of Sabina Lead Mapping Narrative

In June 2016, House Bill 512 was passed to enact O.R.C. Section 6109.121 to establish requirements governing lead and copper testing for community and non-transient, non-community public water systems and to revise law governing lead contamination from plumbing and fixtures. The law requires community water systems to identify and map areas of their distribution systems that are known or likely to contain lead service lines. These systems are also required to identify and provide a description of the characteristics of buildings served by the system that may contain lead solder, fixtures or pipes. Single building community and non-transient, non-community water systems are required to map areas of the system that have solder, fixtures and pipes containing lead. Water systems are encouraged to work with their local building authorities when identifying distribution areas with lead service lines.

Because it is practically impossible to determine the lead content of an installed fixture, fitting or pipe, it should be assumed that the manufacture or installation date is the primary indicator of the lead content. Therefore, the characteristics of buildings and piping solder or fixtures would be buildings in Ohio built prior to 1998 or that use plumbing material or solder manufactured before 1998 may have materials with greater than 8% lead and are at a higher risk of contributing lead to the drinking water than materials manufactured after 1998. In addition, buildings built and plumbing materials manufactured after 2014 were required to have less than 0.25% lead by weight and have the lowest risk for contributing lead to the drinking water. It should be noted however that, although prohibited, some use of leaded solder or leaded components may have occurred after the prohibitions became effective.

Supporting information dictates, that on our side, we have non-lead service lines on properties which are marked as lead free on the service line map. See attached spreadsheet.

The houses listed below were built in 1998 or later.

55 Dakins Chapel	324 Dakins Chapel	316 E Washington
93 Dakins Chapel	328 Dakins Chapel	403 E Washington
174 Dakins Chapel	350 Dakins Chapel	535 E Washington
204 Dakins Chapel	374 Dakins Chapel	660 E Washington
212 Dakins Chapel	390 Dakins Chapel	80 Ely
222 Dakins Chapel	31 E Washington	88 Ely
236 Dakins Chapel	122 E Washington	75 Harmony
242 Dakins Chapel	181 E Washington	119 Harmony
258 Dakins Chapel	205 E Washington	131 Harmony
274 Dakins Chapel	314 E Washington	143 Harmony

190 Hulse

193 Hulse

114 N College

116 N College

219 N Howard

247 N Howard

359 N Howard

677 N Howard

12 Rolfe

70 Rolfe

92 Rolfe

114 Rolfe

129 Rolfe

136 Rolfe

139 Rolfe

163 Rolfe

205 Rose

290 Rose

305 S College

307 S College

309 S College

179 S Jackson

33 Sherman

35 Sherman

210 Short

20 Trahera

42 Trahera

64 Trahera

86 Trahera

108 Trahera

161 W Elm

67 W Washington