

Latest map.

SHERWOOD FOREST MOBILE HOME PARK

12/91

Plastic

metal

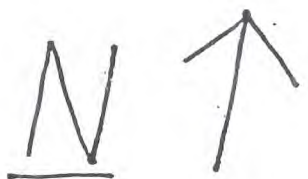

SEWER DISCHARGE POINT

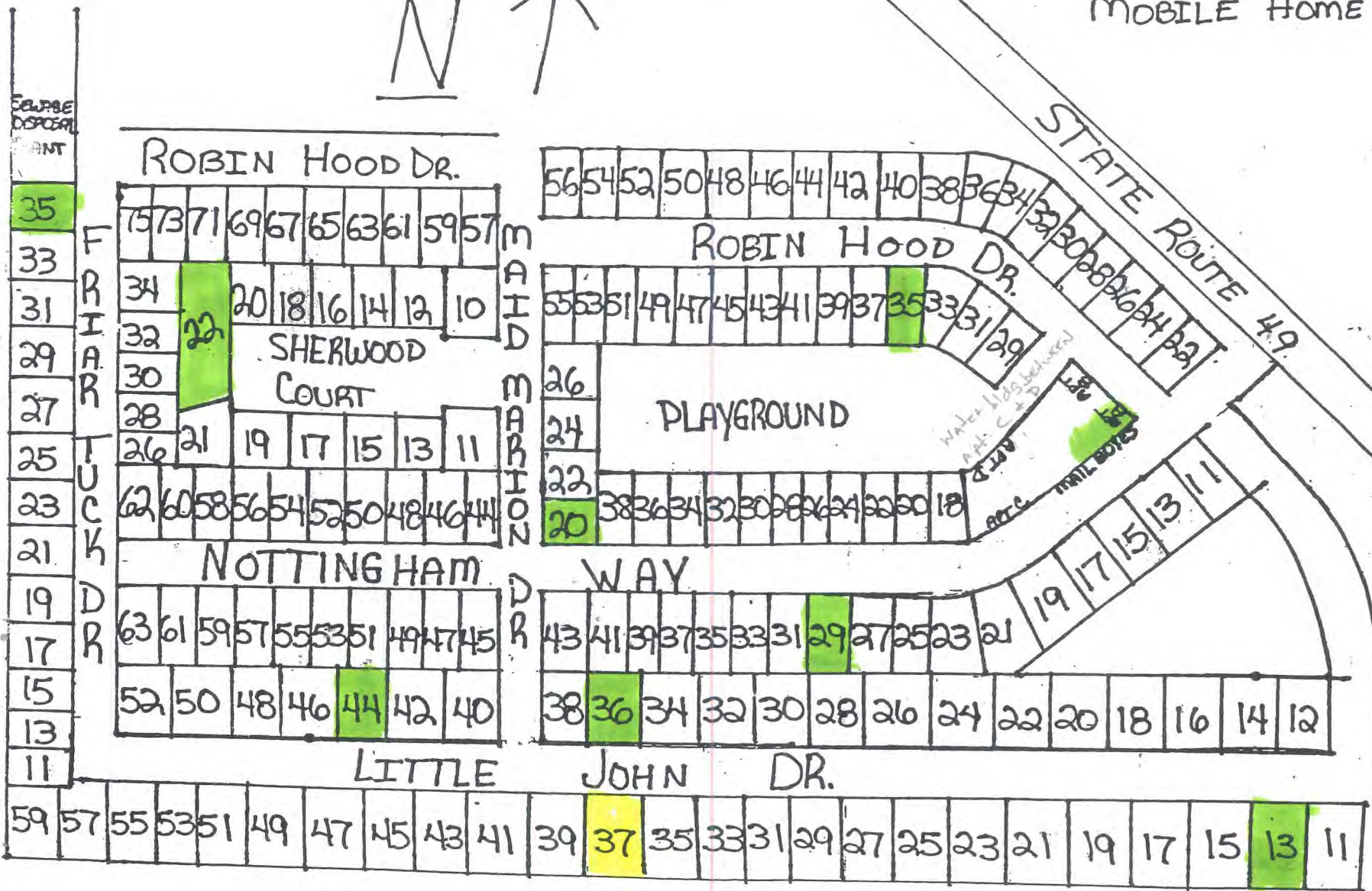

House	Feed line	Water line	Fittings
35 Robin Hood	Poly Pex	Poly Pex	Plastic
20 maid marion	Poly Pex	<del>Poly Pex</del> PVC	Plastic
44 Little John	Poly Pex	PVC	Plastic
29 Nottingham Way	Poly Pex	Poly Pex	Plastic
35 Friar Tuck	Pex	Pex	Brass
27A Robin Hood	PVC	PVC	PVC
22 Sherwood Ct	Poly Pex	Poly Pex	Plastic
13 Little John Dr	Poly Pex	Poly Pex	Plastic & Brass
36 Little John Dr	Poly Pex	Poly Pex	Plastic
37 Little John Dr	Copper	Copper	Copper

All trailers have Brass shutoffs in line

75 Robin Hood is a tear down was replaced by 35 Friar Tuck

75 Robin Hood is all copper line

### VERIFICATION FORM FOR COMMUNITY PUBLIC WATER SYSTEMS CLAIMING NO LEAD SERVICE LINES

The owner or operator of all community public water systems must identify and map areas of their distribution system that are known or are likely to contain lead service lines. Systems must submit a copy of the applicable map to the Ohio Department of Health and the Ohio Department of Job and Family Services. Systems must also submit a report to the director containing at least both of the following: (1) The applicable map with narrative, and (2) A list of sampling locations used to collect samples as required by Ohio Revised Code (ORC) Section 6109.121 and any rules adopted thereunder, including contact information for the owner and occupant of each sampling site.

Should a water system determine no lead service lines exist in their distribution system, they must provide information stating they reviewed, at the minimum, historical permit records and local ordinances, distribution maintenance records and information pertaining to installation dates or materials for all service lines. This information must be verified below.

I HEREBY CERTIFY THAT THE FOLLOWING METHOD(S) WERE USED TO DETERMINE NO LEAD SERVICE LINES EXIST IN THIS WATER SYSTEM'S DISTRIBUTION SYSTEM, AS REQUIRED BY ORC 6109.121(F):

LEAD SERVICE LINE VERIFICATION	
This PWS states they have no lead service lines and has reviewed the following information (select one or more of the following):	
<input type="checkbox"/>	Historical permit records and/or local ordinances
<input type="checkbox"/>	Distribution maintenance records (i.e. meter replacement, waterline break repairs)
<input type="checkbox"/>	Information pertaining to installation dates for all service lines (i.e. after 1986 when lead services lines were banned)
<input checked="" type="checkbox"/>	Service line material of all service lines is known (i.e. all service lines are known to be PVC) <i>Syn area as etc</i>

*Sherwood Forest by Lois Spahr* 3-6-17  
Signature of Responsible Person Date

*SHERWOOD FOREST BY LOIS SPHAR MGR.*  
Printed Name and Title of Responsible Person

PWS NAME: Sherwood Forest  
MHP  
PWS ID: QH1901112  
COUNTY: Darke

<b>For Ohio EPA use only:</b>
Date Verification Rec'd: _____