

Village of Fletcher Public Water System Lead and Copper Map Legend Narrative

- Yellow areas on the map indicate buildings constructed prior to 1998. These buildings may or may not contain fixtures or piping containing lead or lead solder.
- Blue areas on the map indicate buildings constructed after 2014 with a low risk of having fixtures or piping that contains lead or lead solder.
- Orange areas on the map indicate buildings constructed between the years 1998 and 2013 with a low risk of having fixtures or piping that contains lead or lead solder.
- The Village of Fletcher has no information indicating that we have any lead service lines in our system.
- “Because it is practically impossible to determine the lead content of an installed fixture, fitting or pipe, it should be assumed that the manufacture or installation date is the primary indicator of the lead content. Therefore, the characteristics of buildings and piping solder or fixtures would be buildings in Ohio built prior to 1998 or that use plumbing material or solder manufactured before 1998 may have materials with greater than 8% lead and are at a higher risk of contributing lead to the drinking water than materials manufactured after 1998. In addition, buildings built and plumbing materials manufactured after 2014 were required to have less than 0.25% lead by weight and have the lowest risk for contributing lead to the drinking water. It should be noted however that, although prohibited, some use of leaded solder or leaded components may have occurred after the prohibitions became effective.”

VILLAGE OF FLETCHER

WATER DISTRIBUTION MAP

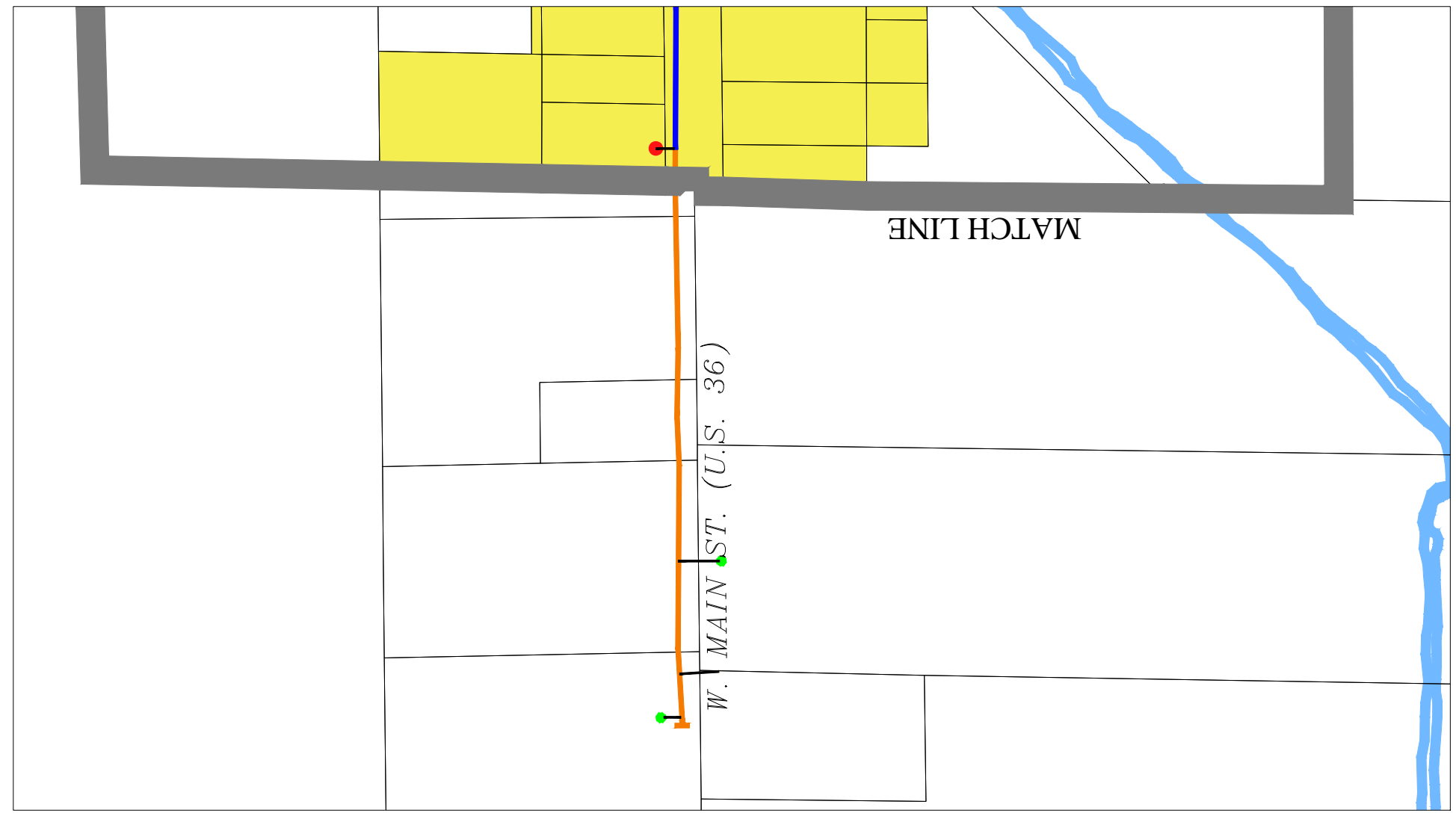
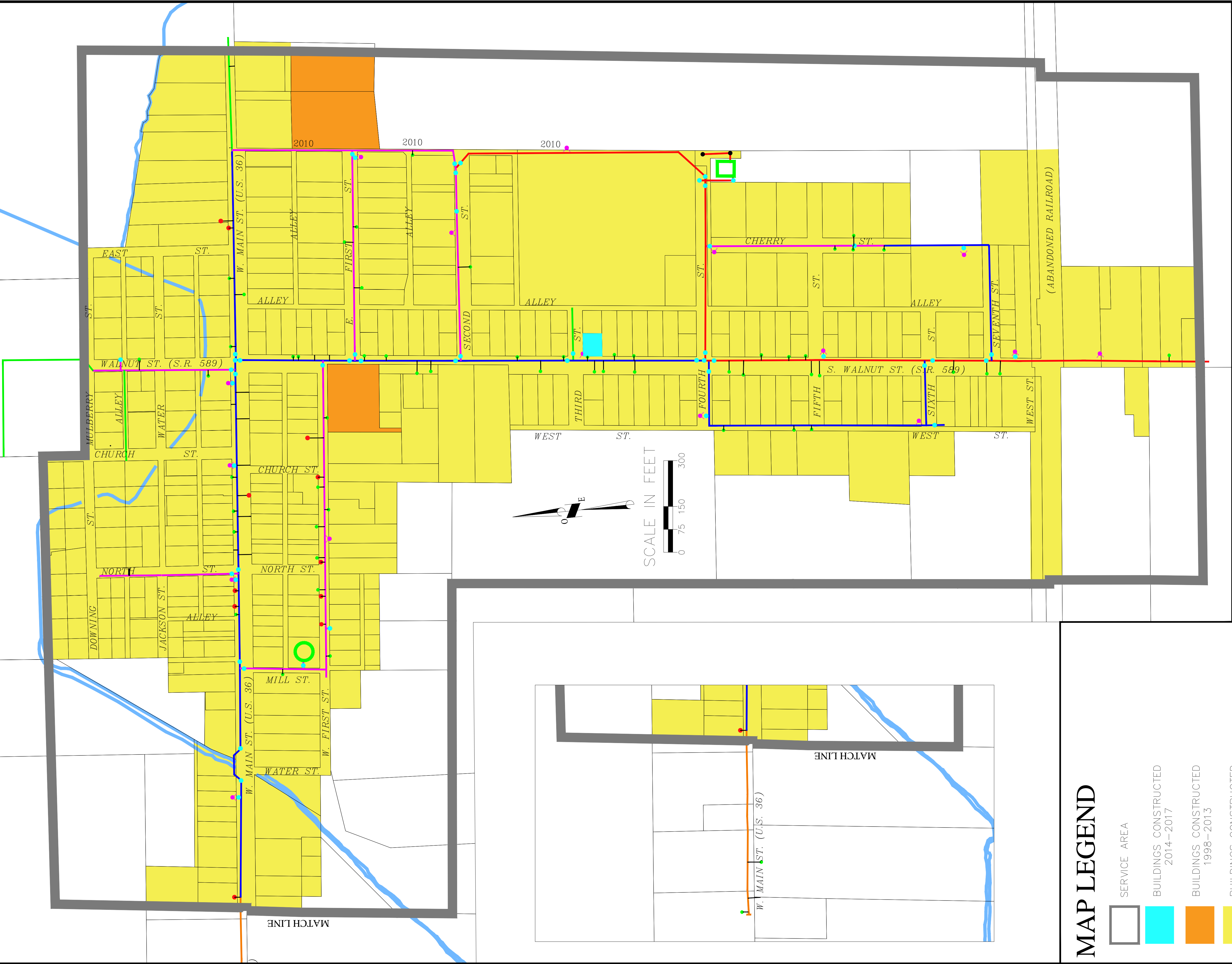

MAP LEGEND

- SERVICE AREA
- BUILDINGS CONSTRUCTED 2014-2017
- BUILDINGS CONSTRUCTED 1998-2013
- BUILDINGS CONSTRUCTED BEFORE 1998
- 2" PVC
- 4" PVC
- 6" DUCTILE IRON
- 6" PVC
- 8" PVC
- GUSTIN DITCH
- SERVICE LINE

- WATER VALVE
- SERVICE CURB STOP
- SERVICE WATER METER
- FIRE HYDRANT
- VILLAGE WELL
- WATER TREATMENT PLANT
- WATER TOWER

NOTE:
ALL WATER MAINS SOUTH OF MAIN ST. WERE INSTALLED IN 2000.
ALL WATER MAINS NORTH OF MAIN ST. WERE INSTALLED IN 2005.



440 E. HOEWISHER ROAD
SPRINGFIELD, OHIO 45365
(937) 497-0200
www.choiceoneengineering.com

607 N. MERIDIAN STREET
PORTLAND, INDIANA 46140
(317) 238-8554
(260) 766-2500



DRINKING WATER LEAD AND COPPER MONITORING REPORT

PWS Name: Village of Fletcher PWS	PWSID: 5500412 OH	County: Miami	Population: 550
PWS Address: Village of Fletcher PWS 71 N. Walnut St Fletcher, Ohio 45326	Phone: 937-606-0334	Sampling begin date: 09/26/2016	Sampling end date: 09/26/2016
Monitoring Schedule: <input type="checkbox"/> "6 month" or "optional" <input checked="" type="checkbox"/> "annual" or "triennial"			

Return this completed form by mail or fax to the appropriate Ohio EPA district office (receipt being no later than 10 days after the end of the monitoring period). Retain a copy of this report in your files with supporting documentation for a minimum of 12 years.

Lead and Copper Tap Monitoring (First-Draw Samples)

a.	Number of sampling sites required: 10	Number of samples analyzed: 10
	If the number of samples analyzed is less than the standard number of sampling sites required for your water system, then explain why:	
b.	Were all sampling sites tier 1 sites? () Yes (x) No	If no, explain: Not all tier 1 sites were available
c.	Were 50% of your lead samples from sites with Lead Service Lines? () Yes (x) No	If no, explain: We do not have any lead service lines that I am aware of.
d.	Have any of your sampling sites changed since the last monitoring period? (x) Yes () No	If yes, state which sites and explain: Not all the previous sites were available.



DRINKING WATER LEAD AND COPPER MONITORING REPORT

e.	90 th % Lead Level (mg/L): <5.0	90 th % Copper Level (mg/L):0.718
----	--	--

When the 90th % Lead Level is 0.0155 mg/L (or higher) or the 90th % Copper Level is 1.350 mg/L (or higher), contact your Ohio EPA district office within three business days for additional requirements.

I certify that each first-draw lead and copper sample collected for our water system was one liter in volume, was taken from a kitchen or bathroom cold-water tap or a drinking fountain, and, to the best of my knowledge, had stood motionless in the service line and in the interior plumbing of the sampling site for at least six hours. I further certify that each tap sample collected by residents was taken after the water system informed them of proper sampling procedures.

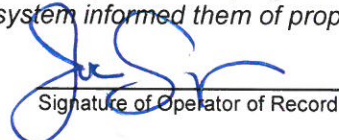
Signature of Operator of Record

09/30/2016
Date

Joe Sampson
Printed Name

For Ohio EPA use only:	Received Date:	Monitoring Period:	Approved: () Yes () No
------------------------------	-------------------	-----------------------	--------------------------

Submit with Form EPA 5105

Page ____ of ____ pages

PWS Name:Fletcher PWS	PWSID:5500412	Analytical Laboratory Name: Masi Labs	Laboratory Certification No. 877
	OH		

List samples sequentially by Laboratory Sample Number



DRINKING WATER LEAD AND COPPER MONITORING REPORT

Date of Sample	Time Sample Taken	Laboratory Sample Number	Address of Sample Site Example: 234 S Main St Town OH 40000	Tap Type* and Location Example: B 2 nd floor	Structure Type SFR, MFR or BLDG	Interior Plumbing Material Pb, CuPb>82, CuPb<83, or other	Service Line Material Pb, Cu, or other	Tier 1, 2, 3, or other	Lead Conc'n (ug/L)	Copper Conc'n (ug/L)
09/26/16	06:41	180001	100E. Fifth St. Fletcher, Ohio 45326	B Faucet	SFR	CuPb<83	Cu	3	<5.0	147
09/26/16	03:30	180002	108 East Second St Fletcher, Ohio 45326	K Faucet	SFR	CuPb<83	Cu	3	<5.0	229
09/26/16	06:07	424426	505 Cherry Lane Fletcher, Ohio 45326	K Faucet	SFR	CuPb<83	Cu	3	<5.0	264
09/26/16	05:30	48470	300 West Main St. Fletcher, Ohio 45326	B Faucet	SFR	CuPb<83	Cu	3	<5.0	300
09/26/16	06:00	263164	706 S. Walnut St. Fletcher, Ohio 45326	K Faucet	SFR	CuPb<83	Cu	3	<5.0	355
09/26/16	03:38	263162	311 S.Walnut St. Fletcher, Ohio 45326	K Faucet	SFR	CuPb<83	Cu	3	<5.0	381
09/26/16	05:45	263163	603 S. Walnut St. Fletcher, Ohio 45326	K Faucet	SFR	CuPb<83	Cu	3	<5.0	427
09/26/16	05:00	431139	111 W. Main St. Fletcher, Ohio 45326	K Faucet	SFR	CuPb<83	Cu	3	<5.0	591
09/26/16	06:30	180003	52 North St, Fletcher, Ohio 45326	B Faucet	SFR	CuPb<83	Cu	3	<5.0	718
09/26/16	07:00	424774	209 S. Walnut St. Fletcher, Ohio 45326	K Faucet	SFR	CuPb<83	Cu	3	<5.0	3750

*Tap type codes: B – bathroom cold water tap; D – drinking fountain; K – kitchen sink cold water tap; R – restroom sink cold water tap; O – other (with prior Ohio EPA acceptance)

Note: 1 mg/L = 1000 ug/L

Village of Fletcher

Water Department

71 North Walnut Street
Fletcher, Ohio 45326
937-606-0334

March 1st, 2017

Ohio Environmental Protection Agency
Southwest District Office
401 East Fifth Street
Dayton, Ohio 45402

Ref: Lead Service Line and Fixture Mapping Project

To whom it may concern,

As per your request I have completed, to the best of my ability, the lead service line and fixture mapping project. Included you will find the map, lead and copper sample points and the verification form, claiming no lead service lines.

The Village of Fletcher PWS has sampled for Lead and Copper each year it has been required. Our records show back as far as 1995 that most of our lead results have been below detection limit, with only 3 above, but none violating the 90th percentile. The (less than 3) are most likely sample errors. So it becomes obvious that we do not have an issue with lead.

I have been employed by the Village of Fletcher PWS for 25 years. In that period of time we have installed over 90% all new C900 water mains with the remainder ductile iron. All new copper service lines were installed as well. There were no lead service lines or mains observed in any construction phase. We have also all new meters in the Village within the last 7 years I believe. As far as main breaks, there has only been 1 since all the new water lines were installed and it was a 2 inch ductile iron line. I have never seen any indications of lead material being used in the Village of Fletcher and our testing results should verify that.

Please, if you have any questions or concerns, feel free to contact me at any time.
Thank you.

Sincerely,



Joe Sampson
WS3 1011718-04

VERIFICATION FORM FOR COMMUNITY PUBLIC WATER SYSTEMS CLAIMING NO LEAD SERVICE LINES

The owner or operator of all community public water systems must identify and map areas of their distribution system that are known or are likely to contain lead service lines. Systems must submit a copy of the applicable map to the Ohio Department of Health and the Ohio Department of Job and Family Services. Systems must also submit a report to the director containing at least both of the following: (1) The applicable map with narrative, and (2) A list of sampling locations used to collect samples as required by Ohio Revised Code (ORC) Section 6109.121 and any rules adopted thereunder, including contact information for the owner and occupant of each sampling site.

Should a water system determine no lead service lines exist in their distribution system, they must provide information stating they reviewed, at the minimum, historical permit records and local ordinances, distribution maintenance records and information pertaining to installation dates or materials for all services lines. This information must be verified below.

I HEREBY CERTIFY THAT THE FOLLOWING METHOD(S) WERE USED TO DETERMINE NO LEAD SERVICE LINES EXIST IN THIS WATER SYSTEM'S DISTRIBUTION SYSTEM, AS REQUIRED BY
ORC 6109.121(F):

LEAD SERVICE LINE VERIFICATION

This PWS states they have no lead service lines and has reviewed the following information (select one or more of the following):

- ☐ Historical permit records and/or local ordinances
- ☐ Distribution maintenance records (i.e. meter replacement, waterline break repairs)
- ☐ Information pertaining to installation dates for all service lines (i.e. after 1986 when lead services lines were banned)
- ☐ Service line material of all service lines is known (i.e. all service lines are known to be PVC)

Signature of Responsible Person [Signature] Date WS3-1011718-04 3-1-17

Printed Name and Title of Responsible Person Joe Sampson Water operator

PWS NAME: Village of Fletcher
PWS ID: OH 5500412
COUNTY: Miami

For Ohio EPA use only:

Date Verification Rec'd: _____

VILLAGE OF FLETCHER

WATER DISTRIBUTION MAP

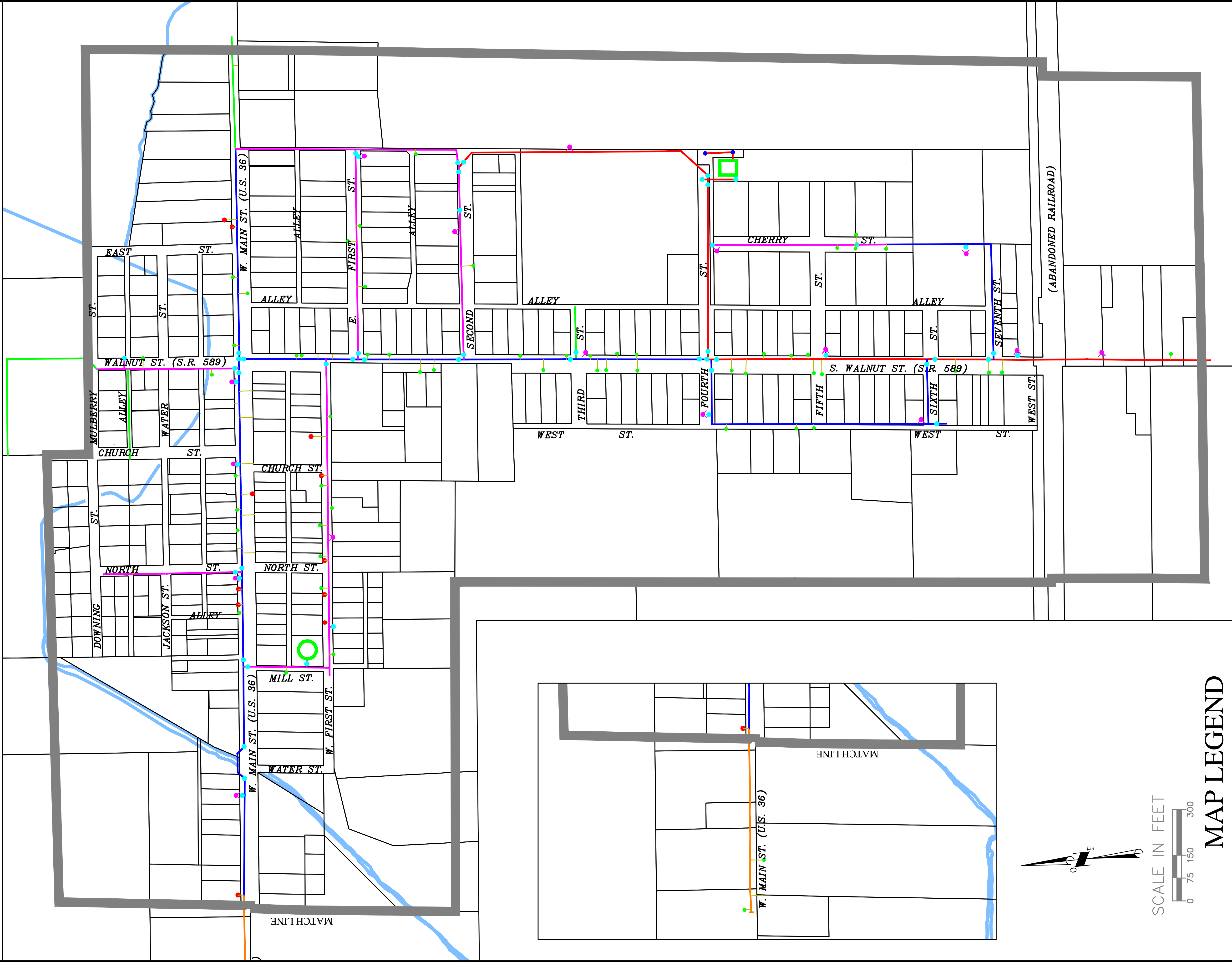

MAP LEGEND

- 2" PVC
- 4" PVC
- 6" DUCTILE IRON
- 6" PVC
- 8" PVC
- CORPORATION LIMITS
- GUSTIN DITCH
- SERVICE LINE

- WATER VALVE
- SERVICE CURB STOP
- SERVICE WATER METER
- FIRE HYDRANT
- VILLAGE WELL
- WATER TREATMENT PLANT
- WATER TOWER



440 E. HOEWISHER ROAD
SIDNEY, OHIO 45365
(937) 497-0200

203 W. LOVELAND AVENUE
LOVELAND, OHIO 45140
(513) 239-8554

607 N. MERIDIAN STREET
PORTLAND, INDIANA
(260) 766-2500

www.choiceoneengineering.com