

RECEIVED

MAR 09 2017

OHIO EPA NEDO

CANTEX PWS OH6782712 drinking water distribution mains consist of GALVANIZED AND COPPER WITH LEAD SOLDER OLDER 1965 . The service lines, hardware and meters are a combination of Brass, including corporation stops. No lead service lines are known at the time of this writing.

Because it is practically impossible to determine lead content of an installed fixture, fitting or pipe, it should be assumed that the DATE THE BUILDING WAS BUILT is the primary indicator of the lead content. Therefore, the characteristics would be buildings and piping solder or fixtures built prior to 1998 or that use plumbing material or solder manufactured before 1998 may have materials with greater than 8% lead and are at a higher risk of contributing lead to the drinking water than materials manufactured after 1998. In addition, buildings built and plumbing materials manufactured after 2014 were required to have less than 0.25% lead by weight and have the lowest risk for contributing lead to the drinking water. It should be noted however that, although prohibited, some use of leaded solder or leaded components may have occurred after the prohibitions became effective.

Eugene F. Davis

Chief Operator

Efdavis2 & Associates LLC

Entity: Canter  
Doc Type: REPORT  
Doc Subtype: \_\_\_\_\_  
Program: DRACW  
County: Portage  
Secondary ID: OH6782712

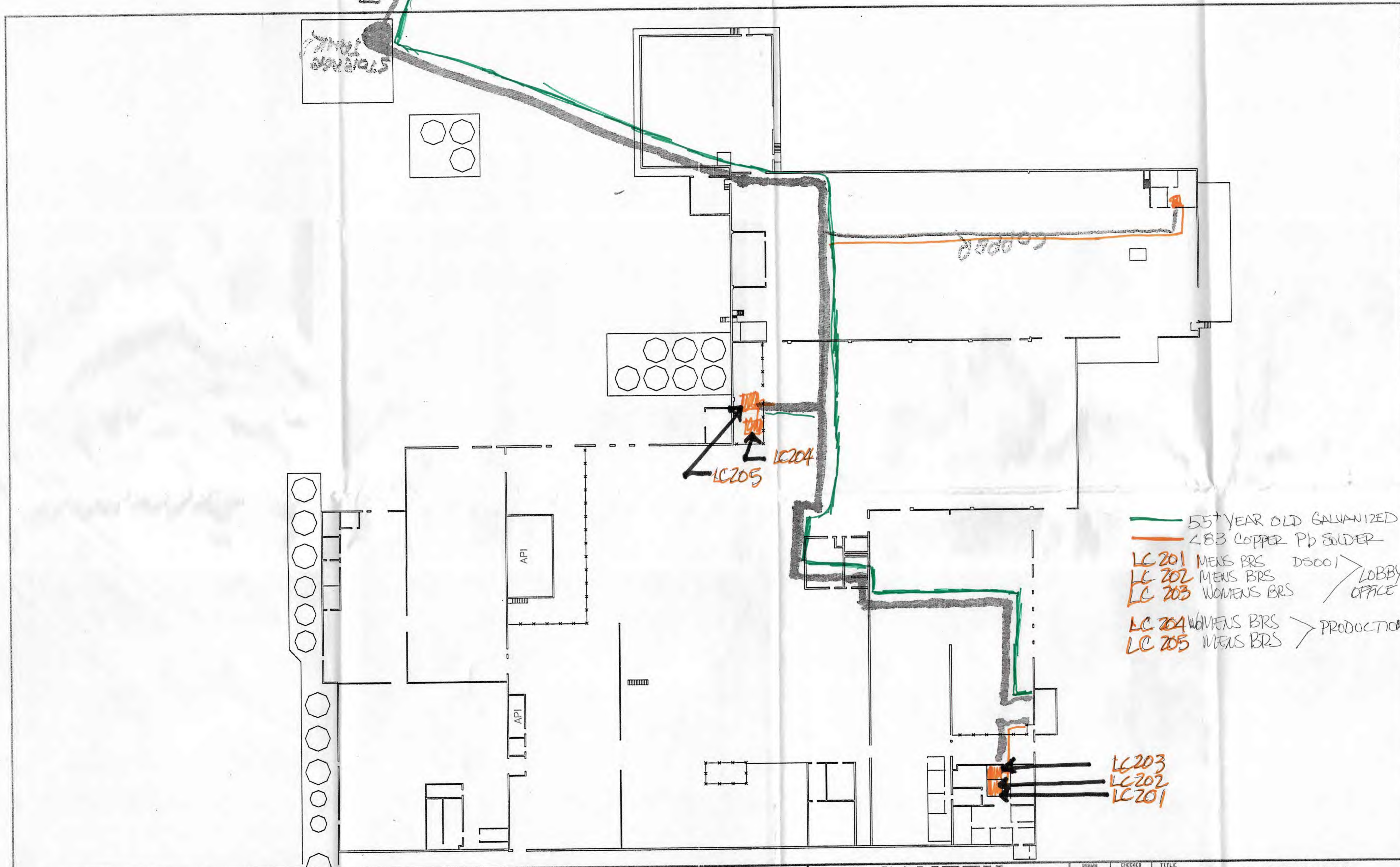

STORAGE TANK

To Well

COPPER

LC 204  
LC 205

— 55+ YEAR OLD GALVANIZED  
 — 483 COPPER Pb SOLDER  
 LC 201 MENS BRS D5001  
 LC 202 MENS BRS LOBBY  
 LC 203 WOMENS BRS OFFICE  
 LC 204 WOMENS BRS PRODUCTION  
 LC 205 MENS BRS

LC 203  
LC 202  
LC 201

CANTEX

TOLERANCES UNLESS OTHERWISE SPECIFIED  
 ANGULAR-----1/16"  
 FRACTIONAL 1/64  
 DECIMAL DPL 1.015  
 DPL 1.005

DATE	DATE	TITLE	REV.
6/21/99		NEW BLEND PLANT AURORA, OHIO	A
SHEET 1 OF 1		DRWG. NO.	

REV.	CHANGE	BY	DATE

RECEIVED  
 MAR 02 2017  
 OHIO EPA NEDO

Entity: Cantelex Inc  
 Doc Type: Report  
 Doc Subtype:   
 Program:   
 County:   
 Secondary ID:   
 save in color