

RE: McDonalds Restaurant - Bellville
Report
Lead Mapping
Drinking Water Program
Richland County
PWS ID: OH7048312

Craig Roberts

Operator Cert. # WS1-1013698-89

RECEIVED

MAR 20 2017

OHIO E.P.A.
N.W.D.O.

Here is the map for McDonalds Bellville and Hanley Road. Some of the hot water has soldered joints but was in long before the decision was made to reduce lead solder. We have had no lead show up in the water for either McDonalds. We take five samples from all the sinks in the resauarnt and have no lead show up.

“ building in Ohio built prior to 1998 or that use plumbing material or solder manufactured before 1998 may have materials with greater than 8% lead and are at a higher risk of contributing lead to the drinking water than materials manufactured after 1998. In addition, buildings built and plumbing materials manufactured after 2014 were required to have less than 0.25% lead by weight and have the lowest risk for contributing lead to the drinking water. It should be noted however that, although prohibited, some use of leaded solder or leaded components may have occurred after the prohibitions became effective.”

Craig Roberts

Bellville McDonald's

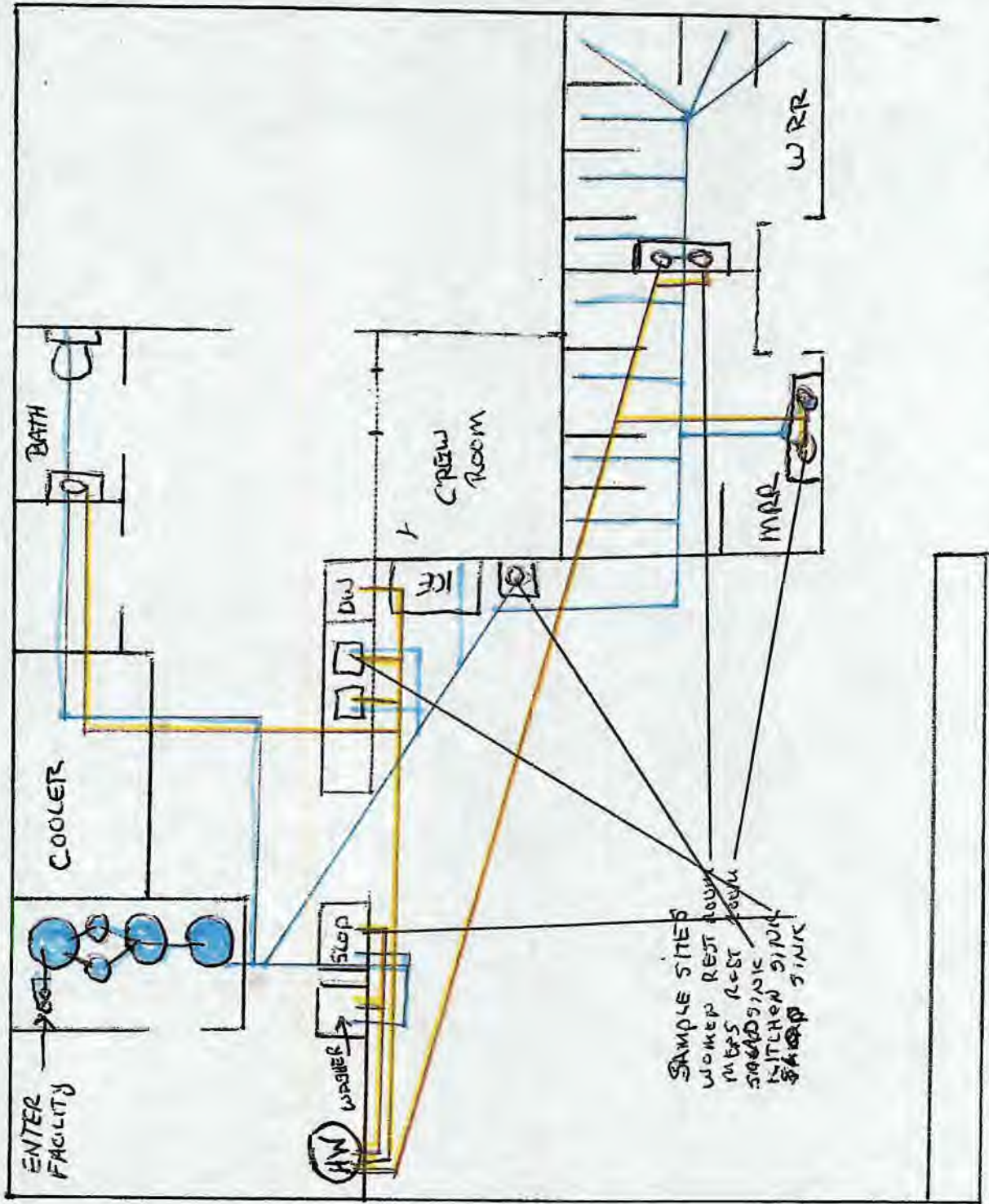

Bellville Plumbing
1989

PWS ID 7048312
860 ST RT 97 BELLVILLE OH
LINES: PWS, CH,
HOT WATER WAS SOLDERED JOINTS
SOLDERED JOINT CONTAIN LEAD