

RE: Northwest Twp Water District
Report
Lead Mapping
Drinking Water Program
Williams County
PWS ID: 8641912

Received
4/24/2017

RECORD OF THIS PROJECT WILL BE MAINTAINED AT THE OFFICE OF THE ENGINEER. THE CLIENT SHALL BE RESPONSIBLE FOR OBTAINING ALL NECESSARY PERMITS AND APPROVALS FROM ALL APPLICABLE AGENCIES. THE ENGINEER'S RESPONSIBILITY IS LIMITED TO THE DESIGN AND CONSTRUCTION OF THE WATER DISTRIBUTION SYSTEM AS SHOWN ON THESE PLANS. THE ENGINEER DOES NOT WARRANT THE ACCURACY OF THE DATA PROVIDED BY THE CLIENT OR THE RESULTS OF THE DESIGN. THE CLIENT SHALL BE RESPONSIBLE FOR OBTAINING ALL NECESSARY PERMITS AND APPROVALS FROM ALL APPLICABLE AGENCIES. THE ENGINEER'S RESPONSIBILITY IS LIMITED TO THE DESIGN AND CONSTRUCTION OF THE WATER DISTRIBUTION SYSTEM AS SHOWN ON THESE PLANS. THE ENGINEER DOES NOT WARRANT THE ACCURACY OF THE DATA PROVIDED BY THE CLIENT OR THE RESULTS OF THE DESIGN.

OVERALL WATER DISTRIBUTION SITE PLAN

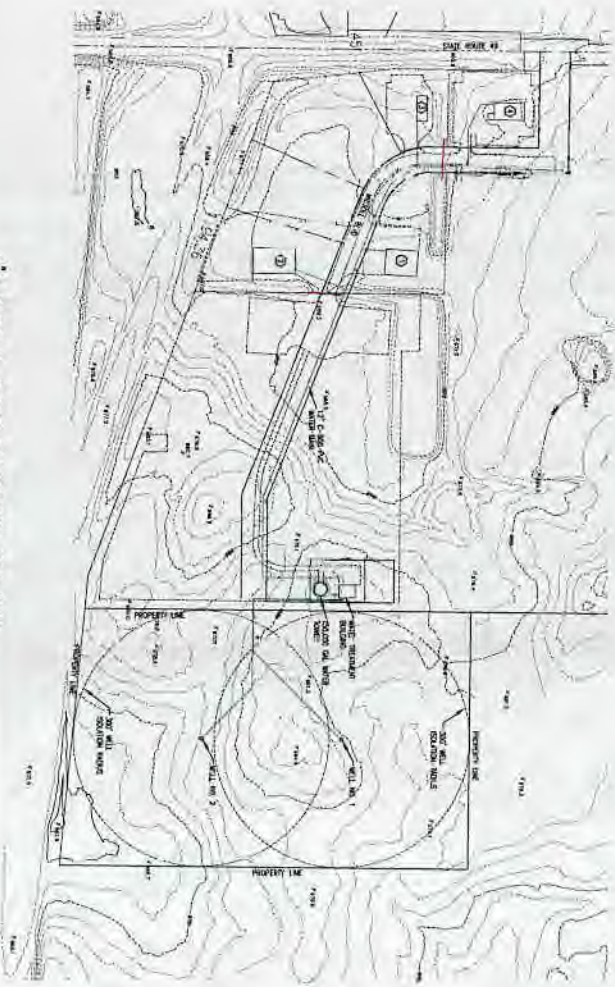

SYMBOLS FOR LINE TYPES
 --- MAIN LINE
 --- SERVICE LINE
 --- FIRE LINE



NO.	DESCRIPTION	DATE	BY
1	DESIGN	3/7/17	DB
2	REVISION	3/7/17	DB
3	REVISION	3/7/17	DB
4	REVISION	3/7/17	DB

Project/Client: NORTHWEST WATER DISTRICT NORTHWEST TOWNSHIP, WILLIAMS CO, OHIO		50 Industrial Drive, P.O. Box 247 Pioneer, Ohio 43084 (614) 757-2268 FAX: (614) 737-2364	Revisions										
		Date: 3-7-2017 Scale: SHOWN Drawn By: D. BERTKE Checked By: D. BERTKE	<table border="1"> <thead> <tr> <th>Date</th> <th>Description</th> </tr> </thead> <tbody> <tr> <td> </td> <td> </td> </tr> <tr> <td> </td> <td> </td> </tr> <tr> <td> </td> <td> </td> </tr> <tr> <td> </td> <td> </td> </tr> <tr> <td> </td> <td> </td> </tr> </tbody> </table>	Date	Description								
Date	Description												
Sheet Description: LEAD MAPPING													

**VERIFICATION FORM FOR COMMUNITY PUBLIC WATER SYSTEMS
CLAIMING NO LEAD SERVICE LINES**

The owner or operator of all community public water systems must identify and map areas of their distribution system that are known or are likely to contain lead service lines. Systems must submit a copy of the applicable map to the Ohio Department of Health and the Ohio Department of Job and Family Services. Systems must also submit a report to the director containing at least both of the following: (1) The applicable map with narrative, and (2) A list of sampling locations used to collect samples as required by Ohio Revised Code (ORC) Section 6109.121 and any rules adopted thereunder, including contact information for the owner and occupant of each sampling site.

Should a water system determine no lead service lines exist in their distribution system, they must provide information stating they reviewed, at the minimum, historical permit records and local ordinances, distribution maintenance records and information pertaining to installation dates or materials for all services lines. This information must be verified below.

I HEREBY CERTIFY THAT THE FOLLOWING METHOD(S) WERE USED TO DETERMINE NO LEAD SERVICE LINES EXIST IN THIS WATER SYSTEM'S DISTRIBUTION SYSTEM, AS REQUIRED BY ORC 6109.121(F):

LEAD SERVICE LINE VERIFICATION	
This PWS states they have no lead service lines and has reviewed the following information (select one or more of the following):	
<input type="checkbox"/>	Historical permit records and/or local ordinances
<input type="checkbox"/>	Distribution maintenance records (i.e. meter replacement, waterline break repairs)
<input type="checkbox"/>	Information pertaining to installation dates for all service lines (i.e. after 1986 when lead services lines were banned)
<input checked="" type="checkbox"/>	Service line material of all service lines is known (i.e. all service lines are known to be PVC)

 Signature of Responsible Person _____ Date 4-25-17
Michael A. Kidston
 Printed Name and Title of Responsible Person _____

PWS NAME: _____
 PWS ID: OH _____
 COUNTY: _____

<p><u>For Ohio EPA use only:</u></p> <p>Date Verification Rec'd: _____</p>

RECEIVED

MAR 07 2017

DDAGW - NWDO

NORTHWEST TOWNSHIP WATER DISTRICT

PWS ID: OH8641912

PWS COUNTY: WILLIAMS

PWS ADDRESS: Mid Toll Blvd, Edon, OH 43518

NO OF SAMPLING SITES REQUIRED: 5

RE: NORTHWEST TOWNSHIP WATER DISTRICT LEAD MAPPING

I. **PURPOSE:**

This letter is in reference to the Ohio Environmental Protection Agency requirement for:

Mapping a distribution system to identify areas that are known to contain or likely to contain lead services lines and identify homes or buildings served by community water systems that may contain lead piping, solder or fixtures.

II. **IDENTIFYING DISTRIBUTION AREAS WITH LEAD SERVICE LINES**

As we are a relatively young water system, all Distribution Lines and Service Line Installations within our system are well known. As shown on the map, the water mains are constructed of PVC C-900 and the service lines are constructed of HDPE DR9.

III. **IDENTIFYING CHARACTERISTICS OF HOMES OR BUILDINGS WITH LEAD PIPING, SOLDER OR FIXTURES**

Because it is practically impossible to determine the lead content of an installed fixture, fitting or pipe, it should be assumed that the manufacture or installation date is the primary indicator of the lead content. Therefore, the characteristics of buildings and piping solder or fixtures used prior to 1988 may have materials with greater than 8% lead and are at a higher risk of contributing lead to the drinking water. All of the buildings within our water district were built after 1996. It is not likely the piping, solder or fixtures installed within our district would contribute lead to the drinking water.