

RE: Hemmelgarn and Sons
Report
Lead Mapping
Drinking Water Program
Mercer County
PWS ID: OH5437812

Hemmelgarn & Sons, Inc.

Philothea Road

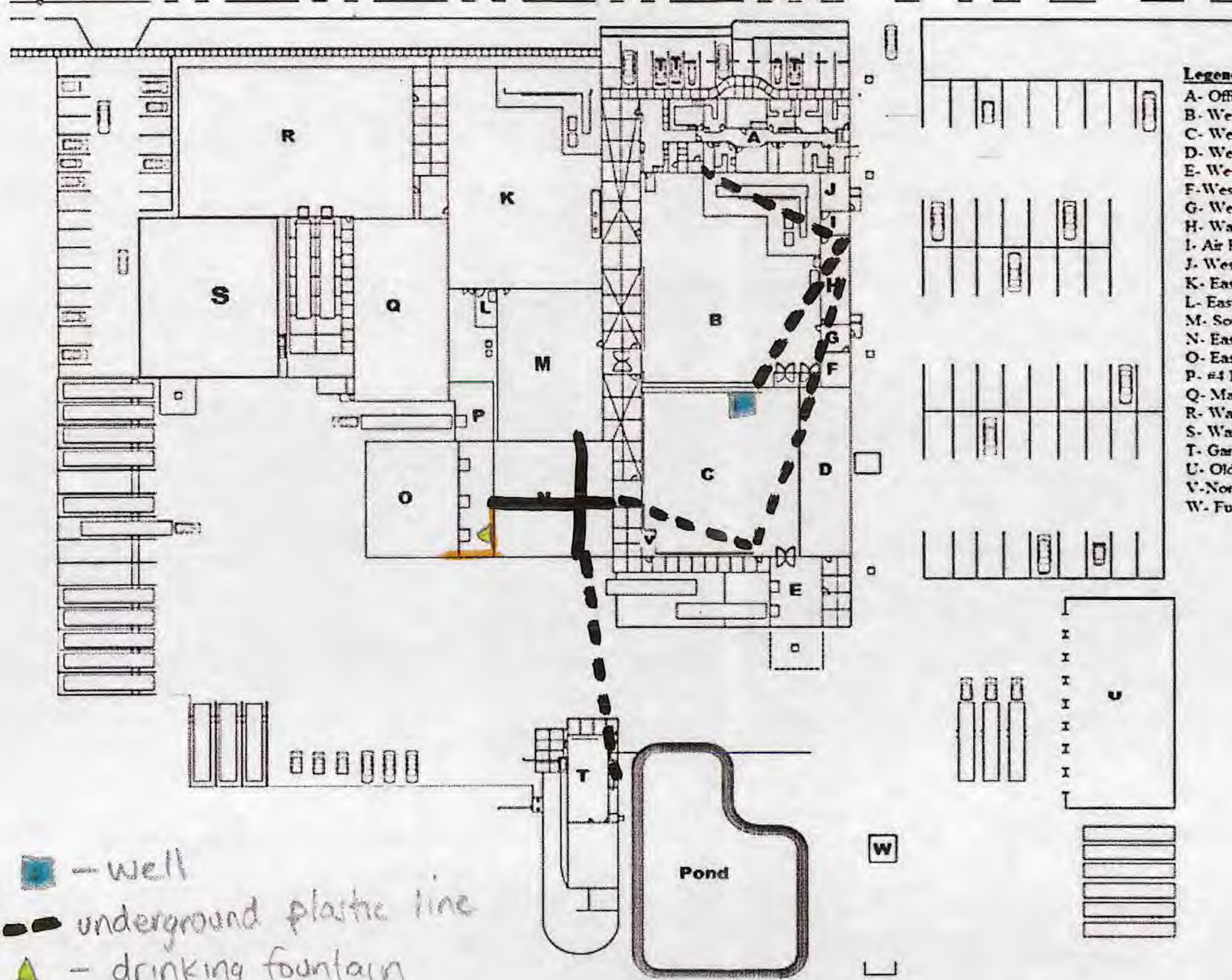





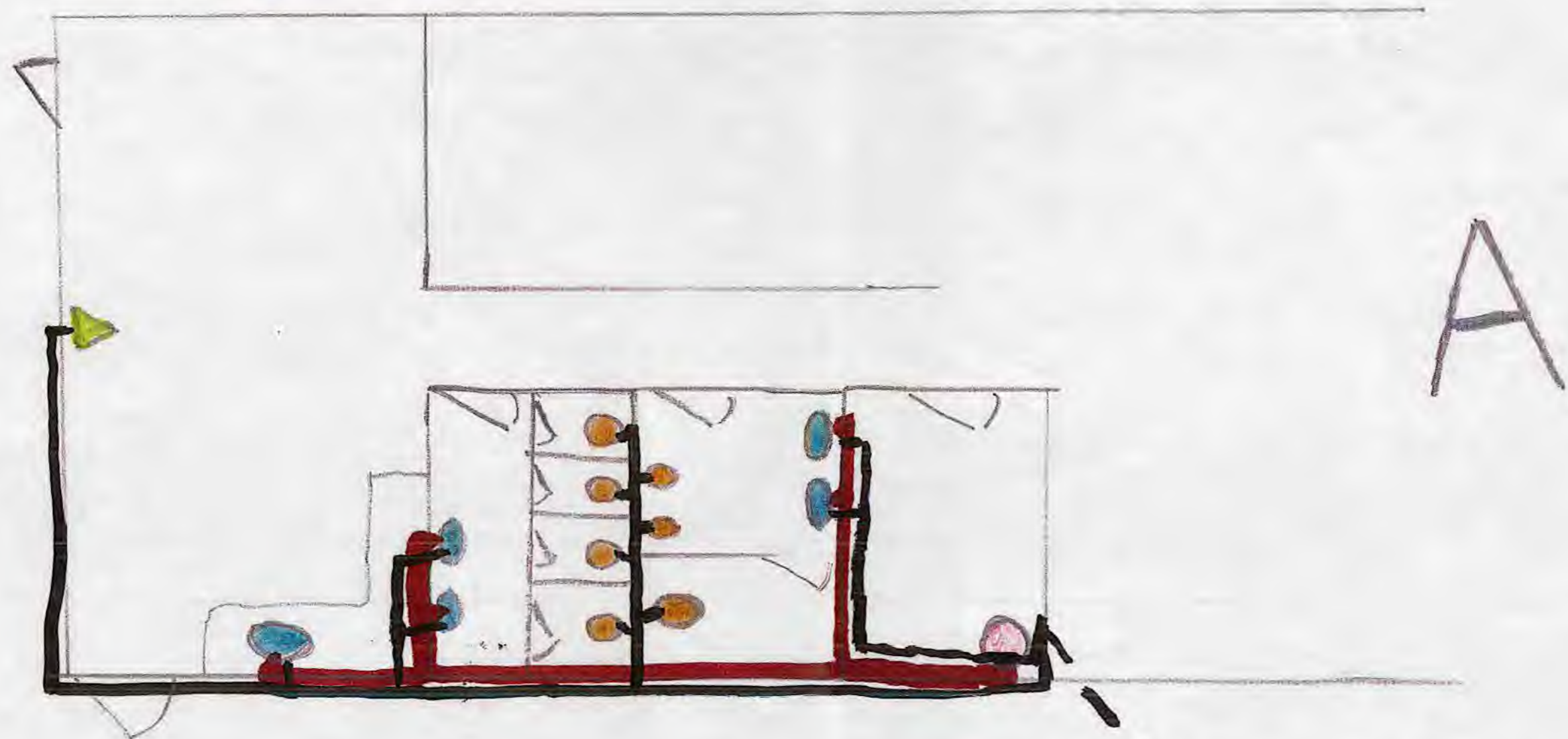

- Legend**
- A- Office, Restrooms, Breakroom
 - B- West Grading Room
 - C- West Cooler
 - D- West Dry Storage
 - E- West Dock
 - F- West Electric Room
 - G- West Entrance
 - H- Water, Main Room
 - I- Air Room
 - J- West Boiler Room
 - K- East Grading Room
 - L- East Boiler Room
 - M- South Cooler
 - N- East Cooler
 - O- East Dock
 - P- #4 Dock
 - Q- Material Wash Room
 - R- Warehouse #1
 - S- Warehouse #2
 - T- Garage
 - U- Old Carton Barn Storage
 - V- North Electric Room
 - W- Fuel Station

- well
- underground plastic line
- drinking fountain
- plastic/pvc line
- copper line

Buildings A thru J were all constructed after the fire (November 2003). We moved in October 2005.
 Building M,N, O, and T were pre 1975

Hemmelgarn & Sons, Inc.



-  sink
-  toilets / urnial
-  hot water heater
-  drinking fountain
-  hot water
-  cold water

--- plastic service line from water room

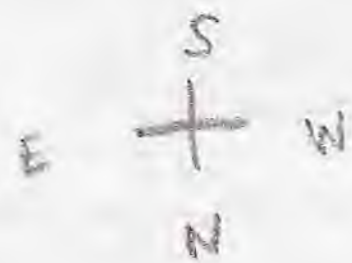





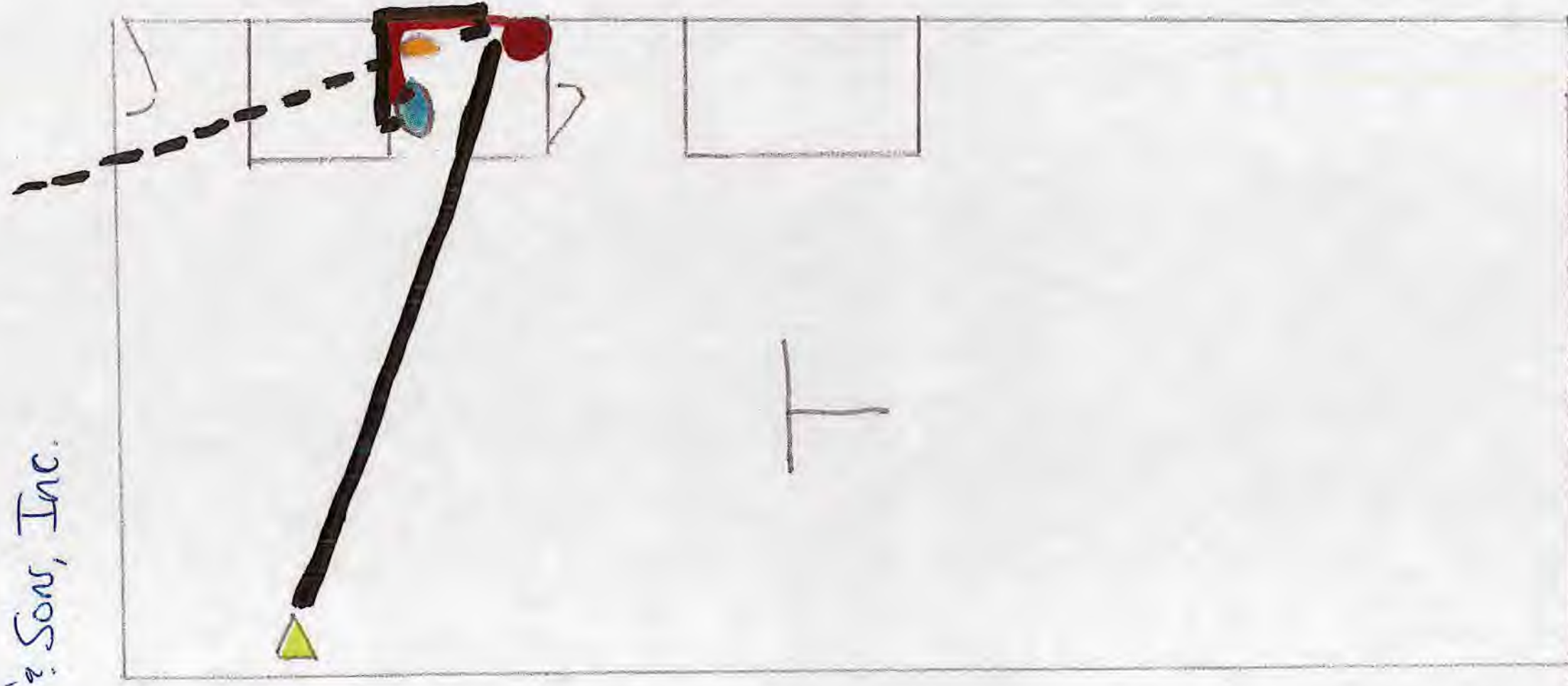

Building A was constructed in 2004-2005 after the fire in 11-2003

Hemmelgarn & Sons, Inc.



Building T was constructed pre 1975

-  - drinking fountain
-  - toilet
-  - sink
-  - underground service line
-  - copper line cold water
-  - copper line - hot water
-  - water heater