

Lead & Copper Mapping Project

PWS Name: Kenston High School

PWS #: OH 2873712

Year Built: 2006

Service Line Material: Non-Lead

If you have any questions, please contact:

Clearwater Operations & Maintenance

10180 Queens Way #3

Chagrin Falls, OH 44023

440-708-0266

clearwater@clearwaterops.com

KENSTON HIGH SCHOOL / 1ST FLOOR

| | | |
|--------------|-------|--------------------------------------|
| CRITICAL | (AED) | LOCATION OF EXISTING AED |
| | (E) | ELECTRICAL SHUTOFF |
| | (F) | FIRE ALARM PANEL |
| | (G) | GAS SHUTOFF |
| | (K) | KNOX BOX |
| | (S) | SPRINKLER SHUTOFF |
| NON CRITICAL | (A) | ADMINISTRATIVE SUITE |
| | (R) | AREA OF REFUGE |
| | (E) | ELEVATOR |
| | (P) | LOCATION OF BLUEPRINTS |
| | (RA) | ROOF ACCESS POINT |
| | (SM) | SECURITY MONITORING & ACCESS CONTROL |
| | (FE) | FIRE EXTINGUISHER |
| | (ED) | EXTERIOR DOOR # |
| | (SE) | SERVICE ENTRANCE |
| | (C) | CAMERA |
| COMMON AREAS | (DN) | DINING |
| | (GN) | GYMNASIUM |
| | (ME) | MEDIA |
| | (ST) | STAGE |
| | | |

FACILITY SAFETY PLAN
 KENSTON LOCAL SCHOOLS
 KENSTON HIGH SCHOOL / 1ST FLOOR
 TRN:018772
 Building Phone: (440) 543-9821
 Emergency Phone: (440) xxx-xxxx



2006

KENSTON HIGH SCHOOL / 2ND FLOOR

| | | |
|--|-------|--------------------------------------|
| CRITICAL | (AED) | LOCATION OF EXISTING AED |
| | (E) | ELECTRICAL SHUTOFF |
| | (F) | FIRE ALARM PANEL |
| | (G) | GAS SHUTOFF |
| | (K) | KNOX BOX |
| | (S) | SPRINKLER SHUTOFF |
| | (W) | WATER SHUTOFF |
| NON CRITICAL | (A) | ADMINISTRATIVE SUITE |
| | (R) | AREA OF REFUGE |
| | (E) | ELEVATOR |
| | (P) | LOCATION OF BLUEPRINTS |
| | (RA) | ROOF ACCESS POINT |
| | (SM) | SECURITY MONITORING & ACCESS CONTROL |
| | FE | FIRE EXTINGUISHER |
| | DR # | EXTERIOR DOOR # |
| | SE # | SERVICE ENTRANCE |
| | △ | CAMERA |
| COMMON AREAS | (DN) | DINING |
| | (GM) | GYMNASIUM |
| | (ME) | MEDIA |
| | (ST) | STAGE |
| FACILITY SAFETY PLAN KENSTON LOCAL SCHOOLS KENSTON HIGH SCHOOL / 2ND FLOOR TRN:018770 Building Phone: (440) 543-9821 Emergency Phone: (440) xxx-xxxx | | |

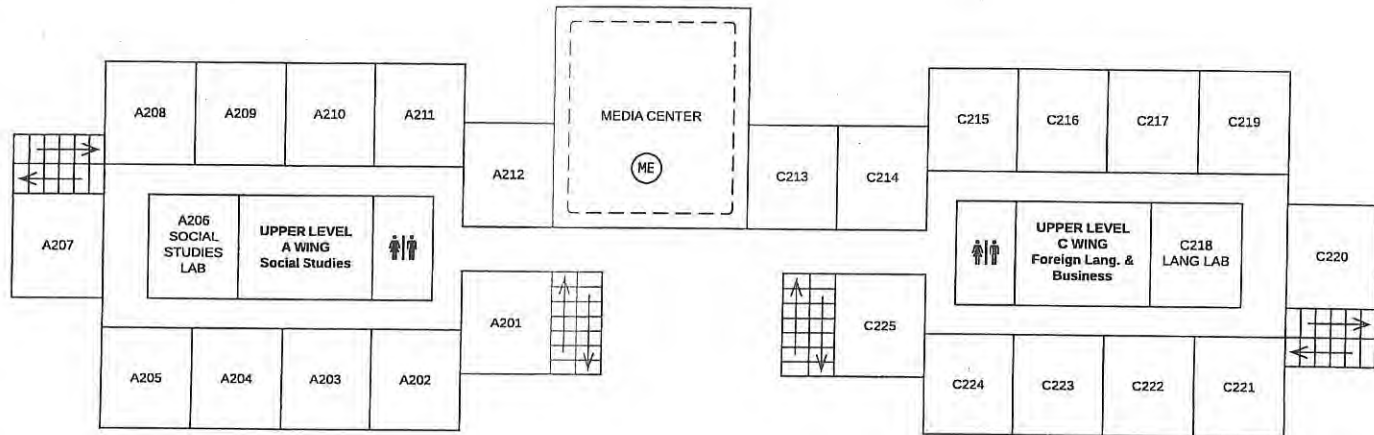



Geauga **REALink**



Geauga County GIS

Frank J. Gliha, Geauga County Auditor
Joe Cattell, Geauga County Engineer PE, PS



1 Inch = 133.92 Feet | Scale: 1,607

This tax map was prepared by Geauga County GIS in accordance with Section 5713.09 of the O.R.C. Geauga County digital data is a representation of recorder plats, surveys, deeds, and other collected information for use within the Geographic Information System for purposes of public access and analysis. These and other digital data do not replace or modify land surveys, deeds, and/or other legal instruments defining land ownership or use. Geauga County assumes no legal responsibility for this information.

www.auditor.co.geauga.oh.us

February 22, 2017