

# Lead & Copper Mapping Project

PWS Name: ICASI

PWS #: OH 2873912

Year Built: 2004

Service Line Material: Non-Lead

If you have any questions, please contact:

Clearwater Operations & Maintenance

10180 Queens Way #3

Chagrin Falls, OH 44023

440-708-0266

[clearwater@clearwaterops.com](mailto:clearwater@clearwaterops.com)

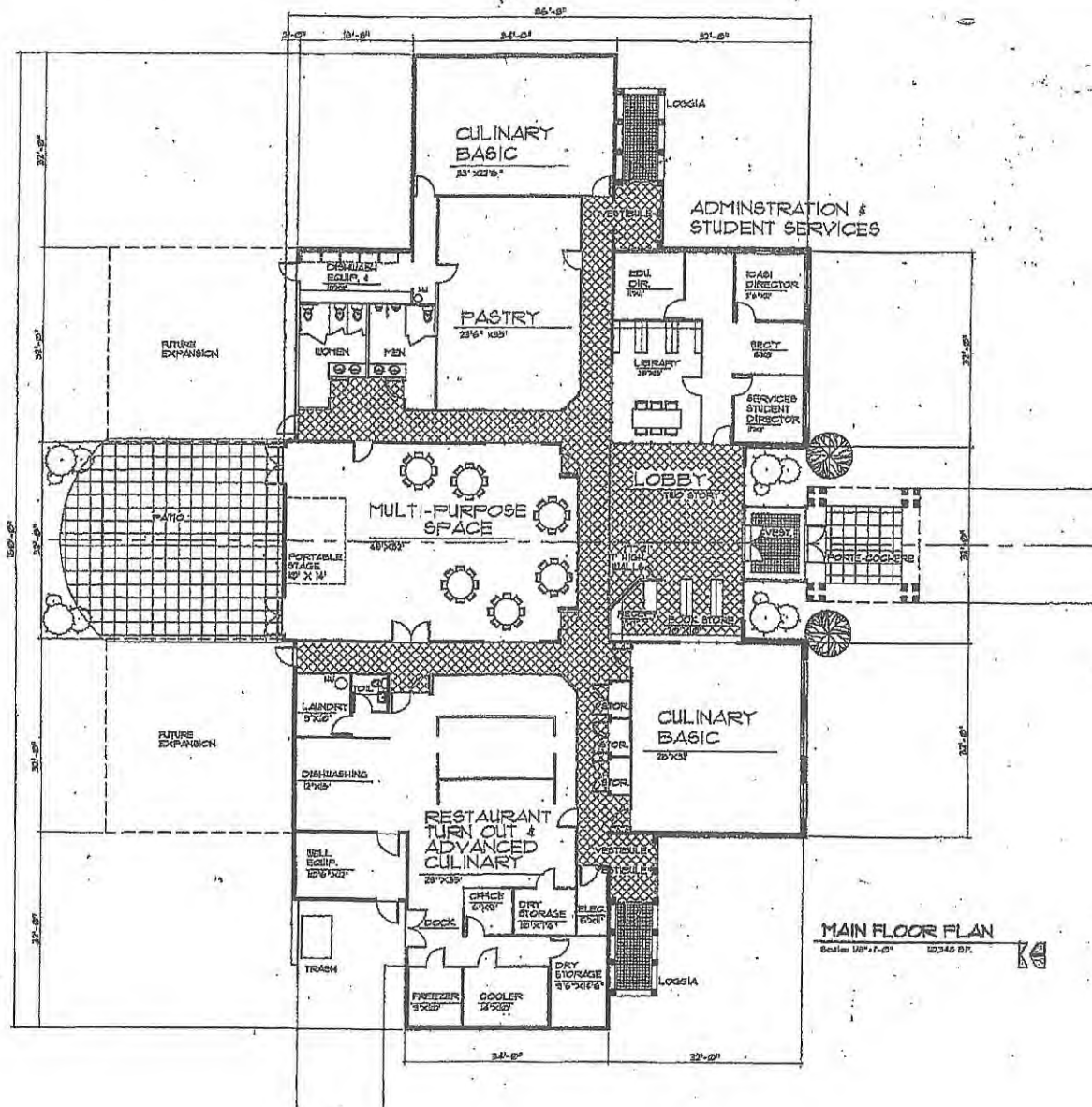

**MAIN FLOOR PLAN**  
Scale: 1/8" = 1'-0" 12/24/04 D.F.

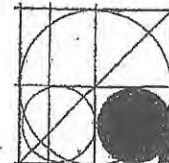

REVISION	DATE
REVISED	9/22/04
REVISED	9/26/04
REVISED	10/16/04
REVISED	10/22/04
REVISED	11/10/04
REVISED	11/23/04
REVISED	11/27/04
REVISED	12/10/04

**Leber · Brown  
Architects**  
cleveland, ohio

Professional seal and registration information for the State of Ohio, including the name of the architect and the project name.



NO. 041004BLDUG	
DATE	9/20/04
CHECKED	104-150

TITLE:  
**PROPOSED  
PLAN**

I.C.A.S.I.  
CULINARY  
SCHOOL  
CHESTERLAND, OH

**A-1**



 **Geauga**  **REALink**



powered by GIS

**Frank J. Gliha, Geauga County Auditor**  
**Joe Cattell, Geauga County Engineer PE, PS**



**1 Inch = 24.67 Feet | Scale: 296**

This tax map was prepared by Geauga County GIS in accordance with Section 5713.09 of the O.R.C. Geauga County digital data is a representation of recorder plats, surveys, deeds, and other collected information for use within the Geographic Information System for purposes of public access and analysis. These and other digital data do not replace or modify land surveys, deeds, and/or other legal instruments defining land ownership or use. Geauga County assumes no legal responsibility for this information.

[www.auditor.co.geauga.oh.us](http://www.auditor.co.geauga.oh.us)

February 22, 2017