

Dean's Backflow Service Inc.
16387a Twp Road 454
Loudonville, Ohio
(419) 651-0142

This is for Nashville:

Most of the town does not have lead service lines but there are five homes on the west end of state route 39 that we are not sure if the service lines are completely changed to plastic.

Most homes were built in the early 1900's some in the 40's and 50's and four new homes in the last five years.

"Buildings in Ohio built prior to 1998 or that use plumbing material or solder manufactured before 1998 may have materials with greater than 8% lead and are at a higher risk of contributing lead to the drinking water than materials manufactured after 1998. In addition, buildings built and plumbing materials manufactured after 2014 were required to have less than 0.25% lead by weight and have the lowest risk for contributing lead to the drinking water. It should be noted however that, although prohibited, some use of leaded solder or leaded components may have occurred after the prohibitions became effective."

Thank You!
Kevin Dean, Operator

RECEIVED
MAR 31 2011
BY:

Entity: _____
Doc Type: RIPM
Doc Subtype: Lead Mapping
Program: DRAM
County: Helmes
Secondary ID: OH 3801012

Revises #588281

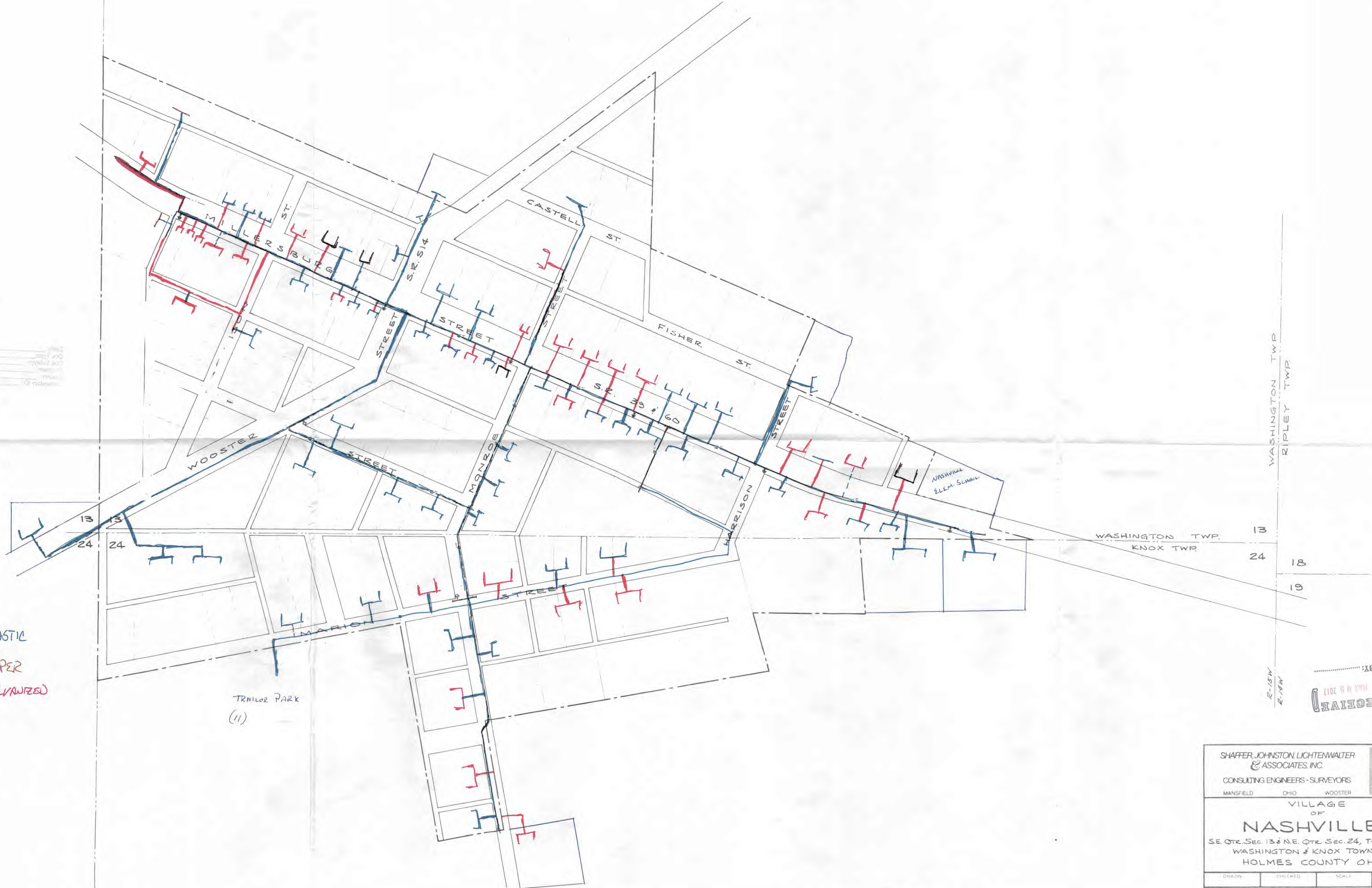

1" = 100'

- PLASTIC
- COPPER
- GALVANIZED

TRAILOR PARK
(II)

NASHVILLE
ELEM. SCHOOL

WASHINGTON TWP.
RIPLEY TWP.

WASHINGTON TWP.
KNOX TWP.

13
24
18
19

R-15W
R-15W

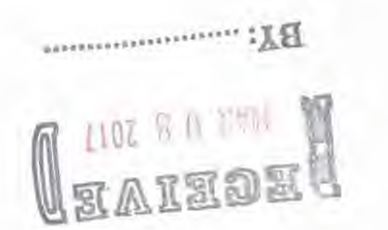

SHAFER, JOHNSTON, LICHTENWALTER
& ASSOCIATES, INC.
CONSULTING ENGINEERS - SURVEYORS
MANSFIELD OHIO WOOSTER

VILLAGE
OF
NASHVILLE
SE. QTR. Sec. 13 & NE. QTR. Sec. 24, T-19N; R-15W
WASHINGTON & KNOX TOWNSHIPS
HOLMES COUNTY OHIO

DRAWN	CHECKED	SCALE	DATE
JOB NO. EW-1239	SHEET 1	OF	