

**VERIFICATION FORM FOR COMMUNITY PUBLIC WATER SYSTEMS
CLAIMING NO LEAD SERVICE LINES**

The owner or operator of all community public water systems must identify and map areas of their distribution system that are known or are likely to contain lead service lines. Systems must submit a copy of the applicable map to the Ohio Department of Health and the Ohio Department of Job and Family Services. Systems must also submit a report to the director containing at least both of the following: (1) The applicable map with narrative, and (2) A list of sampling locations used to collect samples as required by Ohio Revised Code (ORC) Section 6109.121 and any rules adopted thereunder, including contact information for the owner and occupant of each sampling site.

Should a water system determine no lead service lines exist in their distribution system, they must provide information stating they reviewed, at the minimum, historical permit records and local ordinances, distribution maintenance records and information pertaining to installation dates or materials for all services lines. This information must be verified below.

I HEREBY CERTIFY THAT THE FOLLOWING METHOD(S) WERE USED TO DETERMINE NO LEAD SERVICE LINES EXIST IN THIS WATER SYSTEM'S DISTRIBUTION SYSTEM, AS REQUIRED BY ORC 6109.121(F):

LEAD SERVICE LINE VERIFICATION
<p>This PWS states they have no lead service lines and has reviewed the following information (select one or more of the following):</p> <ul style="list-style-type: none"> <input type="checkbox"/> Historical permit records and/or local ordinances <input checked="" type="checkbox"/> Distribution maintenance records (i.e. meter replacement, waterline break repairs) <input type="checkbox"/> Information pertaining to installation dates for all service lines (i.e. after 1986 when lead services lines were banned) <input checked="" type="checkbox"/> Service line material of all service lines is known (i.e. all service lines are known to be PVC)

Tennis King 5/19/17
 Signature of Responsible Person Date
Tennis King - Operator of Record
 Printed Name and Title of Responsible Person

PWS NAME: Sundial MHA
PWS ID: OH 8503912
COUNTY: Wayne

RECEIVED	
For Ohio EPA use only:	
Date Verification Rec'd: <u>MAY 22 2017</u>	
BY _____	

Entity: _____
 Doc Type: Report
 Doc Subtype: Lead mapping
 Program: DDAGW
 County: Wayne
 Secondary ID: OH8503912

Add to rDOC 585649

Lead Mapping and Distribution Systems

Narrative: Service for main lines throughout the mobile home park consists of two-inch PVC piping. Stand pipe for each mobile home service line consists of a one-half inch by four foot copper pipe with two soldered connections.

Because it is practically impossible to determine the lead content of an installed fixture, fitting or pipe, it should be assumed that the manufacture or installation date is the primary indicator of the lead content. Therefore, the characteristics of buildings and piping solder or fixtures would be buildings in Ohio built prior to 1998 or that use plumbing material or solder manufactured before 1998 may have materials with greater than 8% lead and are at a higher risk of contributing lead to the drinking water than materials manufactured after 1998. In addition, buildings built and plumbing materials manufactured after 2014 were required to have less than 0.25% lead by weight and have the lowest risk for contributing lead to the drinking water. It should be noted however that, although prohibited, some use of leaded solder or leaded components may have occurred after the prohibitions became effective.

RECEIVED
APR 10 2017

BY:

Sundial Mobile Village
15091 Portage St. Office
Doylestown, OH 44230

March 7, 2017

re: Mapping Requirements

Division of Drinking and Ground Waters

Attached are the submittal requirements for the Lead mapping in Distribution including a map, narrative description and a list of sampling locations that are Tier I sites used to collect samples.

T King
Owner/Operator

Lead Mapping in Distribution Systems

Narrative: Service for main lines throughout the mobile home park consists of two-inch PVC piping. Stand pipe for each mobile home service line consists of a one-half inch by four foot copper with two soldered connections.

1991 PORTLAND ST. ...
PWS (R) No. 8503912

6" WEST WELL
4" WEST WELL

WATER LINE FROM VIEWS TO PRESSURE TANK WITH Y-FITTING
CONNECTIVE ADD. 1" WEST WELLS.

* 2" MAIN WATER LINE FROM PRESSURE TANK TO PRESSURE TANK

1/2" = 1/2" WIRE
O = 3/4" HOSE
□ = WELL
E = PRESSURE TANK
E = PRESSURE TANK
E = PRESSURE TANK

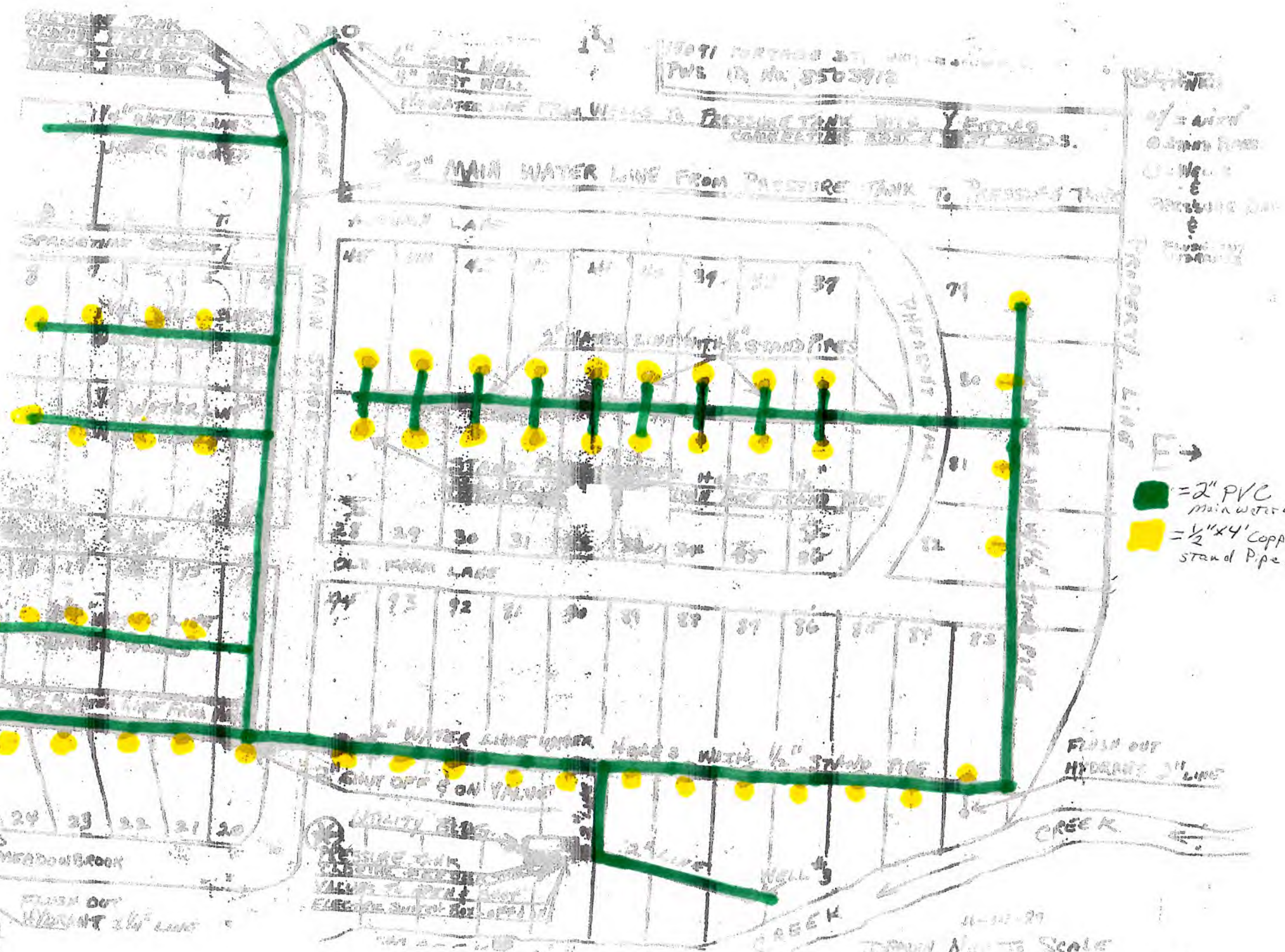

E →
■ = 2" PVC
Main water line
● = 1/2" x 4' Copper
Stand Pipe.

11-12-87
DRAIN MAP TO SCALE
1" = 100' (Vertical North Arrow)